

NEW MEXICO OIL CONSERVATION COMMISSION
Well Location and Acreage Dedication Plat

Section A.

Date February 6, 1959

Operator Southern Union Gas Company Lease Armenta
Well No. 1 Unit Letter H Section 27 Township 29N Range 10W NMPM
Located 2190 Feet From North Line, 820 Feet From East Line
County San Juan G. L. Elevation 5508 Dedicated Acreage 160 Acres
Name of Producing Formation Farmington Pool Aztec Pictured Cliffs

1. Is the Operator the only owner* in the dedicated acreage outlined on the plat below?
Yes _____ No X.
2. If the answer to question one is "no," have the interests of all the owners been consolidated by communitization agreement or otherwise? Yes X No _____. If answer is "yes," Type of Consolidation Armenta Gas Unit #B - Communitization
3. If the answer to question two is "no," list all the owners and their respective interests below:

Owner

Land Description

El Paso Natural Gas Co.

SW/4 NE/4 Sec. 27, T-29N, R-10W

Pan-American Petr. Co.

SE/4 NE/4 Sec. 27, T-29N, R-10W

Section B

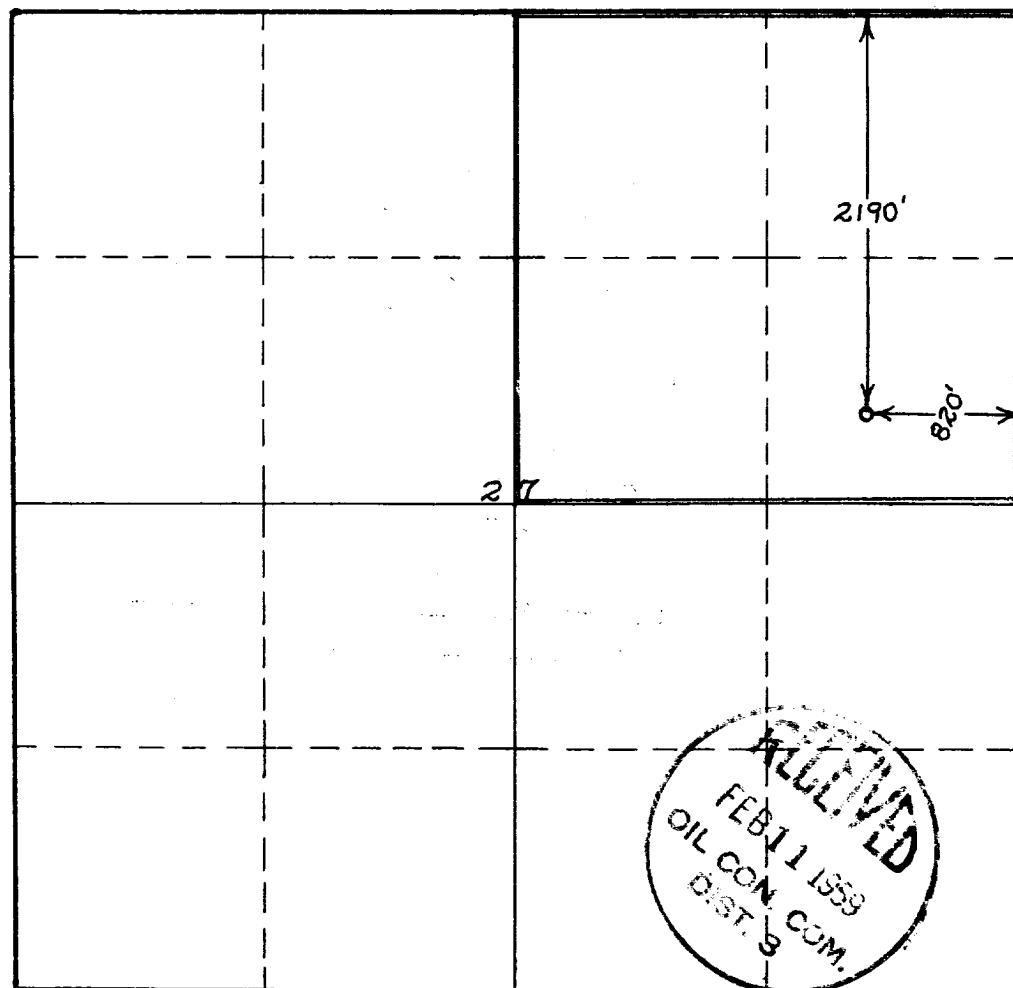

This is to certify that the information in Section A above is true and complete to the best of my knowledge and belief.

(Operator)
Paul J. Edote
(Representative)
P. O. Box 815
Farmington, New Mexico
Address

This is to certify that the well location shown on the plat in Section B was plotted from field notes of actual surveys made by me or under my supervision and that the same is true and correct to the best of my knowledge and belief.

Date Surveyed _____

Registered Professional
Engineer and/or Land Surveyor.

Certificate No. _____
(See instructions for completing this form on the reverse side)

INSTRUCTIONS FOR COMPLETION:

1. Operator shall furnish and certify to the information called for in Section A.
2. Operator shall outline the dedicated acreage for both oil and gas wells on the plat in Section B.
3. A registered professional engineer or land surveyor registered in the State of New Mexico or approved by the Commission shall show on the plat the location of the well and certify this information in the space provided.
4. All distances shown on the plat must be from the outer boundaries of Section.
5. If additional space is needed for listing owners and their respective interests as required in question 3, Section A, please use space below

OIL CONSERVATION COMMISSION		
AZTEC DISTRICT OFFICE		
No. Copies Received <u>4</u>		
DISTRIBUTION		
	RECEIVED	
Operator	/	
Santa Fe	/	
Proration Office		
State Land Office		
U. S. G. S.	/	
Transporter		
File	/	✓

* "Owner" means the person who has the right to drill into and to produce from any pool and to appropriate the production either for himself or for himself and another. (65-3-29 (e) NMSA 1953 Comp.)