

NEW MEXICO OIL CONSERVATION COMMISSION

Well Location and Acreage Dedication Plat

SECTION A.

Date **March 10, 1961**

Operator **Aztec Oil and Gas Company** Lease **Hagood**
 Well No. **23-0** Unit Letter **I** Section **19** Township **29N** Range **13W** NMPM
 Located **1980** Feet From **South** Line **660** Feet From **East** Line
 County **San Juan** G. L. Elevation **5384** Dedicated Acreage **80** Acres
 Name of Producing Formation **Totah Gallup** Pool **Totah**

1. Is the Operator the only owner* in the dedicated acreage outlined on the plat below? Yes **XX** No
2. If the answer to question One is "No," have the interests of all the owners been consolidated by communitization agreement or otherwise? Yes No If answer is "Yes," Type of Consolidation
3. If the answer to question Two is "No," list all the owners and their respective interests below:

OWNER

LAND DESCRIPTION

SECTION B.

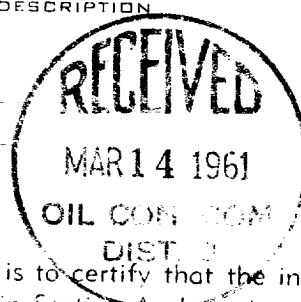
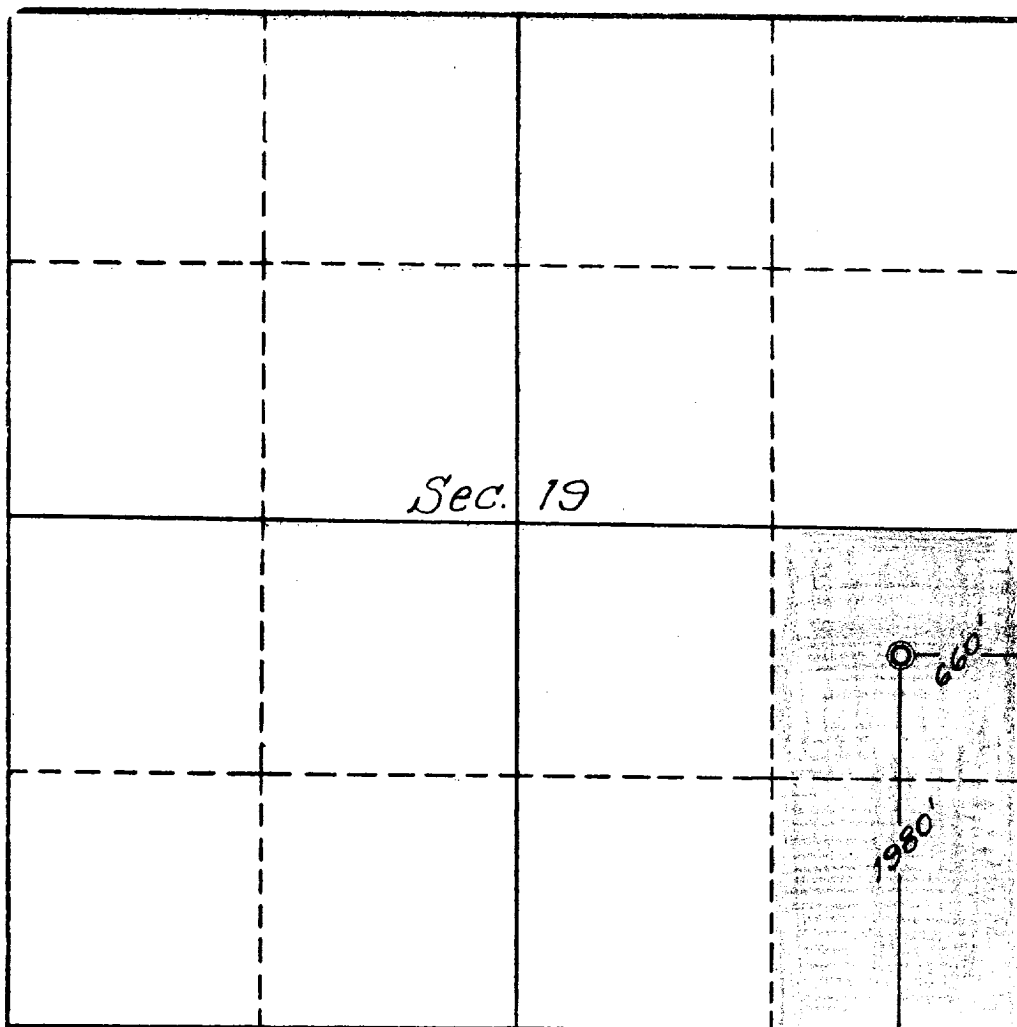

This is to certify that the information in Section A above is true and complete to the best of my knowledge and belief.

Aztec Oil and Gas Company
(OPERATOR)

ORIGINAL SIGNED BY **JOE C. SALMON**
(REPRESENTATIVE)

Drawer 570, Farmington, N.M.
(ADDRESS)

This is to certify that the well location shown on the plat in Section B was plotted from **800** notes of actual surveys made by me or under my supervision and that the same is true and correct to the best of my knowledge and belief.

Date Surveyed **3-7-61**

Four States Engineering Co.
FARMINGTON, NEW MEXICO

C. L. Totah
REGISTERED ENGINEER OR
LAND SURVEYOR

Certificate No. **3084**