

**NEW MEXICO OIL CONSERVATION COMMISSION**  
**Santa Fe, New Mexico**

30-045-08061

## NOTICE OF INTENTION TO DRILL OR RECOMPLETE

Notice must be given to the District Office of the Oil Conservation Commission and approval obtained before drilling or recompletion begins. If changes in the proposed plan are considered advisable, a copy of this notice showing such changes will be returned to the sender. Submit this notice in **QUINTUPLICATE**. One copy will be returned following approval. See additional instructions in Rules and Regulations of the Commission.

**Astec, New Mexico****June 15, 1953**

(Place)

(Date)

OIL CONSERVATION COMMISSION  
 SANTA FE, NEW MEXICO

Gentlemen:

You are hereby notified that it is our intention to commence the (Drilling) (Recompletion) of a well to be known as

**Basin Natural Gas Corporation**

(Company or Operator)

**Hare** (Lease), Well No. **#1**, in **Pool** (it) The well is located **1650** feet from the **North** line and **1650** feet from the **East** line of Section **23**, T. **29**, R. **11-W**, NMPM.  
 (GIVE LOCATION FROM SECTION LINE) Pool, **San Juan** County

|   |          |          |   |
|---|----------|----------|---|
| D | C        | B        | A |
| E | F        | <i>X</i> | H |
| L | <i>R</i> | J        | I |
| M | N        | O        | P |

If State Land the Oil and Gas Lease is No.

If patented land the owner is **Seitinsner, - Hare,**  
 Address **Bloomfield, New Mexico**

We propose to drill well with drilling equipment as follows: **Cable Tools**  
**and Rotary**

The status of plugging bond is **Blanket**Drilling Contractor **F. B. Umbarger**

We intend to complete this well in the **Picture Cliff Formation**  
 formation at an approximate depth of **1700** feet.

### CASING PROGRAM

We propose to use the following strings of Casing and to cement them as indicated:

| Size of Hole  | Size of Casing | Weight per Foot | New or Second Hand | Depth           | Sacks Cement |
|---------------|----------------|-----------------|--------------------|-----------------|--------------|
| <b>12 1/2</b> | <b>10 3/4</b>  | <b>32</b>       | <b>Used</b>        | <b>64 ft.</b>   | <b>2</b>     |
| <b>7-7/8</b>  | <b>5 1/2</b>   | <b>15</b>       | <b>New</b>         | <b>1700 ft.</b> | <b>100</b>   |
|               |                |                 |                    |                 |              |
|               |                |                 |                    |                 |              |

If changes in the above plans become advisable we will notify you immediately.

ADDITIONAL INFORMATION (If recompletion give full details of proposed plan of work.)

If production is indicated we will shoot the section with approximately 1 1/2 qts. to the foot of SEG and complete as gas well, running 1" tubing to the bottom. We will run a Geoelectric log and may test the Farmington-Fruitland if indicated by the electric log.

Approved **7-29**, 19**53**  
 Except as follows:

*Subject to final approval  
 of bond by commission*

OIL CONSERVATION COMMISSION

By **Ernest C. Arnold**  
 Title

Sincerely yours,

**Basin Natural Gas Corp.**  
 (Company or Operator)

By **F. B. Umbarger**

Position **Vice-President**  
 Send Communications regarding well to

Name **F. B. Umbarger**Address **Box 578, Astec, New Mexico**

COMPANY BASIN NATURAL GAS CORPORATION

Well Name & No. The Basin Natural Gas Corp. Lease No. W. L. Hare #1

Location 1650 feet from the North line, 1650 feet from the East line.

Being in SW $\frac{1}{4}$ , NE $\frac{1}{4}$ .

Sec. 23, T29 N., R11 W., N.M.P.M., San Juan County, New Mexico

Ground Elevation 5484.58 5485

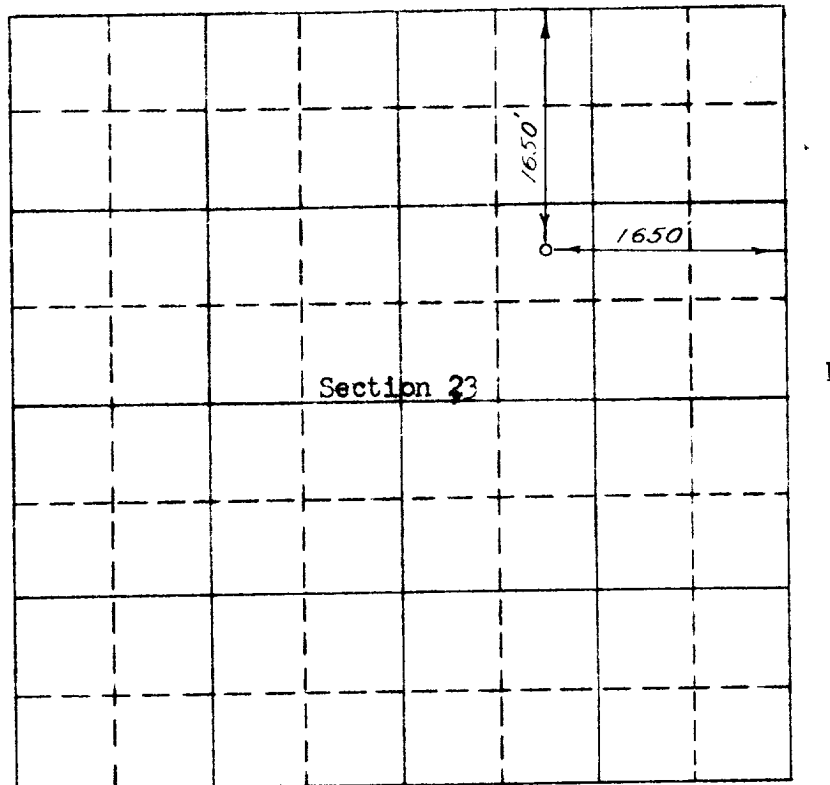

Scale -- 4 inches equals 1 mile

Surveyed April 18, 19 53

This is to certify that the above plat was prepared from field notes of actual surveys made by me or under my supervision and that the same are true and correct to the best of my knowledge and belief.

C. O. Walker

Registered Professional  
Engineer and Land Surveyor.

Seal:

Farmington, New Mexico

|                              |                  |                                     |
|------------------------------|------------------|-------------------------------------|
| OIL CONSERVATION COMMISSION  |                  |                                     |
| AZTEC DISTRICT OFFICE        |                  |                                     |
| No. Copies Received <u>5</u> |                  |                                     |
| DISTRIBUTION                 |                  |                                     |
|                              | NO.<br>FURNISHED |                                     |
| Operator                     | <u>1</u>         |                                     |
| Santa Fe                     | <u>1</u>         |                                     |
| Proration Office             |                  |                                     |
| State Land Office            |                  |                                     |
| U. S. G. S.                  | <u>2</u>         |                                     |
| Transporter                  |                  |                                     |
| File                         | <u>1</u>         | <input checked="" type="checkbox"/> |