

(SUBMIT IN TRIPLICATE)

UNITED STATES
DEPARTMENT OF THE INTERIOR
GEOLOGICAL SURVEY

Land Office Walla Walla
Lease No. W-10770
Unit 1072

SUNDRY NOTICES AND REPORTS ON WELLS

NOTICE OF INTENTION TO DRILL	<input checked="" type="checkbox"/>	SUBSEQUENT REPORT OF WATER SHUT-OFF	
NOTICE OF INTENTION TO CHANGE PLANS		SUBSEQUENT REPORT OF SHOOTING OR ACIDIZING	
NOTICE OF INTENTION TO TEST WATER SHUT-OFF		SUBSEQUENT REPORT OF ALTERING CASING	
NOTICE OF INTENTION TO RE-DRILL OR REPAIR WELL		SUBSEQUENT REPORT OF RE-DRILLING OR REPAIR	
NOTICE OF INTENTION TO SHOOT OR ACIDIZE		SUBSEQUENT REPORT OF ABANDONMENT	
NOTICE OF INTENTION TO PULL OR ALTER CASING		SUPPLEMENTARY WELL HISTORY	
NOTICE OF INTENTION TO ABANDON WELL			

(INDICATE ABOVE BY CHECK MARK NATURE OF REPORT, NOTICE, OR OTHER DATA)

April 1, 1959

Well No. 10 is located 1.0 ft. from N line and 1.0 ft. from W line of sec. 20

W. Walla Walla (1/4 Sec. and Sec. No.) W-10770 (Twp.) 2-1 (Range) W. 10770 (Meridian)
Walla Walla (Field) Walla Walla (County or Subdivision) Washington (State or Territory)

The elevation of the derrick floor above sea level is 1012 ft.

DETAILS OF WORK

(State names of and expected depths to objective sands; show sizes, weights, and lengths of proposed casings; indicate mudding jobs, cementing points, and all other important proposed work)

Proposed to: Set 250' of 1 1/2" casing and cement with 150 lb. cement. Drill through fractured little formation to an approximately total depth of 210'. Set 1 1/2" casing to total depth with 75 lb. cement. Perforate casing and sand-test for flow of oil, gas and water. Run 1" signal line.

The 150 lb. casing of 150 acres, has been dedicated to this location.

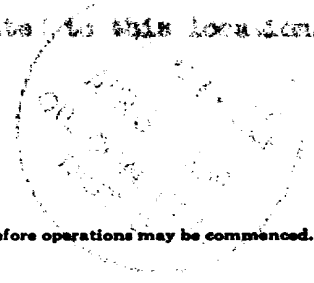

I understand that this plan of work must receive approval in writing by the Geological Survey before operations may be commenced.

Company W. Walla Walla

Address W. Walla Walla

Walla Walla, Wash. State

By Joe C. Salmon

Title Assistant Superintendent



NEW MEXICO OIL CONSERVATION COMMISSION

Well Location and Acreage Dedication Plat

Section A.

Date March 30, 1959

Operator Aztec Oil and Gas Company Lease Hare
Well No. 10 Unit Letter Section 23 Township 29 North Range 10 West NMPM
Located 1650 Feet From North Line, 1650 Feet From West Line
County San Juan G. L. Elevation 5745 Dedicated Acreage 160 Acres
Name of Producing Formation Pictured Cliffs Pool Undesignated

1. Is the Operator the only owner* in the dedicated acreage outlined on the plat below?
Yes X No .
2. If the answer to question one is "no," have the interests of all the owners been consolidated by communitization agreement or otherwise? Yes No . If answer is "yes,"
Type of Consolidation
3. If the answer to question two is "no," list all the owners and their respective interests below:

Owner

Land Description

RECEIVED

APR 3 1959

Section B

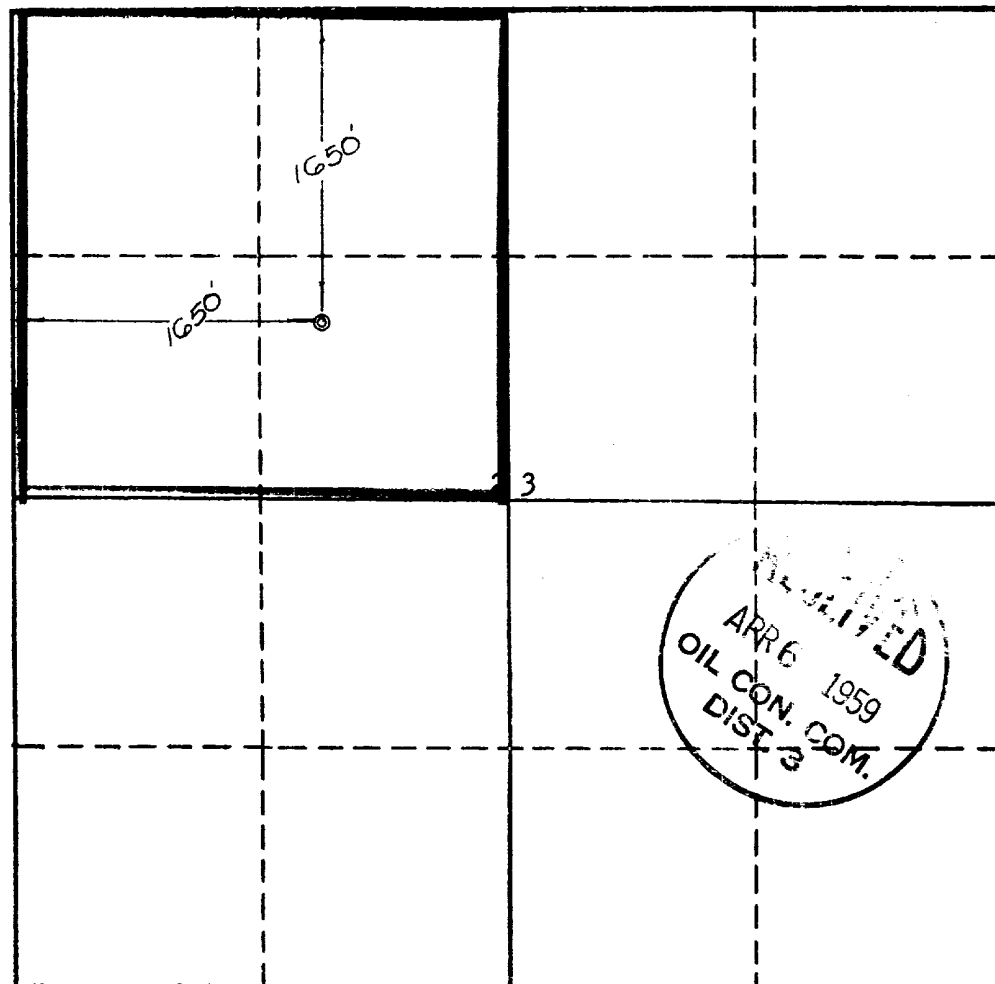

This is to certify that the information in Section A above is true and complete to the best of my knowledge and belief.

AZTEC OIL & GAS COMPANY

(Operator)

ORIGINAL SIGNED BY JOE C. SALMON

(Representative)

Box 786, Farmington, N. M.

Address

This is to certify that the well location of the plat in Section B is based from field notes of surveys made by me or under my supervision and that the same is true and correct to the best of my knowledge and belief.

Date Surveyed March 28, 1959

Ernest V. Echohawk
Ernest V. Echohawk
Registered Land Surveyor.

Certificate No. 1545

