

NO. OF COPIES RECEIVED	5
DISTRIBUTION	
SANTA FE	1
FILE	1
U.S.G.S.	
LAND OFFICE	
TRANSPORTER	OIL
	GAS 1
OPERATOR	2
PRORATION OFFICE	

NEW MEXICO OIL CONSERVATION COMMISSION  
REQUEST FOR ALLOWABLE  
AND  
AUTHORIZATION TO TRANSPORT OIL AND NATURAL GAS

Form C-104  
Supersedes Old C-104 and C-110  
Effective 1-1-65

I. Operator  
MORRIS F. MCNEY, JR.  
Address  
P. O. Box 14738, 5500 Tramway Blvd. N.E., Albuquerque, New Mexico 87111  
Reason(s) for filing (Check proper box)  
New Well ☐ Change in Transporter of:  
Recompletion ☐ Oil ☐ Dry Gas ☐  
Change in Ownership ☒ Casinghead Gas ☐ Condensate ☐  
Other (Please explain)

If change of ownership give name and address of previous owner  
McKay, Payne and Zachry, P.O. Box 14738, Alb., N. M. 87111

II. DESCRIPTION OF WELL AND LEASE

Lease Name Bearden	Well No. 1	Pool Name, Including Formation Aztec Fruitland	Kind of Lease XXXXXX Federal XXX Fee	Lease No. -
Location Unit Letter <u>E</u> <u>1750</u> Feet From The <u>N</u> Line and <u>800</u> Feet From The <u>West</u> Line of Section <u>10</u> Township <u>29N</u> Range <u>10W</u> , NMPM, <u>San Juan</u> County				

III. DESIGNATION OF TRANSPORTER OF OIL AND NATURAL GAS

Name of Authorized Transporter of Oil <input type="checkbox"/> or Condensate <input type="checkbox"/>	Address (Give address to which approved copy of this form is to be sent)	
Name of Authorized Transporter of Casinghead Gas <input type="checkbox"/> or Dry Gas <input checked="" type="checkbox"/>	Address (Give address to which approved copy of this form is to be sent)	
<u>El Paso Gas Company</u>	<u>El Paso, Texas</u>	
If well produces oil or liquids, give location of tanks.	Unit	Sec.
	Twp.	Rge.
	Is gas actually connected? When	

If this production is commingled with that from any other lease or pool, give commingling order number:

IV. COMPLETION DATA

Designate Type of Completion - (X)	Oil Well	Gas Well	New Well	Workover	Deepen	Plug Back	Same Resrv.	Diff. Resrv.
		X						
Date Spudded 12/29/56	Date Compl. Ready to Prod. 1/22/57	Total Depth 1803	P.B.T.D. 1703					
Elevations (DF, RKB, RT, GR, etc.) 5502	Name of Producing Formation Fruitland	Top Oil/Gas Pay 1510	Tubing Depth 1554					
Perforations 1554-1555, 1559-1561	Depth Casing Shoe 1785							
TUBING, CASING, AND CEMENTING RECORD								
HOLE SIZE	CASING & TUBING SIZE	DEPTH SET	SACKS CEMENT					

V. TEST DATA AND REQUEST FOR ALLOWABLE OIL WELL

(Test must be after recovery of total volume of load oil and must be equal to or exceed top allowable for this depth or be for full 24 hours)

Date First New Oil Run To Tanks	Date of Test	Producing Method (Flow, pump, gas lift, etc.)	
Length of Test	Tubing Pressure	Casing Pressure	Choke Size
Actual Prod. During Test	Oil - Bbls.	Water - Bbls.	Gas - MCF

GAS WELL

Actual Prod. Test-MCF/D	Length of Test	Bbls. Condensate/MMCF	Gravity of Condensate
Testing Method (pitot, back pr.,)	Tubing Pressure (Shut-in)	Casing Pressure (Shut-in)	Choke Size

VI. CERTIFICATE OF COMPLIANCE

I hereby certify that the rules and regulations of the Oil Conservation Commission have been complied with and that the information given above is true and complete to the best of my knowledge and belief.

Morris F. McNeely, Jr.  
(Signature)  
Operator  
(Title)  
September 26, 1975  
(Date)

OIL CONSERVATION COMMISSION

APPROVED \_\_\_\_\_, 19\_\_\_\_  
BY \_\_\_\_\_  
TITLE \_\_\_\_\_

This form is to be filed in compliance with RULE 1104.  
If this is a request for allowable for a newly drilled or deepened well, this form must be accompanied by a tabulation of the deviation tests taken on the well in accordance with RULE 111.  
All sections of this form must be filled out completely for allowable on new and recompleted wells.  
Fill out only Sections I, II, III, and VI for changes of owner, well name or number, or transporter, or other such change of condition.  
Separate Forms C-104 must be filed for each pool in multiply completed wells.

NEW MEXICO OIL CONSERVATION COMMISSION  
WELL LOCATION AND ACREAGE DEDICATION PLAT

Form No. 1  
Supersedes O-129  
4-15-1964

All dimensions must be from the outer boundaries of the Section

McKay, Payne & Zachry		Bearden		# 1
E	19	29N	10W	San Juan
1750	North	890	feet from the	West
5504	Fruitland	Aztec Fruitland	15710	

- Outline the acreage dedicated to the subject well by colored pencil or hachure marks on the plat below.
- If more than one lease is dedicated to the well, outline each and identify the ownership thereof (both as to working interest and royalty).
- If more than one lease of different ownership is dedicated to the well, have the interests of all owners been consolidated by communitization, unitization, forced pooling, etc?

COMMUNITIZATION

Yes No If answer is "yes," type of consolidation

If answer is "yes," list the owners and tract descriptions which have actually been consolidated. Use reverse side of this form for answers.

No allowance will be made for the well until all interests have been consolidated (by communitization, unitization, forced pooling, etc.) or until a non-standard unit, eliminating such interests, has been approved by the Commission.

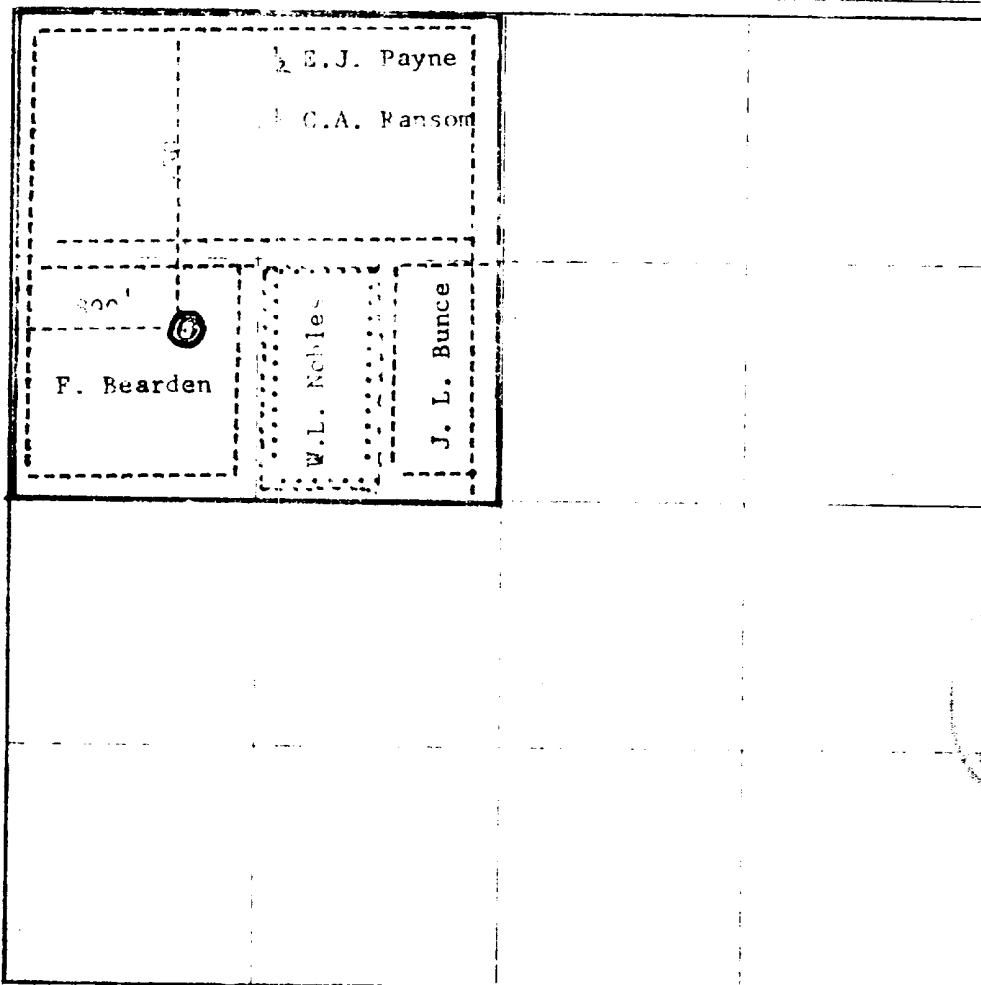

CERTIFICATION

I hereby certify that the information contained herein is true and complete to the best of my knowledge and belief.

Horace F. McKay, Jr.

Operator

McKay, Payne & Zachry

February 19, 1968

I hereby certify that the well location shown on this plat was obtained from the notes of one or more surveys made by me or under my supervision and that the same is true and correct to the best of my knowledge and belief.

RECEIVED  
OCT 13

Oil and Gas Division  
New Mexico State Capitol  
Santa Fe, New Mexico

Certificate No.

