

(SUBMIT IN TRIPLICATE)

Indian Agency _____

UNITED STATES
DEPARTMENT OF THE INTERIOR
GEOLOGICAL SURVEY

Navajo Tribal

Allottee _____

Lease No. 14-20-603-2198

			X

SUNDRY NOTICES AND REPORTS ON WELLS

NOTICE OF INTENTION TO DRILL	X	SUBSEQUENT REPORT OF WATER SHUT-OFF	
NOTICE OF INTENTION TO CHANGE PLANS		SUBSEQUENT REPORT OF SHOOTING OR ACIDIZING	
NOTICE OF INTENTION TO TEST WATER SHUT-OFF		SUBSEQUENT REPORT OF ALTERING CASING	
NOTICE OF INTENTION TO REDRILL OR REPAIR WELL		SUBSEQUENT REPORT OF REDRILLING OR REPAIR	
NOTICE OF INTENTION TO SHOOT OR ACIDIZE		SUBSEQUENT REPORT OF ABANDONMENT	
NOTICE OF INTENTION TO PULL OR ALTER CASING		SUPPLEMENTARY WELL HISTORY	
NOTICE OF INTENTION TO ABANDON WELL			

(INDICATE ABOVE BY CHECK MARK NATURE OF REPORT, NOTICE, OR OTHER DATA)

Navajo Tribal "H"

Farrington, New Mexico March 27, 19 61

Well No. 2 is located 810 ft. from N line and 660 ft. from E line of sec. 24

NE 1/4 NE 1/4 of Section 24 T-29-N R-14-W N.M.P.M.
(1/4 Sec. and Sec. No.) (Twp.) (Range) (Meridian)

Tetch Gallup San Juan New Mexico
(Field) (County or Subdivision) (State or Territory)

The elevation of the derrick floor above sea level is _____ ft. (To be reported later)

DETAILS OF WORK

(State names of and expected depths to objective sands; show sizes, weights, and lengths of proposed casings; indicate mudding jobs, cementing points, and all other important proposed work)

We propose to drill the above well to approximately 5300' to test and develop productive Gallup zones. Stimulation will be as indicated upon penetration of Gallup pay. Rotary tools will be used to total depth. Casing program as follows:

SIZE	DEPTH	CEMENT	REMARKS
8-5/8"	200'	200 sacks	Next - circulate.
4-1/2"	5300'	200 sacks	4% gel cement with 100 sacks next on bottom.

Copies of location plats attached. A copy of any survey taken will be submitted upon completion of well.

I understand that this plan of work must receive approval in writing by the Geological Survey before operations may be commenced.

Company Pan American Petroleum Corporation

Address Box 480

Farrington, New Mexico

Attn: L. O. Speer, Jr.

ORIGINAL SIGNED BY

R. M. Bauer, Jr.

By _____

Title Senior Petroleum Engineer

NEW MEXICO OIL CONSERVATION COMMISSION

Well Location and Acreage Dedication Plat

SECTION A.

Date **March 27, 1961**

Operator **Pan American Petroleum Corporation** Lease **Navajo Tribal "H"**
 Well No **2** Unit Letter **A** Section **24** Township **29 North** Range **14 West** NMPM
 Located **810** Feet From **North** Line **660** Feet From **East** Line
 County **San Juan** G. L. Elevation **To report later** Dedicated Acreage **80** Acres
 Name of Producing Formation **Gallup** Pool **Totah Gallup**

1. Is the Operator the only owner* in the dedicated acreage outlined on the plat below? Yes ☒ No ☐
2. If the answer to question One is "No," have the interests of all the owners been consolidated by communication agreement or otherwise? Yes ☐ No ☐ If answer is "Yes," Type of Consolidation _____
3. If the answer to question Two is "No," list all the owners and their respective interests below.

OWNER

LAND DESCRIPTION



This is to certify that the information in Section A above is true and complete to the best of my knowledge and belief.

Pan American Petroleum Corp.

R. M. Bauer, Jr.
 R. M. Bauer, Jr.

Box 480, Farmington, New Mexico

SECTION B.

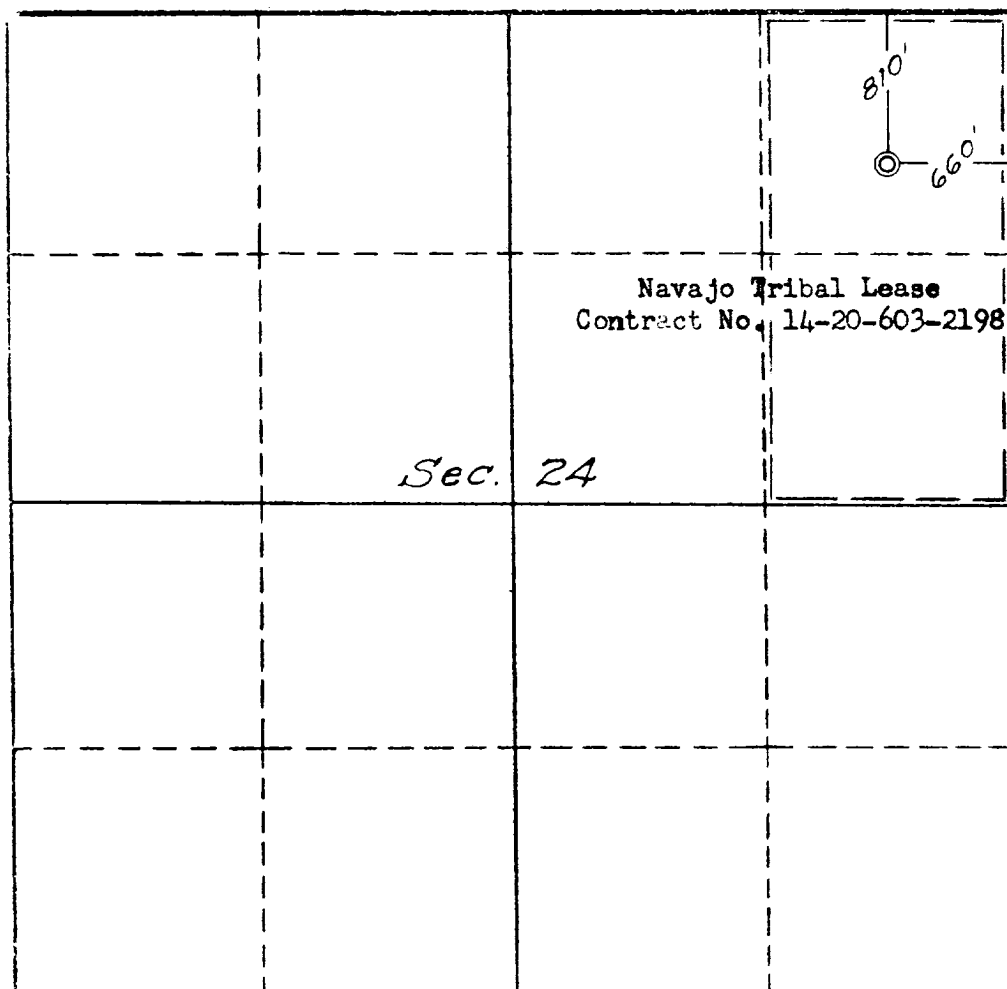

This is to certify that the well location shown on the plat in Section B was plotted from **3000** feet horizontal survey made by me or under my supervision and that the same is true and correct to the best of my knowledge and belief.

Date Surveyed **Mar 23, 1961**

Four States Engineering Co.

FARMINGTON, NEW MEXICO

C. J. [Signature]
 C. J. [Signature]
 REGISTERED ENGINEER AND SURVEYOR
Certificate No. **5084**