

Date Remediation Started: _____		Date Completed: _____	
Remediation Method:	Excavation: _____	Approx. cubic yards _____	
(Check all appropriate sections)			
	Landfarm _____	Insitu Bioremediation _____	
	Other _____		
Remediation Location: Onsite _____ Offsite _____			
(ie. landfarmed onsite, name and location of offsite facility)			
General Description Of Remedial Action: <u>One sample was taken at 3' below bottom of pit center. No PID reading was conducted on location. Sample was transported to laboratory for TPH analysis per EPA Method 8015 and for BTEX per EPA Method 8020.</u>			
Ground Water Encountered:	No _____ X _____ Yes _____	Depth _____	
Final Pit:	Sample location	<u>Center of pit below bottom of pit</u>	
Closure Sampling:	_____		
(if multiple samples attach sample results and diagram of sample locations and depths)	Sample depth	<u>4'</u>	
	Sample date <u>2/3/99</u>	Sample time <u>9:27</u>	
Sample Results			
	Benzene (ppm)	<u>ND</u>	
	Total BTEX (ppm)	<u>0.028</u>	
	Field headspace (ppm)	<u>176</u>	
	TPH	<u>54.23</u>	
Ground Water Sample:	Yes _____ No _____ X _____	(If yes, attach sample results)	
I HEREBY CERTIFY THAT THE INFORMATION ABOVE IS TRUE AND COMPLETE TO THE BEST OF MY KNOWLEDGE AND BELIEF			
DATE	<u>6-28-99</u>	PRINTED NAME _____	
SIGNATURE	<u>[Signature]</u>	AND TITLE <u>P.L.</u>	

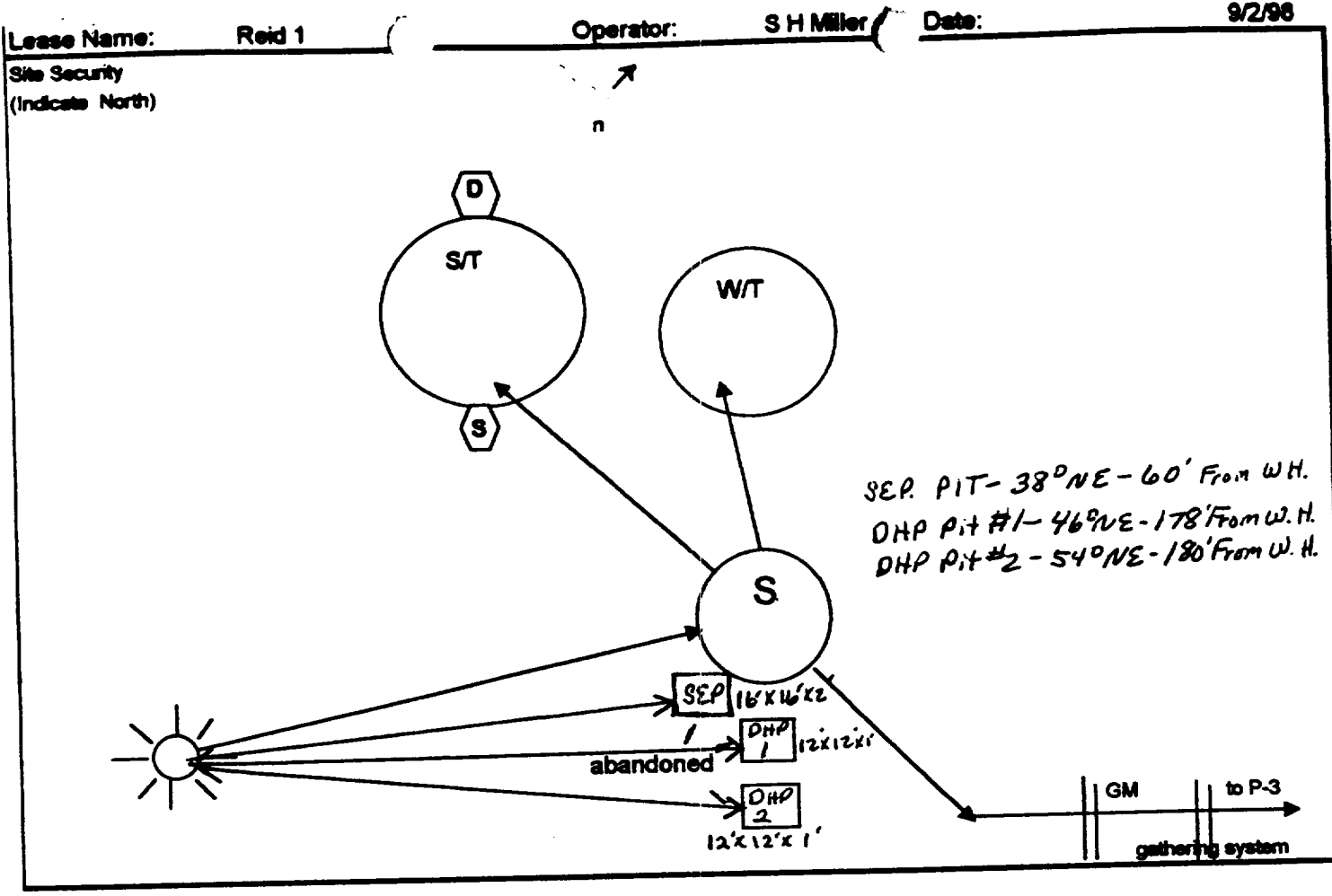

Lease Name: Reid 1

Federal/ Indian Lease No: _____

CA No.: _____

Unit : M

Legal Description: Sec: 13 T: 29N R: 12W

County: San Juan, NM

Load line valves :
Sealed during Production

Drain line valves :
Sealed during Production

Production Line valve:
Sealed during sales

This lease is subject to the site security plan for San Juan Basin Operations. The plan is located at:
Conoco Inc.
3315 Bloomfield Hwy
Farmington, NM



REID 1 Dch. Pit # 1

12' X 12' X 1'

46° NE 178' From WH.

	Time	P.P.M
Center -	0927	176
South -	0929	6
North -	0930	6
East -	0931	5
West. -	0932	4

Soil Real Sandy

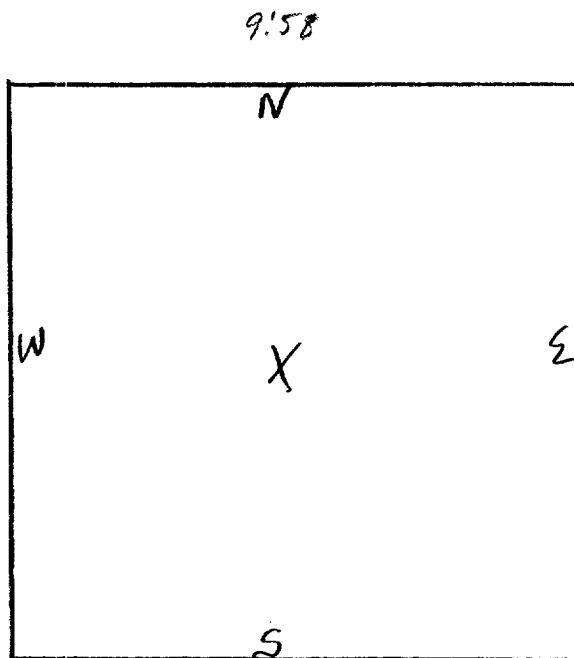

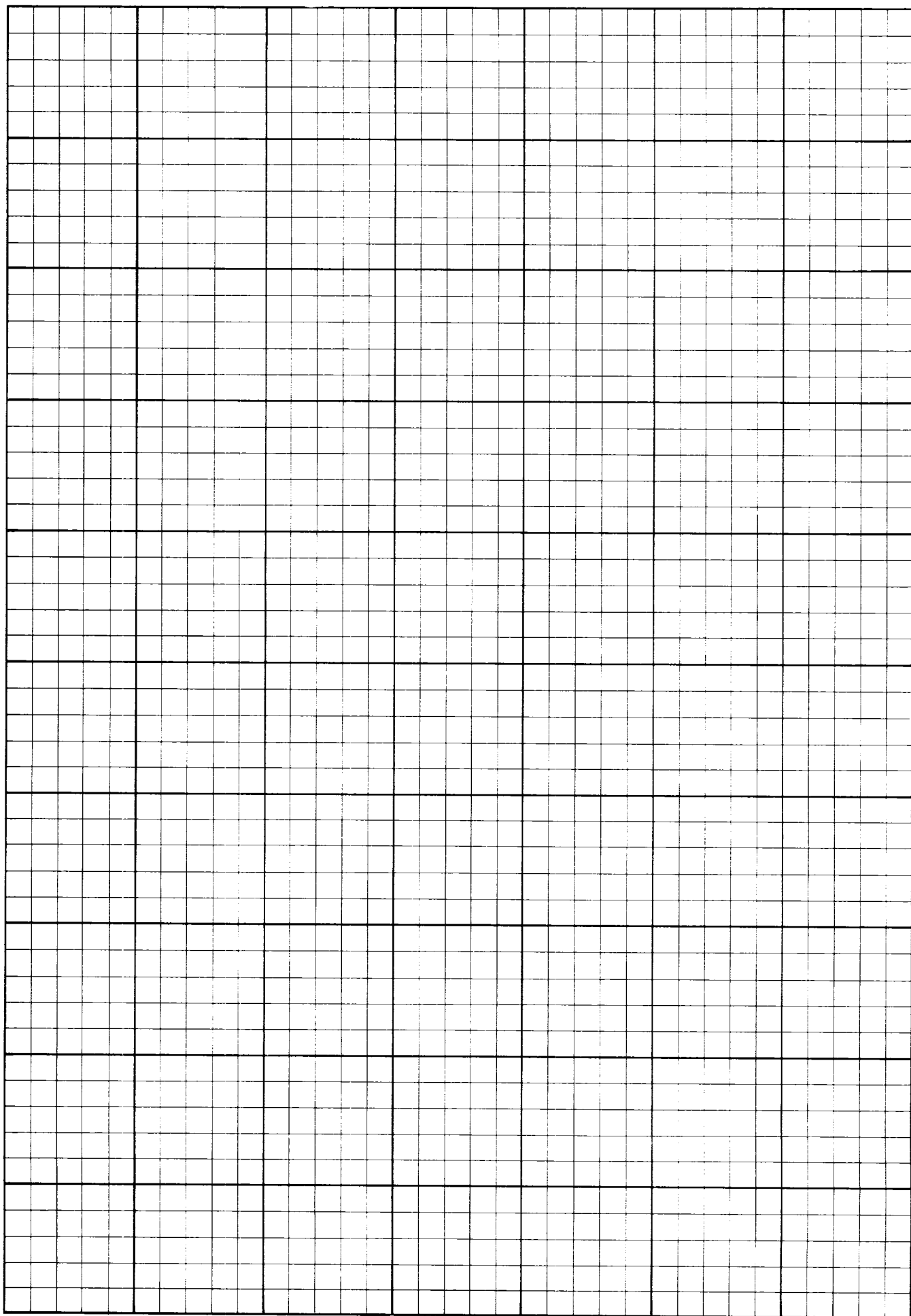

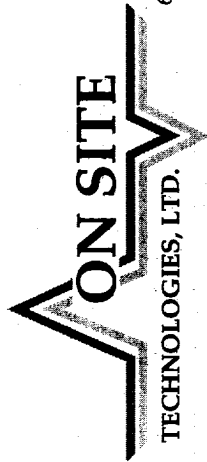

CHAIN OF CUSTODY RECORD

5671

Date: 2-3-99

Page 1 of 1

657 W. Maple • P. O. Box 2606 • Farmington NM 87499
LAB: (505) 325-5667 • FAX: (505) 325-6256

Purchase Order No.:		Job No.	
Name <u>Shirley Ebert</u>		Title	
Company <u>Coxco Inc.</u>		Company	
Address <u>3315 Blountfield Hwy</u>		Mailing Address	
City, State, Zip <u>Farmington N.M. 87401</u>		City, State, Zip	
Sampling Location: <u>Reid 1</u>		Telephone No.	
<u>DHP #1</u>		Telefax No.	
Sampler: <u>Judson Valdez</u>		ANALYSIS REQUESTED	
SEND INVOICE TO		RESULTS TO	
SAMPLE IDENTIFICATION		Number of Containers	
NAME		DATE	
TIME		MATRIX	
PRES.			
<u>Center of Pt</u>		<u>2-3-99 0912</u>	
<u>South Wall</u>		<u>2-3-99 0929</u>	
<u>North Wall</u>		<u>2-3-99 0930</u>	
<u>East Wall</u>		<u>2-3-99 0931</u>	
<u>West Wall</u>		<u>2-3-99 0932</u>	
<u>4 Ft. Composite</u>		<u>2-3-99</u>	
Date/Time		Date/Time	
Received by: <u>Judson Valdez</u>		Received by: <u>Heidi Rogers</u>	
Date/Time		Date/Time	
Received by:		Received by:	
Date/Time		Date/Time	
Rush		10 Working Days	
Special Instructions:			
Authorized by: _____		Date _____	
(Client Signature Must Accompany Request)			
Distribution: White - On Site		Yellow - LAB	
Pink - Sampler		Goldenrod - Client	

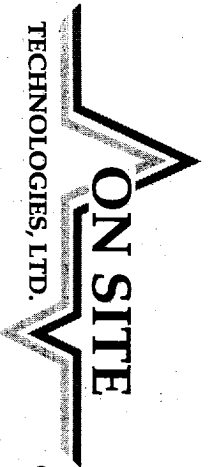

657 W. Maple • P. O. Box 2606 • Farmington NM 87499
LAB: (505) 325-5667 • FAX: (505) 325-6256

CHAIN OF CUSTODY RECORD

5671

Date: 2-3-99

Page 1 of 1

Purchase Order No.:		Job No.	
Name: <u>Shirley Ebert</u>		Title:	
Company: <u>Genco Inc.</u>		Company:	
Address: <u>3315 Thompson Hwy</u>		Mailing Address:	
City, State, Zip: <u>Farmington N.M. 87401</u>		City, State, Zip:	
Telephone No.:		Telefax No.:	
SEND INVOICE TO			
Sampling Location: <u>Reid 1</u>			
<u>DHP # 1</u>			
Sampler: <u>Judson Valdez</u>			
SAMPLE IDENTIFICATION		Number of Containers	
DATE		TIME	
MATRIX		PRES.	
LAB ID			
ANALYSIS REQUESTED			
Relinquished by: <u>Judson Valdez</u>		Received by: <u>Mark Lee</u>	
Date/Time: <u>2-3-99 1446</u>		Date/Time: <u>2-3-99 1446</u>	
Relinquished by:		Received by:	
Date/Time:		Date/Time:	
Relinquished by:		Received by:	
Date/Time:		Date/Time:	
Method of Shipment:		Rush	
Authorized by:		24-48 Hours	
(Client Signature Must Accompany Request)		10 Working Days	
Date:		Special Instructions:	

DATE	TIME	MATRIX	PRES.	LAB ID
2/3/99	0717	SOIL	WWT	2
2/3/99	0925	SOIL	WWT	6
2/3/99	0930	SOIL	WWT	6
2/3/99	0931	SOIL	WWT	5
2/3/99	0932	SOIL	WWT	4
2/3/99		SOIL	WWT	2

over Appaling

OFF: (505) 325-5667



LAB: (505) 325-1556

February 24, 1999

Shirley Ebert
Conoco, Inc.
3315 Bloomfield Hwy
Farmington, NM 87401
TEL: (505) 324-5813
FAX (505) 324-5825

RE: Reid 1 DHP #1

Order No.: 9902033

Dear Shirley Ebert,

On Site Technologies, LTD. received 2 samples on 2/3/99 for the analyses presented in the following report.

The Samples were analyzed for the following tests:

- BTEX (SW8021B)
- Diesel Range Organics (SW8015)
- Gasoline Range Organics (SW8015)

There were no problems with the analyses and all data for associated QC met EPA or laboratory specifications except where noted in the Case Narrative.

If you have any questions regarding these tests results, please feel free to call.

Sincerely,

A handwritten signature in black ink, appearing to read "David Cox", is written over a horizontal line.

David Cox

OFF: (505) 325-5667



LAB: (505) 325-1556

On Site Technologies, LTD.

Date: 24-Feb-99

CLIENT: Conoco, Inc.
Project: Reid 1 DHP #1
Lab Order: 9902033

CASE NARRATIVE

Samples were analyzed using the methods outlined in the following references:

Test Methods for Evaluating Solid Waste, Physical/Chemical Methods, SW846, 3rd Edition

All method blanks, laboratory spikes, and/or matrix spikes met quality assurance objectives.

OFF: (505) 325-5667



LAB: (505) 325-1556

ANALYTICAL REPORT

Date: 24-Feb-99

Client:	Conoco, Inc.	Client Sample Info:	Reid 1 DHP #1
Work Order:	9902033	Client Sample ID:	Center of Pit
Lab ID:	9902033-01A	Matrix:	SOIL
Project:	Reid 1 DHP #1	Collection Date:	2/3/99 9:27:00 AM
		COC Record:	5671

Parameter	Result	PQL	Qual	Units	DF	Date Analyzed
DIESEL RANGE ORGANICS		SW8015				Analyst: DC
T/R Hydrocarbons: C10-C28	54	25		mg/Kg	1	2/23/99
GASOLINE RANGE ORGANICS		SW8015				Analyst: HR
T/R Hydrocarbons: C6-C10	0.23	0.13		mg/Kg	1	2/6/99
BTEX		SW8021B				Analyst: HR
Benzene	ND	1		µg/Kg	1	2/9/99
Toluene	ND	2		µg/Kg	1	2/9/99
Ethylbenzene	3.6	1		µg/Kg	1	2/9/99
m,p-Xylene	19	2		µg/Kg	1	2/9/99
o-Xylene	5.4	1		µg/Kg	1	2/9/99

Qualifiers:	PQL - Practical Quantitation Limit	S - Spike Recovery outside accepted recovery limits
	ND - Not Detected at Practical Quantitation Limit	R - RPD outside accepted recovery limits
	J - Analyte detected below Practical Quantitation Limit	E - Value above quantitation range
	B - Analyte detected in the associated Method Blank	Surr: - Surrogate

1 of 1

P.O. BOX 2606 • FARMINGTON, NM 87499

- TECHNOLOGY BLENDING INDUSTRY WITH THE ENVIRONMENT -

OFF: (505) 325-5667



LAB: (505) 325-1556

ANALYTICAL REPORT

Date: 24-Feb-99

Client:	Conoco, Inc.	Client Sample Info:	Reid 1 DHP #1
Work Order:	9902033	Client Sample ID:	4pt. Composite
Lab ID:	9902033-02A	Matrix:	SOIL
Project:	Reid 1 DHP #1	Collection Date:	2/3/99 9:30:00 AM
		COC Record:	5671

Parameter	Result	PQL	Qual	Units	DF	Date Analyzed
DIESEL RANGE ORGANICS		SW8015				Analyst: DC
T/R Hydrocarbons: C10-C28	ND	25		mg/Kg	1	2/23/99
GASOLINE RANGE ORGANICS		SW8015				Analyst: HR
T/R Hydrocarbons: C6-C10	ND	0.13		mg/Kg	1	2/6/99

Qualifiers:

PQL - Practical Quantitation Limit

ND - Not Detected at Practical Quantitation Limit

J - Analyte detected below Practical Quantitation Limit

B - Analyte detected in the associated Method Blank

S - Spike Recovery outside accepted recovery limits

R - RPD outside accepted recovery limits

E - Value above quantitation range

Surr: - Surrogate

1 of 1

P.O. BOX 2606 • FARMINGTON, NM 87499

- TECHNOLOGY BLENDING INDUSTRY WITH THE ENVIRONMENT -