

State of New Mexico  
Energy, Minerals and Natural Resources Department  
Oil Conservation Division

Sundry Notices and Reports on Wells

1. Type of Well  
GAS

2. Name of Operator  
**MERIDIAN OIL**

3. Address & Phone No. of Operator  
PO Box 4289, Farmington, NM 87499 (505) 326-9700

4. Location of Well, Footage, Sec., T, R, M  
990'FSL, 990'FWL, Sec.16, T-29-N, R-10-W, NMPM, San Juan County

API # (assigned by OCD)  
30-045-08228

5. Lease Number

6. State Oil&Gas Lease #  
B-11303-15

7. Lease Name/Unit Name  
Schultz Com B

8. Well No.  
6

9. Pool Name or Wildcat  
Basin Fruitland Coal  
Aztec Pictured Cliffs

10. Elevation:

Type of Submission

☒ Notice of Intent  
☐ Subsequent Report  
☐ Final Abandonment

Type of Action

☒ Abandonment  
☒ Recompletion  
☐ Plugging Back  
☐ Casing Repair  
☐ Altering Casing  
☐ Other -  
☐ Change of Plans  
☐ New Construction  
☐ Non-Routine Fracturing  
☐ Water Shut off  
☐ Conversion to Injection

13. Describe Proposed or Completed Operations

It is intended to recomplete the Fruitland Coal zone of the subject well by perforating and fracture stimulating according to the attached procedure and wellbore diagram. Production from the Pictured Cliffs and Fruitland Coal will then be commingled. Application is being made to the New Mexico Oil Conservation Division for commingling.

RECEIVED  
JAN 12 1995  
OIL CON. DIV.  
DIST. 3

SIGNATURE  (JCC2) Regulatory Affairs January 11, 1995

(This space for State Use)

Approved by ORIGINAL SIGNED BY ERNIE BUSCH Title DEPUTY OIL & GAS INSPECTOR, DIST. #3

Date JAN 12 1995

District I  
PO Box 1980, Hobbs, NM 88241-1980  
District II  
PO Drawer DD, Artesia, NM 88211-0719  
District III  
1000 Rio Brazos Rd., Aztec, NM 87410  
District IV  
PO Box 2088, Santa Fe, NM 87504-2088

State of New Mexico  
Energy, Minerals & Natural Resources Department

OIL CONSERVATION DIVISION  
PO Box 2088  
Santa Fe, NM 87504-2088

Form C-1  
Revised February 21, 1995  
Instructions on back  
Submit to Appropriate District Office  
State Lease - 4 Copies  
Fee Lease - 3 Copies

☐ AMENDED REPORT

WELL LOCATION AND ACREAGE DEDICATION PLAT

API Number 30-045-08228		Pool Code 71629/71280	Pool Name Basin Fruitland Coal/Aztec Pictured Cliffs
Property Code 7483	Property Name SCHULTZ COM. B		Well Number 6
OGRID No. 14538	Operator Name MERIDIAN OIL INC.		Elevation 5712'

10 Surface Location

UL or lot no. M	Section 16	Township 29-N	Range 10-W	Lot Idn	Feet from the 990	North/South line SOUTH	Feet from the 990	East/West line WEST	County S. J.
--------------------	---------------	------------------	---------------	---------	----------------------	---------------------------	----------------------	------------------------	-----------------

11 Bottom Hole Location If Different From Surface

UL or lot no.	Section	Township	Range	Lot Idn	Feet from the	North/South line	Feet from the	East/West line	County
---------------	---------	----------	-------	---------	---------------	------------------	---------------	----------------	--------

12 Dedicated Acres W/320-160	13 Joint or Infill	14 Consolidation Code	15 Order No.
---------------------------------	--------------------	-----------------------	--------------

NO ALLOWABLE WILL BE ASSIGNED TO THIS COMPLETION UNTIL ALL INTERESTS HAVE BEEN CONSOLIDATED  
OR A NON-STANDARD UNIT HAS BEEN APPROVED BY THE DIVISION

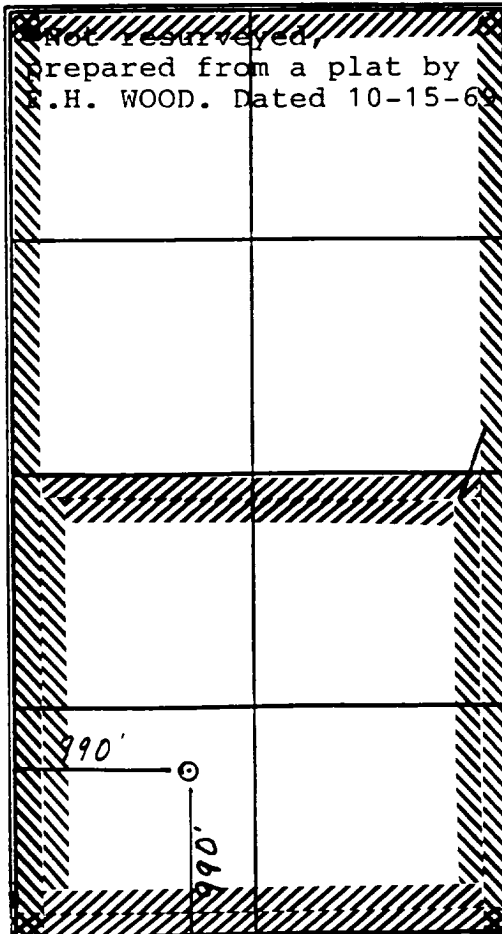

17 OPERATOR CERTIFICATION

I hereby certify that the information contained herein is true and complete to the best of my knowledge and belief.

  
Signature  
Peggy Bradfield  
Printed Name  
Regulatory Affairs  
Title  
1-11-95  
Date

18 SURVEYOR CERTIFICATION

I hereby certify that the well location shown on this plat was plotted from field notes of actual surveys made by or under my supervision, and that the same is true and correct to the best of my belief.

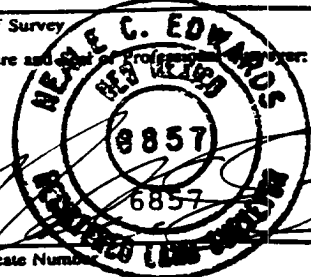
1-11-95  
Date of Survey  
Signature and Seal of Professional Surveyor  
  
Certificate Number

### Pertinent Data Sheet - Schultz Com B #6

**Location:** 990' FSL, 990' FWL. Unit M, Section 16, T29N, R10W, San Juan County, New Mexico

**Field:** Aztec Pictured Cliffs

**Elevation:** 5724' DF

**TD:** 2127'

**PBTD:** 2127'

**Completed:** 09-15-56

**Spud Date:** 09-02-56

**DP #:** 51061A

#### **Casing Record:**

<u>Hole Size</u>	<u>Csg Size</u>	<u>Wt. &amp; Grade</u>	<u>Depth Set</u>	<u>Cement</u>	<u>Top/Cement</u>
11"	8 5/8"	24.0# J-55	100'	70 sxs	Circ/Surface
7 7/8"	5 1/2"	13.7#/15.5# J-55	2052'	100 sxs	

#### **Tubing Record:**

<u>Tbg Size</u>	<u>Wt. &amp; Grade</u>	<u>Depth Set</u>
1"		2104'

#### **Formation Tops:**

Ojo Alamo:	805'
Kirtland:	970'
Fruitland:	1690'
Pictured Cliffs:	2062'

**Logging Record:** I-ES, GR-Density

#### **Stimulation:**

Well was shot w/150 quarts of nitroglycerine from 2068' to 2127', then SOF 2052' to 2127'. Sand frac'd from 2052' to 2127' w/20,000# sand & 17,750 gal diesel oil. Flush w/2,250 gal diesel.

#### **Workover History:**

#### **Production History:**

**Transporter:** EPNG

# SCHULTZ COM B #6

CURRENT

AZTEC PICTURED CLIFFS (GAS)

SEC 16, T29N, R10W, SAN JUAN COUNTY, NM

COMPLETED  
09/15/56

8-5/8" 24# J-55 CSG SET @ 100'  
CMT TO SURFACE

OJO ALAMO @ 805'

KIRTLAND @ 970'

1" TBG SET @ 2104'

FRUITLAND @ 1690'

TOC UNKNOWN

PICTURED CLIFFS @ 2062'

5-1/2" 15.5# EW CSG SET @ 2052'  
CMT W/ 100 SXS

SHOT HOLE W/ 150 QTS NITRO  
GLYCERIN FROM 2068' - 2127'  
FRAC'D 2052' - 2127' W/ 30,000 SND &  
17,750 GAL DIESEL

TD  
2127'

# SCHULTZ COM B #6

PROPOSED  
BASIN FRUITLAND COAL  
SEC 16, T29N, R10W, SAN JUAN COUNTY, NM

COMPLETED  
09/15/56

OJO ALAMO @ 805'

KIRTLAND @ 970'

FRUITLAND @ 1690'

PICTURED CLIFFS @ 2062'

8-5/8" 24# J-55 CSG SET @ 100'  
CMT TO SURFACE

2-3/8" TBG SET @ 2029'

TOC UNKNOWN

PERF 1877' - 1895', 1936' - 1943',  
1947' - 1952' W/ 2SPF

PERF 1984' - 1989', 1996' - 2002',  
2016' - 2029', 2037' - 2040' W/ 2 SPF

CIBP SET @ 2049'  
5-1/2" 15.5# EW CSG SET @ 2052'  
CMT W/ 100 SXS

SHOT HOLE W/ 150 QTS NITRO  
GLYCERIN FROM 2068' - 2127'  
FRAC'D 2052' - 2127' W/ 30,000 SND &  
17,750 GAL DIESEL

TD  
2127'

**SCHULTZ COM B #6**  
**SW/4 Section 16 T29N R10W**  
**Recommended Completion Procedure**

1. Test rig anchors and repair if necessary. Install 1-400 bbl frac tank on location and fill with 2% KCl water. Filter all water to 25 microns. Heat water as required by weather.
2. MOL and RU. Comply to all NMOC, BLM and MOI rules and regulations. Hold safety meeting. ND wellhead. NU BOP. Test operation of rams. NU two relief lines.
3. TOOH laying down 2104' of 1" tubing, tally and inspect.
4. TIH with 2-7/8" N-80 tubing and 4-3/4" bit and clean out to TD at 2127'. TOOH.
5. TIH with 2-7/8" N-80 tubing, 5-1/2" casing scraper and 4-3/4" bit and clean out to 2052'. TOOH.
6. TIH with 2-7/8" tubing, 5-1/2" packer and set at 2049'. Pump 600 gals. of 15% HCl, using 500 scf N<sub>2</sub>/bbl. Job will be pumped at 3 to 4 bbls/min. Shut in for 1 hour. Flow to pit and check for spent acid. Take Pitot Gauge. TOOH.
7. RIH and wireline set 5-1/2" CIBP at 2049'. Load hole with water.
8. RU and RIH with CNL-CCL-GR and log from 2049' to 49'.
9. Run CBL from CIBP at 2049' to surface. If CBL appears inadequate, re-run log with 500 psi surface pressure. If bond still appears unacceptable, contact production engineering. Send copy of CBL to production engineering and drilling.

**\*\*\* LOWER COAL \*\*\***

10. TIH with 5-1/2" fullbore packer and 2-7/8" N-80 tubing and set packer at 1884'. Load hole with 2% KCl water and test CIBP and casing to 3500 psi for 15 minutes. Test tubing / casing annulus to 500 psi for 15 minutes. Equalize pressure and unseat packer. TOOH.
11. RU wireline and perforate the following coal interval with a Select Fire 3-1/8" HSC with 10.0 gram charges, 0.30 holes at 2 SPF (correlate depths to CNL-CCL-GR log). Prior to perforating, review with production engineering.

1984' - 1989'  
1996' - 2002'  
2016' - 2029'  
2037' - 2040'

Total: 27 feet - 54 holes.

12. TIH with 5-1/2" fullbore packer on 2-7/8" N-80 tubing and set packer at 1884'.

**SCHULTZ COM B #6**  
**SW/4 Section 16 T29N R10W**  
**Recommended Completion Procedure**  
**Page 2**

13. RU treatment company for frac. Hold safety meeting with all personnel. Pressure test surface lines to 5000 psi. Pump 200 gals. of 15% HCl ahead of frac. Fracture treat procedure will be available prior to treatment. Tag sand with 0.4 mCi/1000# of Ir-192 tracer. Flush with 9 bbls of 2% KCl water. **MAXIMUM PRESSURE IS LIMITED TO 3500 PSI!** Monitor backside and braden head pressures during frac. Monitor bottomhole and surface treating pressure, rate, foam quality and sand concentration with computer van. Frac during daylight only.
14. SI well for 2 hours for gel break.
15. After gel break, open well through choke manifold and monitor flow. Flow at 20 bbls/hr, or less if sand is observed.
16. When well ceases to flow, TOOH with 2-7/8" tubing and packer.
17. TIH with 2-7/8" N-80 tubing and notched collar and clean out to 2049'. TOOH.
18. TIH and set 5-1/2" RBP at 1972' with wireline.
19. Refill 400 bbl frac tank with 2% KCl water and filter to 25 microns. Heat water as required by weather.

**\*\*\* UPPER COAL \*\*\***

20. TIH with 5-1/2" fullbore packer and 2-7/8" N-80 tubing and set packer at 1777'. Load hole with 2% KCl water and test RBP and casing to 3500 psi for 15 minutes. Test tubing / casing annulus to 500 psi for 15 minutes. Equalize pressure and unseat packer. TOOH.
21. RU wireline and perforate the following coal interval with a Select Fire 3-1/8" HSC with 10.0 gram charges, 0.30 holes at 2 SPF (correlate depths to CNL-CCL-GR log). Prior to perforating, review with production engineering.

**1877' - 1895'**

**1936' - 1943'**

**1947' - 1952'**

Total: 30 feet - 60 holes.

22. TIH with 5-1/2" fullbore packer on 2-7/8" N-80 tubing and set packer at 1777'.
23. RU treatment company for frac. Hold safety meeting with all personnel. Pressure test surface lines to 5000 psi. Fracture treat procedure will be available prior to treatment. Tag sand with 0.4 mCi/1000# of Ir-192 tracer. Flush with 9 bbls of 2% KCl water. **MAXIMUM PRESSURE IS LIMITED TO 3500 PSI!** Monitor backside and braden head pressures during frac. Monitor bottomhole and surface treating pressure, rate, foam quality and sand concentration with computer van. Frac during daylight only.

**SCHULTZ COM B #6**  
SW/4 Section 16 T29N R10W  
Recommended Completion Procedure  
Page 3

24. SI well for 2 hours for gel break.
25. After gel break, open well through choke manifold and monitor flow. Flow at 20 bbls/hr, or less if sand is observed.
26. When well ceases to flow, TOOH with 2-7/8" tubing and packer.
27. TIH with 2-7/8" N-80 tubing and retrieving head and clean out upper coal zone until sand flow stops. **Take Pitot gauge before releasing BP.** Release RBP set at 1972' and TOOH.
28. TIH with notched collar on 2-7/8" N-80 tubing and clean out lower coal zone until sand flow stops. **Take Pitot gauge.** TOOH.
29. RU wireline and run After - Frac log from 2049' to top of tracer activity.
30. TIH with 2029' of 2-3/8" tubing with standard seating nipple one joint off bottom and pump-off plug on bottom. Land tubing string.
31. ND BOP and NU independent wellhead. Pump off plug. **Take final Pitot gauge.** Rig down and release rig.
32. Will move back on location and drill CIBP set at 2049' when appropriate regulatory approval is received.

Approve:

  
P. W. Bent

**VENDORS:**

Wireline:	Petro	325-6669
Fracturing:	Western	327-6222
R.A. Tagging:	Protechnics	326-7133
Tools:	Schlumberger	325-5006
Production Engineer:	Office	326-9703
	Home	326-2381

LJB