

04
George S. Frost
DEPT. OF THE INTERIOR
BUREAU OF LAND MANAGEMENT
DISTRICT III
300 Rio Brazos Road, Santa Fe, NM 87505
DEC 17 1998

State of New Mexico
Energy, Minerals and Natural Resources Department

OIL CONSERVATION DIVISION

2040 South Pacheco Street
Santa Fe, New Mexico 87505

SUBMIT 1 COPY TO
APPROPRIATE
DISTRICT OFFICE
AND 1 COPY TO
SANTA FE OFFICE

PIT REMEDIATION AND CLOSURE REPORT

RECEIVED
JUL 31 1998
OIL CON. DIV.
DIST. 3

Approved

Operator: PNM Gas Services (Burlington) Telephone: 324-3764

Address: 603 W. Elm Street Farmington, NM 87401

Facility or Well Name: McDaniel B #1

Location: Unit M Sec 17 T 29 N R 11 W County San Juan

Pit Type: Separator ☒ Dehydrator ☐ Other ☐

Land Type: BLM ☐ State ☐ Fee ☒ Other ☐

Pit Location: Pit dimensions: length 25 width 25 depth 3

(Attach diagram) Reference: wellhead ☒ other ☐

Footage from reference: 117'

Direction from reference: 20 Degrees ☐ East ☒ North ☐ South ☒ West

Depth to Ground Water: (Vertical distance from contaminants to seasonal high water elevation of ground water)	Less than 50 feet	(20 points)	
	50 feet to 99 feet	(10 points)	
	Greater than 100 feet	(0 points)	<u>20</u>
Wellhead Protection Area: (Less than 200 feet from a private domestic water source, or, less than 1,000 feet from all other water sources)			
	Yes	(20 points)	
	No	(0 points)	<u>0</u>
Distance to Surface Water: (Horizontal distance to perennial lakes, ponds, rivers, streams, creeks, irrigation canals and ditches)			
	Less than 200 feet	(20 points)	
	200 feet to 1,000 feet	(10 points)	
	Greater than 1,000 feet	(0 points)	<u>20</u>
RANKING SCORE (TOTAL POINTS):			<u>40</u>

Date Remediation Started: 5/5/98 Date Completed: 5/7/98

Remediation Method: Excavation X Approx. Cubic Yard 286
(Check all appropriate sections) Landfarmed X Amount Landfarmed (cubic yds) 286
Other _____

Remediation Location: Onsite X Offsite _____
(i.e., landfarmed onsite, name and location of offsite facility)

Backfill Material Location: _____

General Description of Remedial Action:

Excavated contaminated soil to a pit size of 21' X 23' X 16' and landfarmed soil onsite within a bermed area at a depth of 6" to 12". Soil was aerated by disking/plowing until soil met regulatory levels.

*** Sandstone encountered at 16'. See attached risk analysis and lab analysis form.

Ground Water Encountered: No ☒ Yes ☐ Depth _____

Final Pit Closure Sampling:

Sample Location Bottom of excavation.

(if multiple samples, attach sample result and diagram of sample locations and depths.)

Sample depth 16'

Sample date 5/5/98 Sample time 4:00:00 PM

Sample Results

Benzene (ppm) 31.0000

Total BTEX (ppm) *** 390.0000

Field headspace (ppm) _____

TPH (ppm) 330.00 Method 8015

Vertical Extent (ft) _____ Risk Analysis form attached Yes ☒ No ☐

Ground Water Sample: Yes ☐ No ☒ (If yes, see attached Groundwater Site Summary Report)

I HEREBY CERTIFY THAT THE INFORMATION ABOVE IS TRUE AND COMPLETE TO THE BEST OF MY KNOWLEDGE AND MY BELIEF

DATE July 27, 1998

SIGNATURE

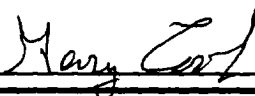

PRINTED NAME Gary Cook
AND TITLE Environmental Technician III

McDaniel B#1
Burlington Resources
Sec. 17, 29N, 11W, M

5-5-98

start:

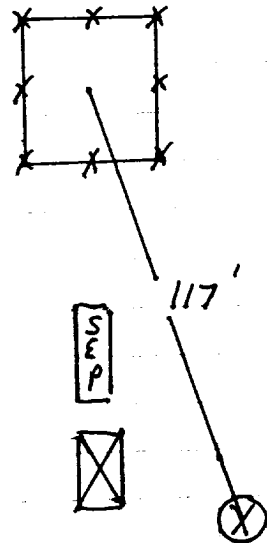

End of excavation:

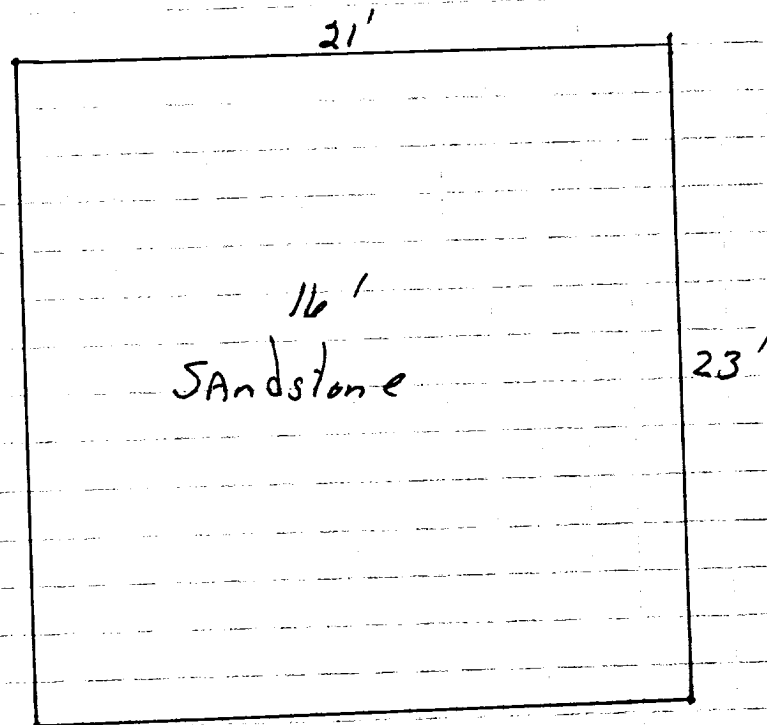

OFF: (505) 325-5667



LAB: (505) 325-1556

On Site Technologies, LTD.

Date: 15-May-98

CLIENT: PNM - Public Service Company of NM
Project: McDaniel B#1
Lab Order: 9805015

CASE NARRATIVE

Samples were analyzed using the methods outlined in the following references:

Test Methods for Evaluating Solid Waste, Physical/Chemical Methods, SW846, 3rd Edition

All method blanks, laboratory spikes, and/or matrix spikes met quality assurance objectives.

OFF: (505) 325-5667



LAB: (505) 325-1556

ANALYTICAL REPORT

Date: 15-May-98

Client: PNM - Public Service Company of NM
Work Order: 9805015
Lab ID: 9805015-01A **Matrix:** SOIL
Project: McDaniel B#1

Client Sample Info: McDaniel B#1
Client Sample ID: 9805051600; Bottom @ 16ft.
Collection Date: 5/5/98 4:00:00 PM
COC Record: 7208

Parameter	Result	PQL	Qual	Units	DF	Date Analyzed
DIESEL RANGE ORGANICS		SW8015				Analyst: HR
T/R Hydrocarbons: C10-C28	330	25		mg/Kg	1	5/13/98
BTEX		SW8020A				Analyst: DC
Benzene	31000	1000		µg/Kg	1000	5/6/98
Toluene	170000	2000		µg/Kg	1000	5/6/98
Ethylbenzene	19000	1000		µg/Kg	1000	5/6/98
m,p-Xylene	140000	2000		µg/Kg	1000	5/6/98
o-Xylene	30000	1000		µg/Kg	1000	5/6/98
	390,000					
	• 3900 ppm					

Qualifiers:

PQL - Practical Quantitation Limit
ND - Not Detected at Practical Quantitation Limit
J - Analyte detected below Practical Quantitation Limit
B - Analyte detected in the associated Method Blank

S - Spike Recovery outside accepted recovery limits
R - RPD outside accepted recovery limits
E - Value above quantitation range
Surr: - Surrogate

1 of 1

P.O. BOX 2606 • FARMINGTON, NM 87499

- TECHNOLOGY BLENDING INDUSTRY WITH THE ENVIRONMENT -

OFF: (505) 325-5667



LAB: (505) 325-1556

ANALYTICAL REPORT

Date: 15-May-98

Client: PNM - Public Service Company of NM
Work Order: 9805015
Lab ID: 9805015-02A **Matrix:** SOIL
Project: McDaniel B#1

Client Sample Info: McDaniel B#1
Client Sample ID: 9805051605; Walls @ 12ft.
Collection Date: 5/5/98 4:05:00 PM
COC Record: 7208

Parameter	Result	PQL	Qual	Units	DF	Date Analyzed
DIESEL RANGE ORGANICS						Analyst: HR
T/R Hydrocarbons: C10-C28	ND	25		mg/Kg	1	5/13/98
BTEX						Analyst: DC
Benzene	580	25		µg/Kg	25	5/6/98
Toluene	1400	50		µg/Kg	25	5/6/98
Ethylbenzene	84	25		µg/Kg	25	5/6/98
m,p-Xylene	520	50		µg/Kg	25	5/6/98
o-Xylene	290	25		µg/Kg	25	5/6/98

2.874
2.874 ppm

Qualifiers:

PQL - Practical Quantitation Limit
ND - Not Detected at Practical Quantitation Limit
J - Analyte detected below Practical Quantitation Limit
B - Analyte detected in the associated Method Blank

S - Spike Recovery outside accepted recovery limits
R - RPD outside accepted recovery limits
E - Value above quantitation range
Surr - Surrogate

1 of 1

P.O. BOX 2606 • FARMINGTON, NM 87499

TECHNOLOGY BLENDING IN JUSTICE WITH THE ENVIRONMENT

McDaniel B*,
(N) 17-29N-11W
Burlington
San Juan County
Lab Sample # 9806041045
Field Head Space 10 ppm

↑
N

WH ⊗

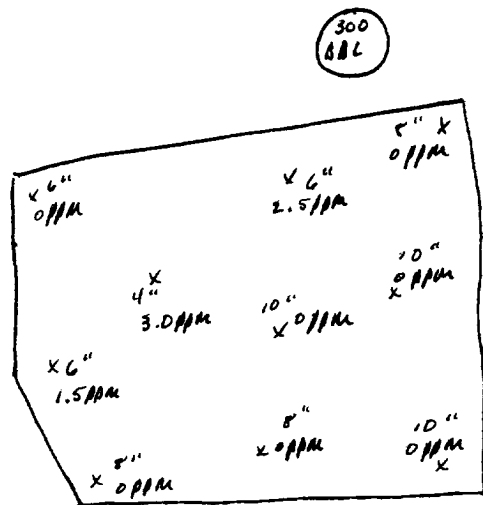

ON SITE

OFF: (505) 325-5667

LAB: (505) 325-1556

TECHNOLOGIES, LTD.

On Site Technologies, LTD.

Date: 08-Jun-98

CLIENT: PNM - Public Service Company of NM
Project: Landfarm Composites
Lab Order: 9806013

CASE NARRATIVE

Samples were analyzed using the methods outlined in the following references:

Test Methods for Evaluating Solid Waste, Physical/Chemical Methods, SW846, 3rd Edition

All method blanks, laboratory spikes, and/or matrix spikes met quality assurance objectives.

OFF: (505) 325-5667

ON SITE
TECHNOLOGIES, LTD.

LAB: (505) 325-1556

ANALYTICAL REPORT

Date: 08-Jun-98

Client:	PNM - Public Service Company of NM	Client Sample Info:	McDaniel B1
Work Order:	9806013	Client Sample ID:	9806041045; Landfarm
Lab ID:	9806013-07A	Matrix:	SOIL
Project:	Landfarm Composites	Collection Date:	6/4/98 10:45:00 AM
		COC Record:	5224

Parameter	Result	PQL	Qual	Units	DF	Date Analyzed
DIESEL RANGE ORGANICS		SW8015				Analyst: HR
T/R Hydrocarbons: C10-C28	ND	25		mg/Kg	1	6/5/98

Qualifiers:

PQL - Practical Quantitation Limit
ND - Not Detected at Practical Quantitation Limit
J - Analyte detected below Practical Quantitation Limit
B - Analyte detected in the associated Method Blank

S - Spike Recovery outside accepted recovery limits
R - RPD outside accepted recovery limits
E - Value above quantitation range
Surr: - Surrogate

1 of 1

P.O. BOX 2606 • FARMINGTON, NM 87499

Well Name:	McDaniel B #1
Well Legals:	Unit M, Sec 17, T29N, R11W
Pit Type:	Separator
Horizontal Distance to Surface Water:	Greater than 1,000 feet
Groundwater Depth:	Greater than 100 feet

RISK ANALYSIS

PNM requests closure of their former pit on the McDaniel B #1 well site using a limited risk analysis based on the following conditions:

1. Groundwater is estimated to be at a depth of 152 feet based upon the elevation of the site and the elevation of the nearest "listed" or "named" river (San Juan River Canyon). (Reference: topographic map.)
2. PNM excavated 286 cubic yards of soil from the former pit. Subsurface lateral contamination has been remediated (see attached analytical results). Source removal minimizes the possibility of surface water contamination.
3. Sandstone was encountered at 16 feet below ground surface. Bedrock/sandstone provides a barrier between remaining contamination and groundwater. Vertical migration through bedrock or sandstone to groundwater is unlikely.
4. PNM excavated and performed remediation to the maximum depth and horizontal extent practicable.

PNM believes their former pit on the McDaniel B #1 well site poses minimal threat to groundwater, human health and the environment based upon our past experience in excavating over 800 pits.