

Form 9-331b
(April 1962)

(SUBMIT IN TRIPLICATE)

UNITED STATES
DEPARTMENT OF THE INTERIOR
GEOLOGICAL SURVEY

Indian Agency

Allettee

Lease No. **21-00-0493-4377**

SUNDRY NOTICES AND REPORTS ON WELLS

INTENTION TO DRILL	<input checked="" type="checkbox"/>	SUBSEQUENT REPORT OF WATER SHUT-OFF
INTENTION TO CHANGE PLANS	<input type="checkbox"/>	SUBSEQUENT REPORT OF SHOOTING OR ACIDIZING
IF INTENTION TO TEST WATER SHUT-OFF	<input type="checkbox"/>	SUBSEQUENT REPORT OF ALTERING CASING
OF INTENTION TO REDRILL OR REPAIR WELL	<input type="checkbox"/>	SUBSEQUENT REPORT OF REDRILLING OR REPAIR
OF INTENTION TO SHOOT OR ACIDIZE	<input type="checkbox"/>	SUBSEQUENT REPORT OF ABANDONMENT
NOTICE OF INTENTION TO PULL OR ALTER CASING	<input type="checkbox"/>	SUPPLEMENTARY WELL HISTORY
NOTICE OF INTENTION TO ABANDON WELL	<input type="checkbox"/>	

(INDICATE ABOVE BY CHECK MARK NATURE OF REPORT, NOTICE, OR OTHER DATA)

Well No. **1** is located **990** ft. from **[N]** line and **903** ft. from **[E]** line of sec **36**
SW 1/4 Section 36 (Range) **29N** (Meridian) **10W**
W124000 (Twp.) **San Juan** (County or Subdivision) **New Mexico** (State or Territory)

The elevation of the derrick floor above sea level is **5334** ft. **5334'** Ungraded Ground Level

DETAILS OF WORK

(State names of and expected depths to objective sands; show sizes, weights, and lengths of proposed casings; indicate mudding jobs, cementing points, and all other important proposed work)

Rotary drilling equipment will be used to drill to approximately 5000' to the base of the Dakota formation with the possibility that drilling will be continued to the Devonian layer at approx. 11,000'. Casing program: conductor pipe 200' of 13-3/8" OD cemented to surface. Surface pipe 200' of 9-5/8" OD cemented to surface. Production pipe required amount of 10" to 7" depending on sufficient depth and nature of pay zones. Production casing to be cemented with sufficient cement to protect all pay zones. But program to consist of native sands to 1000' from 1000' to 3000' low solids oil sands and from 3000' to total depth a low solids oil emulsion mud. Electric logs, etc. will be run prior to setting production casing or abandonment of well. Stimulation treatments such as acidizing or fracturing may be employed in completion.

I understand that this plan of work must receive approval in writing by the Geological Survey before operations may be commenced

Company **Mobile Oil & Refining Company**

Address **P. O. Box 3002**

Denver, Colorado

By **COPY (ORIGINAL SIGNED) B. M. BRAT**

Title **Dist. Supt.**

NUMBER OF COPIES RECEIVED	
DISTRIBUTION	
SANITARY	
FILE	
U.S.G.S.	
LAND OFFICE	
TRANSPORTER	OIL GAS
PRODUCTION OFFICE	
OPERATOR	

NEW MEXICO OIL CONSERVATION COMMISSION
WELL LOCATION AND ACREAGE DEDICATION PLAT
 SEE INSTRUCTIONS FOR COMPLETING THIS FORM ON THE REVERSE SIDE

FORM C-128
 Revised 5/1/57

SECTION A

Operator HUMBLE OIL & REFINING COMPANY		Lease Navajo Tract 2		Well No. 1
Unit Letter N	Section 18	Township 29 North	Range 15 West	County San Juan
Actual Footage Location of Well: 990 feet from the South line and 983 feet from the West line				
Ground Level Elev. 5334' ungraded	Producing Formation Del Norte or Devonian Garry	Pool Wildcat	Dedicated Acreage: 10 Acres	

1. Is the Operator the only owner in the dedicated acreage outlined on the plat below? YES ☒ NO ____ . ("Owner" means the person who has the right to drill into and to produce from any pool and to appropriate the production either for himself or for himself and another. (65-3-29 (e) NMSA 1935 Comp.)
2. If the answer to question one is "no," have the interests of all the owners been consolidated by communitization agreement or otherwise? YES ____ NO ____ . If answer is "yes," Type of Consolidation _____
3. If the answer to question two is "no," list all the owners and their respective interests below:

Owner	Land Description

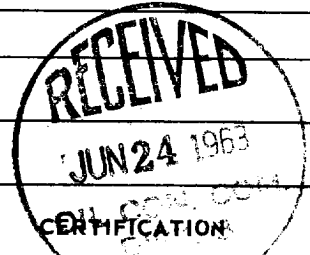

SECTION B

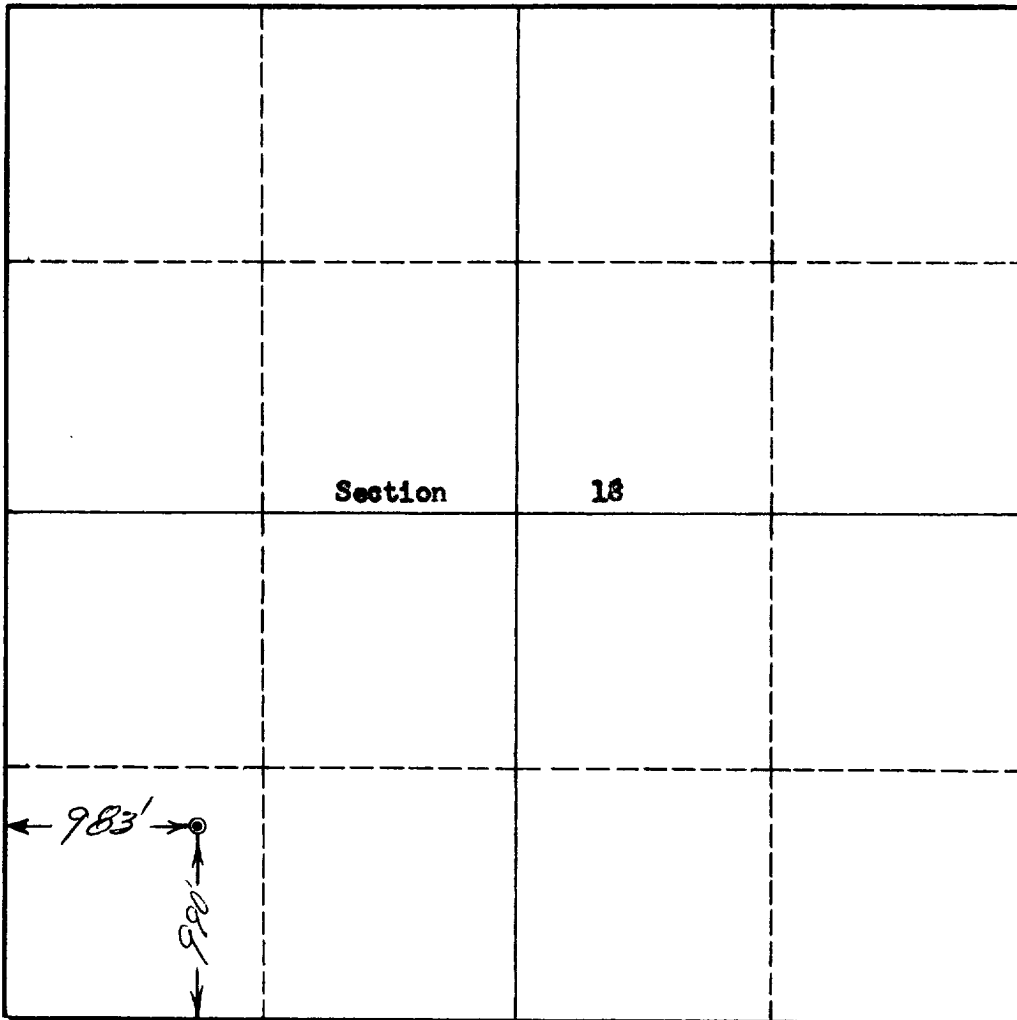

I hereby certify that the information in SECTION A above is true and complete to the best of my knowledge and belief.

COPY (ORIGINAL) B. M. BRADLEY
 SIGNED

Name
B. M. Bradley

Position
Dist. Supt.

Company
Humble Oil & Refining Co.

Date
June 17, 1963

I hereby certify that the well location shown on the plat in SECTION B was plotted from field notes of actual surveys made by me or under my supervision, and that the same is true and correct to the best of my knowledge and belief.

Date Surveyed 13 June 1963
Registered Professional Engineer and/or Land Surveyor Robert H. [Signature] No. PE & LS 2463 San Juan Engineering

