

Well Location and Survey Data

Section A.

Date April 24, 1962

Operator **PAN AMERICAN PETROLEUM CORPORATION** **Bruington Gas Unit**
 Well No. **1** Unit Letter **E** Section **14** Township **29 NORTH** Range **11 WEST** NMPM
 Located **1470** Feet From **the NORTH** **930** Feet From **the WEST** Line
 County **SAN JUAN** G. L. Elevations **320** Acres
 Name of Producing Formation **Dakota** **Basin Dakota**

1. Is the Operator the only owner in the designated acreage shown on the plat below?
 Yes ☐ No ☒ **X**
2. If the answer to question one is "No", have all owners of the acreage shown on the plat below consented by communitization agreement or otherwise? Yes ☒ **X** No ☐
3. If the answer to question two is "No", list and show the interests below:

NOTE: Pan American Petroleum Corporation holds all leases in proposed W/2 Section 14, Dakota unit except an undivided 1/12 perpetual mineral interest in E/2 NW/4 owned by El Paso Natural Gas Company who has agreed to join in the unit as well as furnishing written approval to drill the well on a lease basis prior to execution of unit instruments. Title to an undivided 1/36 interest in E/2 NW/4 is questionable but Pan American's lease covers this interest if ancillary probate proceedings are properly instituted and consummated.

Section B.

Note: All distances must be from outer boundaries of section.

This is to certify that the information in Section A above is true and complete to the best of my knowledge and belief.

Pan American Petroleum Corporation

(Operator)

R. M. Bauer, Jr. *RMB*

(Representative)

Box 480, Farmington, New Mexico

(Address)

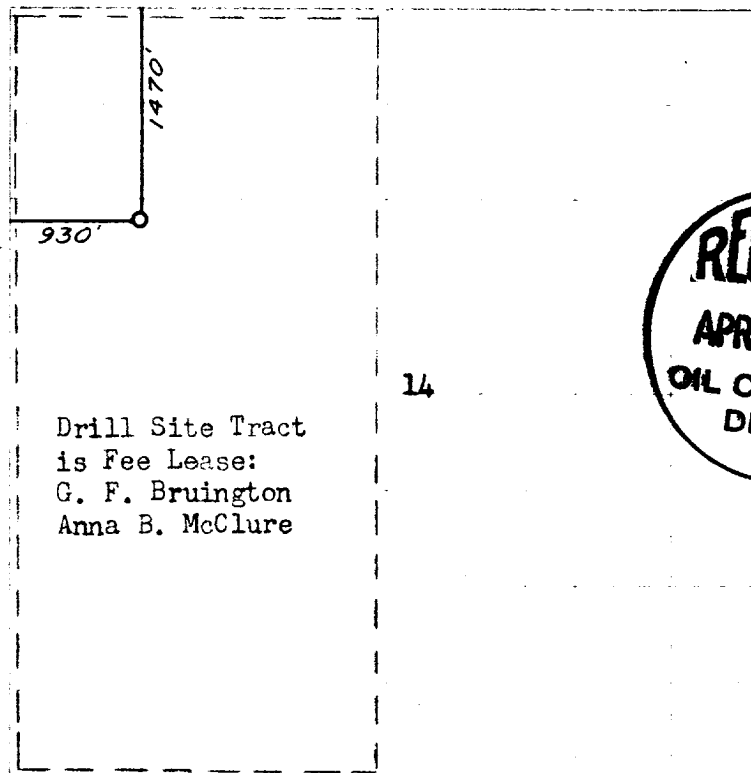

Ref: GLO plat dated 25 June 1910

Scale: 1 inch = 1 mile (equal 1 mile)

This is to certify that the plat above was prepared from field notes of actual surveys made by me or under my supervision and that the same are true and correct to the best of my knowledge and belief.

(Seal)

Date Surveyed 30 January 1962

Farmington, New Mexico

James P. Lease
 Registered Professional Engineer and/or Land Surveyor
 James P. Lease N. Mex. Reg. No. 1463
 San Juan Engineering Company