

NEW MEXICO OIL CONSERVATION COMMISSION

Well Location and Acreage Dedication Plat

Section A.

Date December 21, 1961

Operator PAN AMERICAN PETROLEUM CORPORATION Lease ROBERTS GAS UNIT
 Well No. 1 Unit Letter A Section 14 Township 29 NORTH Range 13 WEST, NMPM
 Located 1190 Feet From the NORTH Line, 820 Feet From the EAST Line
 County SAN JUAN G. L. Elevation to report later Dedicated Acreage 163 Acres
 Name of Producing Formation Dakota Pool Basin Dakota

1. Is the Operator the only owner in the dedicated acreage outlined on the plat below?
 Yes ☒ No ☐ See attached detail plat.
2. If the answer to question one is "no", have the interests of all the owners been consolidated by communitization agreement or otherwise? Yes ☐ No ☐ If answer is "yes", Type of Consolidation.

3. If the answer to question two is "no", list all the owners and their respective interests below:

Owner

Land Description

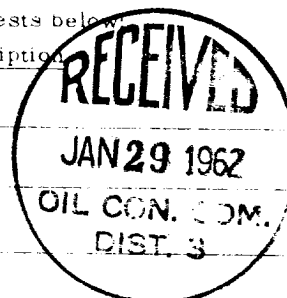

Section B.

Note: All distances must be from outer boundaries of section.

This is to certify that the information in Section A above is true and complete to the best of my knowledge and belief.

Pan American Petroleum Corp.

(Operator)

R. M. Bauer, Jr.

(Representative)

Box 480, Farmington, New Mex.

(Address)

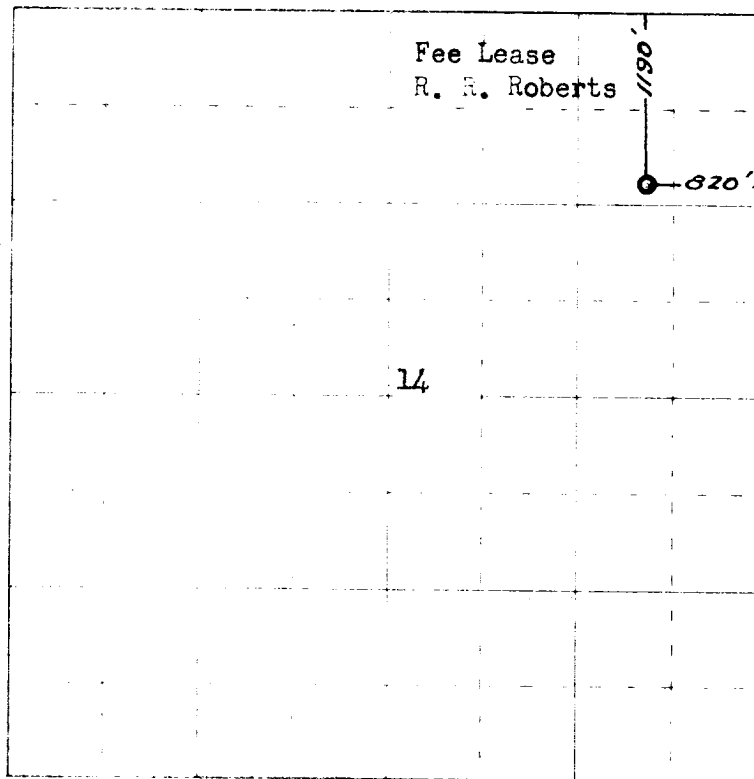

Ref: GLO plat dated 19 April 1881

Non-standard unit comprising 163 acres as outlined on attached detail plat approved by Commission Order No. R-2167.

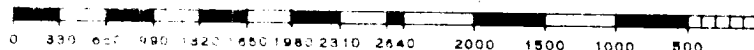

Scale 4 inches equal 1 mile

This is to certify that the above plat was prepared from field notes of actual surveys made by me or under my supervision and that the same are true and correct to the best of my knowledge and belief.

Date Surveyed 19 December 1961

James P. Leese
 Registered Professional Engineer and/or Land Surveyor
 James P. Leese N. Me. Reg. No. 1163





LTR



Job separation sheet

NUMBER OF COPIES RECEIVED	
DISTRIBUTION	
SANTA FE	
FILE	
U.S.G.S.	
LAND OFFICE	
TRANSPORTER	OIL
	GAS
PRORATION OFFICE	
OPERATOR	

NEW MEXICO OIL CONSERVATION COMMISSION
SANTA FE, NEW MEXICO
**CERTIFICATE OF COMPLIANCE AND AUTHORIZATION
TO TRANSPORT OIL AND NATURAL GAS**

FORM C-110
(Rev. 7-60)

FILE THE ORIGINAL AND 4 COPIES WITH THE APPROPRIATE OFFICE

Company or Operator PAN AMERICAN PETROLEUM CORPORATION				Lease Roberts Gas Unit "N"		Well No. 1	
Unit Letter A	Section 14	Township T-29N	Range R-13W	County San Juan			
Pool Basin Dakota				Kind of Lease (State, Fed, Fee) Fee			
If well produces oil or condensate give location of tanks		Unit Letter A	Section 14	Township T-29N	Range R-13W		
Authorized transporter of oil <input type="checkbox"/> or condensate <input checked="" type="checkbox"/>				Address (give address to which approved copy of this form is to be sent) P. O. Box 108 Farmington, New Mexico			
Plateau, Incorporated				Is Gas Actually Connected? Yes _____ No <input checked="" type="checkbox"/>			
Authorized transporter of casing head gas <input type="checkbox"/> or dry gas <input checked="" type="checkbox"/>		Date Connected	Address (give address to which approved copy of this form is to be sent) P. O. Box 480 Farmington, New Mexico Attn: T. M. Gurtis				
Pan American Gas Company							
If gas is not being sold, give reasons and also explain its present disposition:							
<p align="center">REASON(S) FOR FILING (please check proper box)</p> <p>New Well <input checked="" type="checkbox"/> Change in Ownership <input type="checkbox"/></p> <p>Change in Transporter (check one) Other (explain below)</p> <p>Oil <input type="checkbox"/> Dry Gas <input type="checkbox"/></p> <p>Casing head gas . <input type="checkbox"/> Condensate.. <input type="checkbox"/></p>							
Remarks Completed as shut in Basin Dakota well March 13, 1962.							
The undersigned certifies that the Rules and Regulations of the Oil Conservation Commission have been complied with. Executed this the <u>28th</u> day of <u>May</u> , 19 <u>63</u> .							
OIL CONSERVATION COMMISSION				By			
Approved by				Title			
Original Signed Emery C. Arnold				District Services Supervisor			
Title				Company			
Supervisor Dist. # 9				PAN AMERICAN PETROLEUM CORPORATION			
Date				Address			
MAY 29 1963				P. O. Box 480 Farmington, New Mexico Attn: L. O. Spear, Jr.			

