

(SUBMIT IN TRIPLICATE)

Indian Agency **Window Rock**

UNITED STATES  
DEPARTMENT OF THE INTERIOR  
GEOLOGICAL SURVEY

Allottee .....

Lease No. ....

Navajo Tribal Contract No. 14-20-603-1049

**SUNDRY NOTICES AND REPORTS ON WELLS**

NOTICE OF INTENTION TO DRILL.....	<input checked="" type="checkbox"/>	SUBSEQUENT REPORT OF WATER SHUT-OFF.....	
NOTICE OF INTENTION TO CHANGE PLANS.....		SUBSEQUENT REPORT OF SHOOTING OR ACIDIZING.....	
NOTICE OF INTENTION TO TEST WATER SHUT-OFF.....		SUBSEQUENT REPORT OF ALTERING CASING.....	
NOTICE OF INTENTION TO REDRILL OR REPAIR WELL.....		SUBSEQUENT REPORT OF REDRILLING OR REPAIR.....	
NOTICE OF INTENTION TO SHOOT OR ACIDIZE.....		SUBSEQUENT REPORT OF ABANDONMENT.....	
NOTICE OF INTENTION TO PULL OR ALTER CASING.....		SUPPLEMENTARY WELL HISTORY.....	
NOTICE OF INTENTION TO ABANDON WELL.....			

(INDICATE ABOVE BY CHECK MARK NATURE OF REPORT, NOTICE, OR OTHER DATA)

**August 17, 1959**, 19.....

**Navajo**

Well No. **12** is located **1650** ft. from **N** line and **990** ft. from **E** line of sec. **17**

**NE/4 Sec. 17**

(1/4 Sec. and Sec. No.)

**Shiprock-Gallup**

(Field)

**T29N**

(Twp.)

**R18W**

(Range)

**San Juan County**

(County or Subdivision)

**NMPM**

(Meridian)

**New Mexico**

(State or Territory)

The elevation of the derrick floor above sea level is **5192** ft.

**DETAILS OF WORK**

(State names of and expected depths to objective sands; show sizes, weights, and lengths of proposed casings; indicate mudding jobs, cementing points, and all other important proposed work)

**Propose to drill 8 3/4" hole from surface to ten feet. Will set 7" casing at ten feet and cement with ten sacks. Will drill 6 1/4" hole to 110 feet. Propose to set 2" tubing at 100 feet and complete if oil shows warrant.**



I understand that this plan of work must receive approval in writing by the Geological Survey before operations may be commenced.

**Universal Oil Corporation**

Company.....

Address **Box 516**

**Farmington, New Mexico**

By **Harrell Budd**

Title **President**

**NEW MEXICO OIL CONSERVATION COMMISSION**  
**WELL LOCATION AND ACREAGE DEDICATION PLAT**

FORM C-128  
 Revised 5/1/57

**SEE INSTRUCTIONS FOR COMPLETING THIS FORM ON THE REVERSE SIDE**

**SECTION A**

Operator UNIVERSAL OIL CORPORATION		Lease NAVAJO		Well No. 12
Unit Letter H	Section 17	Township 29 NORTH	Range 18 WEST	County SAN JUAN
Actual Footage Location of Well: 1650 feet from the NORTH line and 990 feet from the EAST line				
Ground Level Elev. 5192.14	Producing Formation Gallup	Pool Shiprock Gallup	Dedicated Acreage: 40 Acres	

1. Is the Operator the only owner in the dedicated acreage outlined on the plat below? YES ☒ NO ☐ . ("Owner" means the person who has the right to drill into and to produce from any pool and to appropriate the production either for himself or for himself and another. (65-3-29 (e) NMSA 1935 Comp.)
2. If the answer to question one is "no," have the interests of all the owners been consolidated by communitization agreement or otherwise? YES ☐ NO ☐ . If answer is "yes," Type of Consolidation \_\_\_\_\_
3. If the answer to question two is "no," list all the owners and their respective interests below:

Owner	Land Description

**SECTION B**

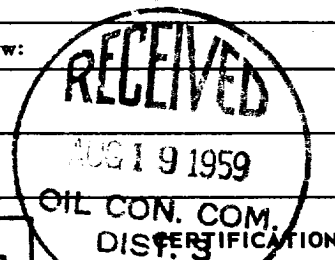
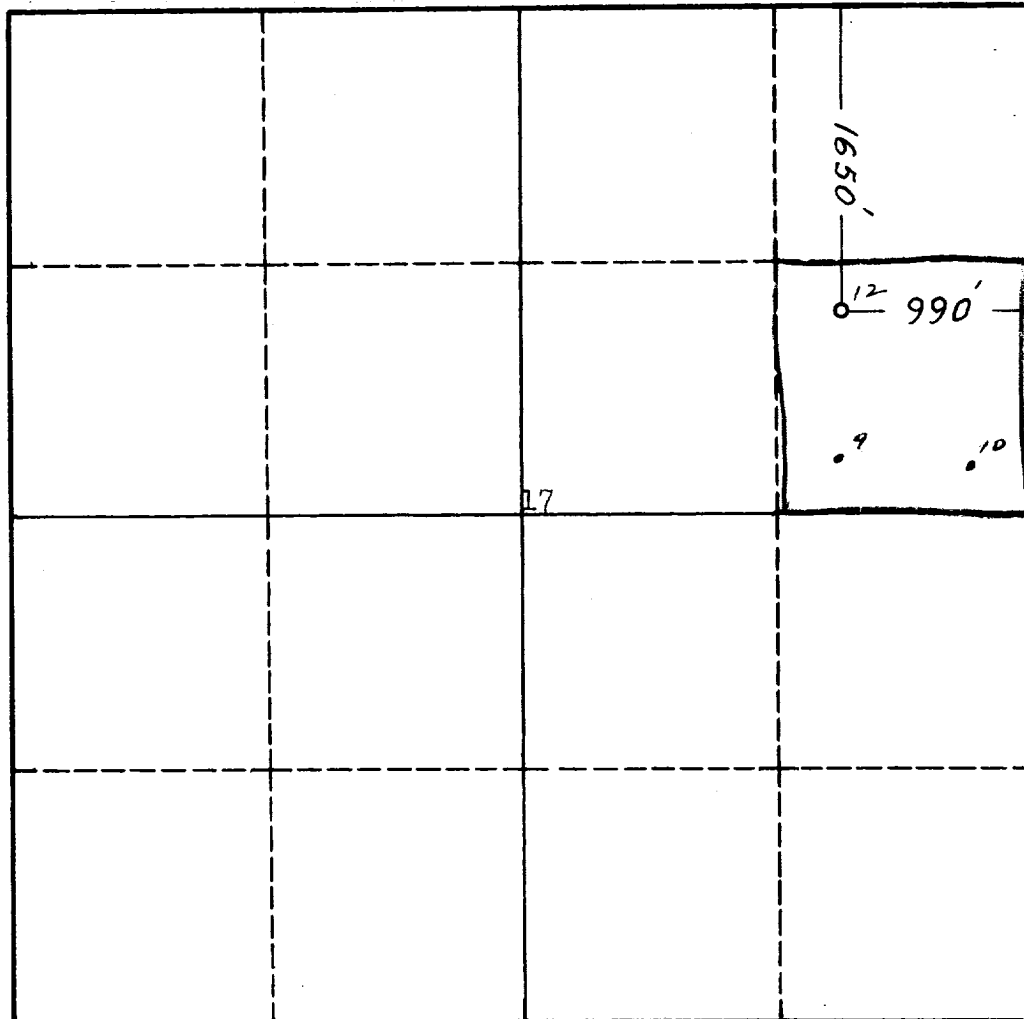

I hereby certify that the information in SECTION A above is true and complete to the best of my knowledge and belief.

Name: Harrell Budd  
 Position: President  
 Company: Universal Oil Corp  
 Date: 8/17/59

I hereby certify that the well location shown on the plat in SECTION B was plotted from field notes of actual surveys made by me or under my supervision, and that the same is true and correct to the best of my knowledge and belief.

Date Surveyed: 22 May 1959  
 Registered Professional Engineer and/or Land Surveyor:  
James P. Leese  
 Certificate No. 1463

0 330 660 990 1320 1650 1980 2310 2640 2000 1500 1000 500 0

## **INSTRUCTIONS FOR COMPLETION OF FORM C-128**

1. Operator shall furnish and certify to the information called for in Section A.
2. Operator shall outline the dedicated acreage for *both* oil and gas wells on the plat in Section B.
3. A registered professional engineer or land surveyor registered in the State of New Mexico or approved by the Commission shall show on the plat the location of the well and certify this information in the space provided.
4. All distances shown on the plat must be from the outer boundaries of the Section.
5. If additional space is needed for listing owners and their respective interests as required in question 3 of Section A, please use space below.