

UNITED STATES
DEPARTMENT OF INTERIOR
BUREAU OF LAND MANAGEMENT

SUNDRY NOTICES AND REPORTS ON WELLS

(Do not use this form for proposals to drill or to
deepen or plug back to a different reservoir.
Use Form 3160-3 for such proposals.)

1. Oil well ☐ Gas Well ☒ Other ☐

Gas Well

2. Name of Operator

Norman L. Gilbreath

3. Address & Telephone No. (505) 632-8845

Box 208, Aztec, New Mexico 87410

4. Location of Well (Footage & S.T.R.)

900' FNL 1100' FEL

A-13-29N-11W

5. Lease Designation and Serial No.

NM-03717-A

6. If Indian, Allottee or Tribe Name.

7. If Unit or CA, Agreement Designation.

8. Well Name and No.

Ben Jones #1

9. API Well No.

30-045-08392

10. Field and Pool, or Exploration Area

Aztec Pictured Cliffs Pool

11. County or Parish, State

San Juan County, New Mexico

12. CHECK APPROPRIATE BOX(es) TO INDICATE NATURE OF NOTICE, REPORT, OR OTHER DATA

☐ Notice of Intent

☐ Abandonment

☐ Change Plans

☒ Subsequent Report

☐ Recompletion

☐ New Construction

☐ Plugging Back

☐ Non-Routine Fracturing

☐ Casing Repair

☐ Water Shut-Off

☐ Final Abandonment Notice

☐ Altering Casing

☐ Conversion to Injection

☒ Other — Re-delivery into pipeline — ☐ Dispose Water

17. Describe Proposed or Completed Operations (Give Pertinent Details and Dates.)

This well was re-delivered into the El Paso Natural Gas pipeline May 10, 1994, at an estimated rate of 25 to 30 Mcfpd.

RECEIVED
MAY 18 1994

OIL DIV.
DISC 3

NOTE: This format is issued in lieu of U.S. BLM Form 3160-5.

14. I hereby certify that the foregoing is true and correct.

Signed *Norman L. Gilbreath* Title _____

Agent

ACCEPTED FOR RECORD

Date **5/12/94**

Approved by _____ Title _____

Conditions of approval, if any:

MAY 18 1994

FARMING

[Signature]

FIELD PIT SITE ASSESSMENT FORM

GENERAL	<p>Meter: <u>70101</u> Location: <u>JONES #1</u></p> <p>Operator #: _____ Operator Name: <u>GILBREATH P/L</u> District: <u>BLOOMFIELD</u></p> <p>Coordinates: Letter: <u>A</u> Section <u>13</u> Township: <u>29</u> Range: <u>11</u></p> <p>Or Latitude _____ Longitude _____</p> <p>Pit Type: Dehydrator _____ Location Drip: <u>X</u> Line Drip: _____ Other: _____</p> <p>Site Assessment Date: <u>5.18.94</u> Area: <u>10</u> Run: <u>93</u></p>
SITE ASSESSMENT	<p>NMOCD Zone: (From NMOCD Maps)</p> <p>Inside <input type="checkbox"/> (1) Outside <input checked="" type="checkbox"/> (2)</p> <p>Land Type: BLM <input checked="" type="checkbox"/> (1) State <input type="checkbox"/> (2) Fee <input type="checkbox"/> (3) Indian _____</p> <p>Depth to Groundwater</p> <p>Less Than 50 Feet (20 points) <input type="checkbox"/> (1) 50 Ft to 99 Ft (10 points) <input type="checkbox"/> (2) Greater Than 100 Ft (0 points) <input checked="" type="checkbox"/> (3)</p> <p>Wellhead Protection Area :</p> <p>Is it less than 1000 ft from wells, springs, or other sources of fresh water extraction? , or ; Is it less than 200 ft from a private domestic water source? <input type="checkbox"/> (1) YES (20 points) <input checked="" type="checkbox"/> (2) NO (0 points)</p> <p>Horizontal Distance to Surface Water Body</p> <p>Less Than 200 Ft (20 points) <input type="checkbox"/> (1) 200 Ft to 1000 Ft (10 points) <input type="checkbox"/> (2) Greater Than 1000 Ft (0 points) <input checked="" type="checkbox"/> (3)</p> <p>Name of Surface Water Body _____</p> <p>(Surface Water Body : Perennial Rivers, Major Wash, Streams, Creeks, Irrigation Canals, Ditches, Lakes, Ponds)</p> <p>Distance to Nearest Ephemeral Stream <input type="checkbox"/> (1) < 100' (Navajo Pits Only) <input type="checkbox"/> (2) > 100'</p> <p>TOTAL HAZARD RANKING SCORE: <u>0</u> POINTS</p>
REMARKS	<p>Remarks : <u>ONLY PIT ON LOCATION. PIT IS DRY. LOCATION IS ON A HILL EAST OF BLANCO PLANT. PEDLINE AND TOPO CONFIRMED LOCATION IS OUTSIDE V.Z.</u></p>

ORIGINAL PIT LOCATION

ORIGINAL PIT LOCATION

Original Pit : a) Degrees from North 256° Footage from Wellhead 87'
 b) Length : 20' Width : 18' Depth : 4'

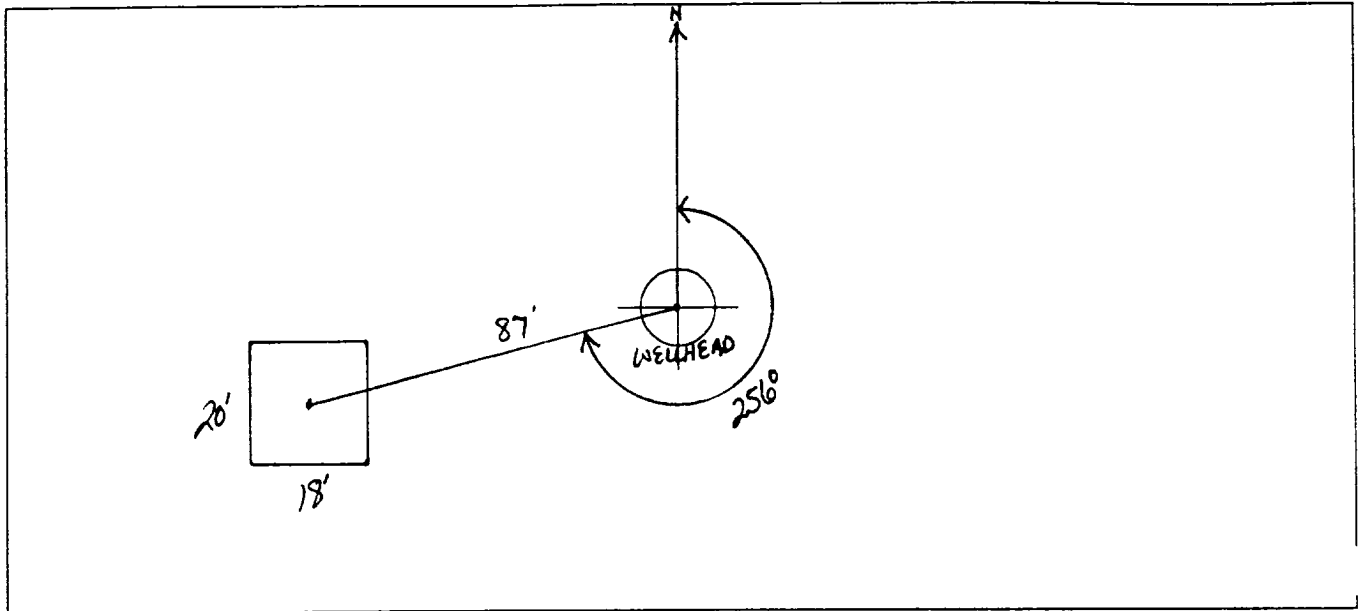

REMARKS

Remarks :

TOOK PICTURES AT 11:50 A.M.

END DUMP

Completed By:

Robert Thompson

Signature

5.18.94

Date

FIELD PIT REMEDIATION/CLOSURE FORM

GENERAL	Meter: <u>70101</u> Location: <u>JONES #1</u> Coordinates: Letter: <u>A</u> Section <u>13</u> Township: <u>29</u> Range: <u>11</u> Or Latitude _____ Longitude _____ Date Started : <u>7-15-94</u> Run: <u>10</u> <u>93</u>
FIELD OBSERVATIONS	Sample Number(s): <u>MK 144</u> Sample Depth: <u>8'</u> Feet Final PID Reading <u>248</u> PID Reading Depth <u>8'</u> Feet Yes No Groundwater Encountered <input type="checkbox"/> <input checked="" type="checkbox"/> Approximate Depth _____ Feet
CLOSURE	Remediation Method : <div style="display: flex; justify-content: space-between;"> <div> Excavation Onsite Bioremediation Backfill Pit Without Excavation </div> <div style="text-align: right;"> <input type="checkbox"/> Approx. Cubic Yards _____ <input type="checkbox"/> <input checked="" type="checkbox"/> </div> </div> Soil Disposition: <div style="display: flex; justify-content: space-between;"> <div> Envirotech Other Facility </div> <div style="text-align: right;"> <input type="checkbox"/> <input type="checkbox"/> Tierra <input type="checkbox"/> Name: _____ </div> </div> Pit Closure Date: <u>7-15-94</u> Pit Closed By: <u>BEI</u>
REMARKS	Remarks : <u>FPNG lines marked Gray Soil Slight</u> <u>Hydrocarbon odor H.T Sand stone 8'</u> _____ _____
	Signature of Specialist: <u>Morgan X. Elion</u>

**FIELD SERVICES LABORATORY****ANALYTICAL REPORT****PIT CLOSURE PROJECT - Soil****SAMPLE IDENTIFICATION**

	Field ID	Lab ID
SAMPLE NUMBER:	mk144	945694
MTR CODE SITE NAME:	70101	N/A
SAMPLE DATE TIME (Hrs):	7-15-94	1507
SAMPLED BY:	N/A	
DATE OF TPH EXT. ANAL:	7/19/94	7/19/94
DATE OF BTEX EXT. ANAL:	N/A	N/A
TYPE DESCRIPTION:	VG	Gray Clay/Sand

REMARKS:

RESULTS

PARAMETER	RESULT	UNITS	QUALIFIERS			
			DF	Q	M(g)	V(ml)
BENZENE		MG/KG				
TOLUENE		MG/KG				
ETHYL BENZENE		MG/KG				
TOTAL XYLENES		MG/KG				
TOTAL BTEX		MG/KG				
TPH (418.1)	631	MG/KG			2.19	28
HEADSPACE PID	248	PPM				
PERCENT SOLIDS	90.1	%				

- TPH is by EPA Method 418.1 and BTEX is by EPA Method 8020 -

The Surrogate Recovery was at N/A % for this sample All QA/QC was acceptable.
Narrative:

DF = Dilution Factor Used

Approved By: T.P.Date: 8/8/94

Test Method for
Oil and Grease and Petroleum Hydrocarbons
in Water and Soil
Perkin-Elmer Model 1600 FT-IR
Qualitative Report

ILLEGIBLE