

(SUBMIT IN TRIPLICATE)

Indian Agency **Window Rock**

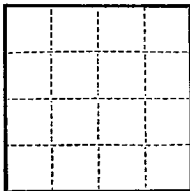

UNITED STATES
DEPARTMENT OF THE INTERIOR
GEOLOGICAL SURVEY
Navajo Tribal Contract No. 14-20-603-1040

Allottee _____
Lease No. _____

SUNDRY NOTICES AND REPORTS ON WELLS

NOTICE OF INTENTION TO DRILL	<input checked="" type="checkbox"/>	SUBSEQUENT REPORT OF WATER SHUT-OFF
NOTICE OF INTENTION TO CHANGE PLANS		SUBSEQUENT REPORT OF SHOOTING OR ACIDIZING
NOTICE OF INTENTION TO TEST WATER SHUT-OFF		SUBSEQUENT REPORT OF ALTERING CASING
NOTICE OF INTENTION TO REDRILL OR REPAIR WELL		SUBSEQUENT REPORT OF REDRILLING OR REPAIR
NOTICE OF INTENTION TO SHOOT OR ACIDIZE		SUBSEQUENT REPORT OF ABANDONMENT
NOTICE OF INTENTION TO PULL OR ALTER CASING		SUPPLEMENTARY WELL HISTORY
NOTICE OF INTENTION TO ABANDON WELL		

RECEIVED
AUG 24 1959
U. S. GEOLOGICAL SURVEY
FARMINGTON NEW MEXICO

(INDICATE ABOVE BY CHECK MARK NATURE OF REPORT, NOTICE, OR OTHER DATA)

August 21, 1959, 19__

Navajo
Well No. **13** is located **900** ft. from **N** line and **3310** ft. from **W** line of sec. **17**
NE/4 **Sec. 17** **T29N** **R18W** **NMPM**
(1/4 Sec. and Sec. No.) (Twp.) (Range) (Meridian)
Shiprock-Gallup **San Juan County** **New Mexico**
(Field) (County or Subdivision) (State or Territory)

The elevation of the derrick floor above sea level is **5211** ft.

DETAILS OF WORK

(State names of and expected depths to objective sands; show sizes, weights, and lengths of proposed casings; indicate mudding jobs, cementing points, and all other important proposed work)

Propose to drill 8 3/4" hole to ten feet. Will set 7" casing at ten feet and cement with ten sacks. Will drill 6 1/4" hole to approximately 110 feet. Will set 2" tubing at 100 feet and complete if oil shows warrant.

RECEIVED
AUG 25 1959
OIL CON. COM.
DIST. 3

I understand that this plan of work must receive approval in writing by the Geological Survey before operations may be commenced.

Company **Universal Oil Corporation**

Address **Box 516**

Farmington, New Mexico

By **Harrell Budd**
Title **President**

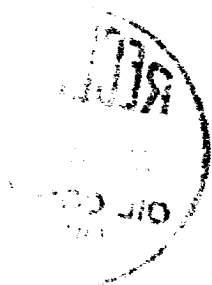

NEW MEXICO OIL CONSERVATION COMMISSION
WELL LOCATION AND ACREAGE DEDICATION PLAT

FORM C-128
Revised 5/1/57

SEE INSTRUCTIONS FOR COMPLETING THIS FORM ON THE REVERSE SIDE

SECTION A

Operator UNIVERSAL OIL CORPORATION		Lease <i>Navajo</i>		Well No. <i>13</i>
Unit Letter C	Section 17	Township 29 NORTH	Range 18 WEST	County SAN JUAN
Actual Footage Location of Well: 990 feet from the NORTH line and 2310 feet from the WEST line				
Ground Level Elev. 5211.0	Producing Formation <i>Gallup</i>	Pool <i>Shiprock Gallup</i>	Dedicated Acreage: 20 Acres	

1. Is the Operator the only owner in the dedicated acreage outlined on the plat below? YES ☐ NO ☐. ("Owner" means the person who has the right to drill into and to produce from any pool and to appropriate the production either for himself or for himself and another. (65-3-29 (e) NMSA 1935 Comp.)
2. If the answer to question one is "no," have the interests of all the owners been consolidated by communization agreement or otherwise? YES ☐ NO ☐. If answer is "yes," Type of Consolidation _____
3. If the answer to question two is "no," list all the owners and their respective interests below:

Owner	Land Description

SECTION B

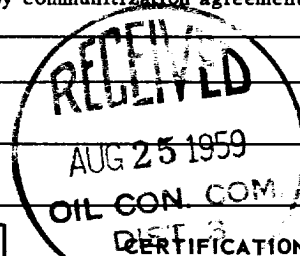
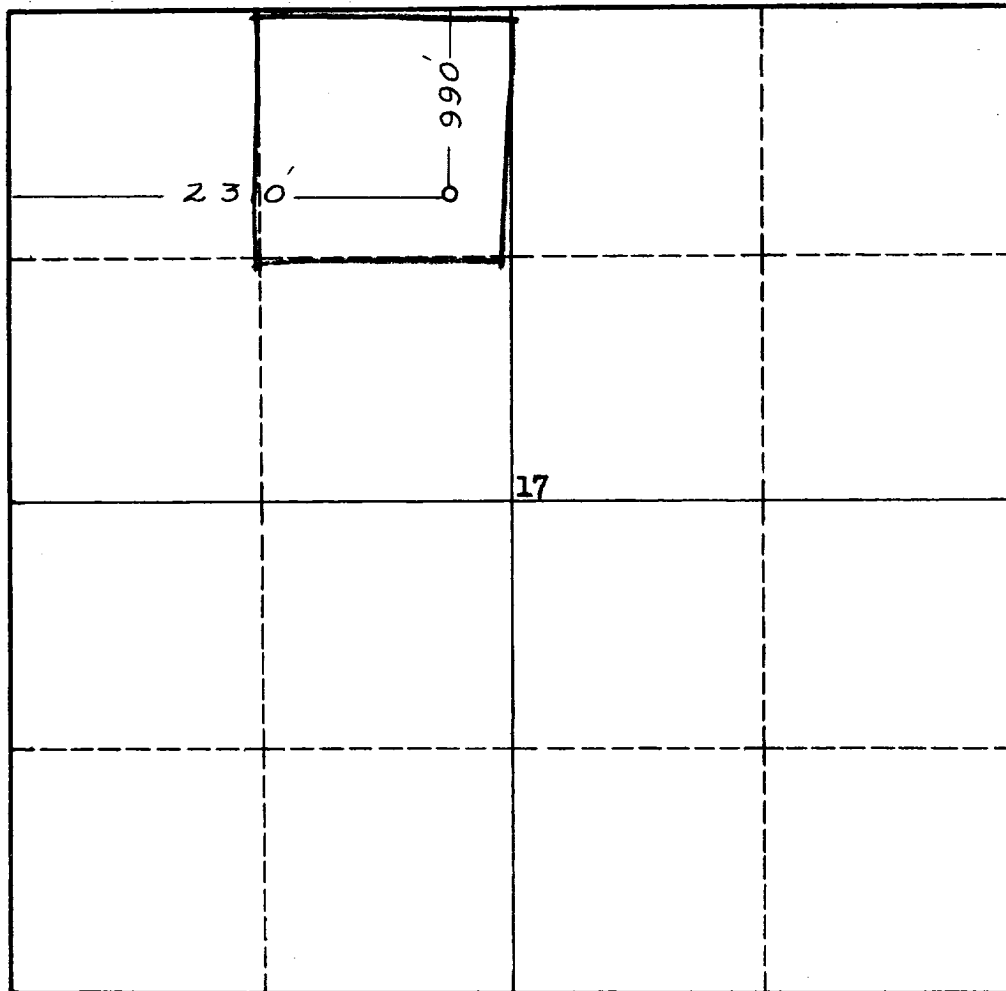

I hereby certify that the information in SECTION A above is true and complete to the best of my knowledge and belief.

Name *Harold Budd*
Position *President*
Company *Universal Oil Corp*
Date *8/21/59*

I hereby certify that the well location shown on the plat in SECTION B was plotted from field notes of actual surveys made by me or under my supervision, and that the same is true and correct to the best of my knowledge and belief.

Date Surveyed
27 April 1959
Registered Professional Engineer and/or Land Surveyor
James P. Leese
James P. Leese

Certificate No. **1463**

INSTRUCTIONS FOR COMPLETION OF FORM C-128

1. Operator shall furnish and certify to the information called for in Section A.
2. Operator shall outline the dedicated acreage for *both* oil and gas wells on the plat in Section B.
3. A registered professional engineer or land surveyor registered in the State of New Mexico or approved by the Commission shall show on the plat the location of the well and certify this information in the space provided.
4. All distances shown on the plat must be from the outer boundaries of the Section.
5. If additional space is needed for listing owners and their respective interests as required in question 3 of Section A, please use space below.