

(SUBMIT IN TRIPLICATE)

UNITED STATES
DEPARTMENT OF THE INTERIOR
GEOLOGICAL SURVEY

Land Office Santa FeLease No. 078110

Unit _____

SUNDRY NOTICES AND REPORTS ON WELLS

NOTICE OF INTENTION TO DRILL.....	<input checked="" type="checkbox"/>	SUBSEQUENT REPORT OF WATER SHUT-OFF.....	
NOTICE OF INTENTION TO CHANGE PLANS.....		SUBSEQUENT REPORT OF SHOOTING OR ACIDIZING.....	
NOTICE OF INTENTION TO TEST WATER SHUT-OFF.....		SUBSEQUENT REPORT OF ALTERING CASING.....	
NOTICE OF INTENTION TO RE-DRILL OR REPAIR WELL.....		SUBSEQUENT REPORT OF RE-DRILLING OR REPAIR.....	
NOTICE OF INTENTION TO SHOOT OR ACIDIZE.....		SUBSEQUENT REPORT OF ABANDONMENT.....	
NOTICE OF INTENTION TO PULL OR ALTER CASING.....		SUPPLEMENTARY WELL HISTORY.....	
NOTICE OF INTENTION TO ABANDON WELL.....			

(INDICATE ABOVE BY CHECK MARK NATURE OF REPORT, NOTICE, OR OTHER DATA)

N.M. Federal "I"

October 26, 1961

Well No. 7 is located 510 ft. from ☒ line and 684 ft. from ☒ line of sec. 11

SW/4 of SW/4 Sec. 11 29N 14W NMPM
 (¼ Sec. and Sec. No.) (Twp.) (Range) (Meridian)

Total Gallup San Juan New Mexico
 (Field) (County or Subdivision) (State or Territory)

The elevation of the ~~drill collar~~ Ground above sea level is 5344 ft.

DETAILS OF WORK

(State names of and expected depths to objective sands; show sizes, weights, and lengths of proposed casings; indicate mudding jobs, cementing points, and all other important proposed work)

We propose to drill this 5100' Gallup Sand test as follows:

12½" hole to 450'. Set 8 5/8" 24# J-55 casing to 450' with sufficient cement to circulate. WOC 24 hrs, test csg. to 1000# for 30 min. Drill 7 7/8" hole to 5100'. Set 1½" 11.6# J-55 csg. to T.D. with 200 sz cnt. on btm. and 400 sacks thru stage collar at base of point lookout. WOC 24 hrs. Test casing to 1000# for 30 min. The csg. will be perforated and the Gallup section fractured on completion.

I understand that this plan of work must receive approval in writing by the Geological Survey before operations may be commenced.

Company Sunray Mid-Continent Oil CompanyAddress 200 Petroleum Club Plaza Bldg.Farmington, New MexicoORIGINAL SIGNED BY
HAL M. STIERWALT

By _____

Title Engineer

NEW MEXICO OIL CONSERVATION COMMISSION

Well Location and Acreage Dedication Plat

Section A.

Date 10-26-61

Operator SUNRAY MID-CONTINENT OIL COMPANY Lease NEW MEXICO "FEDERAL" IT
 Well No. 7 Unit Letter M Section 11 Township 29 NORTH Range 14 WEST, NMPM
 Located 510 Feet From the SOUTH Line, 684 Feet From the WEST Line
 County SAN JUAN G. L. Elevation 5344.0 Dedicated Acreage 60 Acres
 Name of Producing Formation Lower Gallup Pool Totah Gallup

1. Is the Operator the only owner in the dedicated acreage outlined on the plat below?
 Yes ☒ No ☐
2. If the answer to question one is "no", have the interests of all the owners been consolidated by communitization agreement or otherwise? Yes ☐ No ☐ If answer is "yes", Type of Consolidation.
3. If the answer to question two is "no", list all the owners and their respective interests below:

Owner

Land Description

Section B.

This is to certify that the information in Section A above is true and complete to the best of my knowledge and belief.

Sunray Mid-Continent Oil Company
 (Operator)

(Representative)
200 Petroleum Club Plaza Bldg.
 (Address)
Farmington, New Mexico

Ref: GLO plat dated 31 August 1882

Note: All distances must be from outer boundaries of section.

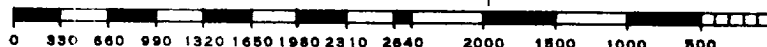
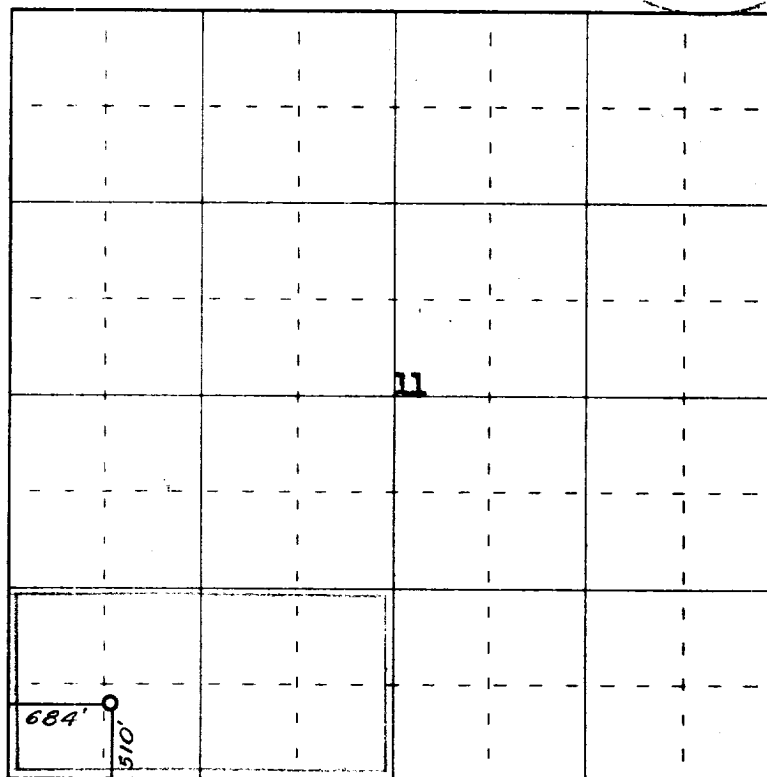

Scale 4 inches equal 1 mile

This is to certify that the above plat was prepared from field notes of actual surveys made by me or under my supervision and that the same are true and correct to the best of my knowledge and belief.

Date Surveyed 23 October 1961

James P. Lease
 Registered Professional Engineer and/or Land Surveyor
 N. Mex. Reg. No. 1463
 San Juan Engineering Company

Farmington, New Mexico