

| | | | |
|--|--|--|--|
| | | | |
| | | | |
| | | | |
| | | | |

(SUBMIT IN TRIPLICATE)

UNITED STATES
DEPARTMENT OF THE INTERIOR
GEOLOGICAL SURVEY

Land Office Santa Fe
Lease No. SP 079908
Unit _____

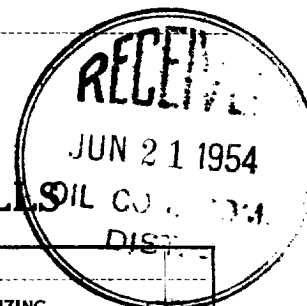

SUNDRY NOTICES AND REPORTS ON WELLS

| | | |
|---|-------------------------------------|---|
| NOTICE OF INTENTION TO DRILL..... | <input checked="" type="checkbox"/> | SUBSEQUENT REPORT OF WATER SHUT-OFF..... |
| NOTICE OF INTENTION TO CHANGE PLANS..... | | SUBSEQUENT REPORT OF SHOOTING OR ACIDIZING..... |
| NOTICE OF INTENTION TO TEST WATER SHUT-OFF..... | | SUBSEQUENT REPORT OF ALTERING CASING..... |
| NOTICE OF INTENTION TO RE-DRILL OR REPAIR WELL..... | | SUBSEQUENT REPORT OF RE-DRILLING OR REPAIR..... |
| NOTICE OF INTENTION TO SHOOT OR ACIDIZE..... | | SUBSEQUENT REPORT OF ABANDONMENT..... |
| NOTICE OF INTENTION TO PULL OR ALTER CASING..... | | SUPPLEMENTARY WELL HISTORY..... |
| NOTICE OF INTENTION TO ABANDON WELL..... | | |

(INDICATE ABOVE BY CHECK MARK NATURE OF REPORT, NOTICE, OR OTHER DATA)

June 11, 1954

Russell Federal
Well No. 73 is located 800 ft. from [N] line and 800 ft. from [E] line of sec. 2

NE 1/4 Section 9 29N 14E H.M.P.M.
(1/4 Sec. and Sec. No.) (Twp.) (Range) (Meridian)
Twin Mounds San Juan New Mexico
(Field) (County or Subdivision) (State or Territory)

The elevation of the ~~land surface~~ ground level above sea level is 2421.5 ft.

DETAILS OF WORK

(State names of and expected depths to objective sands; show sizes, weights, and lengths of proposed casings; indicate mudding jobs, cementing points, and all other important proposed work)

It is proposed to drill with rotary tools to the top of the Mancos Shale, estimated to be at a depth of 3800 4 feet. It is proposed to several core and drill stem test the Pictured Cliffs formation, as well as possible zones in the Manoverde formation. Tentative casing program as follows:
10-3/4" surface casing: 250'
Production string: ?

The NE 1/4 of Section 9 has been designated as the drilling unit.

A Blanket Drilling Bond has heretofore been filed and approved by the Commission.

I understand that this plan of work must receive approval in writing by the Geological Survey before operations may be commenced.

Company PURCO DEVELOPMENT, INC.

Address Post Office Box 1360
Albuquerque, New Mexico

By F. D. GORHAM JR by N. M. Mandy
Frank D. Gorham, Jr.
Title Vice President

Company PUBCO DEVELOPMENT CO.

Lease RUSSELL-FEDERAL Well No. 3

Sec. 9 T. 29N R. 14W

Location 800 feet from north line; 800 feet from east line.

Elevation: 5421.6 CL

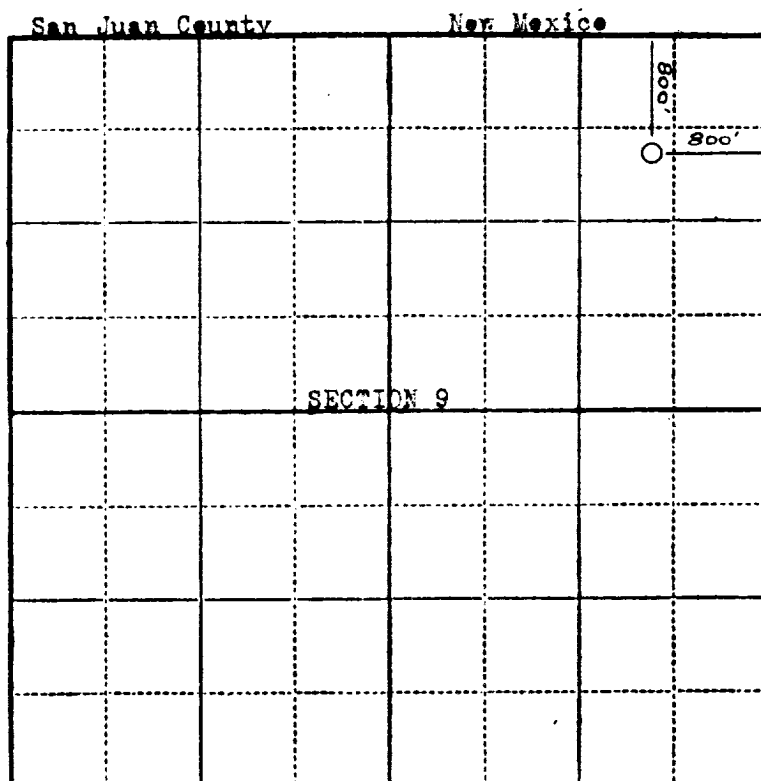

RECEIVED
JUN 11 1954
FEDERAL BUREAU OF SURVEY
BIRMINGHAM, B. M.

Scale—4 inches equal 1 mile.

This is to certify that the above plat was prepared from field notes of actual surveys made by me or under my supervision and that the same are true and correct to the best of my knowledge and belief.

Stephen H. Kinney
STEPHEN H. KINNEY
Registered Professional
Engineer and Land Surveyor

Surveyed June 9, 1954

Seal: