

(SUBMIT IN TRIPLICATE)

UNITED STATES  
DEPARTMENT OF THE INTERIOR  
GEOLOGICAL SURVEY

Land Office Santa Fe  
Lease No. SF 065557  
Unit \_\_\_\_\_

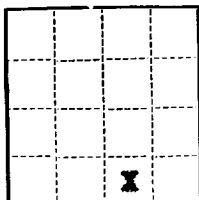

SUNDRY NOTICES AND REPORTS ON WELLS

NOTICE OF INTENTION TO DRILL	<input checked="" type="checkbox"/>	SUBSEQUENT REPORT OF WATER SHUT-OFF
NOTICE OF INTENTION TO CHANGE PLANS		SUBSEQUENT REPORT OF SHOOTING OR ACIDIZING
NOTICE OF INTENTION TO TEST WATER SHUT-OFF		SUBSEQUENT REPORT OF ALTERING CASING
NOTICE OF INTENTION TO RE-DRILL OR REPAIR WELL		SUBSEQUENT REPORT OF RE-DRILLING OR REPAIR
NOTICE OF INTENTION TO SHOOT OR ACIDIZE		SUBSEQUENT REPORT OF ABANDONMENT
NOTICE OF INTENTION TO PULL OR ALTER CASING		SUPPLEMENTARY WELL HISTORY
NOTICE OF INTENTION TO ABANDON WELL		

(INDICATE ABOVE BY CHECK MARK NATURE OF REPORT, NOTICE, OR OTHER DATA)

May 15, 1962

Cornell Dakota Gas Unit "D"  
Well No. 1 is located 1136 ft. from xxx line and 1625 ft. from E line of sec. 12

SE/4 Section 12  
(1/4 Sec. and Sec. No.)

29 N  
(Twp.)

12 W  
(Range)

N.M.P.M.  
(Meridian)

Basin Dakota  
(Field)

San Juan  
(County or Subdivision)

New Mexico  
(State or Territory)

The elevation of the ground level ~~surface~~ above sea level is 5669 ft.

DETAILS OF WORK

(State names of and expected depths to objective sands; show sizes, weights, and lengths of proposed casings; indicate mudding jobs, cementing points, and all other important proposed work)

1. Drill 11" hole to 250'.
2. Set 250' 8-5/8", 2 1/4" casing. Circulate cement to surface.
3. Drill 6-3/4" hole to 6580.
4. Set 6580' 4-1/2" OD, 9.5#, casing. Cement in two stages. First stage: 200 sacks. Second stage through stage collar 50' below Pictured Cliffs. Sufficient volume to cover 50' above Pictured Cliffs.
5. Perforate and stimulate Dakota. Potential and clean up location.

I understand that this plan of work must receive approval in writing by the Geological Survey before operations may be commenced.

Company Tenneco Corp., acting by & thru its managing agent, Tenneco Oil Company

Address P. O. Box 1714  
Durango, Colorado

By L. B. Plumb  
Title District Production Superintendent

## NEW MEXICO OIL CONSERVATION COMMISSION

## Well Location and Acreage Dedication Plat

Section A. **TENNECO CORP., ACTING BY & THRU ITS**Date **May 13, 1962**Operator **TENNECO OIL COMPANY**Lease **CORNELL DAKOTA GAS UNIT "D"**

Well No. **1** Unit Letter **0** Section **12** Township **29 North** Range **12 West** NMPM  
 Located **1136** Feet From **South** Line, **1625** Feet From **East** Line  
 County **San Juan** G. L. Elevation **5670 ungraded** Dedicated Acreage **300** Acres  
 Name of Producing Formation **Dakota** Pool **Dakota Dakota**

1. Is the Operator the only owner in the dedicated acreage outlined on the plat below?

Yes ☒ No ☐2. If the answer to question one is "no", have the interests of all the owners been consolidated by communitization agreement or otherwise? Yes ☐ No ☐ If answer is "yes", Type of Consolidation.

3. If the answer to question two is "no", list all the owners and their respective interests below:

Owner

Land Description

\_\_\_\_\_  
 \_\_\_\_\_  
 \_\_\_\_\_

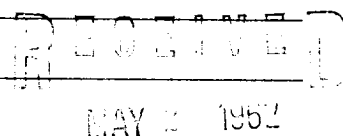

## Section B.

Note: All distances must be from outer boundaries of section.

This is to certify that the information  
 in Section A above is true and complete  
 to the best of my knowledge and belief.

**Tenneco Corp., acting by & thru its  
 managing agent, Tenneco Oil Company**

*[Signature]* (Operator)  
**L. B. Flumb**

(Representative)  
**P. O. Box 1714**

(Address)  
**Durango, Colorado**

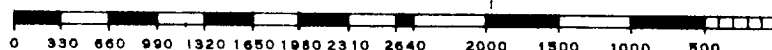
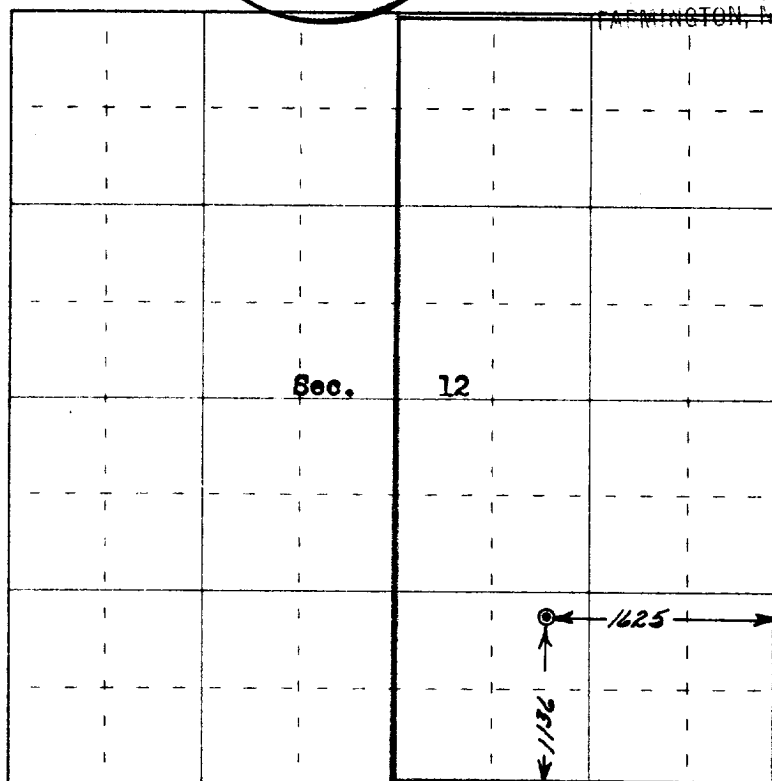

Scale 4 inches equal 1 mile

This is to certify that the above plat was prepared from field notes of actual surveys  
 made by me or under my supervision and that the same are true and correct to the best  
 of my knowledge and belief.

(Seal)

Date Surveyed **17 May 1962**

Farmington, New Mexico  
 San Juan Engineering Co.

*[Signature]*  
 Registered Professional Engineer and/or Land Surveyor  
 Robert H. Ernst, PE & LS 2463