

NUMBER OF COPIES RECEIVED	
DISTRIBUTION	
SANTA FE	✓
FILE	✓
U.S.G.S.	2
LAND OFFICE	
TRANSPORTER	OIL
	G.S.S.
PRODUCTION OFFICE	
OPERATOR	

NEW MEXICO OIL CONSERVATION COMMISSION
Santa Fe, New Mexico

Form C-101
Revised (12/1/55)

NOTICE OF INTENTION TO DRILL

Notice must be given to the District Office of the Oil Conservation Commission and approval obtained before drilling or recompletion begins. If changes in the proposed plan are considered advisable, a copy of this notice showing such changes will be returned to the sender. Submit this notice in **QUINTUPPLICATE**. One copy will be returned following approval. See additional instructions in Rules and Regulations of the Commission.

If State Land submit 6 Copies Attach Form C-128 in triplicate to first 3 copies of form C-101

Houston, Texas
(Please)

August 16, 1962
(Date)

OIL CONSERVATION COMMISSION
SANTA FE, NEW MEXICO

Gentlemen:

You are hereby notified that it is our intention to commence the Drilling of a well to be known as
Texas Eastern Transmission Corporation

(Company or Operator)

Julander Gas Unit

(Lease)

Well No. 1, in _____ (Unit) The well is

located 1,750 feet from the South line and 1735 feet from the East

line of Section 10, T 29-N, R 11-W, NMPM.
(GIVE LOCATION FROM SECTION LINE) Basin Dakota Pool, San Juan County

If State Land the Oil and Gas Lease is No. _____

If patented land the owner is Weldon C. Julander

Address 215 Petroleum Club Plaza, Farmington, N.M.

We propose to drill well with drilling equipment as follows: Rotary Tools to total depth

The status of plugging bond is Issued by American General Insurance Company

Drilling Contractor Unknown at this time

We intend to complete this well in the Dakota OIL CON. COM. formation at an approximate depth of 6,750 DIST. 3 feet.

CASING PROGRAM

We propose to use the following strings of Casing and to cement them as indicated:

Size of Hole	Size of Casing	Weight per Foot	New or Second Hand	Depth	Sacks Cement
<u>12 1/4</u>	<u>8 5/8</u>	<u>24#</u>	<u>New</u>	<u>300 +</u>	<u>260</u>
*Single - <u>7 7/8</u>	<u>4 1/2</u>	<u>11.6# + 9.5#</u>	<u>New</u>	<u>Estm. 6750'</u>	<u>**</u>
*Dual - <u>7 7/8</u>	<u>5 1/2</u>	<u>14# + 15.5#</u>	<u>New</u>	<u>Estm. 6750'</u>	<u>**</u>

If changes in the above plans become advisable we will notify you immediately.

ADDITIONAL INFORMATION (If recompletion give full details of proposed plan of work.)

*Depending on Single or Dual Completion of well.

**Enough cnt. to cover Gallup & Dakota Formations + DV Tool set below Pictured Cliffs and Fruitland Formations with Sufficient cnt. to cover both formations.

Approved 8-20, 19 62
Except as follows:

Sincerely yours,

Texas Eastern Transmission Corporation

(Company or Operator)

By J. D. Gaden J. D. Gaden

Position Chief Production Clerk

Send Communications regarding well to

Name Texas Eastern Transmission Corporation

Address P. O. Box 2521, Houston 1, Texas

OIL CONSERVATION COMMISSION

By Emory C. Arnold

NEW MEXICO OIL CONSERVATION COMMISSION

Well Location and Acreage Dedication Plat

Section A.

Date August 16, 1962

Operator TEXAS EASTERN TRANSMISSION CORP. Lease PERMANENT JULANDER GAS UNIT
 Well No. 1 Unit Letter J Section 10 Township 29 NORTH Range 11 WEST NMPM
 Located 1750 Feet From the SOUTH Line, 1735 Feet From the EAST Line
 County SAN JUAN G. L. Elevation 5589.5 Dedicated Acreage 320 Acres
 Name of Producing Formation Dakota Pool Basin Dakota

1. Is the Operator the only owner in the dedicated acreage outlined on the plat below?

Yes _____ No X2. If the answer to question one is "no", have the interests of all the owners been consolidated by communitization agreement or otherwise? Yes X No _____. If answer is "yes", Type of Consolidation.**Communitization Agreement**

3. If the answer to question two is "no", list all the owners and their respective interests below:

Owner

Land Description

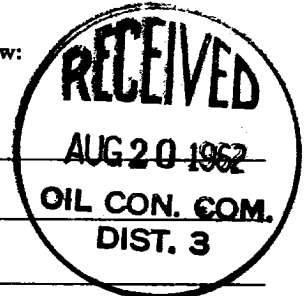

Section B.

This is to certify that the information
 in Section A above is true and complete
 to the best of my knowledge and belief.

Texas Eastern**Transmission Corporation**

(Operator)

(Representative)

P. O. Box 2521

(Address)

Houston 1, Texas

Ref. GLO Plat Dated 29 June 1910

Note: All distances must be from outer boundaries of section.

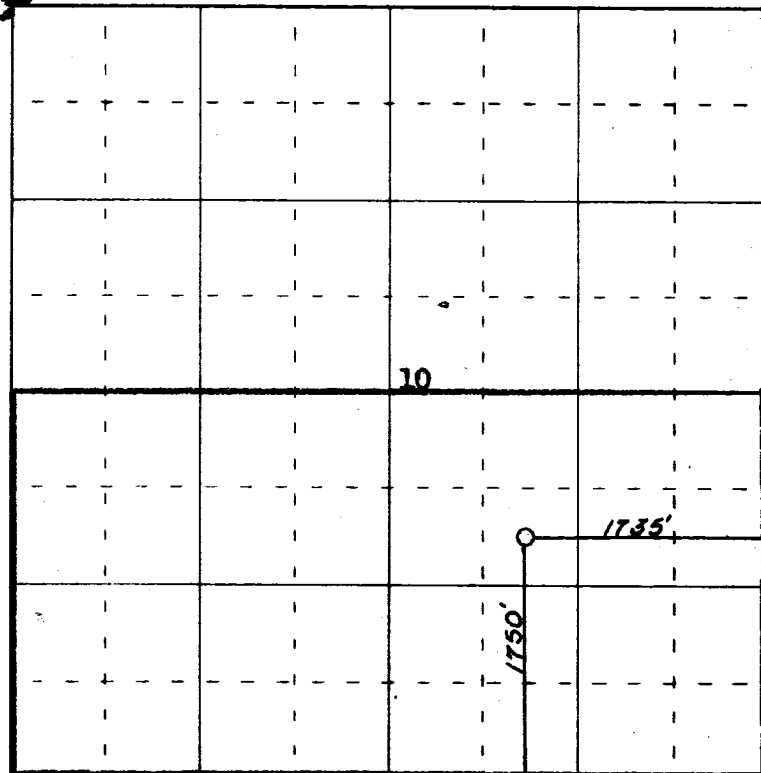

0 330 660 990 1320 1650 1980 2310 2640 2000 1500 1000 500 0

Scale 4 inches equal 1 mile

This is to certify that the above plat was prepared from field notes of actual surveys
 made by me or under my supervision and that the same are true and correct to the best
 of my knowledge and belief.

Date Surveyed 9 August 1962

James P. Loe
 Registered Professional Engineer and/or Land Surveyor
 James P. Loe

Farmingdale, New Mexico