

(SUBMIT IN TRIPLICATE)

Indian Agency _____

UNITED STATES

Nava Jo

DEPARTMENT OF THE INTERIOR
GEOLOGICAL SURVEY

Allettee _____

Lease No. 1-89-IND-57

Sec. 12

X

SUNDRY NOTICES AND REPORTS ON WELLS

NOTICE OF INTENTION TO DRILL	X	SUBSEQUENT REPORT OF WATER SHUT-OFF	
NOTICE OF INTENTION TO CHANGE PLANS		SUBSEQUENT REPORT OF SHOOTING OR ACIDIZING	
NOTICE OF INTENTION TO TEST WATER SHUT-OFF		SUBSEQUENT REPORT OF ALTERING CASING	
NOTICE OF INTENTION TO REDRILL OR REPAIR WELL		SUBSEQUENT REPORT OF REDRILLING OR REPAIR	
NOTICE OF INTENTION TO SHOOT OR ACIDIZE		SUBSEQUENT REPORT OF ABANDONMENT	
NOTICE OF INTENTION TO PULL OR ALTER CASING		SUPPLEMENTARY WELL HISTORY	
NOTICE OF INTENTION TO ABANDON WELL			

(INDICATE ABOVE BY CHECK MARK NATURE OF REPORT, NOTICE, OR OTHER DATA)

U. S. GEOLOGICAL SURVEY
FARMINGTON, NEW MEXICO

May 15, 1962

Well No. 148 is located 946 ft. from N line and 1663 ft. from E line of sec. 12

SW/4 Sec. 12 T29N R19W NMPM
(4 Sec. and Sec. No.) (Twp.) (Range) (Meridian)
Rattlesnake Dakota San Juan County New Mexico
(Field) (County or Subdivision) (State or Territory)

The elevation of the derrick floor above sea level is 5310 ft. (Est. RBM 11')

DETAILS OF WORK

(State names of and expected depths to objective sands; show sizes, weights, and lengths of proposed casings; indicate mudding jobs, cementing points, and all other important proposed work)

We propose to drill this well with rotary tools to an estimated depth of 950' to test the Dakota formation. If commercial production is encountered, a string of 5 1/2" production casing will be run and cemented and the well completed.

I understand that this plan of work must receive approval in writing by the Geological Survey before operations may be commenced.

Company Continental Oil Company

Address Box 3312

Durango, Colorado

By REACH

Title Asst. District Supt.

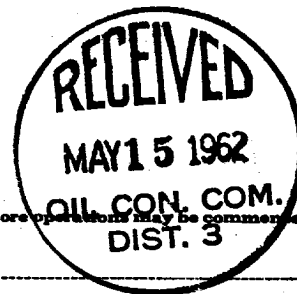

10-11-50

10-11-50

10-11-50 10-11-50 10-11-50 10-11-50
10-11-50 10-11-50 10-11-50 10-11-50
10-11-50 10-11-50 10-11-50 10-11-50

The process of development of the new
of 1950 in the field of international
encountered, a number of difficulties
arising and the work continued.

Continued in the
of the
Bureau, Colorado

NUMBER OF COPIES RECEIVED	
DISTRIBUTION	
SANTA FE	
FILE	
U.S.G.S.	
LAND OFFICE	
TRANSPORTER	OIL GAS
PRODUCTION OFFICE	
OPERATOR	

NEW MEXICO OIL CONSERVATION COMMISSION
WELL LOCATION AND ACREAGE DEDICATION PLAT
 SEE INSTRUCTIONS FOR COMPLETING THIS FORM ON THE REVERSE SIDE

FORM C-128
Revised 5/1/57

SECTION A

Operator Continental Oil Company		Lease Rattlesnake		Well No. 148
Unit Letter N	Section 12	Township 29N	Range 19W	County San Juan
Actual Footage Location of Well: 346 feet from the South line and 1663 feet from the West line				
Ground Level Elev. 5299	Producing Formation Dakota	Pool Dakota	Dedicated Acreage: 40 Acres	

1. Is the Operator the only owner in the dedicated acreage outlined on the plat below? YES ☒ NO ☐ . ("Owner" means the person who has the right to drill into and to produce from any pool and to appropriate the production either for himself or for himself and another. (65-3-29 (e) NMSA 1935 Comp.)
2. If the answer to question one is "no," have the interests of all the owners been consolidated by communitization agreement or otherwise? YES ☐ NO ☐ . If answer is "yes," Type of Consolidation _____
3. If the answer to question two is "no," list all the owners and their respective interests below: _____

Owner	Land Description

SECTION B

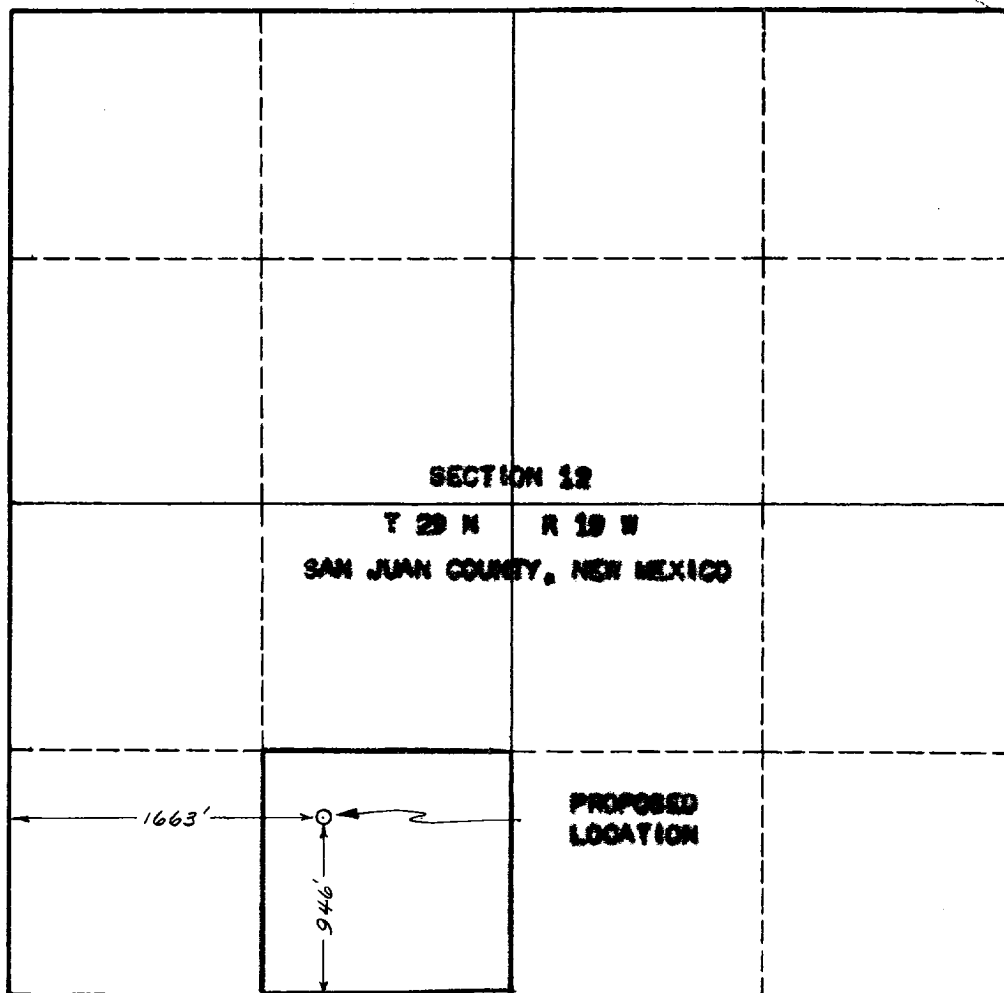

CERTIFICATION

I hereby certify that the information in SECTION A above is true and complete to the best of my knowledge and belief.

Name	R. E. JENSEN
Position	Asst. District Supt.
Company	Continental Oil Company
Date	3-11-62

I hereby certify that the well location shown on the plat in SECTION B was plotted from field notes of actual surveys made by me or under my supervision, and that the same is true and correct to the best of my knowledge and belief.

Date Surveyed	MAY 8, 1962
Registered Professional Engineer and/or Land Surveyor	William M. Clark
Certificate No.	55126

INSTRUCTIONS FOR COMPLETION OF FORM C-128

1. Operator shall furnish and certify to the information called for in Section A.
2. Operator shall outline the dedicated acreage for *both* oil and gas wells on the plat in Section B.
3. A registered professional engineer or land surveyor registered in the State of New Mexico or approved by the Commission shall show on the plat the location of the well and certify this information in the space provided.
4. All distances shown on the plat must be from the outer boundaries of the Section.
5. If additional space is needed for listing owners and their respective interests as required in question 3 of Section A, please use space below.