

(SUBMIT IN TRIPLICATE)

Indian Agency Bureau

UNITED STATES
DEPARTMENT OF THE INTERIOR
GEOLOGICAL SURVEY

Allettee _____

Lease No. 1-42-100-56

1			
	12		

SUNDRY NOTICES AND REPORTS ON WELLS

NOTICE OF INTENTION TO DRILL	<input checked="" type="checkbox"/>	SUBSEQUENT REPORT OF WATER SHUT-OFF	<input type="checkbox"/>
NOTICE OF INTENTION TO CHANGE PLANS	<input type="checkbox"/>	SUBSEQUENT REPORT OF SHOOTING OR ACIDIZING	<input type="checkbox"/>
NOTICE OF INTENTION TO TEST WATER SHUT-OFF	<input type="checkbox"/>	SUBSEQUENT REPORT OF ALTERING CASING	<input type="checkbox"/>
NOTICE OF INTENTION TO REDRILL OR REPAIR WELL	<input type="checkbox"/>	SUBSEQUENT REPORT OF REDRILLING OR REPAIR	<input type="checkbox"/>
NOTICE OF INTENTION TO SHOOT OR ACIDIZE	<input type="checkbox"/>	SUBSEQUENT REPORT OF ABANDONMENT	<input type="checkbox"/>
NOTICE OF INTENTION TO PULL OR ALTER CASING	<input type="checkbox"/>	SUPPLEMENTARY WELL HISTORY	<input type="checkbox"/>
NOTICE OF INTENTION TO ABANDON WELL	<input type="checkbox"/>		

RECEIVED
JAN 22 1962
U. S. GEOLOGICAL SURVEY
FARMINGTON, NEW MEXICO

(INDICATE ABOVE BY CHECK MARK NATURE OF REPORT, NOTICE, OR OTHER DATA)

January 18, 1962

Well No. 142 is located 567 ft. from N line and 744 ft. from W line of sec. 12

N 1/4 Sec. 12 (1/4 Sec. and Sec. No.) T24N, R13W (Twp.) 13W (Range) 13W (Meridian)
Antelope (Field) San Juan County (County or Subdivision) New Mexico (State or Territory)

The elevation of the derrick floor above sea level is 5217 ft.

DETAILS OF WORK

(State names of and expected depths to objective sands; show sizes, weights, and lengths of proposed casings; indicate mudding jobs, cementing points, and all other important proposed work)

We propose to drill this well with rotary tools to an estimated depth of 6700' to test the Paradox formation. Approximately 100' of 13 1/8" O.D. surface casing will be set and cemented to surface. Approximately 1500' of 8 5/8" O.D. intermediate casing will be set and cemented. A stage collar will be located at approximately 1000' to cement the Paradox formation. A 5 1/2" O.D. liner will be set and cemented from approximately 1500' to 6600'. The well will be completed open hole from the bottom of the 5 1/2" liner to a T.D. of approximately 6700'.

I understand that this plan of work must receive approval in writing by the Geological Survey before operations may be conducted.

Company Continental Oil CompanyAddress P. O. Box 1312Bureau, ColoradoOriginal Signed By: H. D. HALEY By H. D. HALEYTitle District SuperintendentU.S. GOVERNMENT PRINTING OFFICE 16-5437b-8
5000(4) 5000(2) 5000(2) 5000(2) 5000(2) 5000(2)

NUMBER OF COPIES RECEIVED	
DISTRIBUTION	
SANTA FE	
FILE	
U.S.G.S.	
LAND OFFICE	
TRANSPORTER	OIL GAS
PRORATION OFFICE	
OPERATOR	

NEW MEXICO OIL CONSERVATION COMMISSION
WELL LOCATION AND ACREAGE DEDICATION PLAT
 SEE INSTRUCTIONS FOR COMPLETING THIS FORM ON THE REVERSE SIDE

FORM C-128
 Revised 5/1/57

SECTION A

Operator Continental Oil Company			Lease Hattiesburg		Well No. 111
Unit Letter B	Section 12	Township 29N	Range 30W	County San Juan	
Actual Footage Location of Well: 567 feet from the North line and 714 feet from the West line					
Ground Level Elev. 5315	Producing Formation Paradox		Pool Hattiesburg Pennsylvanian		Dedicated Acreage: 30 Acres

1. Is the Operator the only owner in the dedicated acreage outlined on the plat below? YES _____ NO **X**. ("Owner" means the person who has the right to drill into and to produce from any pool and to appropriate the production either for himself or for himself and another. (65-3-29 (e) NMSA 1935 Comp.)
2. If the answer to question one is "no," have the interests of all the owners been consolidated by communitization agreement or otherwise? YES **X** NO _____. If answer is "yes," Type of Consolidation **Consolidation Purchase of Interest by Bureau of Mines**
3. If the answer to question two is "no," list all the owners and their respective interests below:

Owner	Land Description

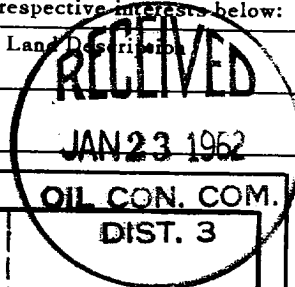

SECTION B

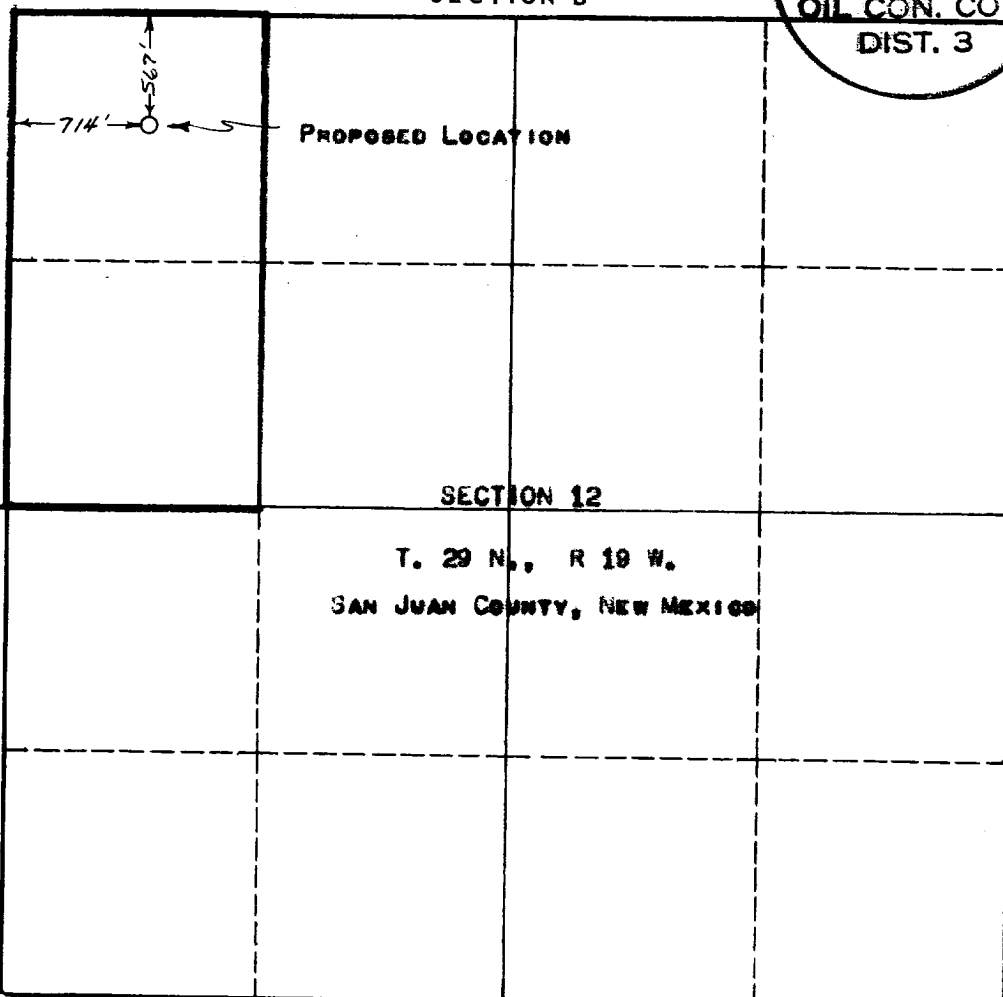

CERTIFICATION

I hereby certify that the information in SECTION A above is true and complete to the best of my knowledge and belief.

Original Signed By:
H. D. HALEY

Name	District Superintendent
Position	Continental Oil Company
Company	January 18, 1962
Date	

I hereby certify that the well location shown on the plat in SECTION B was plotted from field notes of actual surveys made by me or under my supervision, and that the same is true and correct to the best of my knowledge and belief.

Date Surveyed	1-12-62
Registered Professional Engineer and/or Land Surveyor	Edmund M. Clark
Certificate No.	NEW MEXICO #3189

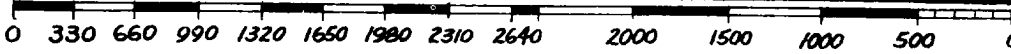

INSTRUCTIONS FOR COMPLETION OF FORM C-128

1. Operator shall furnish and certify to the information called for in Section A.
2. Operator shall outline the dedicated acreage for *both* oil and gas wells on the plat in Section B.
3. A registered professional engineer or land surveyor registered in the State of New Mexico or approved by the Commission shall show on the plat the location of the well and certify this information in the space provided.
4. All distances shown on the plat must be from the outer boundaries of the Section.
5. If additional space is needed for listing owners and their respective interests as required in question 3 of Section A, please use space below.