

District I
P.O. Box 1980, Hobbs, NM

District II
P.O. Drawer DD, Artesia, NM 88221

District III
1000 Rio Brazos Rd, Aztec, NM 87410

State of New Mexico
Energy, Minerals and Natural Resources Department

OIL CONSERVATION DIVISION

2040 South Pacheco Street
Santa Fe, New Mexico 87505

SUBMIT 1 COPY TO
APPROPRIATE
DISTRICT OFFICE
AND 1 COPY TO
SANTA FE OFFICE

RECEIVED
NOV - 1 1999
OIL CON. DIV.
DIST. 3

PIT REMEDIATION AND CLOSURE REPORT

Operator: PNM Gas Services (Burlington)		Telephone: 324-3764	
Address: 603 W. Elm Street Farmington, NM 87401			
Facility or Well Name: Hare #15			
Location:	Unit M	Sec 3	T 29N R 10W County San Juan
Pit Type:	Separator <input checked="" type="checkbox"/>	Dehydrator <input type="checkbox"/>	Other
Land Type:	BLM <input checked="" type="checkbox"/>	State <input type="checkbox"/>	Fee <input type="checkbox"/> Other
Pit Location:	Pit dimensions: length 21' width 21' depth 3'		
(Attach diagram)	Reference: wellhead <input checked="" type="checkbox"/>	other	
Footage from reference: 111'			
Direction from reference: 45 Degrees <input type="checkbox"/> East North <input checked="" type="checkbox"/> of <input checked="" type="checkbox"/> West South <input type="checkbox"/>			
Depth to Ground Water:			
(Vertical distance from contaminants to seasonal high water elevation of ground water)		Less than 50 feet (20 points) 50 feet to 99 feet (10 points) Greater than 100 feet (0 points)	0
Wellhead Protection Area:			
(Less than 200 feet from a private domestic water source, or; less than 1,000 feet from all other water sources)		Yes (20 points) No (0 points)	0
Distance to Surface Water:			
(Horizontal distance to perennial lakes, ponds, rivers, streams, creeks, irrigation canals and ditches)		Less than 200 feet (20 points) 200 feet to 1,000 feet (10 points) Greater than 1,000 feet (0 points)	0
RANKING SCORE (TOTAL POINTS):			0

Hare #15

Date Remediation Started: 06/15/1999

Date Completed: 06/15/1999

Remediation Method: Excavation ☒

Approx. Cubic Yard 142

(Check all appropriate sections)

Landfarmed 92

Amount Landfarmed (cubic yds) 92

Other 50 cu yds overburden.

Remediation Location:

Onsite ☒Offsite ☐

(i.e., landfarmed onsite, name and location of offsite facility)

Backfill Material Location:

General Description of Remedial Action:

Excavated contaminated soil to a pit size of 24' X 16' X 10' and landfarmed soil onsite within a bermed area at a depth of 6" to 12". Soil was aerated by disking/plowing until soil met regulatory levels.

Ground Water Encountered:

No ☒Yes ☐

Depth

Final Pit Closure Sampling:

Sample Location

3 pt. composite - bottom.

(if multiple samples, attach sample result and diagram of sample locations and depths.)

Sample depth

10'

Sample date

06/15/1999

Sample time

12:02:00 PM

Sample Results

Benzene (ppm) < 0.025

Total BTEX (ppm) 0.449

Field headspace (ppm)

TPH (ppm)

110.00

Method

8015B

Vertical Extent (ft)

Risk Analysis form attached Yes ☐No ☒

Ground Water Sample:

Yes ☐No ☒

(If yes, see attached Groundwater Site Summary Report)

I HEREBY CERTIFY THAT THE INFORMATION ABOVE IS TRUE AND COMPLETE TO THE BEST OF MY KNOWLEDGE AND MY BELIEF

DATE October 28, 1999

SIGNATURE

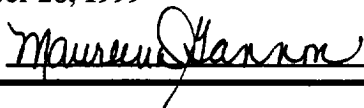

PRINTED NAME Maureen Gannon
AND TITLE Project Manager

Have #15
Burlington
Sec. 3, 29N, 10W, m

6-15-99

↑

N

Site diagram:

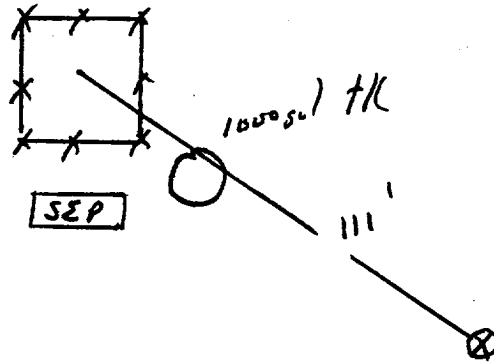

End of excavation:

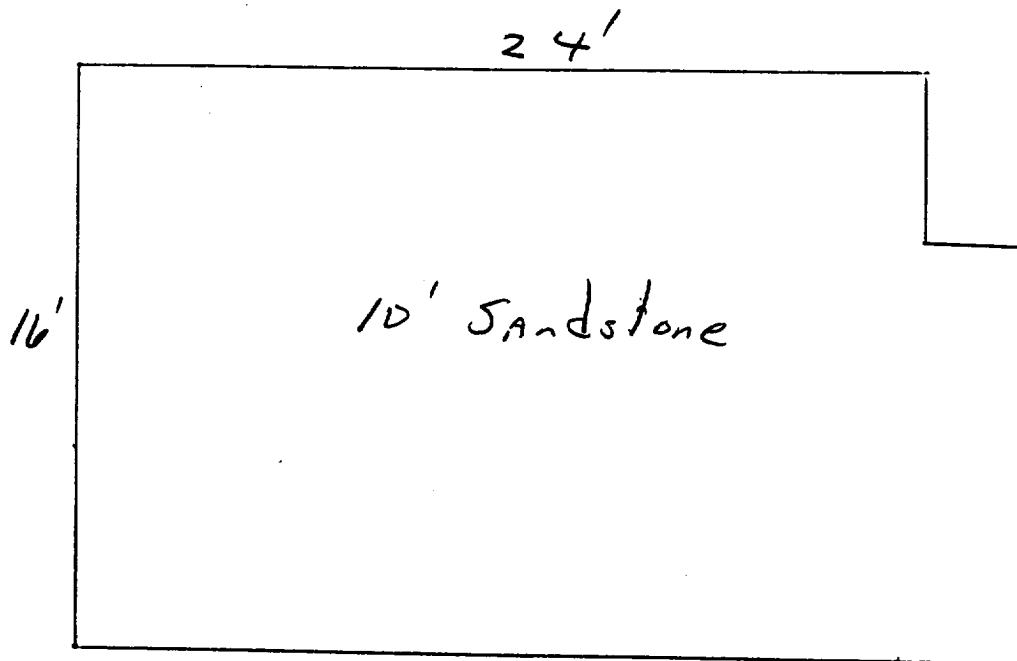

OFF: (505) 325-5667



LAB: (505) 325-1556

On Site Technologies, LTD.

Date: 30-Jun-99

CLIENT: PNM - Public Service Company of NM

Project: PNM Pit Remediation

Lab Order: 9906053

CASE NARRATIVE

Samples were analyzed using the methods outlined in the following references:

Test Methods for Evaluating Solid Waste, Physical/Chemical Methods, SW846, 3rd Edition

All method blanks, laboratory spikes, and/or matrix spikes met quality assurance objectives.

OFF: (505) 325-5667



LAB: (505) 325-1556

ANALYTICAL REPORT

Date: 30-Jun-99

Client:	PNM - Public Service Company of NM	Client Sample Info:	Hare #15
Work Order:	9906053	Client Sample ID:	9906151202; 10ft. - 33pt. composite Bottom
Lab ID:	9906053-05A	Matrix:	SOIL
Project:	PNM Pit Remediation	Collection Date:	6/15/99 12:02:00 PM
		COC Record:	7611

Parameter	Result	PQL	Qual	Units	DF	Date Analyzed
DIESEL RANGE ORGANICS						
T/R Hydrocarbons: C10-C28	110	25		mg/Kg	1	Analyst: DC 6/28/99
AROMATIC VOLATILES BY GC/PID						
						Analyst: DC
Benzene	ND	25		µg/Kg	25	6/24/99
Toluene	ND	50		µg/Kg	25	6/24/99
Ethylbenzene	39	25		µg/Kg	25	6/24/99
m,p-Xylene	300	50		µg/Kg	25	6/24/99
o-Xylene	110	25		µg/Kg	25	6/24/99

449
1449 ppm

Qualifiers:	PQL - Practical Quantitation Limit	S - Spike Recovery outside accepted recovery limits
	ND - Not Detected at Practical Quantitation Limit	R - RPD outside accepted recovery limits
	J - Analyte detected below Practical Quantitation Limit	E - Value above quantitation range
	B - Analyte detected in the associated Method Blank	Surr: - Surrogate

P.O. BOX 2606 • FARMINGTON, NM 87499

1 of 1

OFF: (505) 325-5667



LAB: (505) 325-1556

ANALYTICAL REPORT

Date: 30-Jun-99

Client:	PNM - Public Service Company of NM	Client Sample Info:	Hare #15
Work Order:	9906053	Client Sample ID:	9906151205; 5ft.
Lab ID:	9906053-06A	Matrix:	SOIL
Project:	PNM Pit Remediation	Collection Date:	6/15/99 3:05:00 PM
		COC Record:	7611

Parameter	Result	PQL	Qual	Units	DF	Date Analyzed
DIESEL RANGE ORGANICS		SW8015B				Analyst: DC
T/R Hydrocarbons: C10-C28	1000	25		mg/Kg	1	6/28/99
AROMATIC VOLATILES BY GC/PID		SW8021B				Analyst: DC
Benzene	ND	250		µg/Kg	250	6/24/99
Toluene	25000	500		µg/Kg	250	6/24/99
Ethylbenzene	7400	250		µg/Kg	250	6/24/99
m,p-Xylene	96000	500		µg/Kg	250	6/24/99
o-Xylene	19000	250		µg/Kg	250	6/24/99

147400
147.4 ppm

Qualifiers:

- PQL - Practical Quantitation Limit
- ND - Not Detected at Practical Quantitation Limit
- J - Analyte detected below Practical Quantitation Limit
- B - Analyte detected in the associated Method Blank

- S - Spike Recovery outside accepted recovery limits
- R - RPD outside accepted recovery limits
- E - Value above quantitation range
- Surr: - Surrogate

P.O. BOX 2606 • FARMINGTON, NM 87499

1 of 1

Sec. 3 T29N R10W 4th PM
Burlington

Landfarm Drawing

App 92 cu yds

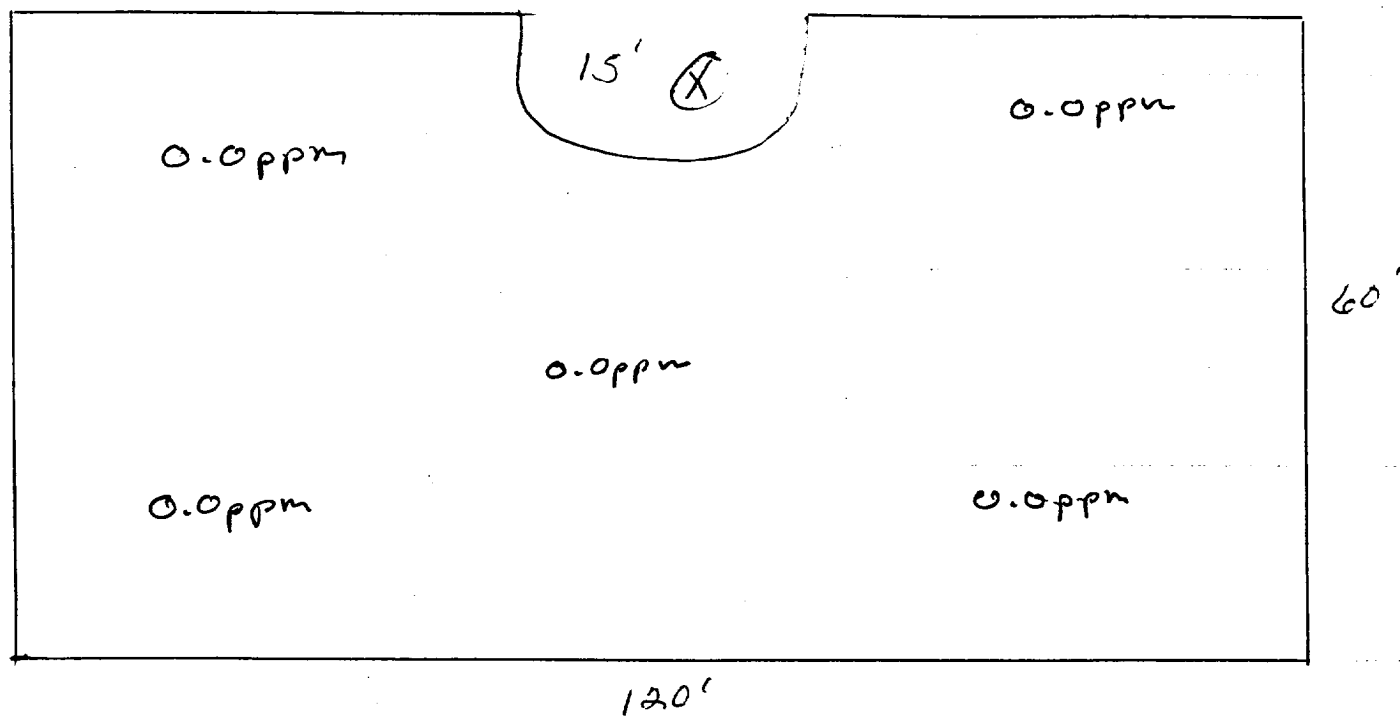

Not to scale

2" to 12" Depth
Headspace 9.5 ppm
Sample # 990714/333



On Site Technologies, LTD.

Date: 30-Jul-99

CLIENT: PNM - Public Service Company of NM
Project: PNM Pit Remediation Landfarms
Lab Order: 9907036

CASE NARRATIVE

Samples were analyzed using the methods outlined in the following references:

Test Methods for Evaluating Solid Waste, Physical/Chemical Methods, SW846, 3rd Edition

All method blanks, laboratory spikes, and/or matrix spikes met quality assurance objectives.

OFF: (505) 325-5667



LAB: (505) 325-1556

ANALYTICAL REPORT

Date: 30-Jul-99

Client:	PNM - Public Service Company of NM	Client Sample Info:	Hare 15 LF
Work Order:	9907036	Client Sample ID:	9907141333; 5pt Comp
Lab ID:	9907036-03A	Matrix:	SOIL
Project:	PNM Pit Remediation Landfarms	Collection Date:	7/14/99 1:33:00 PM
		COC Record:	7491

Parameter	Result	PQL	Qual	Units	DF	Date Analyzed
DIESEL RANGE ORGANICS		SW8015B				Analyst: DC
T/R Hydrocarbons: C10-C28	ND	25		mg/Kg	1	7/29/99

Qualifiers:

- PQL - Practical Quantitation Limit
- ND - Not Detected at Practical Quantitation Limit
- J - Analyte detected below Practical Quantitation Limit
- B - Analyte detected in the associated Method Blank

- S - Spike Recovery outside accepted recovery limits
- R - RPD outside accepted recovery limits
- E - Value above quantitation range
- Surr: - Surrogate

1 of 1

P.O. BOX 2606 • FARMINGTON, NM 87499

- TECHNOLOGY BLENDING INDUSTRY WITH THE ENVIRONMENT -