

Company.....Continental Oil Co.
Lease.....Well No. 134
Sec. 2....., T. 29 N....., R. 19 W N.M.P.M.

Location.....1900 ft. West of East line & 750 ft.
North of South line of Sect. 2, T29N, R19W, N.M.P.M.

Elevation on hub at ground - 5229.1

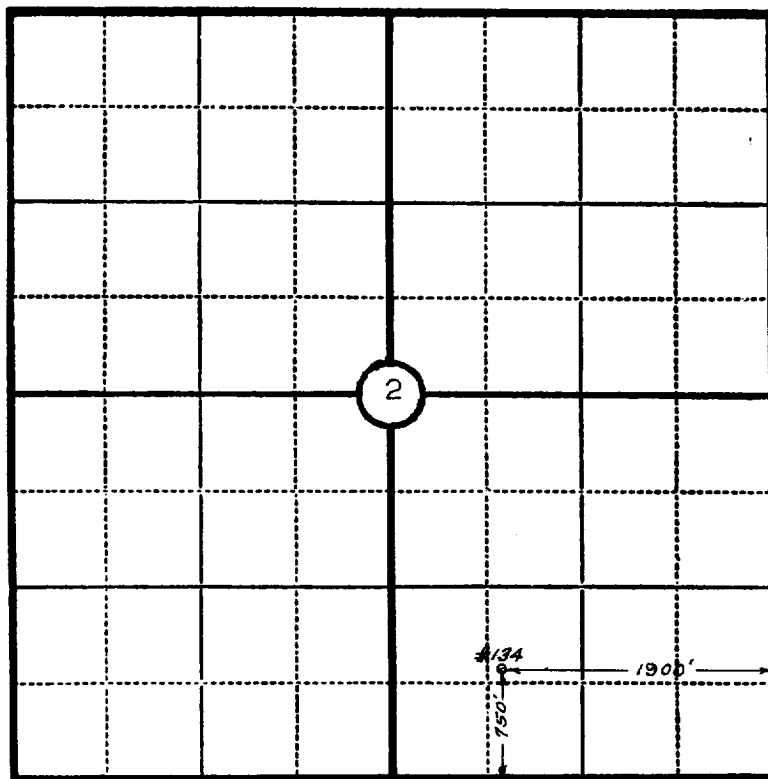

Scale—4 inches equal 1 mile.

This is to certify that the above plat was prepared from field notes of actual surveys made by me or under my supervision and that the same are true and correct to the best of my knowledge and belief.

Seal:

John H. Vealey, C.E.
7.24.1598
Registered Professional
Engineer and Land Surveyor.

Surveyed February 4 , 1953

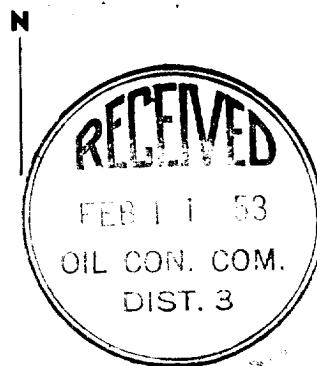

OIL CONSERVATION COMMISSION		
AZTEC DISTRICT OFFICE		
No. Copies Received 3		
DISTRIBUTION		
	NO. FURNISHED	
Operator		
Santa Fe		
Protection Office		
State Land Office		
U. S. G. S.		
Transporter		
File	1	/