

NEW MEXICO OIL CONSERVATION COMMISSION
WELL LOCATION AND ACREAGE DEDICATION PLAT

Form C-102
Supersedes C-108
Effective 1-1-65

All distances must be from the outer boundaries of the Section.

| | | | | | |
|---|---|-------------------------|---------------------------------------|---|----------------------|
| Operator EL PASO NATURAL GAS COMPANY | | | Lease FEUILLE A (SF-078197) | | Well No. 1 |
| Unit Letter I | Section 4 | Township 29-N | Range 10-W | County SAN JUAN | |
| Actual Footage Location of Well: 1527 feet from the SOUTH line and 869 feet from the EAST line | | | | | |
| Ground Level Elev. 5969 | Producing Formation FRUITLAND | | Pool AZTEC FRUITLAND EXT. | Dedicated Acreage: 146.46 Acres | |

1. Outline the acreage dedicated to the subject well by colored pencil or hachure marks on the plat below.
2. If more than one lease is dedicated to the well, outline each and identify the ownership thereof (both as to working interest and royalty).
3. If more than one lease of different ownership is dedicated to the well, have the interests of all owners been consolidated by communitization, unitization, force-pooling, etc?

☐ Yes ☐ No If answer is "yes," type of consolidation _____

If answer is "no," list the owners and tract descriptions which have actually been consolidated. (Use reverse side of this form if necessary.) _____

No allowable will be assigned to the well until all interests have been consolidated (by communitization, unitization, forced-pooling, or otherwise) or until a non-standard unit, eliminating such interests, has been approved by the Commission.

NOTE: THIS PLAT REISSUED TO SHOW DEDICATION CHANGE TO CONFORM TO RESURVEY. 10-7-69

NOTE: THIS PLAT REISSUED TO SHOW CHANGE IN FORMATION. 5-31-79

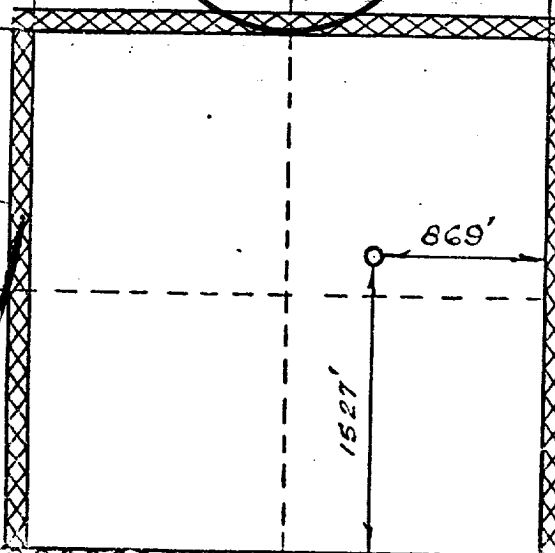
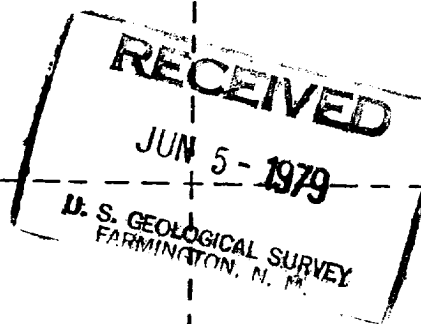
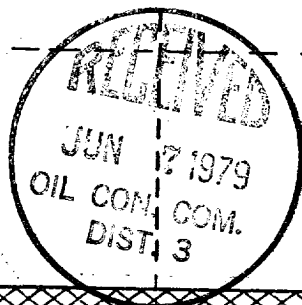

CERTIFICATION

I hereby certify that the information contained herein is true and complete to the best of my knowledge and belief.

D. P. Brisco

Name
Drilling Clerk

Position
El Paso Natural Gas

Company
June 5, 1979

Date

I hereby certify that the well location shown on this plat was plotted from field notes of actual surveys made by me or under my supervision, and that the same is true and correct to the best of my knowledge and belief.

Date Surveyed
NOVEMBER 18, 1952

Registered Professional Engineer and/or Land Surveyor

Certificate No.

NYMOCK

