

NEW MEXICO OIL CONSERVATION COMMISSION
Santa Fe, New Mexico

Form C-101
Revised (12/1/55)

NOTICE OF INTENTION TO DRILL

Notice must be given to the District Office of the Oil Conservation Commission and approval obtained before drilling or recompletion begins. If changes in the proposed plan are considered advisable, a copy of this notice showing such changes will be returned to the sender. Submit this notice in QUINTUPPLICATE. One copy will be returned following approval. See additional instructions in Rules and Regulations of the Commission. If State Land submit 6 Copies Attach Form C- 128 in triplicate to first 3 copies of form C-101

Farmington, New Mexico
(Place)

July 19, 1961
(Date)

OIL CONSERVATION COMMISSION
SANTA FE, NEW MEXICO

Gentlemen:

You are hereby notified that it is our intention to commence the Drilling of a well to be known as

ROY OWEN & COMPANY

(Company or Operator)

Donella
(Lease)

, Well No. 1, in P (Unit) The well is

located 990 feet from the South line and 330 feet from the

East line of Section 3, T. 29N, R. 15W, NMPM.

(GIVE LOCATION FROM SECTION LINE) Wildcat Pool, San Juan County

D	C	B	A
E	F	G	H
I	K	J	I
M	N	O	P

If State Land the Oil and Gas Lease is No.

If patented land the owner is John Brinkhall

Address Bloomfield, New Mexico

We propose to drill well with drilling equipment as follows: Rotary, surface to TD

The status of plugging bond is Current and on file

Drilling Contractor Century Drilling Company
Enterprise Bldg., Tulsa, Oklahoma
P.O. Box 1236, Farmington, New Mexico

We intend to complete this well in the Gallup formation at an approximate depth of 4,700 feet.

CASING PROGRAM

We propose to use the following strings of Casing and to cement them as indicated:

Size of Hole	Size of Casing	Weight per Foot	New or Second Hand	Depth	Sacks Cement
<u>12-1/2</u>	<u>8-5/8</u>	<u>24 #</u>	<u>New</u>	<u>120</u>	<u>75</u>
<u>7-7/8</u>	<u>4-1/2</u>	<u>9.5#</u>	<u>New</u>	<u>4700</u>	<u>100</u>

If changes in the above plans become advisable we will notify you immediately.

ADDITIONAL INFORMATION (If recompletion give full details of proposed plan of work.)

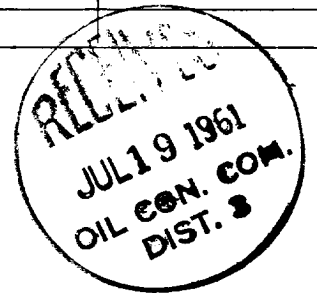

Approved 7-19, 1961
Except as follows:

Sincerely yours,

ROY OWEN & COMPANY

(Company or Operator)

By R. Owen

Position Owner

Send Communications regarding well to

Name Roy Owen & Co.

Address P. O. Box 838, Farmington, N.M.

OIL CONSERVATION COMMISSION

By Ernest A. [Signature]

NEW MEXICO OIL CONSERVATION COMMISSION
Well Location and Acreage Dedication Plat

Section A.

Date July 18, 1961

Operator Roy Owen & Co. Lease Donella
Well No. 1 Unit Letter P Section 3 Township 29N Range 15W NMPM
Located 990 Feet From South Line, 330 Feet From East Line
County San Juan G. L. Elevation 5156 Dedicated Acreage 40 Acres
Name of Producing Formation Gallup Pool Wildcat

1. Is the Operator the only owner* in the dedicated acreage outlined on the plat below?
Yes ☒ No ☐.
2. If the answer to question one is "no," have the interests of all the owners been consolidated by communitization agreement or otherwise? Yes ☐ No ☐. If answer is "yes," Type of Consolidation _____
3. If the answer to question two is "no," list all the owners and their respective interests below:

Owner

Land Description

Section B

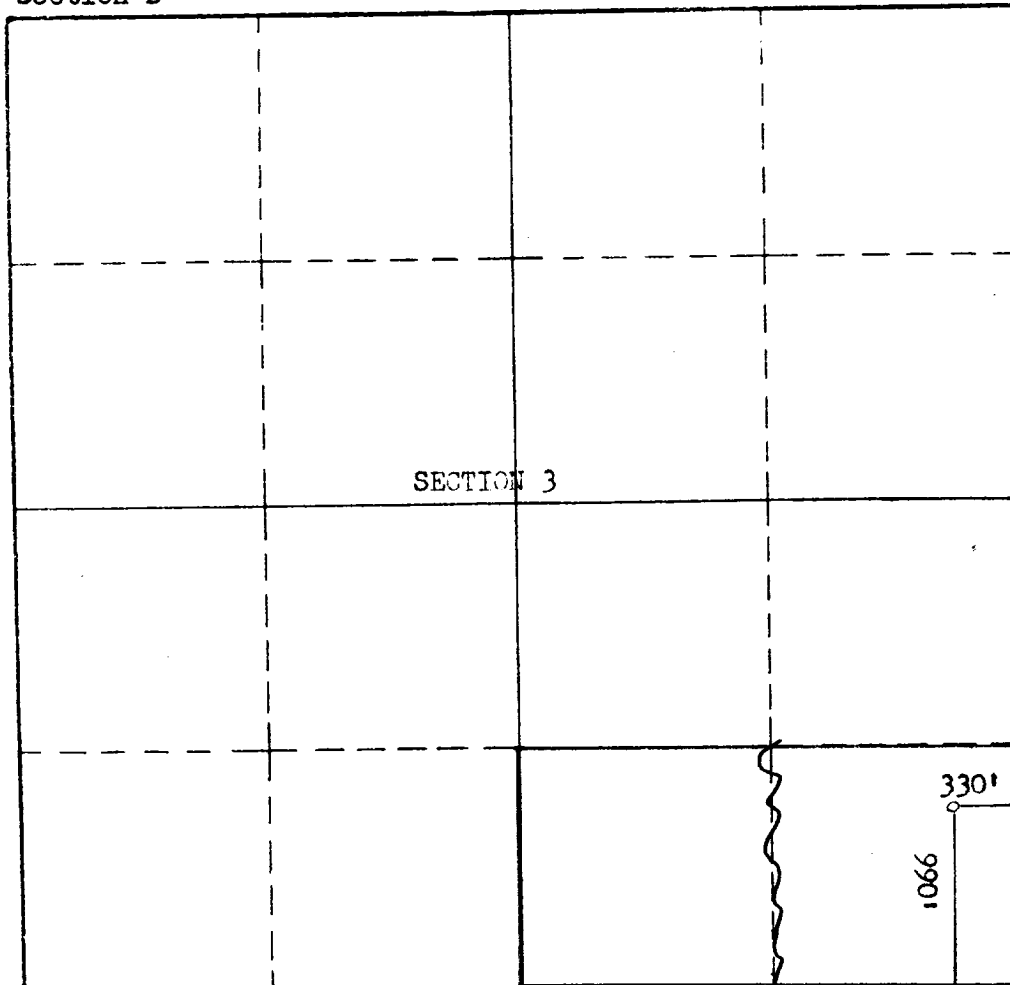

This is to certify that the information in Section A above is true and complete to the best of my knowledge and belief.

Roy Owen & Company
(Operator)

R. Owen
(Representative)

P. O. Box 838

Farmington, N.M.
Address

This is to certify that the well location shown on the plat in Section B was plotted from field notes of actual surveys made by me or under my supervision and that the same is true and correct to the best of my knowledge and belief.

Date Surveyed July 13, 1961

Stephen H. Kinney
STEPHEN H. KINNEY,

Registered Professional
Engineer and/or Land Surveyor.

Certificate No. 803

(See instructions for completing this form on the reverse side)