

DISTRICT I
P.O. Box 1980, Hobbs, NM 88240

DISTRICT II
P.O. Drawer DD, Artesia, NM 88210

DISTRICT III
1000 Rio Brazos Rd., Aztec, NM 87410

OIL CONSERVATION DIVISION
P.O. Box 2088
Santa Fe, New Mexico 87504-2088

WELL API NO.
5. Indicate Type of Lease STATE <input type="checkbox"/> FEE <input checked="" type="checkbox"/>
6. State Oil & Gas Lease No.
7. Lease Name or Unit Agreement Name Shiotani
8. Well No. #2
9. Pool name or Wildcat Fruitland Coals
10. Elevation (Show whether DF, RKB, RT, GR, etc.) 5401 GR

SUNDRY NOTICES AND REPORTS ON WELLS
(DO NOT USE THIS FORM FOR PROPOSALS TO DRILL OR TO DEEPEN OR PLUG BACK TO A DIFFERENT RESERVOIR. USE "APPLICATION FOR PERMIT" (FORM C-101) FOR SUCH PROPOSALS.)

1. Type of Well: OIL WELL <input type="checkbox"/> GAS WELL <input checked="" type="checkbox"/> OTHER
2. Name of Operator Maralex Resources, Inc.
3. Address of Operator P. O. Box 421, Blanco, NM 87401-0421
4. Well Location Unit Letter <u>K</u> : <u>1585</u> Feet From The <u>South</u> Line and <u>1680</u> Feet From The <u>West</u> Line Section <u>6</u> Township <u>29N</u> Range <u>12W</u> NMPM <u>San Juan</u> County
10. Elevation (Show whether DF, RKB, RT, GR, etc.) 5401 GR

11. Check Appropriate Box to Indicate Nature of Notice, Report, or Other Data	
NOTICE OF INTENTION TO:	SUBSEQUENT REPORT OF:
PERFORM REMEDIAL WORK <input type="checkbox"/>	REMEDIAL WORK <input type="checkbox"/>
PLUG AND ABANDON <input type="checkbox"/>	ALTERING CASING <input type="checkbox"/>
TEMPORARILY ABANDON <input type="checkbox"/>	COMMENCE DRILLING OPNS. <input type="checkbox"/>
CHANGE PLANS <input type="checkbox"/>	PLUG AND ABANDONMENT <input type="checkbox"/>
PULL OR ALTER CASING <input type="checkbox"/>	CASING TEST AND CEMENT JOB <input type="checkbox"/>
OTHER: <u>Run tbg & flow test</u> <input checked="" type="checkbox"/>	OTHER: <input type="checkbox"/>

12. Describe Proposed or Completed Operations (Clearly state all pertinent details, and give pertinent dates, including estimated date of starting any proposed work) SEE RULE 1103.

Run 2 3/8" tubing to the Pictured Cliffs for a 3 to 4 day flow test prior to recompleting to the Fruitland formation.

Request a verbal approval.

RECEIVED
DEC 15 1992
OIL CON. DIV
DIST 3

I hereby certify that the information above is true and complete to the best of my knowledge and belief.

SIGNATURE A. M. O'Hare TITLE President DATE 12/11/92
TYPE OR PRINT NAME TELEPHONE NO.

(This space for State Use)

APPROVED BY Erica Burch DEPUTY OIL & GAS INSPECTOR, DIST. #3 DATE DEC 22 1992
CONDITIONS OF APPROVAL, IF ANY:

OIL CONSERVATION DIVISION

DISTRICT I
P.O. Box 1980, Hobbs, NM 88240

P.O. Box 2088
Santa Fe, New Mexico 87504-2088

DISTRICT II
P.O. Drawer DD, Artesia, NM 88210

DISTRICT III
1000 Rio Brazos Rd., Aztec, NM 87410

WELL LOCATION AND ACREAGE DEDICATION PLAT

All Distances must be from the outer boundaries of the section

Operator Maralex Resources, Inc.			Lease Shiotani		Well No. #2
Unit Letter K	Section 6	Township 29N	Range 12W	County NMPM San Juan	
Actual Footage Location of Well:					
1585 feet from the South line and		1680 feet from the West line			
Ground level Elev. 5401 GR	Producing Formation Pictured Cliffs	Pool Fruitland Coals	Dedicated Acreage: 320 Acres		

1. Outline the acreage dedicated to the subject well by colored pencil or hatchure marks on the plat below.

2. If more than one lease is dedicated to the well, outline each and identify the ownership thereof (both as to working interest and royalty).

3. If more than one lease of different ownership is dedicated to the well, have the interest of all owners been consolidated by communitization, unitization, force-pooling, etc.?

☐ Yes ☐ No If answer is "yes" type of consolidation _____

If answer is "no" list the owners and tract descriptions which have actually been consolidated. (Use reverse side of this form if necessary.) _____

No allowable will be assigned to the well until all interests have been consolidated (by communitization, unitization, forced-pooling, or otherwise) or until a non-standard unit, eliminating such interest, has been approved by the Division.

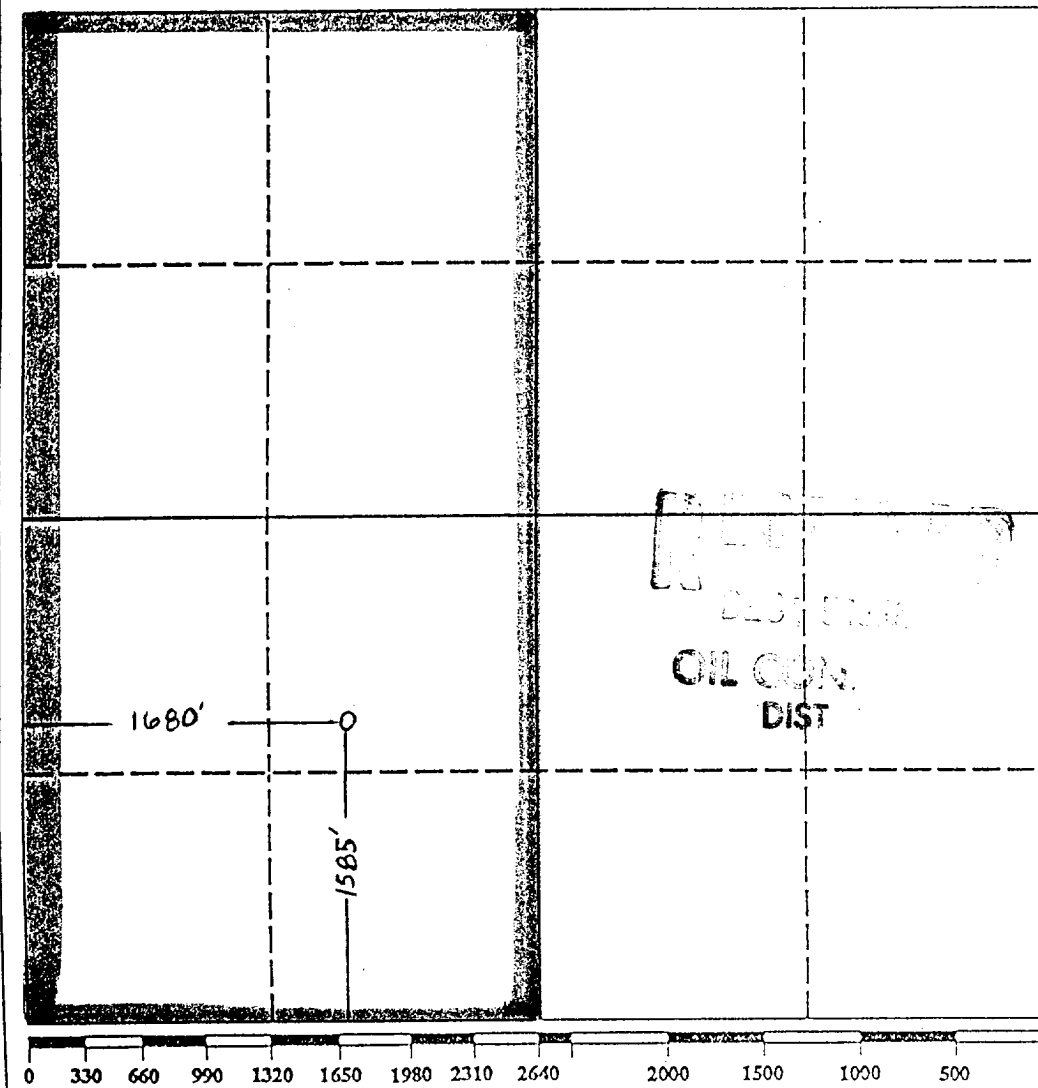

OPERATOR CERTIFICATION

I hereby certify that the information contained herein is true and complete to the best of my knowledge and belief.

Signature

A. M. O'Hare

Printed Name

A. M. O'Hare

Position

President

Company

Maralex Resources, Inc.

Date

12-14-92

SURVEYOR CERTIFICATION

I hereby certify that the well location shown on this plat was plotted from field notes of actual surveys made by me or under my supervision, and that the same is true and correct to the best of my knowledge and belief.

Date Surveyed

Signature & Seal of Professional Surveyor

Certificate No.

Date December 10, 1992Operator Maralex Resources, Inc. Lease Shiotani

Well No. 2 Unit Letter K Section 6 Township 29 NORTH Range 12 WEST NMPM
 Located 1585 Feet From THE SOUTH Line, 1680 Feet From THE WEST Line
 County SAN JUAN G. L. Elevation 5393.02 Dedicated Acreage .60 Acres
 Name of Producing Formation Pictured Cliffs Pool Kutz Canyon

Is the Operator the only owner* in the dedicated acreage outlined on the plat below?

Yes X No

If the answer to question one is "no," have the interests of all the owners been consolidated by communitization agreement or otherwise? Yes No . If answer is "yes," Type of Consolidation

If the answer to question two is "no," list all the owners and their respective interests below:

REF. G.L.O. PLAT DATED 7 APRIL 1881

OwnerLand Description

Section B

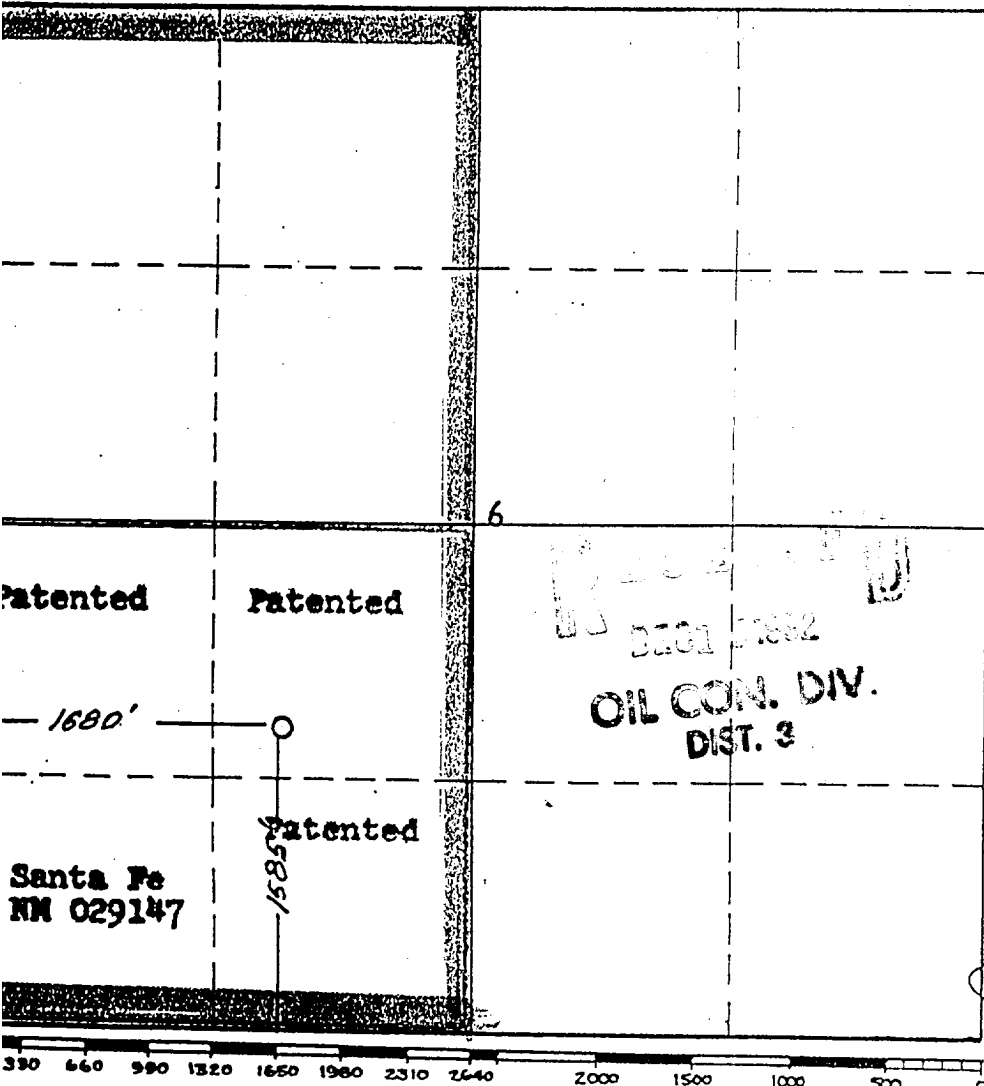

This is to certify that the information in Section A above is true and complete to the best of my knowledge and belief.

Maralex Resources, Inc.

(Operator)

(Representative)

A.M. O'Hare/President

PO Box 421, Blanco, NM 87412
 Address

This is to certify that the well location shown on the plat in Section B was plotted from field notes of actual surveys made by me or under my supervision and that the same is true and correct to the best of my knowledge and belief.

Date Surveyed 2 JANUARY 1958

James P. Leese
 Registered Professional
 Engineer and/or Land Surveyor.

JAMES P. LEESE

Certificate No. 1463

(See instructions for completing this form on the reverse side)