

NEW MEXICO OIL CONSERVATION COMMISSION

Well Location and Acreage Dedication Plat

Section A.

Date April 5, 1961

Operator Roy Owen & Co. Lease Champ
Well No. 4-1 Unit Letter 1 Section 4 Township 29 N Range 16 W NSPM
Located 2210 Feet From south Line, 660 Feet From east Line
County San Juan G. L. Elevation _____ Dedicated Acreage NE/SE 40 Acres
Name of Producing Formation Wildcat Pool _____

1. Is the Operator the only owner* in the dedicated acreage outlined on the plat below?
Yes x No _____.
2. If the answer to question one is "no," have the interests of all the owners been consolidated by communitization agreement or otherwise? Yes _____ No _____. If answer is "yes," Type of Consolidation _____
3. If the answer to question two is "no," list all the owners and their respective interests below:

Owner

Land Description

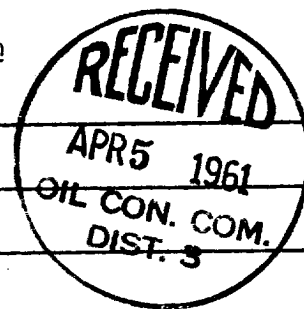

Section B

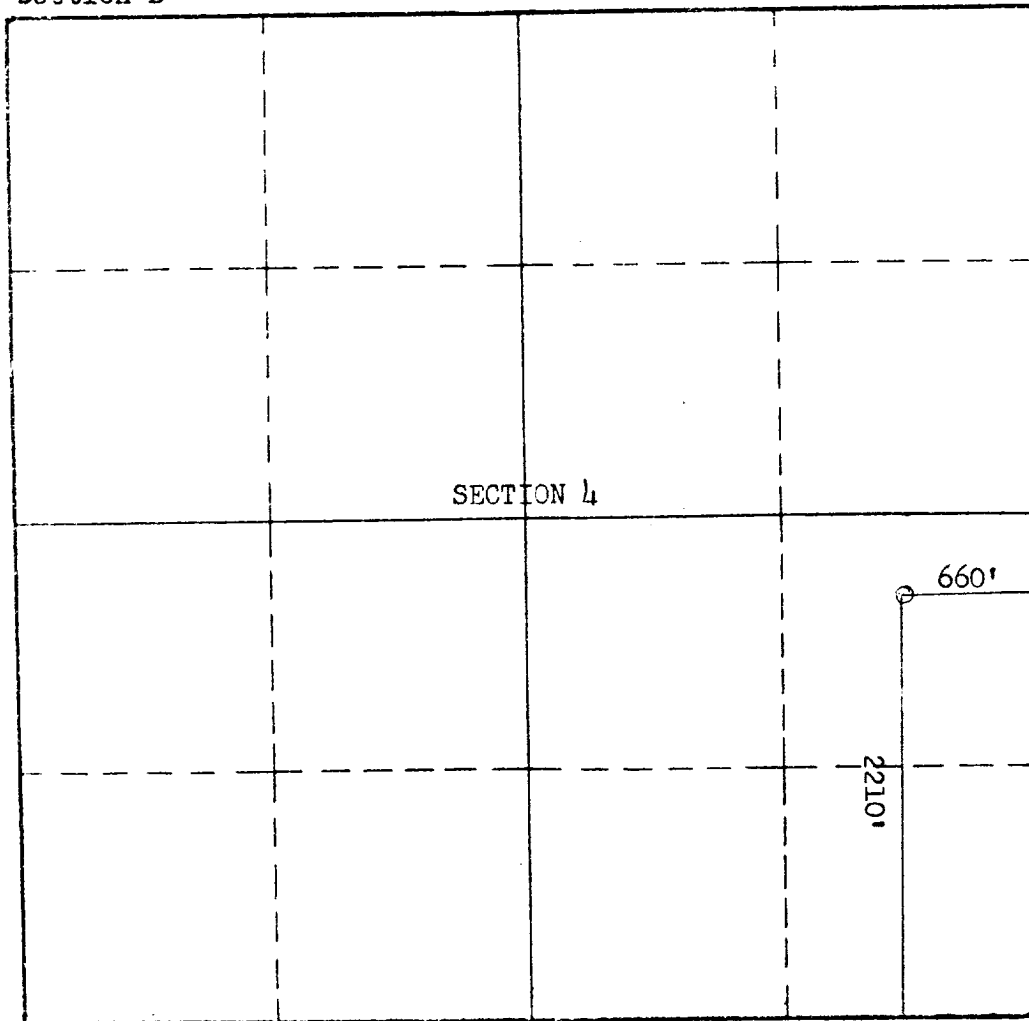

This is to certify that the information in Section A above is true and complete to the best of my knowledge and belief.

Roy Owen & Co.

(Operator)

R. Owen

(Representative)

P. O. Box 838

Farmington, New Mexico

Address

This is to certify that the well location shown on the plat in Section B was plotted from field notes of actual surveys made by me or under my supervision and that the same is true and correct to the best of my knowledge and belief.

Date Surveyed April 5, 1961

Stephen H. Kinney
STEPHEN H. KINNEY,

Registered Professional
Engineer and/or Land Surveyor.

Certificate No. 803