

(SUBMIT IN TRIPLICATE)

Indian Agency

UNITED STATES
DEPARTMENT OF THE INTERIOR
GEOLOGICAL SURVEY

Allottee

Lease No. 1-113-Ind.-5723-1

SUNDRY NOTICES AND REPORTS ON WELLS

NOTICE OF INTENTION TO DRILL	<input checked="" type="checkbox"/>	SUBSEQUENT REPORT OF WATER SHUT-OFF	
NOTICE OF INTENTION TO CHANGE PLANS		SUBSEQUENT REPORT OF SHOOTING OR ACIDIZING	
NOTICE OF INTENTION TO TEST WATER SHUT-OFF		SUBSEQUENT REPORT OF ALTERING CASING	
NOTICE OF INTENTION TO REDRILL OR REPAIR WELL		SUBSEQUENT REPORT OF REDRILLING OR REPAIR	
NOTICE OF INTENTION TO SHOOT OR ACIDIZE		SUBSEQUENT REPORT OF ABANDONMENT	FEB 9 1961
NOTICE OF INTENTION TO PULL OR ALTER CASING		SUPPLEMENTARY WELL HISTORY	
NOTICE OF INTENTION TO ABANDON WELL			

(INDICATE ABOVE BY CHECK MARK NATURE OF REPORT, NOTICE, OR OTHER DATA)

U. S. GEOLOGICAL SURVEY
FARMINGTON, NEW MEXICO

Feb. 8, 1961

Well No. 1 is located 1900 ft. from N line and 1900 ft. from W line of sec. 2

SE/4 NW/4
(1/4 Sec. and Sec. No.)

29N
(Twp.)

17W
(Range)

N.M.P.M.
(Meridian)

Wildcat
(Field)

San Juan
(County or Subdivision)

New Mexico
(State or Territory)

The elevation of the derrick floor above sea level is 1950 ft.

DETAILS OF WORK

(State names of and expected depths to objective sands; show sizes, weights, and lengths of proposed casings; indicate mudding jobs, cementing points, and all other important proposed work)

Op rates will use a C. T. Rig to drill a 12 1/2" hole to a depth of 90', run 90' of 8 5/8" J55, 2 3/4" Surface pipe, cement surface by circulating cement, allow 18 hours for cement to set and test cement to insure that all water zones are sealed off. A 6" C.T. hole will then be drilled through the Gallup Formation or to a depth of 500' and test for production.

I understand that this plan of work must receive approval in writing by the Geological Survey before operations may be started.

Company Henderson-Stephens, Agent for Century Exploration Co.,

Address Room 125, Petr. Center Bldg.

Farmington

BY Henderson E. Stephens

Title Partner

NUMBER OF COPIES RECEIVED	
DISTRIBUTION	
SANTA FE	
FILE	
U.S.G.S.	
LAND OFFICE	
TRANSPORTER	OIL GAS
PRODUCTION OFFICE	
OPERATOR	

NEW MEXICO OIL CONSERVATION COMMISSION
WELL LOCATION AND ACREAGE DEDICATION PLAT
SEE INSTRUCTIONS FOR COMPLETING THIS FORM ON THE REVERSE SIDE

FORM C-128
Revised 5/1/57

SECTION A

Operator HENDERSON - STEPHENS <i>Agent for Century Exploration Co.</i>				Well No. 1	
Unit Letter F	Section 2	Township 29 NORTH	Range 17 WEST	County SAN JUAN	
Actual Footage Location of Well: 1980 feet from the NORTH line and 1980 feet from the WEST line					
Ground Level Elev. 4951.0	Producing Formation Gallegos	Pool Gallegos (11000)	Dedicated Acreage: 10 Acres		

Ref: GLO plat dated 12 February 1915

1. Is the Operator the only owner in the dedicated acreage outlined on the plat below? YES ☒ NO ☐ ("Owner" means the person who has the right to drill into and to produce from any pool and to appropriate the production either for himself or for himself and another. (65-3-29 (e) NMSA 1935 Comp.)
2. If the answer to question one is "no," have the interests of all the owners been consolidated by communitization agreement or otherwise? YES ☐ NO ☐ If answer is "yes," Type of Consolidation _____
3. If the answer to question two is "no," list all the owners and their respective interests below:

Owner	Land Description

SECTION B

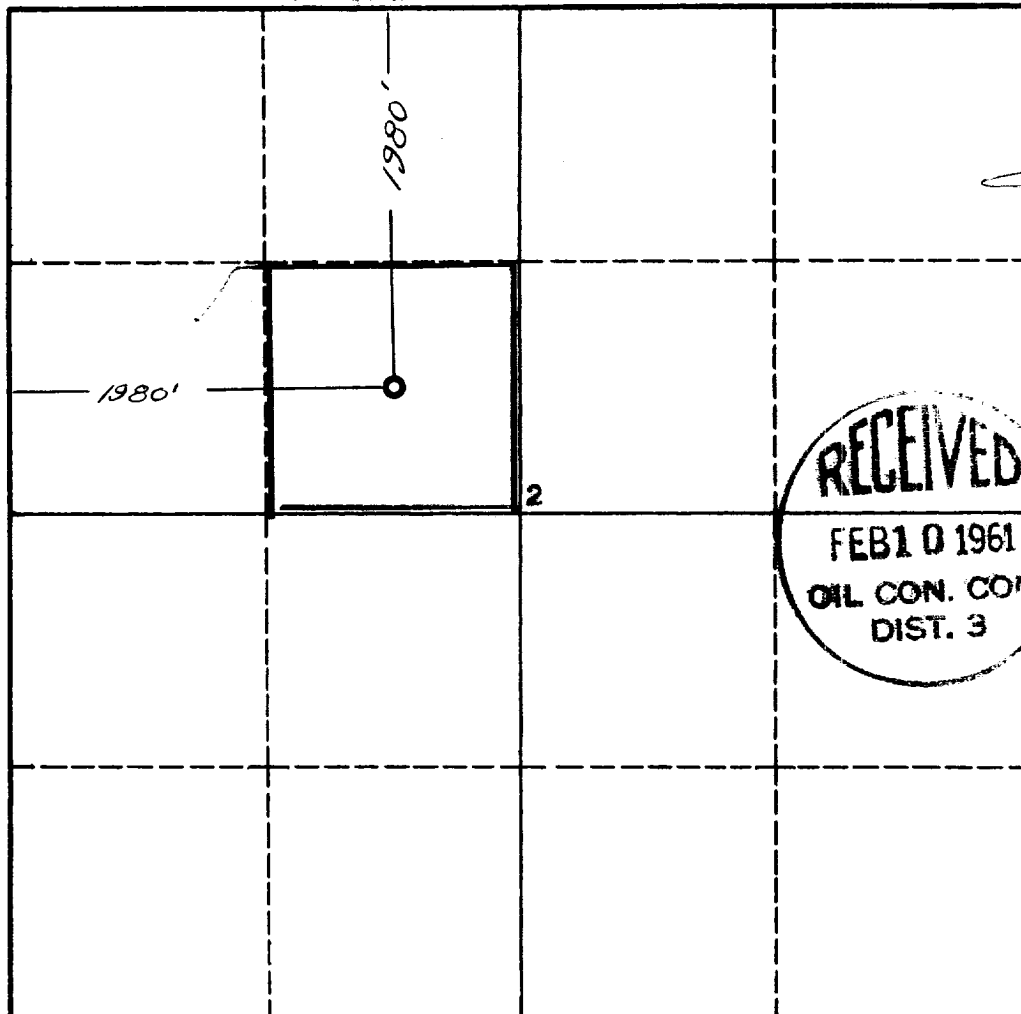

**U.S. GEOLOGICAL SURVEY
CERTIFICATION**

I hereby certify that the information in SECTION A above is true and complete to the best of my knowledge and belief.

Robert E. Henderson

Name HENDERSON
Position Henderson-Stephens
Company Feb. 8, 1961
Date

RECEIVED

**FEB 10 1961
OIL CON. COM.
DIST. 3**

I hereby certify that the well location shown on the plat in SECTION B was plotted from field notes of actual surveys made by me or under my supervision, and that the same is true and correct to the best of my knowledge and belief.

Date Surveyed 3 February 1961
Registered Professional Engineer and/or Land Surveyor <i>James P. Leese</i> James P. Leese
Certificate No. 1463

0 330 660 990 1320 1650 1980 2310 2640 2000 1500 1000 500 0

INSTRUCTIONS FOR COMPLETION OF FORM C-128

1. Operator shall furnish and certify to the information called for in Section A.
2. Operator shall outline the dedicated acreage for *both* oil and gas wells on the plat in Section B.
3. A registered professional engineer or land surveyor registered in the State of New Mexico or approved by the Commission shall show on the plat the location of the well and certify this information in the space provided.
4. All distances shown on the plat must be from the outer boundaries of the Section.
5. If additional space is needed for listing owners and their respective interests as required in question 3 of Section A, please use space below.