

NEW MEXICO OIL CONSERVATION COMMISSION
Santa Fe, New Mexico

Form G-101
Revised (12/1/55)

NOTICE OF INTENTION TO DRILL

Notice must be given to the District Office of the Oil Conservation Commission and approval obtained before drilling or recompletion begins. If changes in the proposed plan are considered advisable, a copy of this notice showing such changes will be returned to the sender. Submit this notice in QUINTUPPLICATE. One copy will be returned following approval. See additional instructions in Rules and Regulations of the Commission. If State Land submit 6 Copies Attach Form G- 128 in triplicate to first 3 copies of form G-101

Durango, Colorado
(Place)

August 25, 1958
(Date)

OIL CONSERVATION COMMISSION
SANTA FE, NEW MEXICO

Gentlemen:

You are hereby notified that it is our intention to commence the Drilling of a well to be known as

Continental Oil Company

(Company or Operator)

Rattlesnake

(Lease)

Well No. 135, in A The well is

(Unit)

located 660 feet from the North line and 660 feet from the

East line of Section 1, T. 29N, R. 19W, NMPM.

(GIVE LOCATION FROM SECTION LINE) Wildest Pool, San Juan County

If State Land the Oil and Gas Lease is No.

If patented land the owner is.

Address.

We propose to drill well with drilling equipment as follows: Rotary tools from
Surface to total depth.

The status of plugging bond is Blanket bond

Drilling Contractor Aspen Drilling Co.
Denver, Colorado

We intend to complete this well in the Pennsylvania formation at an approximate depth of 7200 feet.

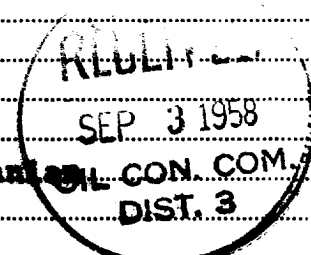

CASING PROGRAM

We propose to use the following strings of Casing and to cement them as indicated:

Size of Hole	Size of Casing	Weight per Foot	New or Second Hand	Depth	Sacks Cement
12"	10 3/4"	32.75#	New	200'	300
9 7/8"	7 5/8"	24#	New	2800'	900
6 5/8"	5 1/2"	see below*	New	7200'	400
* 5300' 14# STAC, 1500' 15.5# STAC, 400' 17# STAC					

If changes in the above plans become advisable we will notify you immediately.

ADDITIONAL INFORMATION (If recompletion give full details of proposed plan of work.)

In the event that unconsolidated sands or water flows are encountered, the 7 5/8" intermediate string will be run and cemented. If commercial production is found, the well will be completed and production casing run and cemented per above schedule.

Approved 7-3, 19 58
Except as follows:

Sincerely yours,

Continental Oil Company

(Company or Operator)
ORIGINAL SIGNED BY:

By BURTON HALL

Position District Superintendent

Send Communications regarding well to

Name Burton Hall

Address Box 3312, Durango, Colorado

OIL CONSERVATION COMMISSION

By [Signature]

NEW MEXICO OIL CONSERVATION COMMISSION
Well Location and Acreage Dedication Plat

Section A.

Date August 25, 1958

Operator Continental Oil Company Lease Rattlesnake
Well No. 135 Unit Letter A Section 1 Township 29N Range 19W NMPM
Located 660 Feet From North Line, 660 Feet From East Line
County San Juan G. L. Elevation 5327 Dedicated Acreage Unknown 40 Acres
Name of Producing Formation Pennsylvanian Pool Wildcat

1. Is the Operator the only owner* in the dedicated acreage outlined on the plat below?
Yes X No _____.
2. If the answer to question one is "no," have the interests of all the owners been consolidated by communitization agreement or otherwise? Yes _____ No _____. If answer is "yes," Type of Consolidation _____
3. If the answer to question two is "no," list all the owners and their respective interests below:

Owner

Land Description



Section B

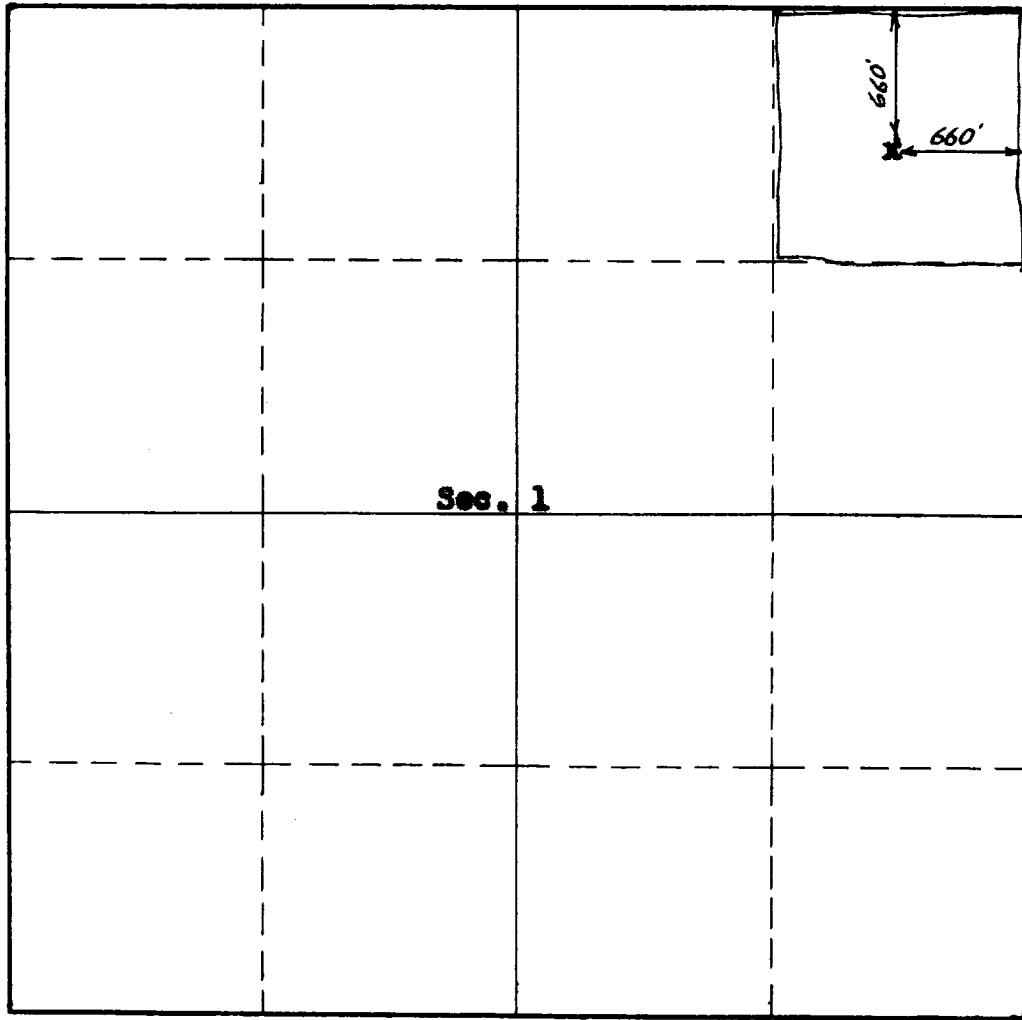

This is to certify that the information in Section A above is true and complete to the best of my knowledge and belief.

Continental Oil Co.

(Operator)
ORIGINAL SIGNED BY:
BURTON HALL

(Representative)

Box 3312, Durango, Colo.
Address

This is to certify that the well location shown on the plat in Section B was plotted from field notes of actual surveys made by me or under my supervision and that the same is true and correct to the best of my knowledge and belief.

Date Surveyed August 22, 1958

Elmer M. Clark
Registered Professional
Engineer and/or Land Surveyor.

(See attached)

Certificate No. Colo. #2279

(See instructions for completing this form on the reverse side)

0 330 660 990 1320 1650 1980 2310 2640 2000 1500 1000 500 0

INSTRUCTIONS FOR COMPLETION:

1. Operator shall furnish and certify to the information called for in Section A.
2. Operator shall outline the dedicated acreage for both oil and gas wells on the plat in Section B.
3. A registered professional engineer or land surveyor registered in the State of New Mexico or approved by the Commission shall show on the plat the location of the well and certify this information in the space provided.
4. All distances shown on the plat must be from the outer boundaries of Section.
5. If additional space is needed for listing owners and their respective interests as required in question 3, Section A, please use space below

* "Owner" means the person who has the right to drill into and to produce from any pool and to appropriate the production either for himself or for himself and another. (65-3-29 (e) NMSA 1953 Comp.)

CERTIFICATE OF SURVEY

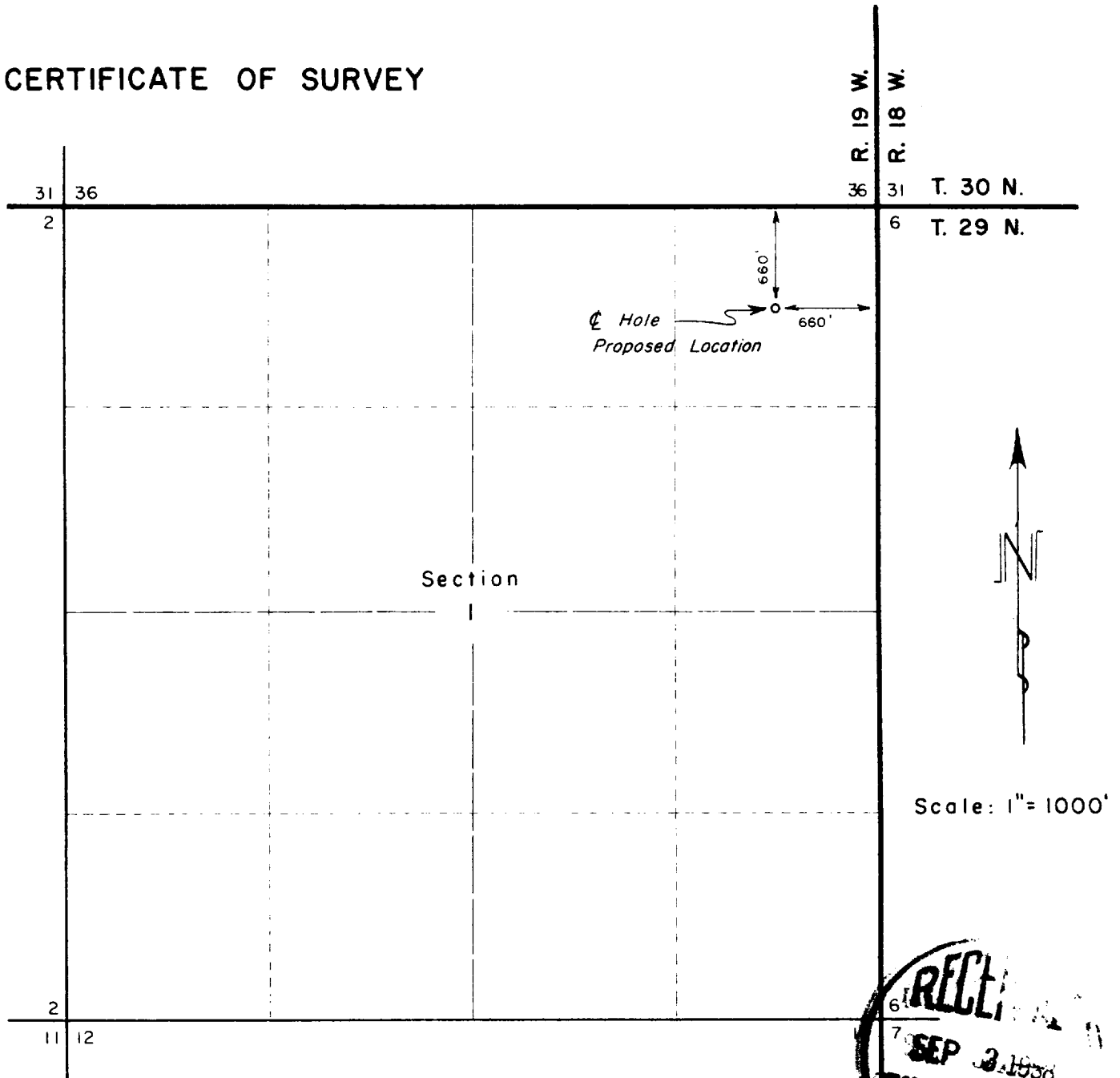

WELL LOCATION: Continental Oil Co. — Rattlesnake No. 135

Located 660 feet South of the North line and 660 feet West of the East line of Section 1.
 Township 29 North Range 19 West New Mexico Principal Meridian
 San Juan County, New Mexico
 Existing ground elevation determined at 5327 feet based on U.S.G.S. datum.

I hereby certify the above plat represents a survey made under my supervision and is accurate to the best of my knowledge and belief.

Elmer M. Clark
 ELMER M. CLARK
 Registered Land Surveyor
 State of Colo. (No. 2279)

PLANET ENGINEERS, INC.
 Durango, Colorado
 August 25, 1958

OIL CONSERVATION COMMISSION

AZTEC DISTRICT OFFICE

No. Copies Received 2

DISTRIBUTION

	NO. FURNISHED	
Operator	1	
Santa Fe	1	
Proration Office		
State Land Office		
U. S. G. S.	2	
Transporter		
File	1	<input checked="" type="checkbox"/>