

COPY

(SUBMIT IN TRIPLICATE)

			X
Sec.	1		

UNITED STATES
DEPARTMENT OF THE INTERIOR
GEOLOGICAL SURVEY

Indian Agency Navajo
1-89-IND-56
Allottee _____
Lease No. _____

Conoco Lease No. 6780

SUNDRY NOTICES AND REPORTS ON WELLS

NOTICE OF INTENTION TO DRILL	<input checked="" type="checkbox"/>	SUBSEQUENT REPORT OF WATER SHUT-OFF	
NOTICE OF INTENTION TO CHANGE PLANS		SUBSEQUENT REPORT OF SHOOTING OR ACIDIZING	
NOTICE OF INTENTION TO TEST WATER SHUT-OFF		SUBSEQUENT REPORT OF ALTERING CASING	
NOTICE OF INTENTION TO REDRILL OR REPAIR WELL		SUBSEQUENT REPORT OF REDRILLING OR REPAIR	
NOTICE OF INTENTION TO SHOOT OR ACIDIZE		SUBSEQUENT REPORT OF ABANDONMENT	
NOTICE OF INTENTION TO PULL OR ALTER CASING		SUPPLEMENTARY WELL HISTORY	
NOTICE OF INTENTION TO ABANDON WELL			

(INDICATE ABOVE BY CHECK MARK NATURE OF REPORT, NOTICE, OR OTHER DATA)

August 25, 1958

Well No. 135 is located 660ft. from [N] line and 660 ft. from [E] line of sec. 1

NE 1/4 Sec. 1 29N 19W NMPM
(1/4 Sec. and Sec. No.) (Twp.) (Range) (Meridian)
Rattlesnake San Juan New Mexico
(Field) (County or Subdivision) (State or Territory)

The elevation of the derrick floor above sea level is 5336 ft.

DETAILS OF WORK

(State names of and expected depths to objective sands; show sizes, weights, and lengths of proposed casings; indicate mudding jobs, cementing points, and all other important proposed work)

We propose to drill this well with rotary tools to an estimated depth of 7200', to test the Pennsylvanian formation. Approximately 200' of 10 3/4" surface casing will be run and cemented, and if unconsolidated sands or water flows are encountered, approximately 2800' of 7 5/8" intermediate casing will be run and cemented. If commercial production is found, a string of 5 1/2" production casing will be run and the well completed.

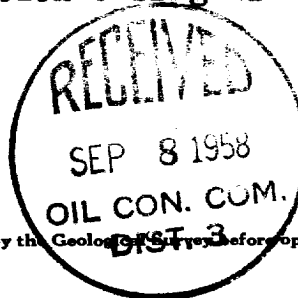

I understand that this plan of work must receive approval in writing by the Geological Survey before operations may be commenced.

Company Continental Oil Co.

Address Box 3312
Durango, Colorado

ORIGINAL SIGNED BY:
By BURTON HALL

Title District Superintendent

CERTIFICATE OF SURVEY

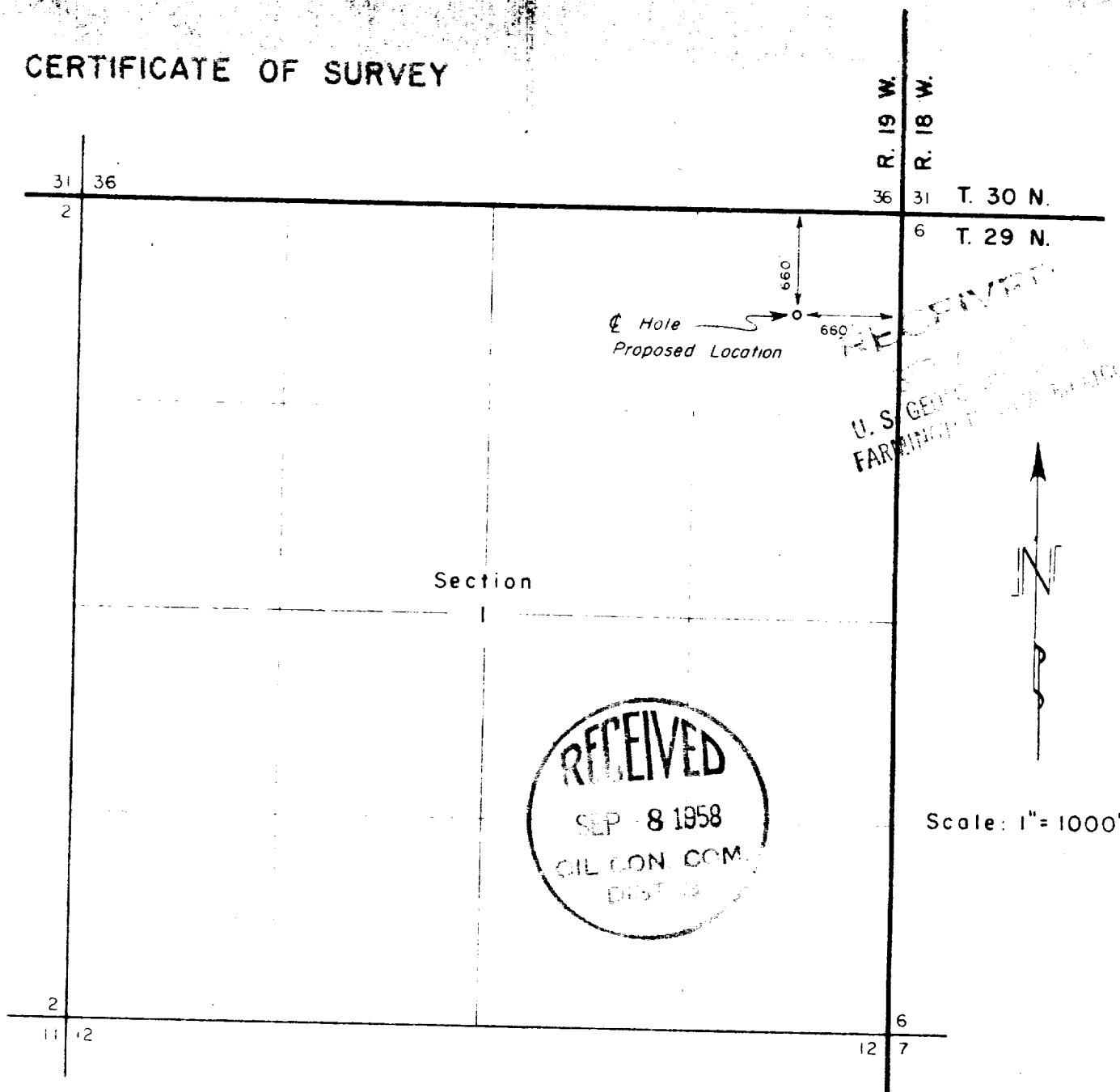

WELL LOCATION: Continental Oil Co. — Rattlesnake No. 135

Located 660 feet South of the North line and 660 feet West of the East line of Section 1,
 Township 29 North Range 19 West New Mexico Principal Meridian
 San Juan County, New Mexico
 Existing ground elevation determined at 5327 feet based on U.S.G.S. datum.

I hereby certify the above plot represents a survey made under my supervision and is accurate to the best of my knowledge and belief.

Elmer M. Clark
ELMER M. CLARK
 Registered Land Surveyor
 State of Colo. (No. 2279)

PLANET ENGINEERS, INC.
 Durango, Colorado
 August 25, 1958