

District I
P O Box 1980 Santa Fe, NM

District II
P O Drawer 90, Aztec, NM 87421

District III
1000 Rio Brazos Rd. Aztec, NM 87410

State of New Mexico
Energy, Minerals and Natural Resources Department

SUBMIT 1 COPY TO
APPROPRIATE
DISTRICT OFFICE
AND 1 COPY TO
SANTA FE OFFICE

Denny S. Faust
DEPUTY OIL & GAS INSPECTOR

OIL CONSERVATION DIVISION

2040 South Pacheco Street
Santa Fe, New Mexico 87505

FEB 28 1997

PIT REMEDIATION AND CLOSURE REPORT

RECEIVED
OCT 31 1996

OIL CON. DIV.
DIST. 3

Operator: PNM Gas Services (Amoco)		Telephone: 324-3764	
Address: 603 W. Elm Street Farmington, NM 87401			
Facility or Well Name: Archuleta #1			
Location:	Unit: M	Sec. 19	T. 30 N R. 8 W County San Juan
Pit Type:	Separator	Dehydrator <input checked="" type="checkbox"/>	Other
Land Type:	BLM <input checked="" type="checkbox"/>	State	Fee Other
Pit Location:	Pit dimensions: length 15 width 15 depth 3.5		
(Attach diagram)	Reference: wellhead <input checked="" type="checkbox"/> other		
	Footage from reference: 90'		
	Direction from reference: 15 Degrees East North <input checked="" type="checkbox"/>		
	West of South		
Depth to Ground Water:	Less than 50 feet (20 points) 50 feet to 99 feet (10 points) Greater than 100 feet (0 points)		10
<small>(Vertical distance from contaminants to seasonal high water elevation of ground water)</small>			
Wellhead Protection Area:	Yes (20 points) No (0 points)		0
<small>(Less than 200 feet from a private domestic water source, or, less than 1,000 feet from all other water sources)</small>			
Distance to Surface Water:	Less than 200 feet (20 points) 200 feet to 1,000 feet (10 points) Greater than 1,000 feet (0 points)		0
<small>(Horizontal distance to perennial lakes, ponds, rivers, streams, creeks, irrigation canals and ditches)</small>			
RANKING SCORE (TOTAL POINTS):			10

Date Remediation Started: 9/20/94 Date Completed: 11/16/94

Remediation Method: Excavation X Approx. Cubic Yard 1044

(Check all appropriate sections)

Landfarmed X Amount Landfarmed (cubic yds) 1044

Other _____

Remediation Location: Onsite X Offsite _____

(i.e., landfarmed onsite, name and location of offsite facility)

Backfill Material Location: _____

General Description of Remedial Action:

Excavated contaminated soil and landfarmed soil onsite within a bermed area at a depth of 6" to 12". Soil will be aerated by plowing/disking until soil meets regulatory levels.

Ground Water Encountered: No ✓ Yes _____ Depth _____

Final Pit Closure Sampling:

Sample Location Center of pit

(if multiple samples, attach sample result and diagram of sample locations and depths.)

Sample depth 13'

Sample date 11/16/94 Sample time 9:45:00 AM

Sample Results

Benzene (ppm) ND

Total BTEX (ppm) ND

Field headspace (ppm) _____

TPH ND Method 418.1

Vertical Extent (ft) _____ Risk Assessment form attached Yes _____ No ✓

Ground Water Sample: Yes _____ No ✓ (If yes, attach sample results)

I HEREBY CERTIFY THAT THE INFORMATION ABOVE IS TRUE AND COMPLETE TO THE BEST OF MY KNOWLEDGE AND MY BELIEF

DATE October 25, 1996

SIGNATURE Maureen Gannon

PRINTED NAME Maureen Gannon

AND TITLE Environmental Engineer

Shit-tu-en Granby

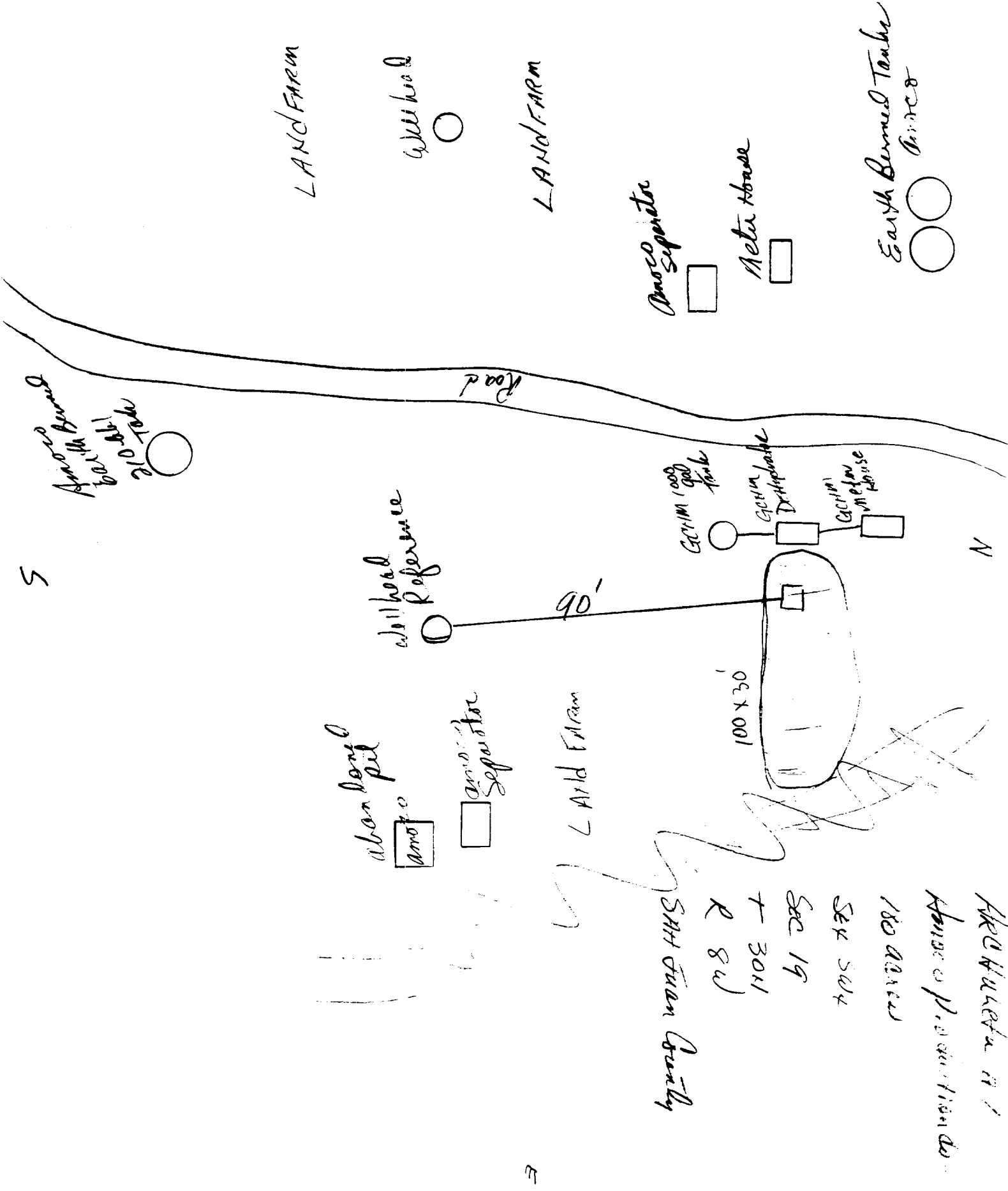

VOLATILE AROMATIC HYDROCARBONS

Gas Company of New Mexico

Project ID: Pit Pilot Project
Sample ID: Archuleta 1 - 10 - S
Lab ID: 0450
Sample Matrix: Soil
Preservative: Cool
Condition: Intact

Report Date: 11/28/94
Date Sampled: 11/16/94
Date Received: 11/16/94
Date Extracted: 11/21/94
Date Analyzed: 11/21/94

Target Analyte	Concentration (ug/kg)	Detection Limit (ug/kg)
Benzene	ND	9.63
Toluene	ND	9.63
Ethylbenzene	ND	9.63
m,p-Xylenes	ND	19.3
o-Xylene	ND	9.63

ND - Analyte not detected at the stated detection limit.

Quality Control:

Surrogate
Trifluorotoluene
Bromofluorobenzene

Percent Recovery
94
98

Acceptance Limits
81 - 117%
74 - 121%

Reference:

Method 5030, Purge and Trap; Method 8020, Aromatic Volatile Organics; Test Methods for Evaluating Solid Wastes, SW-846, United States Environmental Protection Agency, Final Update I, July, 1992.

Comments:

Analyst

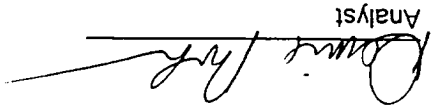

Review

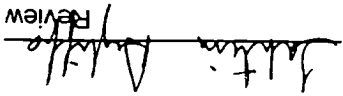

VOLATILE AROMATIC HYDROCARBONS

Gas Company of New Mexico

Project ID:	Pit Pilot Project	Report Date:	11/28/94
Sample ID:	Archuleta 1 - 11LF	Date Sampled:	11/16/94
Lab ID:	0451	Date Received:	11/16/94
Sample Matrix:	Soil	Date Extracted:	11/21/94
Preservative:	Cool	Date Analyzed:	11/21/94
Condition:	Intact		

Target Analyte	Concentration (ug/kg)	Detection Limit (ug/kg)
Benzene	ND	9.24
Toluene	ND	9.24
Ethylbenzene	ND	9.24
m,p-Xylenes	ND	18.5
o-Xylene	ND	9.24

ND - Analyte not detected at the stated detection limit.

Quality Control:	<u>Surrogate</u>	<u>Percent Recovery</u>	<u>Acceptance Limits</u>
	Trifluorotoluene	92	81 -117%
	Bromofluorobenzene	96	74 -121%

Reference: Method 5030, Purge and Trap; Method 8020, Aromatic Volatile Organics;
Test Methods for Evaluating Solid Wastes, SW-846, United States
Environmental Protection Agency, Final Update I, July, 1992.

Comments:

Analyst

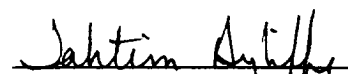
Review

TOTAL PETROLEUM HYDROCARBONS
EPA Method 418.1

Gas Company of New Mexico

Project ID: Pit Pilot Project
Sample Matrix: Soil
Preservative: Cool
Condition: Intact

Report Date: 11/28/94
Date Sampled: 11/16/94
Date Received: 11/16/94
Date Extracted: 11/22/94
Date Analyzed: 11/22/94

Sample ID	Lab ID	Concentration (mg/kg)	Detection Limit (mg/kg)
Archuleta 1 10 - S	0450	ND	24.6
Archuleta 1 11 L F	0451	ND	25.0

ND- Analyte not detected at the stated detection limit.

Reference: Method 3550 - Sonication Extraction; Test Methods for Evaluating Solid Waste, SW-846, United States Environmental Protection Agency, September, 1986;
Method 418.1 - Petroleum Hydrocarbons, Total Recoverable; Chemical Analysis of Water and Waste, United States Environmental Protection Agency, 1978.

Comments:

Analyst

Review