



Company Delhi Oil Corporation

Lease Florance Well No. 2-43

Sec. 24 T. 30 N., R. 8 W., N.M.P.M.

Location 1650' from the North line and 1650'  
from the East line.

SF 078615 A

San Juan County

New Mexico

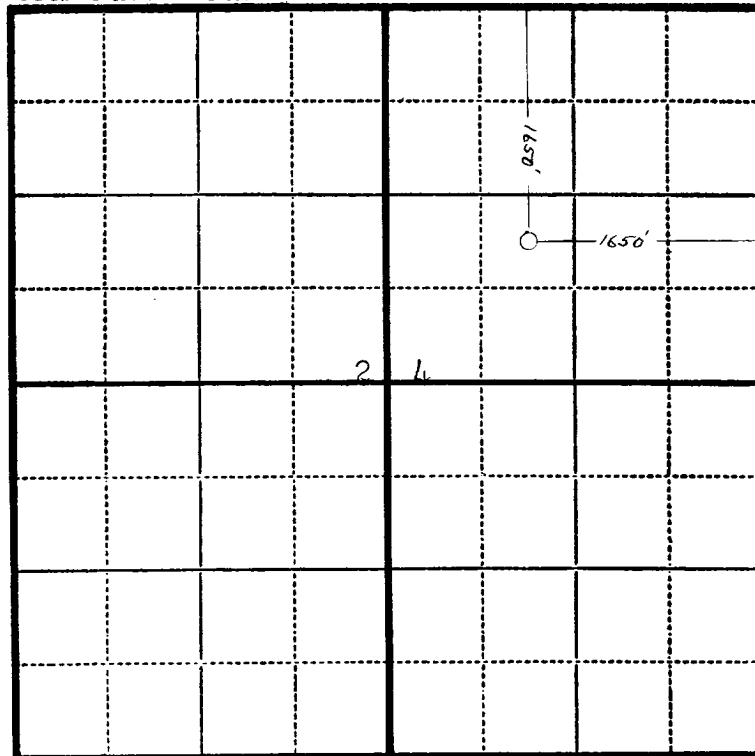

N

Scale—4 inches equals 1 mile.

This is to certify that the above plat was prepared from field notes of actual surveys made by me or under my supervision and that the same are true and correct to the best of my knowledge and belief.

Seal:

Registered Professional  
Engineer and Land Surveyor.

Charles J. Finklea  
N. Mex. Reg. No. 1302

Surveyed August 6, 19 51