

(SUBMIT IN TRIPLICATE)
UNITED STATES
DEPARTMENT OF THE INTERIOR
GEOLOGICAL SURVEY

Land Office Santa Fe
Lease No. 078578
Unit 2 1/4 Sec. 21

SUNDRY NOTICES AND REPORTS ON WELLS

NOTICE OF INTENTION TO DRILL	<input checked="" type="checkbox"/>	SUBSEQUENT REPORT OF WATER SHUT-OFF	<input type="checkbox"/>
NOTICE OF INTENTION TO CHANGE PLANS	<input type="checkbox"/>	SUBSEQUENT REPORT OF SHOOTING OR ACIDIZING	<input type="checkbox"/>
NOTICE OF INTENTION TO TEST WATER SHUT-OFF	<input type="checkbox"/>	SUBSEQUENT REPORT OF ALTERING CASING	<input type="checkbox"/>
NOTICE OF INTENTION TO RE-DRILL OR REPAIR WELL	<input type="checkbox"/>	SUBSEQUENT REPORT OF RE-DRILLING OR REPAIR	<input type="checkbox"/>
NOTICE OF INTENTION TO SHOOT OR ACIDIZE	<input type="checkbox"/>	SUBSEQUENT REPORT OF ABANDONMENT	<input type="checkbox"/>
NOTICE OF INTENTION TO PULL OR ALTER CASING	<input type="checkbox"/>	SUPPLEMENTARY WELL HISTORY	<input type="checkbox"/>
NOTICE OF INTENTION TO ABANDON WELL	<input type="checkbox"/>		

(INDICATE ABOVE BY CHECK MARK NATURE OF REPORT, NOTICE, OR OTHER DATA)

Flamingo

September 23

1953

Well No. 210 is located 1400 ft. from N line and 1005 ft. from E line of sec. 21
2 1/4 Sec. 21 30 N 8 W 100N
(1/4 Sec. and Sec. No.) (Twp.) (Range) (Meridian)
Flamingo Santa Fe New Mexico
(Field) (County or Subdivision) (State or Territory)

The elevation of the derrick floor above sea level is _____ ft.

DETAILS OF WORK

(State names of and expected depths to objective sands; show sizes, weights, and lengths of proposed casings; indicate mudding jobs, cementing points, and all other important proposed work)

We propose to drill with rotary using mud to approx. 4200' and set pipe, then drill with rotary using gas to base of Point Lobos, shoot with nitro and clean out for gas completion in entire New Verde section.

Proposed Casing Program

200' - 12-3/4" 32.75# 1-40 Casing - cemented to surface
4200' - 7" 20# 3-55 55 casing - cemented with 200 cu.
4500' - 1.9" 2.75# 3-55 13 tubing



I understand that this plan of work must receive approval in writing by the Geological Survey before operations may be commenced.

Company Dallal Oil Corporation

Address Box #1175

Farmington, New Mexico

By

Title

Supt.

Company Delhi Oil Corporation

Lease Florance Well No. 40

Sec. 21 T. 30 N. R. 8 W., N.M.P.M.

Location 1650' from the North line and 1825'
from the East line.

San Juan County

New Mexico

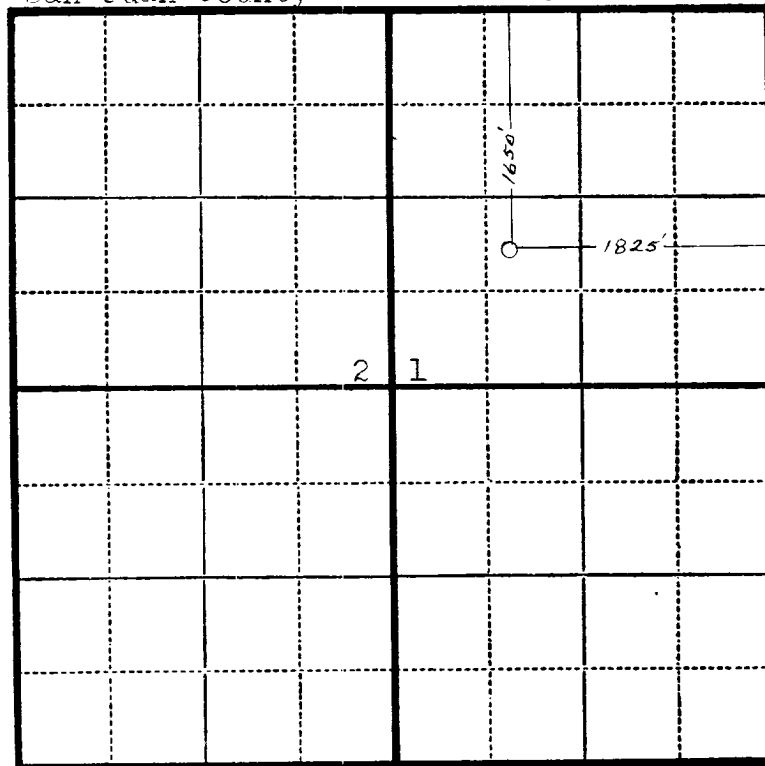

Scale—4 inches equals 1 mile.

This is to certify that the above plat was prepared from field notes of actual surveys made by me or under my supervision and that the same are true and correct to the best of my knowledge and belief.

Charles J. Finklea

Seal:

Registered Professional
Engineer and Land Surveyor.

Charles J. Finklea
N. Mex. Reg. No. 1302

Surveyed September 29, 1951

