

STATE OF NEW MEXICO  
OIL CONSERVATION  
COMMISSION  
DISTRICT NO. 3  
Phone 99 P. O. Box 697  
AZTEC, NEW MEXICO

(SUBMIT IN TRIPLICATE)  
UNITED STATES  
DEPARTMENT OF THE INTERIOR  
GEOLOGICAL SURVEY

Land Office **070596-1**  
Lease No. \_\_\_\_\_  
Unit \_\_\_\_\_

SEP 5 1951  
OIL CONSERVATION  
COMMISSION

SUNDRY NOTICES AND REPORTS ON WELLS

NOTICE OF INTENTION TO DRILL	SUBSEQUENT REPORT OF WATER SHUT-OFF
NOTICE OF INTENTION TO CHANGE PLANS	SUBSEQUENT REPORT OF SHOOTING OR ACIDIZING
NOTICE OF INTENTION TO TEST WATER SHUT-OFF	SUBSEQUENT REPORT OF ALTERING CASING
NOTICE OF INTENTION TO RE-DRILL OR REPAIR WELL	SUBSEQUENT REPORT OF REDRILLING OR REPAIR
NOTICE OF INTENTION TO SHOOT OR ACIDIZE	SUBSEQUENT REPORT OF ABANDONMENT
NOTICE OF INTENTION TO PULL OR ALTER CASING	SUPPLEMENTARY WELL HISTORY
NOTICE OF INTENTION TO ABANDON WELL	

(INDICATE ABOVE BY CHECK MARK NATURE OF REPORT, NOTICE, OR OTHER DATA)

September 4,

Well No. **Flanagan 1-35** is located **1090** ft. from **N** line and **1142** ft. from **E** line of sec. **18**  
**N. E. 1/4 Sec. 18** **T-30-N R-3-W** **NM**  
(1/4 Sec. and Sec. No.) (Range) (Merid) **New Mexico**  
**Blanco-Alto** (Field) (County or Subdivision) (State or Territory)

The elevation of the derrick floor above sea level is \_\_\_\_\_ ft. (will be furnished later)

DETAILS OF WORK

(State names of and expected depths to objective sands; show sizes, weights, and lengths of proposed casings; indicate mudding jobs, cementing points, and all other important proposed work)

We propose to drill with rotary tools to the Cliffhouse sand and set 7" casing, rotary tools will then be employed using gas to drill thru the Cliffhouse, Menafee and Point Lockout for Mesa Verde completion, well will then be shot with S.H.G..

Casing Program:

100' - 13-3/8" Surface casing - Circulate cement to surface.  
2200' - 9-5/8" Intermediate string if found necessary - 200 sacks of regular cement.  
4300' - 7" 20# Casing - 200 sacks of regular cement.  
4500' - 1.9" OD Non BUE Tubing

(Designated drilling unit East 1/2 Section 18)

I understand that this plan of work must receive approval in writing by the Geological Survey before operations may be commenced.

Company **Delhi Oil Corporation**

Address **Box 1175**  
**Farmington, New Mexico**

By **J. P. Howell**  
**Superintendent**

Title \_\_\_\_\_

DEPARTMENT OF THE INTERIOR  
BIOLOGICAL SURVEY  
UNITED STATES  
(SUBMIT IN TRIPLICATE)

**SUNDRY NOTICES AND REPORTS ON WELLS**

[illegible]

\_\_\_\_\_ is located \_\_\_\_\_  
\_\_\_\_\_ has and \_\_\_\_\_  
\_\_\_\_\_ from \_\_\_\_\_

(S) (M) (W) (P)

(U) (V) (W) (X) (Y) (Z)

The elevation of the denture floor should be determined by

DEGREE OF WORK

1. The first step in the process of identifying a problem is to define the problem clearly. This involves identifying the symptoms, the scope of the problem, and the impact it is having on the organization. Once the problem is defined, the next step is to identify the causes of the problem. This can be done through a variety of methods, including interviews, surveys, and data analysis. Once the causes are identified, the next step is to develop a plan of action to address the problem. This plan should outline the steps that will be taken to solve the problem, the resources that will be needed, and the timeline for completion. Finally, the plan should be implemented and the results monitored to ensure that the problem is solved and that the organization is back on track.

.....Company

Address

Company Delhi Oil Corporation

Lease Florance Well No. 1-35

Santa Fe 078596-A

Sec. 18 T. 30 N., R. 8 W., N.M.P.M.  
1090' 1162'

Location ~~XXX~~ from the North line and ~~XXX~~  
from the East line.

San Juan County

New Mexico

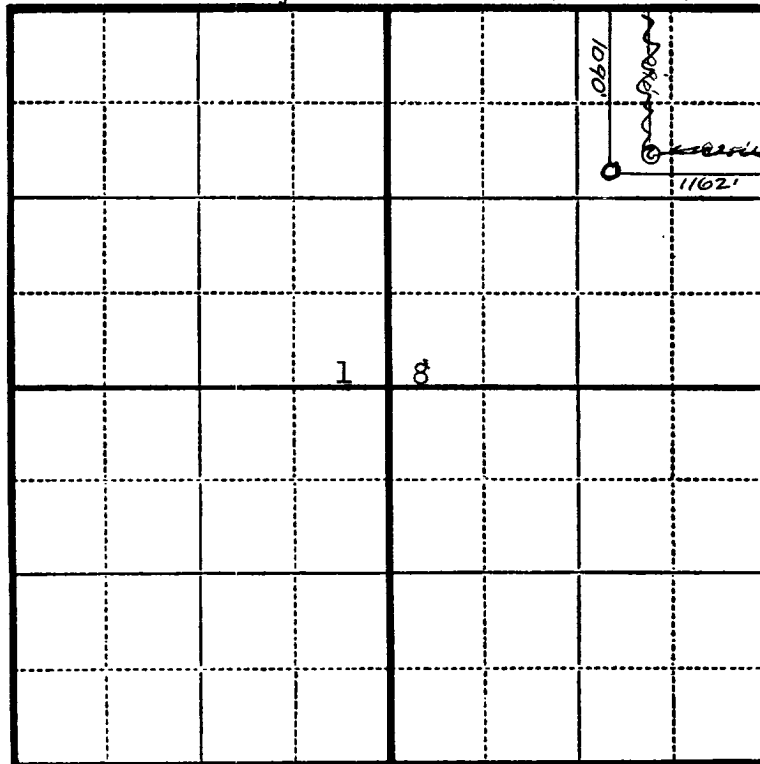

N

Scale—4 inches equals 1 mile.

This is to certify that the above plat was prepared from field notes of actual surveys made by me or under my supervision and that the same are true and correct to the best of my knowledge and belief.

*Charles J. Finklea*

Seal:

Registered Professional Charles J. Finklea  
Engineer and Land Surveyor. N. Mex. Reg. No. 1302

Surveyed August 9, 1951