

Form 9-231a
(Feb. 1951)

(SUBMIT IN TRIPLICATE)

UNITED STATES
DEPARTMENT OF THE INTERIOR
GEOLOGICAL SURVEY

Land Office Santa Fe
Lease No. SF 070500-A
Unit 4 1/2 of Sec. 4

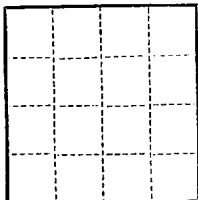

SUNDRY NOTICES AND REPORTS ON WELLS

NOTICE OF INTENTION TO DRILL.....	<input checked="" type="checkbox"/>	SUBSEQUENT REPORT OF WATER SHUT-OFF.....	
NOTICE OF INTENTION TO CHANGE PLANS.....		SUBSEQUENT REPORT OF SHOOTING OR ACIDIZING.....	
NOTICE OF INTENTION TO TEST WATER SHUT-OFF.....		SUBSEQUENT REPORT OF ALTERING CASING.....	
NOTICE OF INTENTION TO RE-DRILL OR REPAIR WELL.....		SUBSEQUENT REPORT OF RE-DRILLING OR REPAIR.....	
NOTICE OF INTENTION TO SHOOT OR ACIDIZE.....		SUBSEQUENT REPORT OF ABANDONMENT.....	
NOTICE OF INTENTION TO PULL OR ALTER CASING.....		SUPPLEMENTARY WELL HISTORY.....	
NOTICE OF INTENTION TO ABANDON WELL.....			

(INDICATE ABOVE BY CHECK MARK NATURE OF REPORT, NOTICE, OR OTHER DATA)

April 27, 1956

Well No. 3 is located 1650 ft. from [N] line and 1650 ft. from [E] line of sec. 4
Sec. 4 (1/4 Sec. and Sec. No.) 30N (Twp.) 8W (Range) 104W (Meridian)
Blanco (Manzanita) (Field) San Juan (County or Subdivision) New Mexico (State or Territory)

The elevation of the derrick floor above sea level is _____ ft. (Will be furnished later)

DETAILS OF WORK

(State names of and expected depths to objective sands; show sizes, weights, and lengths of proposed casings; indicate mudding jobs, cementing points, and all other important proposed work)

We propose to drill with rotary tools using mud to base of Pictured Cliffs (Approx. 3,300') Set intermediate casing and drill with gas to base of Point Lobos (Approx. 5,500') and set production string of casing, perforate the Point Lobos, Manzanita & Cliff House. Sand water fracturing each of the above formations for gas completion thru the entire New Verde section.

PROPOSED CASING PROGRAM

200'	of	10 3/4"	32.75'	Elect-Mold Casing	-	Connected to Surface
3,300'	of	7 5/8"	26.40'	1-55 SS Casing	-	Connected w/ 200 Sams
2,300'	of	5 1/2"	24'	1-55 SS Casing	-	Connected w/ 150 Sams (Liner)
5,500'	of	2" EUE	7.70'	1-55 Tubing		

I understand that this plan of work must receive approval in writing by the Geological Survey before operations may be commenced.

Company Bell-Taylor Oil Corporation

Address P. O. Box 1175

Paragon, New Mexico

By J. M. Howell

Title Dist. Supt.

NEW MEXICO
OIL CONSERVATION COMMISSION

Form C-128

Well Location and/or Gas Proration Plat

Date 4/26/56

Operator DELHI - TAYLOR OIL CORPORATION

Lease K. F. Moore

Well No. 3 Section 4 Township 30 NORTH Range 8 WEST, NMPM

Located 1650 Feet From the NORTH Line, 1650 Feet From the EAST Line,

SAN JUAN

County, New Mexico. G. L. Elevation _____

Name of Producing Formation Manoverda Pool Blanco Dedicated Acreage 320.65

(Note: All distances must be from outer boundaries of Section)

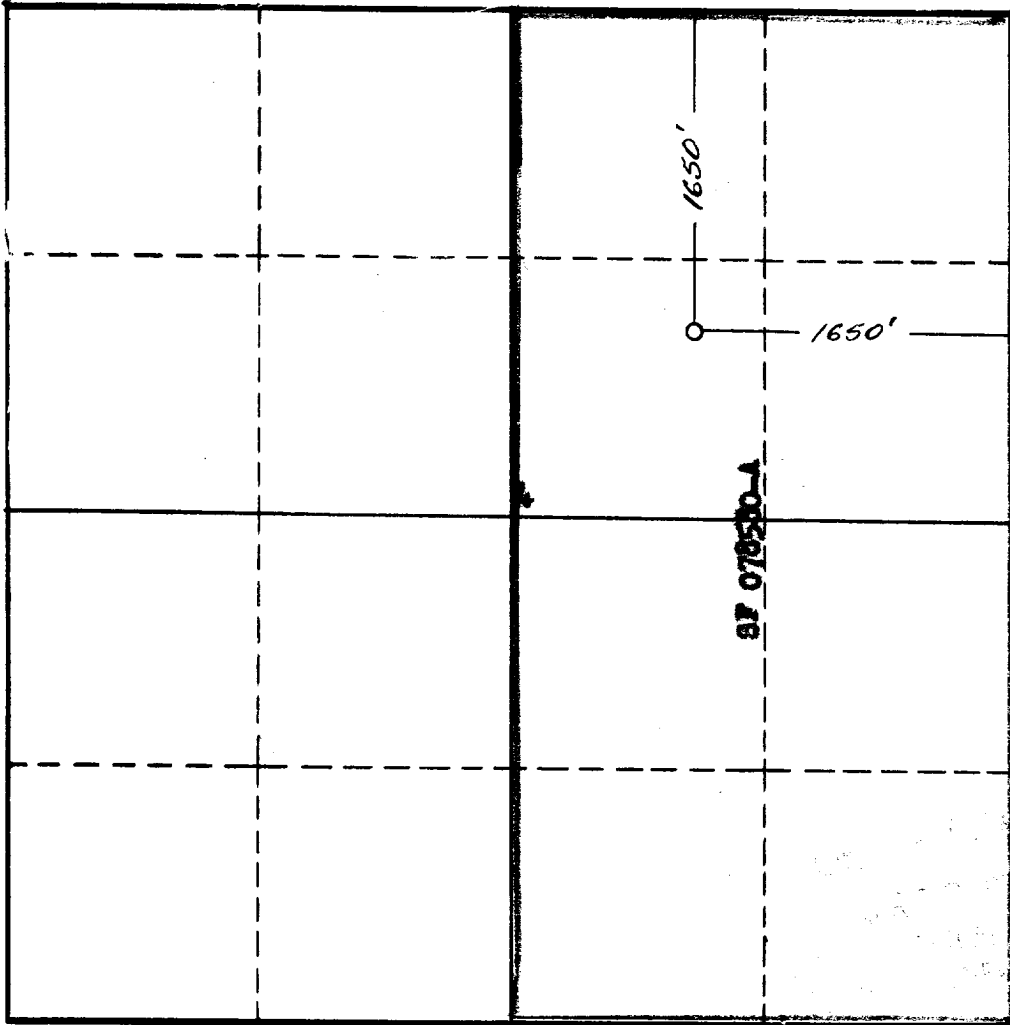

NOTE

This section of
form is to be
used for gas
wells only.

SCALE: 1"=1000'

1. Is this Well a Dual Comp. ? Yes No X.
2. If the answer to Question 1 is yes, are there any other dually completed wells within the dedicated acreage ? Yes No.

Name James P. Leese
Position Dist. Supt.
Representing Delhi-Taylor Oil Corporation
Address Box 1175 Farmington, New Mexico

This is to certify that the above plat was prepared from field notes of actual surveys made by me or under my supervision and that the same are true and correct to the best of my knowledge and belief.

Date Surveyed 24 APRIL 1956
James P. Leese
Registered Professional Engineer and/or
Land Surveyor James P. Leese
N. Mex. Reg. No. 1463