

Well Location and Acreage Dedication Plat

Section A.

Date **AUGUST 11, 1960**

Operator **EL PASO NATURAL GAS COMPANY** Lease **BLOOMFIELD NM019405**  
 Well No. **1** Unit Letter **A** Section **17** Township **29-N** Range **11-W** NMPM  
 Located **1140** Feet From **NORTH** Line **990** Feet From **EAST** Line  
 County **SAN JUAN** G. L. Elevation **5622** Dedicated Acreage **280X 320** Acres  
 Name of Producing Formation **DAKOTA** Pool **WILDCAT DAKOTA**

1. Is the Operator the only owner in the dedicated acreage outlined on the plat below?

Yes \_\_\_\_\_ No **X**2. If the answer to question one is "no", have the interests of all the owners been consolidated by communitization agreement or otherwise? Yes **X** No \_\_\_\_\_. If answer is "yes", Type of Consolidation.**Communitization Agreement**

3. If the answer to question two is "no", list all the owners and their respective interests below:

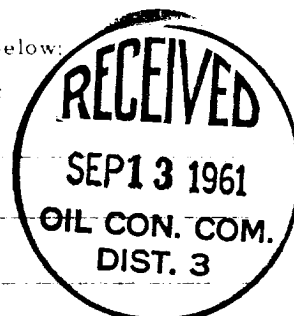
OwnerLand Description

Section B.

This is to certify that the information  
 in Section A above is true and complete  
 to the best of my knowledge and belief.

**El Paso Natural Gas company**  
 (Operator)

**ORIGINAL SIGNED A.M. SMITH**  
 (Representative)

**Box 990,**  
 (Address)

**Farmington, New Mexico**

Note: All distances must be from outer boundaries of section

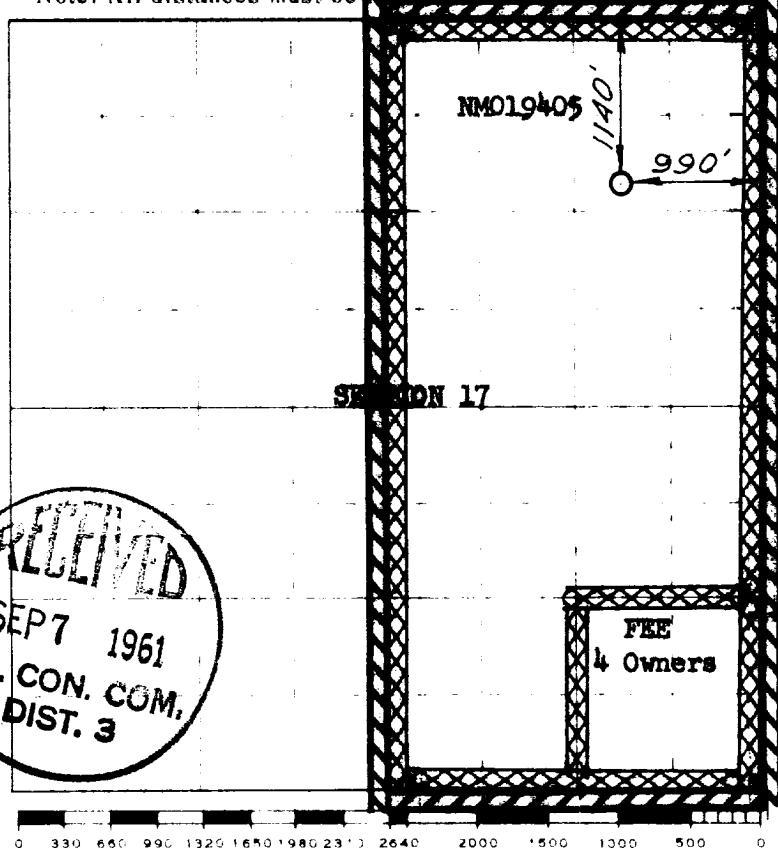

**NOTE: THIS PLAT REISSUED TO  
 SHOW REVISED DEDICATION**



Scale 4 inches equal 1 mile

This is to certify that the above plat was prepared from field notes of actual surveys  
 made by me or under my supervision and that the same are true and correct to the best  
 of my knowledge and belief.

(Seal)

Date Surveyed **AUGUST 3, 1960**

*David O. Nielsen*  
 Registered Professional Engineer and/or Land Surveyor

Farmington, New Mexico

STATE OF MINNESOTA	
COUNTY OF _____	
IN SENATE,	
JANUARY 1, 1900.	
REPORT OF THE	
COMMISSIONER OF THE LAND OFFICE	
FOR THE YEAR 1899.	
PUBLISHED BY THE STATE OF MINNESOTA.	
ST. PAUL: PUBLISHED BY THE STATE OF MINNESOTA.	
1899.	
TRANS. OF THE	OF THE
PROPERTY OF THE	OF THE
DEPARTMENT	31