

Well Location and Acreage Dedication Plat

Section A.

Date October 17, 1962

Operator SOUTHERN UNION PRODUCTION COMPANY Lease WITT  
 Well No. 1 Unit Letter N Section 33 Township 29 NORTH Range 11 WEST NMPM  
 Located 1120 Feet From the SOUTH Line, 1510 Feet From the WEST Line  
 County SAN JUAN G. L. Elevation 5462.2 Dedicated Acreage 309.96 Acres  
 Name of Producing Formation Dakota Pool Basin Dakota

1. Is the Operator the only owner in the dedicated acreage outlined on the plat below?

Yes \_\_\_\_\_ No X2. If the answer to question one is "no", have the interests of all the owners been consolidated by communitization agreement or otherwise? Yes X No \_\_\_\_\_. If answer is "yes", Type of Consolidation.**Communitization Agreement**

3. If the answer to question two is "no", list all the owners and their respective interests below:

OwnerLand Description

Section B.

This is to certify that the information  
 in Section A above is true and complete  
 to the best of my knowledge and belief.

Southern Union Production Co.

(Operator)

L. S. Macmillan

(Representative)

P. O. Box 808

(Address)

Farmington, New Mexico

Ref. GLO Plat Dated 3 Sept. 1878

Note: All distances must be from outer boundaries of section.

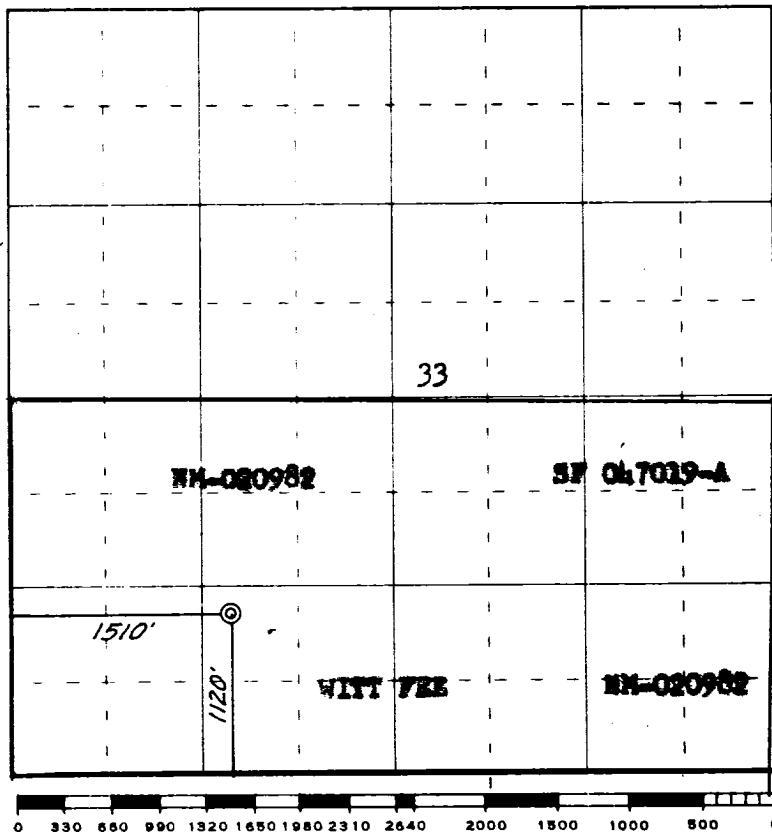

Scale 4 inches equal 1 mile

This is to certify that the above plat was prepared from field notes of actual surveys  
 made by me or under my supervision and that the same are true and correct to the best  
 of my knowledge and belief.

(Seal)

Farmington, New Mexico

Date Surveyed 30 August 1962

James P. Leese  
 Registered Professional Engineer and/or Land Surveyor  
 James P. Leese N. Mex. Reg. No. 1463

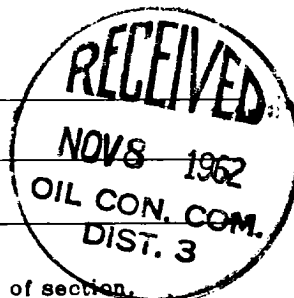

|                                 |  |
|---------------------------------|--|
| STATE OF NEW MEXICO             |  |
| OIL FIELD PRODUCTION COMMISSION |  |
| WARRANT OF SEIZURE              |  |
| NUMBER OF OIL FIELD             |  |
| 1                               |  |
| 2                               |  |
| 3                               |  |
| 4                               |  |
| 5                               |  |
| 6                               |  |
| 7                               |  |
| 8                               |  |
| 9                               |  |
| 10                              |  |
| 11                              |  |
| 12                              |  |
| 13                              |  |
| 14                              |  |
| 15                              |  |
| 16                              |  |
| 17                              |  |
| 18                              |  |
| 19                              |  |
| 20                              |  |
| 21                              |  |
| 22                              |  |
| 23                              |  |
| 24                              |  |
| 25                              |  |
| 26                              |  |
| 27                              |  |
| 28                              |  |
| 29                              |  |
| 30                              |  |
| 31                              |  |
| 32                              |  |
| 33                              |  |
| 34                              |  |
| 35                              |  |
| 36                              |  |
| 37                              |  |
| 38                              |  |
| 39                              |  |
| 40                              |  |
| 41                              |  |
| 42                              |  |
| 43                              |  |
| 44                              |  |
| 45                              |  |
| 46                              |  |
| 47                              |  |
| 48                              |  |
| 49                              |  |
| 50                              |  |
| 51                              |  |
| 52                              |  |
| 53                              |  |
| 54                              |  |
| 55                              |  |
| 56                              |  |
| 57                              |  |
| 58                              |  |
| 59                              |  |
| 60                              |  |
| 61                              |  |
| 62                              |  |
| 63                              |  |
| 64                              |  |
| 65                              |  |
| 66                              |  |
| 67                              |  |
| 68                              |  |
| 69                              |  |
| 70                              |  |
| 71                              |  |
| 72                              |  |
| 73                              |  |
| 74                              |  |
| 75                              |  |
| 76                              |  |
| 77                              |  |
| 78                              |  |
| 79                              |  |
| 80                              |  |
| 81                              |  |
| 82                              |  |
| 83                              |  |
| 84                              |  |
| 85                              |  |
| 86                              |  |
| 87                              |  |
| 88                              |  |
| 89                              |  |
| 90                              |  |
| 91                              |  |
| 92                              |  |
| 93                              |  |
| 94                              |  |
| 95                              |  |
| 96                              |  |
| 97                              |  |
| 98                              |  |
| 99                              |  |
| 100                             |  |

## MISCELLANEOUS REPORTS ON WELLS

(Submit to appropriate District Office as per Commission Rule 1106)

|   |                      |   |                        |   |                      |                          |
|---|----------------------|---|------------------------|---|----------------------|--------------------------|
| Name of Company<br><b>SOUTHERN UNION PRODUCTION COMPANY</b>   |                      |   |                        | Address<br><b>P. O. Box 808 - Farmington, N.M.</b>  |                      |                          |
| Lease<br><b>WITT</b>  | Well No.<br><b>1</b> | Unit Letter<br><b>N</b>                             | Section<br><b>33</b>   | Township<br><b>29-N</b>   | Range<br><b>11-W</b> |                          |
| Date Work Performed<br><b>11-28-62 to 12-4-62</b>   |                      | Pool<br><b>Basin Dakota</b>                         |                        | County<br><b>San Juan</b>   |                      |                          |
| THIS IS A REPORT OF: (Check appropriate block)  |                      |   |                        |   |                      |                          |
| <input type="checkbox"/> Beginning Drilling Operations  |                      | <input type="checkbox"/> Casing Test and Cement Job |                        | <input checked="" type="checkbox"/> Other (Explain):  |                      |                          |
| <input type="checkbox"/> Plugging   |                      | <input type="checkbox"/> Remedial Work              |                        |   |                      |                          |
| Detailed account of work done, nature and quantity of materials used, and results obtained.   |                      |   |                        |   |                      |                          |
| 1. Drilled to 6255' with mud.<br>2. Ran 193 jts. 4-1/2", O.D., 10.50#, J-55 casing. Landed at 6253' R.K.B. Set Baker stage collar @ 1745 R.K.B.<br>3. Cement 1st stage w/255 sks 50-50 pozmix followed w/65 sks regular latex. Plug down 7:00 A.M., 11-28-62.<br>4. Cemented 2nd stage w/1000 cu. ft. 40% Diacel "D", Followed with 75 sks regular. Plug down 10:45 A.M., 11-28-62.<br>5. Drill stage collar at 1745' RKB & clean out to P.B.T.D. 6218' R.K.B. Pressure test casing to 3500 psi for 30 minutes. Pressure held.<br>6. Perforated 2 shots/ft. 6172-6188; 6150-6156; Sand-Water frac w/2500# 20-40 sand and 26,250 gallons 1% Acid Water.<br>7. Set Bridge Plug @ 6140' R.K.B.<br>8. Perf. 2 shots/ft. 6094-6128. Sand-Water frac w/60,000# 20-40 sand & 56,180 gal. 1% HCL water.<br>9. Set Bridge Plug @ 6075 R.K.B. |                      |   |                        |   |                      |                          |
| (OVER)  |                      |   |                        |   |                      |                          |
| Witnessed by<br><b>Dick Baker</b>   |                      | Position<br><b>Pusher</b>                           |                        | Company<br><b>Signal Oil Well Service</b>   |                      |                          |
| FILL IN BELOW FOR REMEDIAL WORK REPORTS ONLY  |                      |   |                        |   |                      |                          |
| ORIGINAL WELL DATA  |                      |   |                        |   |                      |                          |
| D F Elev.   | T D                  | P B T D   | Producing Interval     | Completion Date   |                      |                          |
| Tubing Diameter   |                      | Tubing Depth  | Oil String Diameter    | Oil String Depth  |                      |                          |
| Perforated Interval(s)  |                      |   |                        |   |                      |                          |
| Open Hole Interval  |                      |   | Producing Formation(s) |   |                      |                          |
| RESULTS OF WORKOVER   |                      |   |                        |   |                      |                          |
| Test  | Date of Test         | Oil Production BPD                                  | Gas Production MCFPD   | Water Production BPD  | GOR Cubic feet/Bbl   | Gas Well Potential MCFPD |
| Before Workover   |                      |   |                        |   |                      |                          |
| After Workover  |                      |   |                        |   |                      |                          |
| OIL CONSERVATION COMMISSION   |                      |   |                        | I hereby certify that the information given above is true and complete to the best of my knowledge. |                      |                          |
| Approved by<br><b>W. R. Smith</b>   |                      |   |                        | Name<br><b>D. G. Macy</b>   |                      |                          |
| Title<br><b>Oil Conservation Inspector DIST. NO. 3</b>  |                      |   |                        | Position<br><b>Petroleum Engineer</b>   |                      |                          |
| Date<br><b>Jan. 6 1963</b>  |                      |   |                        | Company<br><b>Southern Union Production Company</b>   |                      |                          |

10. Perf. 2 shots/ft. 6035-6038; 6015-6025. Sand-Water frac. w/40,000# sand and 42,630 gals. 1% HCL Water.
11. Drilled Bridge Plug and cleaned out to P.B.T.D. of 6220' R.K.B.
12. Landed 1-1/2" tubing with Bit on @ 6128' R.K.B. Perf. tubing 2 shots/ft. 6124-6128'.
13. Well completed 12-4-62.

