

UNITED STATES
DEPARTMENT OF THE INTERIOR
GEOLOGICAL SURVEY

APPLICATION FOR PERMIT TO DRILL, DEEPEN, OR PLUG BACK

1a. TYPE OF WORK DRILL ☒ DEEPEN ☐ PLUG BACK ☐
b. TYPE OF WELL OIL WELL ☐ GAS WELL ☒ OTHER ☐ SINGLE ZONE ☐ MULTIPLE ZONE ☐
2. NAME OF OPERATOR W. M. GALLAWAY
3. ADDRESS OF OPERATOR 101-2 Petroleum Plaza Bldg., Farmington, N.M. 87401
4. LOCATION OF WELL (Report location clearly and in accordance with any State requirements.)*
At surface 790' FSL and 790' FEL
At proposed prod. zone
14. DISTANCE IN MILES AND DIRECTION FROM NEAREST TOWN OR POST OFFICE*
Approx. 2 miles Southeast of Bloomfield, N. M.
15. DISTANCE FROM PROPOSED* LOCATION TO NEAREST PROPERTY OR LEASE LINE, FT. (Also to nearest drlg. unit line, if any) 790'
16. NO. OF ACRES IN LEASE 1183.91
17. NO. OF ACRES ASSIGNED TO THIS WELL 160
18. DISTANCE FROM PROPOSED LOCATION* TO NEAREST WELL, DRILLING, COMPLETED, OR APPLIED FOR, ON THIS LEASE, FT. 1060'
19. PROPOSED DEPTH 1900'
20. ROTARY OR CABLE TOOLS Rotary
21. ELEVATIONS (Show whether DF, RT, GR, etc.) 5616 GR
22. APPROX. DATE WORK WILL START* As soon as possible.

23. PROPOSED CASING AND CEMENTING PROGRAM

| SIZE OF HOLE | SIZE OF CASING | WEIGHT PER FOOT | SETTING DEPTH | QUANTITY OF CEMENT |
|--------------|----------------|-----------------|---------------|--------------------|
| 8 3/4" | 7 5/8" | 28 | 60' | 25 Sacks |
| 6 3/4" | 4 1/2" | 10.50 | 1900' | 150 Sacks |

Plan to mud drill through Pictured Cliffs formation and set production casing through zone, perforate casing, stimulate well by fracing, run tubing and test well.

Blowout preventer diagram attached.

Gas is dedicated.

RECEIVED

JUL 7 1977

U. S. GEOLOGICAL SURVEY
FARMINGTON, N. M.

IN ABOVE SPACE DESCRIBE PROPOSED PROGRAM: If proposal is to deepen or plug back, give data on present productive zone and proposed new productive zone. If proposal is to drill or deepen directionally, give pertinent data on subsurface locations and measured and true vertical depths. Give blowout preventer program, if any.

24.

SIGNED

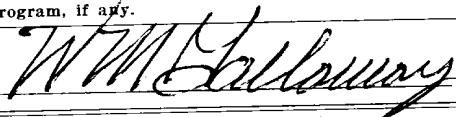

TITLE

Operator

DATE

7-1-77

(This space for Federal or State office use)

PERMIT NO.

APPROVAL DATE

APPROVED BY

TITLE

DATE

CONDITIONS OF APPROVAL, IF ANY:



*See Instructions On Reverse Side

Instructions

General: This form is designed for submitting proposals to perform certain well operations, as indicated, on all types of lands and leases for appropriate action by either a Federal or a State agency, or both, pursuant to applicable Federal and/or State laws and regulations. Any necessary special instructions concerning the use of this form and the number of copies to be submitted, particularly with regard to local, area, or regional procedures and practices, either are shown below or will be issued by, or may be obtained from, the local Federal and/or State office.

Item 1: If the proposal is to redrill to the same reservoir at a different subsurface location or to a new reservoir, use this form with appropriate notations. Consult applicable State or Federal regulations concerning subsequent work proposals or reports on the well.

Item 4: If there are no applicable State requirements, locations on Federal or Indian land should be described in accordance with Federal requirements. Consult local State or Federal office for specific instructions.

Item 14: Needed only when location of well cannot readily be found by road from the land or lease description. A plat, or plats, separate or on this reverse side, showing the roads to, and the surveyed location of, the well, and any other required information, should be furnished when required by Federal or State agency offices.

Items 15 and 18: If well is to be, or has been directionally drilled, give distances for subsurface location of hole in any present or objective production zone.

Item 22: Consult applicable Federal or State regulations, or appropriate officials, concerning approval of the proposal before operations are started.

NEW MEXICO OIL CONSERVATION COMMISSION

WELL LOCATION AND ACERAGE DEDICATION PLAT

All distances must be from the outer boundaries of the Section

| | | | | | |
|--|--|-----------------------------|--|------------------------------------|-----------------------|
| Operator W. M. GALLAWAY | | | Lease DELO | | Well No. 11 |
| Unit Letter P | Section 26 | Township 29 NORTH | Range 11 WEST | County SAN JUAN | |
| Actual Footage Location of Well: 790 feet from the SOUTH line and 790 feet from the EAST line | | | | | |
| Ground Level Elev. 5616 | Producing Formation PICTURED CLIFF | | Pool FULCHER KUTZ <i>eyk</i> | Dedicated Acreage: 160 ✓ | Acres |

1. Outline the acreage dedicated to the subject well by colored pencil or hatchure marks on the plat below.
2. If more than one lease is dedicated to the well, outline each and identify the ownership thereof (both as to working interest and royalty),
3. If more than one lease of different ownership is dedicated to the well, have the interests of all owners been consolidated by communization, unitization, force-pooling, etc?

() Yes () No If answer is "yes," type of consolidation

If answer is "no," list the owners and tract descriptions which have actually consolidated. (Use reverse side of this form if necessary.)

No allowable will be assigned to the well until all interests have been consolidated (by communization, unitization, forced-pooling, or otherwise) or until a non standard unit, eliminating such interests, has been approved by the Commission.

CERTIFICATION

I hereby certify that the information contained herein is true and complete to the best of my knowledge and belief.

W. M. Gallaway
 Name **W. M. Gallaway**
 Position **Operator**
 Company **W. M. Gallaway**
 Date **July 1, 1977**

I hereby certify that the well location shown on this plat was plotted from field notes of actual surveys made by me under my supervision, and that the same is true and correct to the best of my knowledge and belief.

21 June 1977
 Date Surveyed
James P. Leese
 Registered Professional Engineer
 and/or Land Surveyor **James P. Leese**

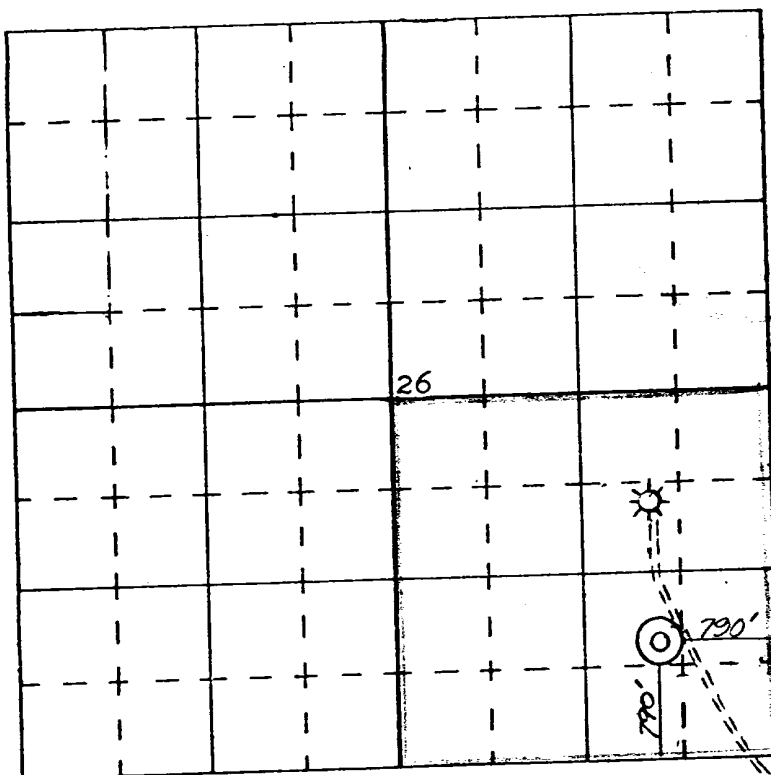

SCALE—4 INCHES EQUALS 1 MILE

SAN JUAN ENGINEERING COMPANY, FARMINGTON, N. M.

1463
 Certificate No.

PROPOSED BOP STACK
7-5/8 " CASING

Bell Nipple

Flowline

BOP w/pipe Rams
2000 psi WP

8 " Flange

2000 psi WP

Kill Line 2 " 2000psi WP

8 " 2000 psi WP
Flange

W. M. GALLAWAY

Well: Delo #11

San Juan County, New Mexico

W. M. GALLAWAY
101-2 Petroleum Plaza Building
Farmington, New Mexico 87401

MULTI-POINT SURFACE USE PLAN FOR
DRILLING OPERATIONS ON FEDERAL LEASES

Lease Name DELO Well No. 11
Well Location 790' FSL, 790' FEL, Sec. 26, T29N, R11W
Field Fulcher Kutz P.C.
County San Juan State New Mexico

- 1.* Existing roads including location of the exit from main highway.
2. Planned access roads. Approximately 30' from existing road to well location.
- 3.* Location of wells.
- 4.* Lateral roads to well location.
5. Location of tank batteries and flow lines. None
6. Location and types of water supply: Water will be trucked to location and used off of water truck.
7. Methods for handling waste disposal: Waste will be burned and buried.
8. Location of camps: None
9. Location of air strips: None
10. Location layout to include position of rig, mud tanks, reserve pits, burn pits, pipe racks, etc: See attached diagram of proposed layout.
11. Plans for restoration of the surface: Pits will be backfilled and leveled to original grade. Location will be seeded according to B.L.M. seeding requirements.
12. Any other information that may be used in evaluating the impact on environment: Location falls in sandy loam with scattered juniper trees approximately 30' from existing road to Delo #10 well.

* Shown on attached map.

I hereby certify that I, or persons under my direct supervision, have inspected the proposed drillsite and access route; that I am familiar with the conditions which presently exist; that the statements made in this plan are, to the best of my knowledge, true and correct; and, that the work associated with the operations proposed herein will be performed by W. M. Gallaway and his contractors and subcontractors in conformity with this plan and the terms and conditions under which it is approved.

July 1, 1977
Date

W. M. Gallaway
W. M. Gallaway, Operator

No Scale Development Plan De 10 # 11

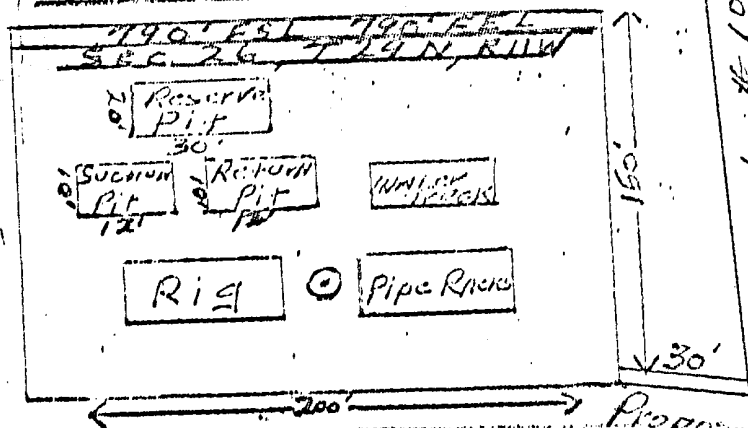

W. M. Gallaway

Well: De 10 # 11

San Juan County, New Mexico

100715
100715
100715

UNITED STATES
DEPARTMENT OF THE INTERIOR
GEOLOGICAL SURVEY

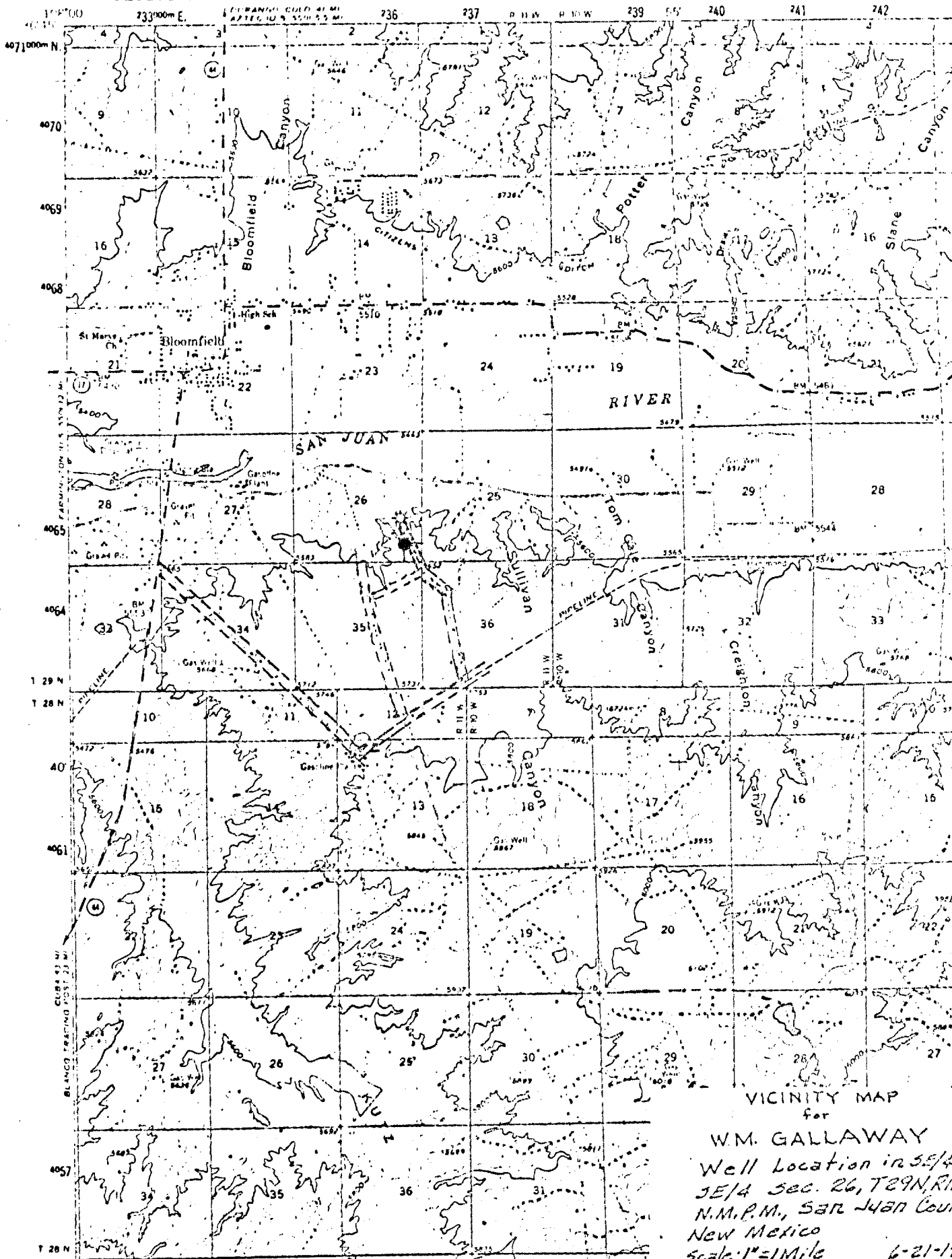

VICINITY MAP
for

W.M. GALLAWAY
Well Location in SE 1/4
SE 1/4 Sec. 26, T29N, R11E,
N.M.P.M., San Juan Co.,
New Mexico
Scale: 1" = 1 Mile 6-21-15