

UNITED STATES
DEPARTMENT OF THE INTERIOR
GEOLOGICAL SURVEY

APPLICATION FOR PERMIT TO DRILL, DEEPEN, OR PLUG BACK

1a. TYPE OF WORK DRILL ☒ DEEPEN ☐ PLUG BACK ☐

b. TYPE OF WELL
OIL WELL ☐ GAS WELL ☒ OTHER ☐ SINGLE ZONE ☒ MULTIPLE ZONE ☐

2. NAME OF OPERATOR Southland Royalty Company

3. ADDRESS OF OPERATOR P. O. Drawer 570, Farmington, New Mexico

4. LOCATION OF WELL (Report location clearly and in accordance with any State requirements.)*
At surface 1050' FNL & 1650' FWL ✓
At proposed prod. zone

14. DISTANCE IN MILES AND DIRECTION FROM NEAREST TOWN OR POST OFFICE*
2 miles West of Blanco, New Mexico

15. DISTANCE FROM PROPOSED* LOCATION TO NEAREST PROPERTY OR LEASE LINE, FT. (Also to nearest drig. unit line, if any) 1050'

16. NO. OF ACRES IN LEASE 2335.05

17. NO. OF ACRES ASSIGNED TO THIS WELL N- 320 ✓

18. DISTANCE FROM PROPOSED* LOCATION TO NEAREST WELL, DRILLING, COMPLETED, OR APPLIED FOR, ON THIS LEASE, FT. 600'

19. PROPOSED DEPTH 6703'

20. ROTARY OR CABLE TOOLS Rotary

21. ELEVATIONS (Show whether DF, RT, GR, etc.) 5746' GR

22. APPROX. DATE WORK WILL START* September 15, 1979

23.

PROPOSED CASING AND CEMENTING PROGRAM

SIZE OF HOLE	SIZE OF CASING	WEIGHT PER FOOT	SETTING DEPTH	QUANTITY OF CEMENT
12-1/4"	8-5/8"	24#	200'	140 sxs (165 cu. ft.)
7-7/8"	5-1/2"	15.5#	6703'	215 sxs (321 cu. ft.) 1st Stage
				212 sxs (317 cu. ft.) 2nd Stage
				147 sxs (219 cu. ft.) 3rd Stage

Surface formation is Nacimiento.

Top of Ojo Alamo sand is at 1158'.

Top of Pictured Cliffs sand is at 2118'.

Top of Cliff House sand is at 3693'.

Fresh water mud will be used to drill from surface to total depth.

It is anticipated that an IES will be run from surface casing to total depth.

It is anticipated that a GR-Density will be run from total depth to Chacra top.

No abnormal pressures or poisonous gases are anticipated in this well.

It is expected that this well will be drilled before November 1, 1979. This depends on time required for approvals, rig availability and the weather.

Gas is dedicated.

Dedicated Acreage: N/2 Section 23-T29N-R10W

IN ABOVE SPACE DESCRIBE PROPOSED PROGRAM: If proposal is to deepen or plug back, give data on present productive zone and proposed new productive zone. If proposal is to drill or deepen directionally, give pertinent data on subsurface locations and measured and true vertical depths. Give blowout preventer program, if any.

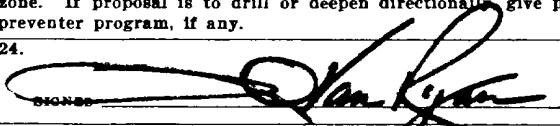
24.  TITLE District Production Manager DATE August 17, 1979

(This space for Federal or State office use)

PERMIT NO. _____

APPROVAL DATE _____

APPROVED BY _____
CONDITIONS OF APPROVAL, IF ANY:

TITLE _____

DATE _____

*See Instructions On Reverse Side

OIL CONSERVATION DIVISION

STATE OF NEW MEXICO
ENERGY AND MINERALS DEPARTMENTP. O. BOX 2088
SANTA FE, NEW MEXICO 87501Form C-102
Revised 10-1-78

All distances must be from the outer boundaries of the Section.

Operator SOUTHLAND ROYALTY COMPANY			Lease HARE		Well No. 19-E
Unit Letter C	Section 23	Township 29N	Range 10W	County San Juan	
Actual Footage Location of Well: 1050 feet from the North line and 1650 feet from the West line					
Ground Level Elev. 5746	Producing Formation Dakota		Pool Basin Dakota		Dedicated Acreage: 320.00 Acres

1. Outline the acreage dedicated to the subject well by colored pencil or hachure marks on the plat below.
2. If more than one lease is dedicated to the well, outline each and identify the ownership thereof (both as to working interest and royalty).
3. If more than one lease of different ownership is dedicated to the well, have the interests of all owners been consolidated by communitization, unitization, force-pooling, etc?

☐ Yes ☐ No If answer is "yes," type of consolidation _____

If answer is "no," list the owners and tract descriptions which have actually been consolidated. (Use reverse side of this form if necessary.) _____

No allowable will be assigned to the well until all interests have been consolidated (by communitization, unitization, forced-pooling, or otherwise) or until a non-standard unit, eliminating such interests, has been approved by the Commission.

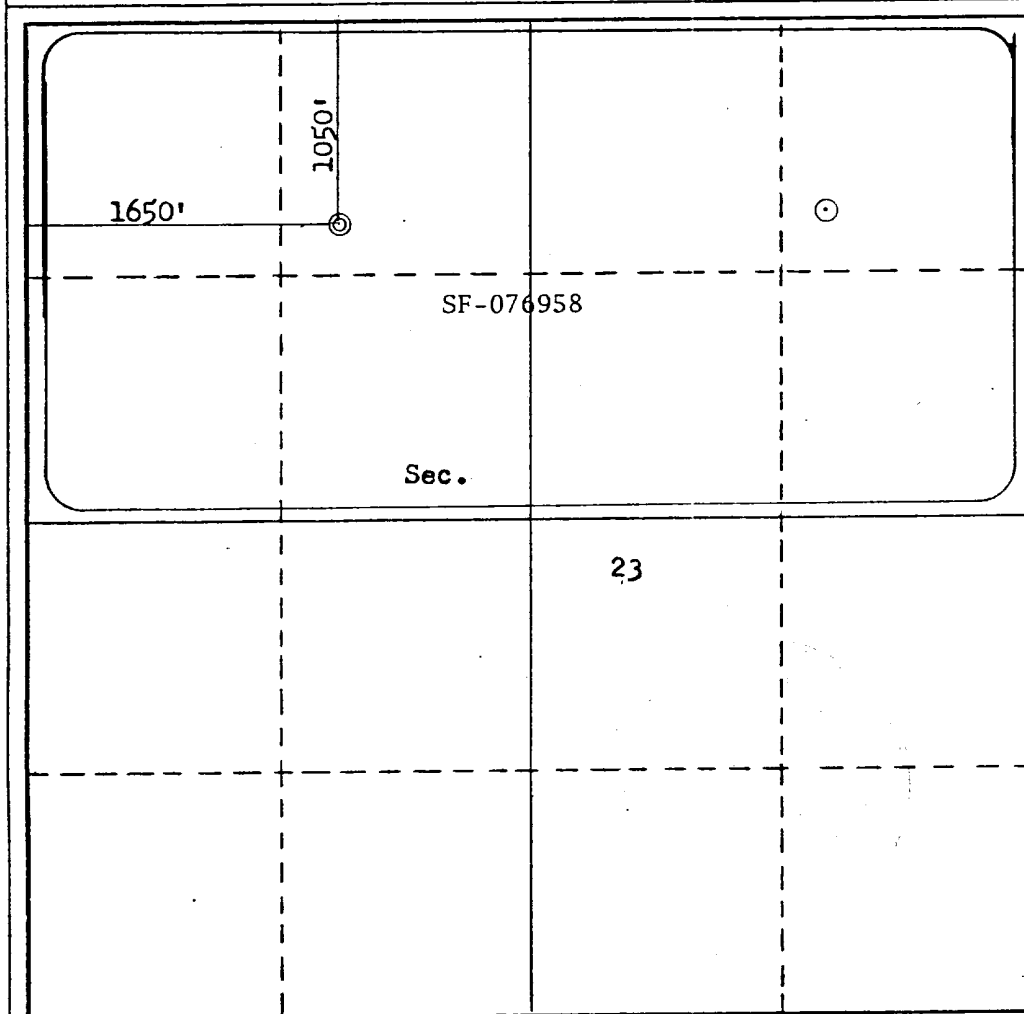

CERTIFICATION

I hereby certify that the information contained herein is true and complete to the best of my knowledge and belief.

Position
District Production Manager

Company
Southland Royalty Company

Date
August 17, 1979

I hereby certify that the well location shown on this plat was plotted from field notes of actual surveys made by me or under my supervision, and that the same is true and correct to the best of my knowledge and belief.

Date Surveyed
August 1, 1979

Registered Professional Engineer
and/or Land Surveyor

Fred B. Kerr Jr.
Fred B. Kerr Jr.

Certificate No.
3950

0 330 660 990 1320 1650 1980 2310 2640 2000 1500 1000 500 0



Southland Royalty Company

United States Geological Survey
P. O. Box 959
Farmington, New Mexico 87401

Attention: Mr. Gene Daniel

Dear Sir:

I hereby certify that I, or persons under my direct supervision, have inspected the proposed drillsite and access route; that I am familiar with the conditions which presently exist; that the statements made in this plan are, to the best of my knowledge, true and correct; and, that the work associated with the operations proposed herein be performed by Southland Royalty Company and its contractors and subcontractors in conformity with this plan and the terms and conditions under which it is approved.

Date: August 17, 1979

Name: 

Title: District Production Manager



Southland Royalty Company

August 17, 1979

United States Geological Survey
P. O. Box 959
Farmington, New Mexico

Attention: Mr. Gene Daniel

Dear Sir:

Enclosed please find a map showing existing roads and planned access roads to Southland Royalty Company's Hare #19E well. The locations of tank batteries and flow lines will be on location with well. A burn pit will be provided for disposal of trash. Cuttings, drilling fluid and produced fluids will be put into the reserve pit and properly disposed of depending on amount and type of fluids.

Contractor will furnish restroom facilities on location.

There will be no air strips or camps.

Also, enclosed is a location layout showing approximate location of rig, pits and pipe racks and cut required to build this location.

Water supply will be the San Juan River.

The location will be restored according to Bureau of Land Management standards. This work will begin when all related construction is finished.

Mr. Ross Lankford will be Southland Royalty Company's field representative supervising these operations.

Yours truly,

L. O. Van Ryan
District Production Manager

LOVR/dg



Southland Royalty Company

August 17, 1979

United States Geological Survey
P. O. Box 959
Farmington, New Mexico

Attention:

Re: Blowout Preventer Plan

Dear Sir:

All drilling and completion rigs will be equipped with 6" or larger double hydraulic blowout preventers and a hydraulic closing unit with steel lines.

The preventer is 3000# working pressure and 6000# test.

All crews will be thoroughly trained in the operation of this preventer. The preventer will be tested frequently enough to insure proper operation.

Yours truly,

L. O. Van Ryan
District Production Manager

LOVR/dg

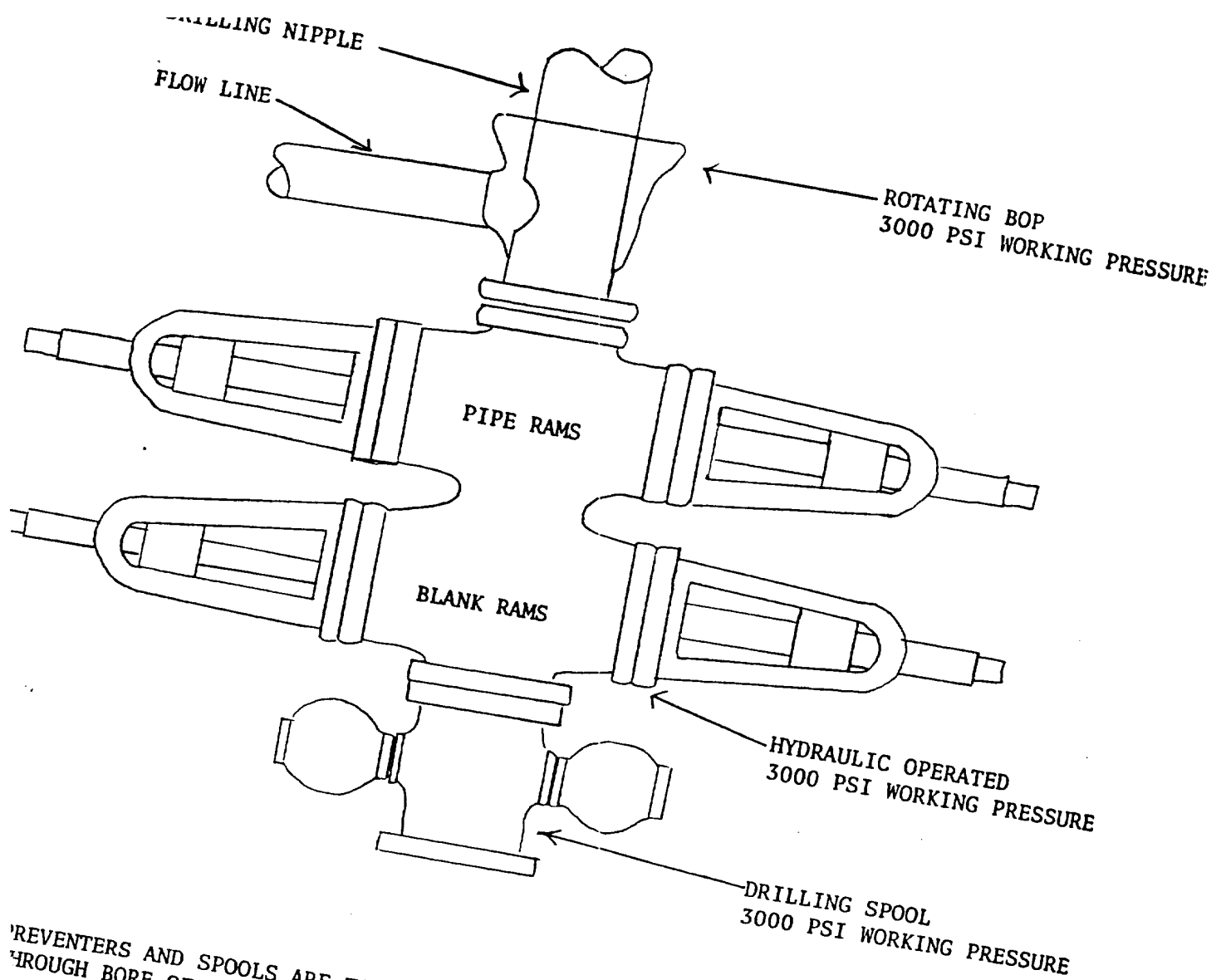

REVENTERS AND SPOOLS ARE TO HAVE
THROUGH BORE OF 6" - 3000 PSI OR LARGER

SOUTHLAND ROYALTY CO. #19E HARE
1050' FNL 1650' FNL Sec 23-T29N-R10W San Juan County, New Mexico

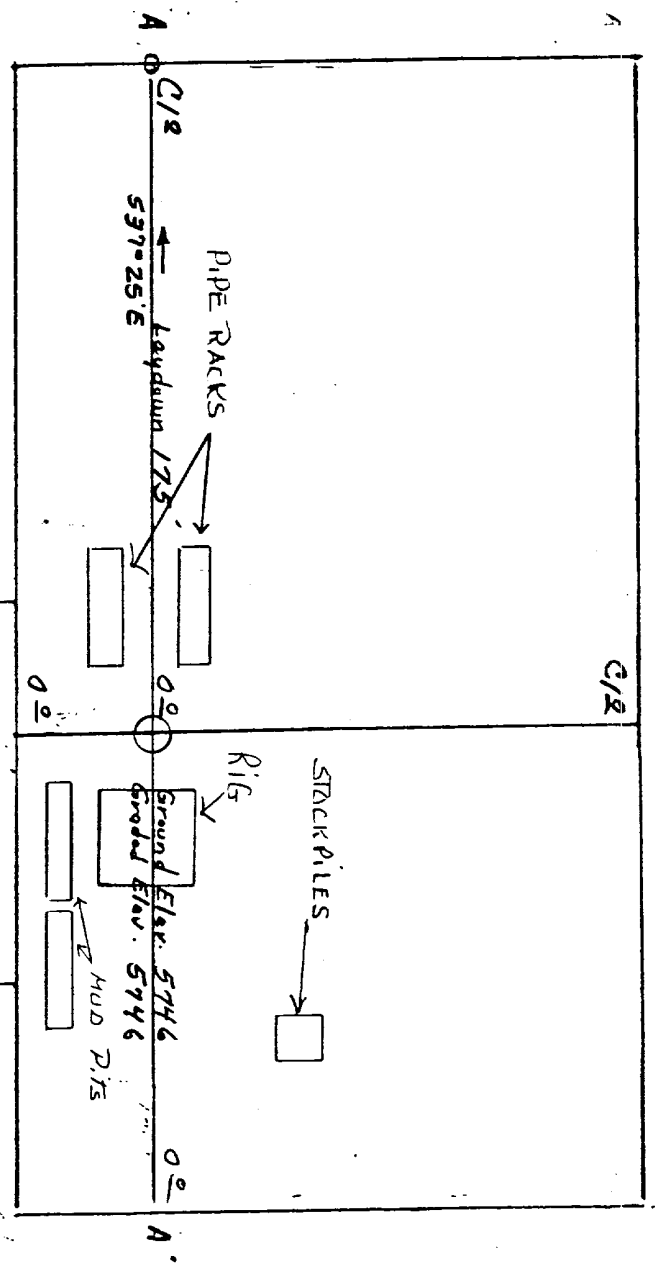

Vert. 1"=40' A-A' Horiz. 1"=100'

5750					
5740					
5730					

B-B' E

5750					
5740					
5730					

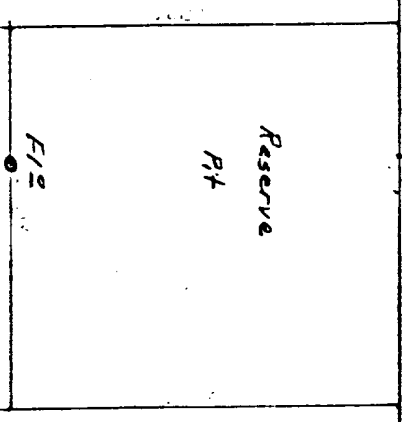

Vert. 1"=40' C-C' Horiz. 1"=100'

D-D' E

KERR LAND SURVEYING
Date: _____



DRILLING SCHEDULE - HARE #19E

Location: 1050' FNL & 1650' FWL Section 23, T29N, R10W, San Juan County, New Mexico

Field: Basin Dakota Elev. 5746' TD 6703'

Geology:

Formation Tops:	Ojo Alamo	1158'	Pt. Lookout	4368'
	Fruitland	1788'	Gallup	5613'
	Pictured Cliffs	2118'	Graneros	6433'
	Cliff House	3693'	Dakota	6553'

Logging Program: IES from surface casing to total depth.
GR-Density from TD to Chacra top.

Coring Program: None

Natural Gauges: None

Drilling:

Contractor:

Tool Pusher:

SRC Representative:

SRC Answering Service: 325-1841
Dispatch Number: 325-7391

Mud Program: Fresh water mud to top of Pt. Lookout. Pretreat gel mud with 10% LCM. Maintain Mud weight at 9.0 to 9.2. Vis to 35 sec. W.L. at 12 to 15.

Materials

Csg Program:	Hole Size	Depth	Csg. Size	Wt. & Grade	
	12-1/4"	200'	8-5/8"	24#	K-55
	7-7/8"	6703'	5-1/2"	15.5#	K-55

Float Equipment:

8-5/8" Surface Casing: Pathfinder Guide Shoe.

5-1/2" Production Casing: Pathfinder guide shoe and Howco self-fill insert valve. Run five centralizers every other jt from shoe. Run Dowell stage tool at 4768' and 2318'. Run cement basket 1 joint below and 5 centralizers above each tool.

Wellhead Equipment: 8-5/8" X 10", 2000# Bradenhead with 5-1/2" casing hanger.
10" X 6", 2000# tubing head and tree.

CEMENTING:

8.625" (8-5/8") surface casing: 140 sxs (165 cu. ft.) of Class "B" with 1/4# gel flake/sx and 3% CaCl. WOC 12 hrs. Test to 600# prior to drilling out. (Volume is 100% excess)

5.500" (5-1/2") Production String:

Stage 1: 215 sxs (321 cu. ft.) of 50/50 Poz with 6% gel, 1/4# gel flake/sx and 0.6% Halad 9 or equivalent. (70% Excess to cover Gallup.)

Stage 2: 212 sxs (317 cu. ft.) of the same as above. (70% Excess to cover Cliff House.)

Stage 3: 147 sxs (219 cu. ft.) of 50/50 Poz with 6% gel, followed by 70 sxs of Class B w/2% CaCl. (50% excess to cover Ojo Alamo.)

If lost circulation occurred - Add 1/4# celloflakes/sx. Run temperature survey after 12 hours.

WOC and Circulate between stages as required by well conditions.
