

NO. OF COPIES RECEIVED	5
DISTRIBUTION	
SANTA FE	1
FILE	1
U.S.G.S.	2
LAND OFFICE	
OPERATOR	1

5A. Indicate Type of Lease
STATE ☐ FEE ☒

5. State Oil & Gas Lease No.

APPLICATION FOR PERMIT TO DRILL, DEEPEN, OR PLUG BACK

1a. Type of Work DRILL <input checked="" type="checkbox"/> DEEPEN <input type="checkbox"/> PLUG BACK <input type="checkbox"/>		7. Unit Agreement Name
b. Type of Well OIL WELL <input type="checkbox"/> GAS WELL <input checked="" type="checkbox"/> OTHER INFILL <input type="checkbox"/> SINGLE ZONE <input checked="" type="checkbox"/> MULTIPLE ZONE <input type="checkbox"/>		8. Term or Lease Name Crawford Gas Com "B"
2. Name of Operator AMOCO PRODUCTION COMPANY		9. Well No. 1E
3. Address of Operator 501 Airport Drive, Farmington, New Mexico 87401		10. Field and Pool, or Wildcat Basin Dakota
4. Location of Well UNIT LETTER J LOCATED 1520 FEET FROM THE South LINE AND 1520' FEET FROM THE East LINE OF SEC. 24 TWP. 29N RGE. 12W		12. County San Juan
15. Proposed Depth 6622'		19A. Formation Dakota
21A. Kind & Status Plug. Bond Statewide		22. Approx. Date Work will start 12/15/79
21. Elevations (Show whether DT, KT, etc.) 5632' GL		21B. Drilling Contractor Unknown
23. PROPOSED CASING AND CEMENT PROGRAM		

SIZE OF HOLE	SIZE OF CASING	WEIGHT PER FOOT	SETTING DEPTH	SACKS OF CEMENT	EST. TOP
12-1/4"	8-5/8"	24#	300'	300 sx	Surface
7-7/8"	4-1/2"	11.6#	6622'	1510 sx	Surface

Amoco proposes to drill the above well to further develop the Basin Dakota reservoir. The well will be drilled to the surface casing point using native mud. The well will then be drilled to TD with a low solids nondispersed mud system. Completion design will be based on open hole logs. Copy of all logs will be filed upon completion. Amoco's standard blow-out prevention will be employed; see attached drawing for blowout preventer design.

Upon completion the well location will be cleaned and the reserve pit filled and leveled.

Gas produced from this well is dedicated to El Paso Natural Gas Co.

APPROVAL VALID
FOR 90 DAYS PRESS
DRILLING OPERATIONS

EXPIRES 2-24-80



IN ABOVE SPACE DESCRIBE PROPOSED PROGRAM; IF PROPOSAL IS TO DEEPEN OR PLUG BACK, GIVE DATA ON PRESENT PRODUCTIVE ZONE AND PROPOSED NEW PRODUCTIVE ZONE. GIVE BLOWOUT PREVENTER PROGRAM, IF ANY.

I hereby certify that the information above is true and complete to the best of my knowledge and belief.

Original Signed By

Signed B. E. FACKRELL Title District Engineer Date November 21, 1979

(This space for State Use)

APPROVED BY Frank S. Chang TITLE DEPUTY OIL & GAS INSPECTOR, DIST. #3 DATE NOV 20 1979

CONDITIONS OF APPROVAL, IF ANY:

OIL CONSERVATION DIVISION

STATE OF NEW MEXICO
ENERGY AND MINERALS DEPARTMENTP. O. BOX 2088
SANTA FE, NEW MEXICO 87501Form C-102
Revised 10-1-78

All distances must be from the outer boundaries of the Section.

Operator AMOCO PRODUCTION COMPANY			Lease CRAWFORD GAS COM "B"		Well No. 1-E
Unit Letter J	Section 24	Township 29N	Range 12W	County San Juan	
Actual Footage Location of Well: 1520 feet from the South line and 1520 feet from the East line					
Ground Level Elev. 5632	Producing Formation Dakota		Pool Basin Dakota	Dedicated Acreage: 320 Acres	

1. Outline the acreage dedicated to the subject well by colored pencil or hachure marks on the plat below.
2. If more than one lease is dedicated to the well, outline each and identify the ownership thereof (both as to working interest and royalty).
3. If more than one lease of different ownership is dedicated to the well, have the interests of all owners been consolidated by communitization, unitization, force-pooling, etc?

☒ Yes ☐ No If answer is "yes," type of consolidation Communitization

If answer is "no," list the owners and tract descriptions which have actually been consolidated. (Use reverse side of this form if necessary.) _____

No allowable will be assigned to the well until all interests have been consolidated (by communitization, unitization, forced-pooling, or otherwise) or until a non-standard unit, eliminating such interests, has been approved by the Commission.

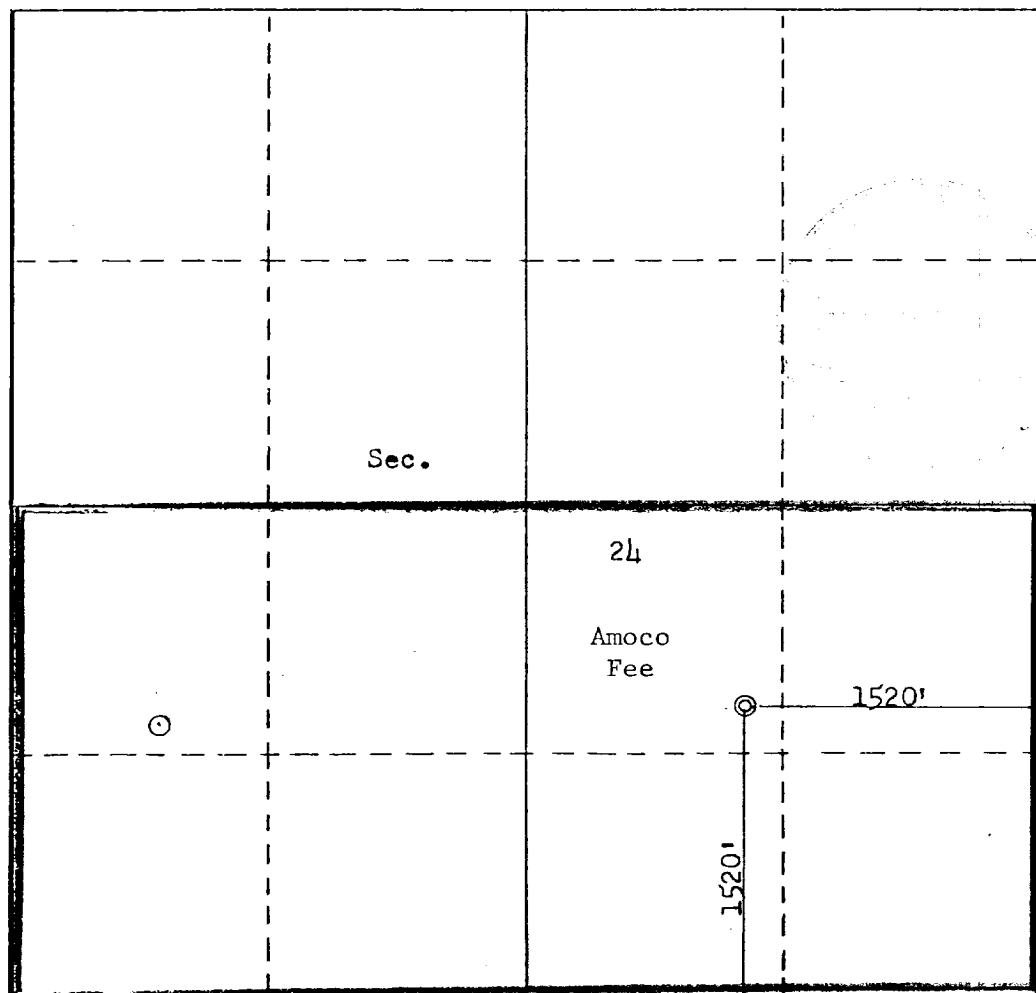

CERTIFICATION

I hereby certify that the information contained herein is true and complete to the best of my knowledge and belief.

B. E. Fackrell

Name

B. E. FACKRELL

Position

DISTRICT ENGINEER

Company

AMOCO PRODUCTION COMPANY

Date

NOVEMBER 9, 1979

I hereby certify that the well location shown on this plat was plotted from field notes of actual surveys made by me or under my supervision, and that the same is true and correct to the best of my knowledge and belief.

Date Surveyed

November 15, 1979

Registered Professional Engineer
and/or Land Surveyor*Fred B. Kerr Jr.*
Fred B. Kerr Jr.

Certificate No.

3950

B. KERR, JR.

THIS PORTION, OR ANY PART THEREOF, MAY BE PLACED OUTSIDE OF SUB-STRUCTURE IF DESIRED. USE LONG RADIUS BENDS. PIPE USED FOR EXTENSION SHOULD BE SHOP MADE WITH NO SCREWED CONNECTIONS AND PRESSURE TESTED INITIALLY TO SAME TEST PRESSURE AS THE CHOKE MANIFOLD.

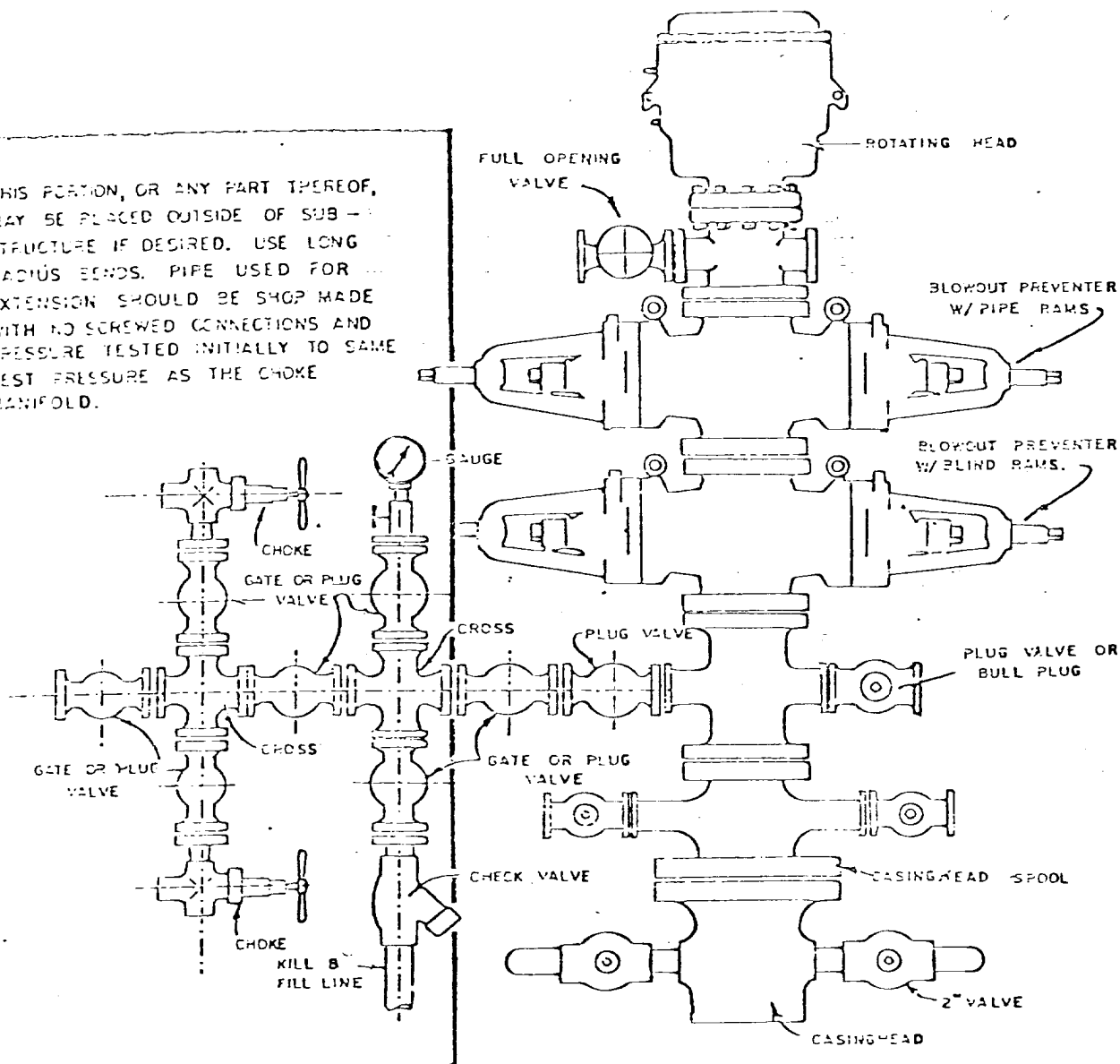

BLOWOUT PREVENTER HOOKUP