

Amended Location

NEW MEXICO OIL CONSERVATION COMMISSION

Form C-101
Revised 1-1-65

NO. OF COPIES RECEIVED	
DISTRIBUTION	
SANTA FE	
FILE	
U.S.G.S.	
LAND OFFICE	
OPERATOR	

5A. Indicate Type of Lease	
STATE <input type="checkbox"/>	FEE <input checked="" type="checkbox"/>
5. State Oil & Gas Lease No.	

APPLICATION FOR PERMIT TO DRILL, DEEPEN, OR PLUG BACK

1a. Type of Work		7. Unit Agreement Name	
b. Type of Well DRILL <input checked="" type="checkbox"/> DEEPEN <input type="checkbox"/> PLUG BACK <input type="checkbox"/> OIL WELL <input type="checkbox"/> GAS WELL <input checked="" type="checkbox"/> OTHER <input type="checkbox"/> SINGLE ZONE <input checked="" type="checkbox"/> MULTIPLE ZONE <input type="checkbox"/>		8. Farm or Lease Name Nye <i>Conn</i>	
2. Name of Operator Pioneer Production Corp.		9. Well No. #1E	
3. Address of Operator P O Box 208, Farmington, NM 87401		10. Field and Pool, or Wildcat Basin Dakota	
4. Location of Well UNIT LETTER <u>E</u> LOCATED <u>1090'</u> FEET FROM THE <u>West</u> LINE AND <u>1730'</u> FEET FROM THE <u>North</u> LINE OF SEC. <u>32</u> TWP. <u>29N</u> RGE. <u>11W</u> NMPM		12. County San Juan	
19. Proposed Depth 6250'		19A. Formation Dakota	
20. Rotary or C.T. Rotary		21. Elevations (Show whether DF, RT, etc.) 5423'	
21A. Kind & Status Plug. Bond		21B. Drilling Contractor Four Corners Drllg. Co.	
22. Approx. Date Work will start ASAP			

23.

PROPOSED CASING AND CEMENT PROGRAM

SIZE OF HOLE	SIZE OF CASING	WEIGHT PER FOOT	SETTING DEPTH	SACKS OF CEMENT	EST. TOP
12-1/4"	8-5/8"	24#	400'	200 sx	surface
7-7/8"	4-1/2"	10.5#	6250'	1550 sx	surface

Plan to drill w/ mud to test the Basin Dakota Formation. Plan to set 4½" csg, cement in two stages, selectively perforate, frac, cleanout after frac, run 1½' tbg. and complete well.

Plan to use BOP furnished by Four Corners Drilling (10" - 3000 psi hydraulic).

Plan to use BOP rental while completing (6" - 3000 spi double gate manual).

GAS DEDICATED.

IN ABOVE SPACE DESCRIBE PROPOSED PROGRAM: IF PROPOSAL IS TO DEEPEN OR PLUG BACK, GIVE DATA ON PRESENT PRODUCTIVE ZONE AND PROPOSED NEW PRODUCTIVE ZONE, GIVE BLOWOUT PREVENTER PROGRAM, IF ANY.

I hereby certify that the information above is true and complete to the best of my knowledge and belief.

Signature Thomas A. Dugan Title Agent Date 1-12-81

(This space for State Use)
Original Signed by CHARLES GHOLSON

DEPUTY OIL & GAS INSPECTOR

APPROVED BY _____ TITLE _____ DATE JAN 13 1981

CONDITIONS OF APPROVAL, IF ANY:

All distances must be from the outer boundaries of the Section.

Operator Pioneer Production Corporation			Lease Nye		Well No. 1E
Unit Letter E	Section 32	Township 29 North	Range 11 West	County San Juan	
Actual Footage Location of Well:					
1730	feet from the North	line and	1090	feet from the West	line
Ground Level Elev. 5423	Producing Formation	Pool		Dedicated Acreage: Acres	

1. Outline the acreage dedicated to the subject well by colored pencil or hachure marks on the plat below.
2. If more than one lease is dedicated to the well, outline each and identify the ownership thereof (both as to working interest and royalty).
3. If more than one lease of different ownership is dedicated to the well, have the interests of all owners been consolidated by communitization, unitization, force-pooling, etc?

☐ Yes ☐ No If answer is "yes," type of consolidation _____

If answer is "no," list the owners and tract descriptions which have actually been consolidated. (Use reverse side of this form if necessary.) _____

No allowable will be assigned to the well until all interests have been consolidated (by communitization, unitization, forced-pooling, or otherwise) or until a non-standard unit, eliminating such interests, has been approved by the Division.

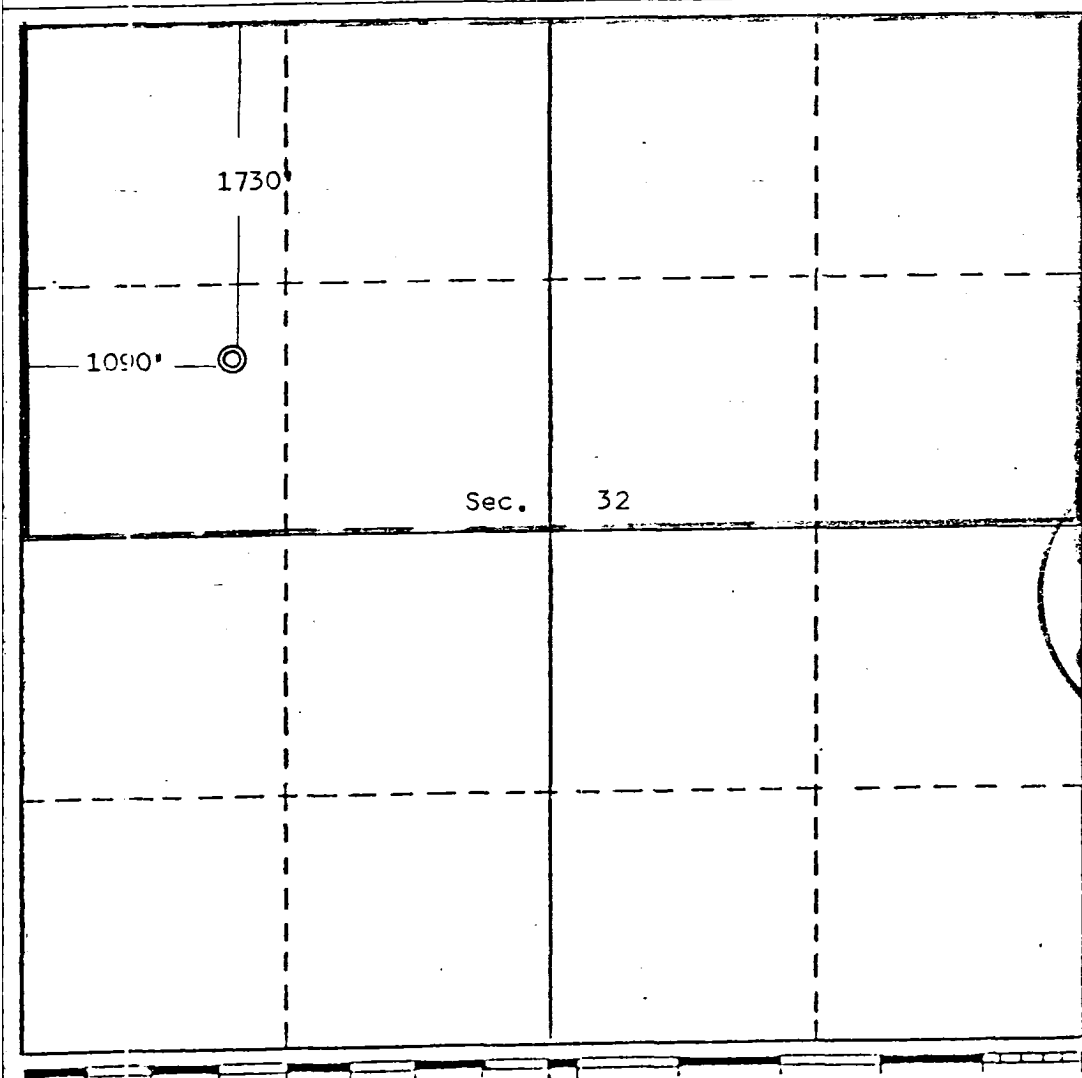

CERTIFICATION

I hereby certify that the information contained herein is true and complete to the best of my knowledge and belief.

J. L. Risen
Name

Position

Company

Date

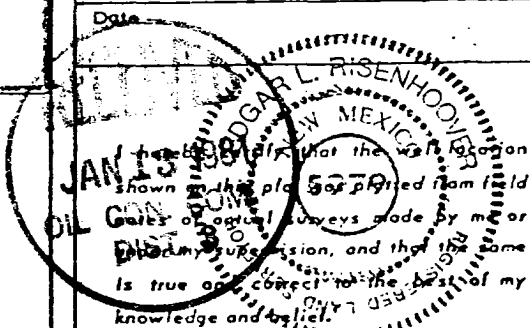

Date Surveyed

December 30, 1980

Registered Professional Engineer
and/or Land Surveyor

Edgar L. Risen

Certificate No. 5973

Edgar L. Risenhoover, L.S.