

COPIES RECEIVED		
DISTRIBUTION		
SANTA FE		
FILE		
U.S.G.S.		
LAND OFFICE		
OPERATOR		

3 - NMOCD 1 - Pioneer 1 - File
NEW MEXICO OIL CONSERVATION COMMISSION

Form C-103
Supersedes Old
C-102 and C-103
Effective 1-1-65

5a. Indicate Type of Lease	
State <input type="checkbox"/>	Fee <input checked="" type="checkbox"/>
5. State Oil & Gas Lease No.	

SUNDRY NOTICES AND REPORTS ON WELLS
(DO NOT USE THIS FORM FOR PROPOSALS TO DRILL OR TO DEEPEN OR PLUG BACK TO A DIFFERENT RESERVOIR.
USE "APPLICATION FOR PERMIT -" (FORM C-101) FOR SUCH PROPOSALS.)

1. OIL WELL <input type="checkbox"/> GAS WELL <input checked="" type="checkbox"/> OTHER <input type="checkbox"/>	7. Unit Agreement Name
2. Name of Operator Pioneer Production Corp.	8. Farm or Lease Name Salmon
3. Address of Operator P O Box 208, Farmington, NM 87401	9. Well No. #1E
4. Location of Well UNIT LETTER _____, 1080 FEET FROM THE North LINE AND 1540 FEET FROM THE East LINE, SECTION 30 TOWNSHIP 29N RANGE 11W NMPM.	10. Field and Pool, or Wildcat Basin Dakota
15. Elevation (Show whether DF, RT, GR, etc.) 5417' GL	12. County San Juan

16. Check Appropriate Box To Indicate Nature of Notice, Report or Other Data
NOTICE OF INTENTION TO: SUBSEQUENT REPORT OF:

PERFORM REMEDIAL WORK <input type="checkbox"/>	PLUG AND ABANDON <input type="checkbox"/>	REMEDIAL WORK <input type="checkbox"/>	ALTERING CASING <input type="checkbox"/>
TEMPORARILY ABANDON <input type="checkbox"/>	CHANGE PLANS <input type="checkbox"/>	COMMENCE DRILLING OPNS. <input type="checkbox"/>	PLUG AND ABANDONMENT <input type="checkbox"/>
PULL OR ALTER CASING <input type="checkbox"/>	OTHER <input checked="" type="checkbox"/> Extend Approval/Move well location	CASING TEST AND CEMENT JOBS <input type="checkbox"/>	OTHER <input type="checkbox"/>

17. Describe Proposed or Completed Operations (Clearly state all pertinent details, and give pertinent dates, including estimated date of starting any proposed work) SEE RULE 1103.

Request approval to move well location from 1080' FNL - 1540' FEL, Sec 30 T29N R11W, as originally approved, to the following location:

1170' FNL - 1730' FEL
Sec 30 T29N R11W
San Juan County, NM

An ammended plat is attached for your reference.

ALSO, request extension of approval to drill due to moving location and rig unavailability.

APPROVAL STAMP
FOR 6 HRS
8-16-81
EXPIRES

18. I hereby certify that the information above is true and complete to the best of my knowledge and belief.

SIGNED Jim L. Jacobs TITLE Agent DATE 2-25-81

Original Signed by FRANK J. CHAVEZ

SUPERVISOR DISTRICT # 3

DATE FEB 26 1981

APPROVED BY _____
CONDITIONS OF APPROVAL, IF ANY:

All distances must be from the outer boundaries of the Section.

Operator Pioneer Production Corporation		Lease Salmon		Well No. 1E
Unit Letter B	Section 30	Township 29 North	Range 11 West	County San Juan
Actual Footage Location of Well: 1170 feet from the North line and 1730 feet from the East line				
Ground Level Elev. 5413	Producing Formation Dakota	Pool Basin Dakota	Dedicated Acreage: 320 Acres	

1. Outline the acreage dedicated to the subject well by colored pencil or hachure marks on the plat below.
2. If more than one lease is dedicated to the well, outline each and identify the ownership thereof (both as to working interest and royalty).
3. If more than one lease of different ownership is dedicated to the well, have the interests of all owners been consolidated by communitization, unitization, force-pooling, etc?

☐ Yes ☐ No If answer is "yes," type of consolidation _____

If answer is "no," list the owners and tract descriptions which have actually been consolidated. (Use reverse side of this form if necessary.) _____

No allowable will be assigned to the well until all interests have been consolidated (by communitization, unitization, forced-pooling, or otherwise) or until a non-standard unit, eliminating such interests, has been approved by the Division.

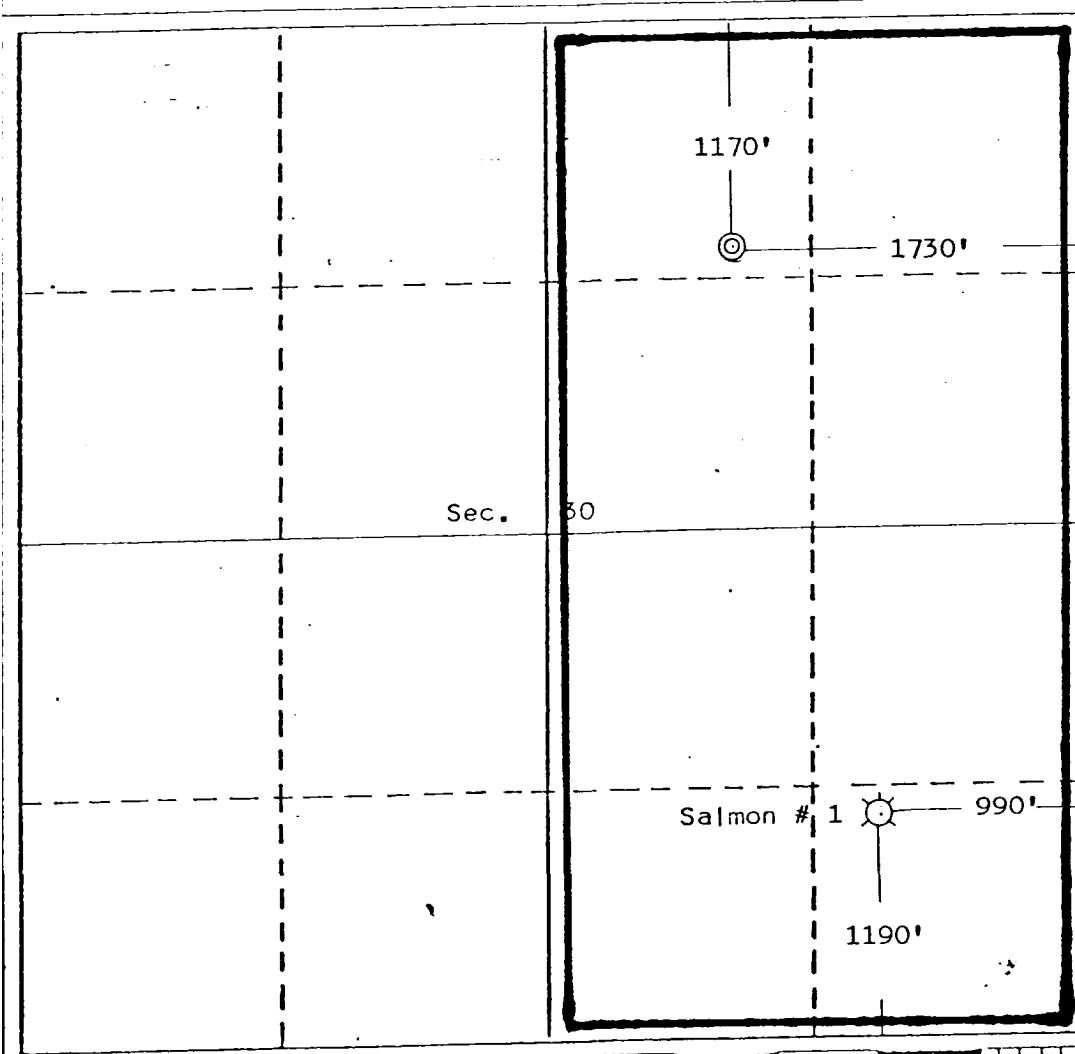

CERTIFICATION

I hereby certify that the information contained herein is true and complete to the best of my knowledge and belief.

Name
Jim L. Jacobson
Position
Agent
Company
Dugan Production Corp.
Date
2-25-81

EDGAR L. RISENHOWER
NEW MEXICO
REGISTERED LAND SURVEYOR
5979

Date Surveyed
February 15, 1981
Registered Professional Engineer
and/or Land Surveyor

Edgar L. Risenhower
Certificate No. 5979