

UNITED STATES  
DEPARTMENT OF THE INTERIOR  
GEOLOGICAL SURVEY

## APPLICATION FOR PERMIT TO DRILL, DEEPEN, OR PLUG BACK

1a. TYPE OF WORK DRILL ☒ DEEPEN ☐ PLUG BACK ☐

b. TYPE OF WELL  
OIL WELL ☐ GAS WELL ☒ OTHER ☐ SINGLE ZONE ☒ MULTIPLE ZONE ☐

2. NAME OF OPERATOR  
SUPRON ENERGY CORPORATION

3. ADDRESS OF OPERATOR  
P.O. Box 808, Farmington, New Mexico 87401

4. LOCATION OF WELL (Report location clearly and in accordance with any State requirements.)\*  
At surface 1020 ft./South line and 1120 ft./West line  
At proposed prod. zone Same as above

5. LEASE DESIGNATION AND SERIAL NO.  
30-045-24571  
NM 0702

6. IF INDIAN, ALLOTTEE OR TRIBE NAME

7. UNIT AGREEMENT NAME

8. FARM OR LEASE NAME  
Reid "B"

9. WELL NO.  
3

10. FIELD AND POOL, OR WILDCAT  
Bloomfield Chacra Ext.

11. SEC., T., R., M., OR BLK. AND SURVEY OR AREA  
Sec. 31, T-29N, R-10W, NMPL

12. COUNTY OR PARISH  
San Juan

13. STATE  
New Mexico

14. DISTANCE IN MILES AND DIRECTION FROM NEAREST TOWN OR POST OFFICE\*  
4 miles southeast of Bloomfield, New Mexico

15. DISTANCE FROM PROPOSED\* LOCATION TO NEAREST PROPERTY OR LEASE LINE, FT. (Also to nearest drlg. unit line, if any)  
1020 ft.  
1020 ft.

16. NO. OF ACRES IN LEASE  
560.00

17. NO. OF ACRES ASSIGNED TO THIS WELL  
160.00 SW 1/4

18. DISTANCE FROM PROPOSED LOCATION\* TO NEAREST WELL, DRILLING, COMPLETED, OR APPLIED FOR, ON THIS LEASE, FT.  
595 Ft.

19. PROPOSED DEPTH  
3060

20. ROTARY OR CABLE TOOLS  
Rotary

21. ELEVATIONS (Show whether DF, RT, GR, etc.)  
5741 GR.

22. APPROX. DATE WORK WILL START\*  
August 30, 1980

## 23. PROPOSED CASING AND CEMENTING PROGRAM

SIZE OF HOLE	SIZE OF CASING	WEIGHT PER FOOT	SETTING DEPTH	QUANTITY OF CEMENT
9-7/8"	7-5/8"	26.40	200 ft.	100 sx circulated
6-3/4"	2-7/8"	6.50	3060 ft.	395 sx cover Ojo Alamo

We propose to drill 9-7/8" surface hole to approx. 200 ft. Run 7-5/8" surface casing and cement, circulating the cement to the surface. Pressure test the casing. Drill 6-3/4" hole to approx. 3060 ft. and cement the 2-7/8" casing. Pressure test the long string. Perforate the casing and fracture the Chacra zone to stimulate production. Clean the well up and nipple down the wellhead. Test the well and connect it to a gathering system.

Gas from this well previously dedicated to a transporter.

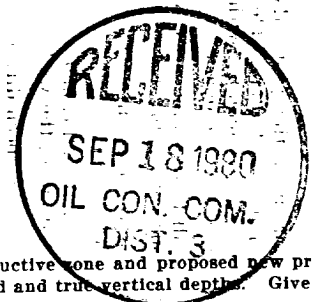
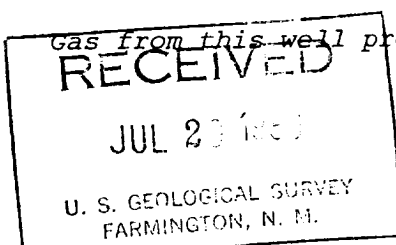

IN ABOVE SPACE DESCRIBE PROPOSED PROGRAM: If proposal is to deepen or plug back, give data on present productive zone and proposed new productive zone. If proposal is to drill or deepen directionally, give pertinent data on subsurface locations and measured and true vertical depths. Give blowout preventer program, if any.

24. SIGNED Ruby P. Mott TITLE Area Superintendent DATE July 29, 1980  
(This space for Federal or State office use)

PERMIT NO. \_\_\_\_\_ APPROVAL DATE \_\_\_\_\_  
APPROVED Gene Wampler TITLE \_\_\_\_\_ DATE \_\_\_\_\_  
CONDITIONS OF APPROVAL, IF ANY: \_\_\_\_\_

ok Frank

**NEW MEXICO OIL CONSERVATION COMMISSION  
WELL LOCATION AND ACREAGE DEDICATION PLAT**

Form C-102  
Supersedes C-128  
Effective 1-1-65

All distances must be from the outer boundaries of the Section.

Operator <b>SUPRON ENERGY CORPORATION</b>			Lease <b>REID B</b>		Well No. <b>3</b>
Unit Letter <b>M</b>	Section <b>31</b>	Township <b>29 NORTH</b>	Range <b>10 WEST</b>	County <b>SAN JUAN</b>	
Actual Footage Location of Well: <b>1020</b> feet from the <b>SOUTH</b> line and <b>1120</b> feet from the <b>WEST</b> line					
Ground Level Elev. <b>5741</b>	Producing Formation <b>Chaco</b>	Pool <b>Block 10 Extension</b>		Dedicated Acreage: <b>20.00 Acres</b>	

1. Outline the acreage dedicated to the subject well by colored pencil or hachure marks on the plat below.
2. If more than one lease is dedicated to the well, outline each and identify the ownership thereof (both as to working interest and royalty).
3. If more than one lease of different ownership is dedicated to the well, have the interests of all owners been consolidated by communitization, unitization, force-pooling, etc?

☐ Yes    ☐ No    If answer is "yes," type of consolidation \_\_\_\_\_

If answer is "no," list the owners and tract descriptions which have actually been consolidated. (Use reverse side of this form if necessary.) \_\_\_\_\_

No allowable will be assigned to the well until all interests have been consolidated (by communitization, unitization, forced-pooling, or otherwise) or until a non-standard unit, eliminating such interests, has been approved by the Commission.

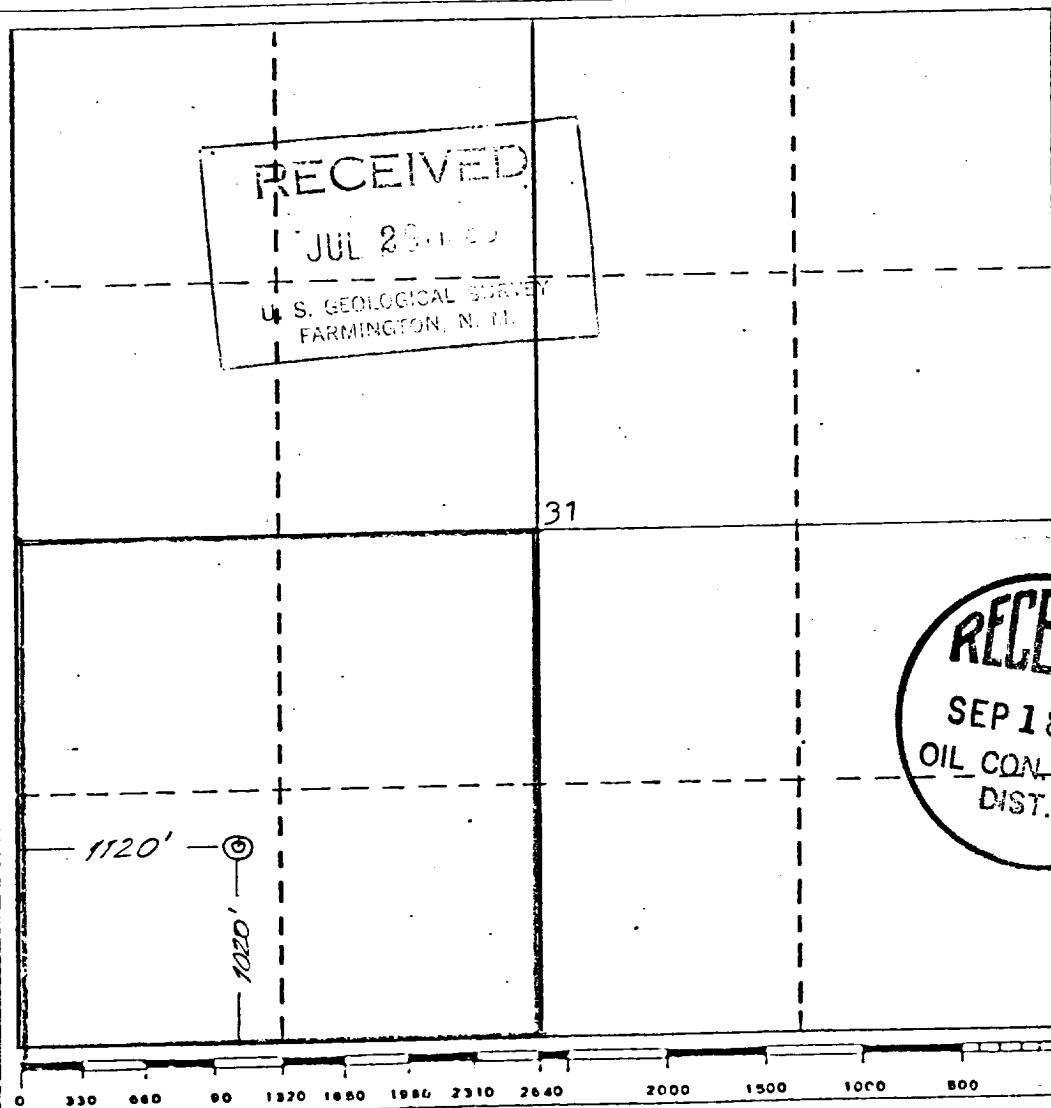

**CERTIFICATION**

I hereby certify that the information contained herein is true and complete to the best of my knowledge and belief.

*Lady D. Mett*  
Name  
**Lady D. Mett**

Position  
**Area Superintendent**

Company  
**SUPRON ENERGY CORPORATION**

Date  
**July 17, 1980**

I hereby certify that this plat was plotted from field notes made by me or under my supervision and that the same is true and correct to the best of my knowledge and belief.

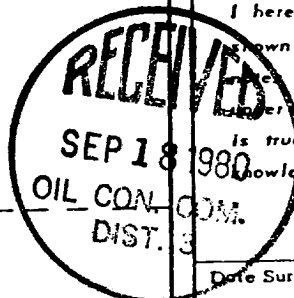
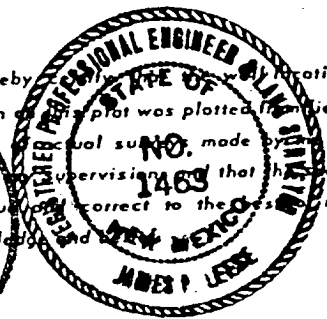

Date Surveyed  
**June 19, 1980**

Registered Professional Engineer  
and/or Land Surveyor  
*James P. Leese*  
**James P. Leese**

Certificate No.  
**1463**

SUPRON ENERGY CORPORATION

REID "B" No. 3

SW  $\frac{1}{4}$  Sec. 31, T-29N, R-10W, NMPM  
San Juan County, New Mexico

1. The Geologic name of the surface formation is "Wasatch".
2. The estimated tops of important Geologic markers are:

A. Top of the Ojo Alamo	730 ft.
B. Top of the Fruitland	1640 ft.
C. Top of the Pictured Cliffs	1885 ft.
D. Top of the Chacra	2885 ft.
3. The estimated depth at which anticipated water, oil or other mineral bearing formations are expected to be encountered are:

A. Top of the Ojo Alamo	730 ft.	Water
B. Top of the Fruitland	1640 ft.	Water
C. Top of the Pictured Cliffs	1885 ft.	Gas
D. Top of the Chacra	2885 ft.	Gas
4. The casing program is shown on 9-331C and all casing is new.
5. The lessee's pressure control equipment schematics are attached along with minimum specifications, testing procedures and frequencies.
6. The type, estimated volumes and characteristics of the circulating medium are as follows:

A. 0 to 200 ft.	Natural mud
B. 200 to 3060 ft.	Permaloid non dispersed mud containing approx. 67 sx of Permaloid and 10 sx of C.M.C.
7. The auxiliary equipment will be floats at the bit and a sub on the floor with a full opening valve to be stabbed into the drill pipe when the kelly is not in the string.
8. This well is in an area which is heavily developed; therefore we will not have a testing or coring program. The logging program is as follows:

A. E.S. Induction
B. Gamma Ray Density
C. Gamma Ray Correlation
D. Cement Bond or Temperature
9. We do not expect to find any abnormal pressures, temperatures or hydrogen sulfide problems in this heavily developed area.
10. The anticipated starting date for this well is August 30, 1980, dependent on rig availability.

SUPRON ENERGY CORPORATION

REID "B" NO. 3

NW/4 Sec. 31, T-29N, R-10W, N.M.P.M.  
San Juan County, New Mexico

The following attachments are included with this application:

1. Topographical map showing the proposed location and access road.
2. Planned access road is 300 feet long and 20 feet wide. The road will follow the natural contour of the land and will have drainage facilities installed to meet the requirements of NTL-6. No extra surfacing materials will be used.
3. Map showing existing production facilities and access roads.
4. Location of surface equipment if required.
5. Drilling and completion water will be obtained from the San Juan River.
6. All pits will be fenced and constructed in such a manner as to prevent litter on the location.
7. We will dispose of all waste by placing it in the reserve pit and burying it when the well is completed.
8. There is no camp at or near the site.
9. There is no air strip.
10. A plat is attached showing the location of the rig, mud tanks, reserve pit, burn pit and etc.
11. A letter of certification is attached. The operators representative for compliance purposes is Rudy D. Motto, Area Superintendent, P.O. Box 808, Farmington, New Mexico 87401. Phone (505) 325-3587.
12. After the well is completed, the location will be cleaned up and bladed. The reserve pit will be allowed to dry, then be filled and restored to its natural state.
13. The soil is sandy clay loam with the principal vegetation being snakeweed, mormon tea, indian ricegrass, juniper and sagebrush.

This is a detailed topographic map of a portion of San Juan County, New Mexico. The map features a grid of section numbers (e.g., 16, 18, 20, 22, 24, 26, 28, 30, 32, 34, 36, 38, 40, 42, 44, 46, 48, 50, 52, 54, 56, 58, 60, 62, 64, 66, 68, 70, 72, 74, 76, 78, 80, 82, 84, 86, 88, 90, 92, 94, 96, 98, 100) and various geographical features. Key locations include Bloomfield, Citizens, and San Juan. The map shows contour lines, roads, and various landmarks. A specific area is highlighted with a black box, and a text label is placed over it.

Supron Energy Corporation  
Reid B #3  
SW $\frac{1}{4}$  Sec 31, T29N, R10W, N.M.P.M.  
San Juan County, New Mexico

# LOCATION AND EQUIPMENT LAYOUT

SUPRON ENERGY CORPORATION

REID "B" NO. 3

1020 Ft./South; 1120 Ft./West line  
Sec. 31, Twp. 29N, Rge. 10W, N.M.P.M.,  
San Juan County, New Mexico

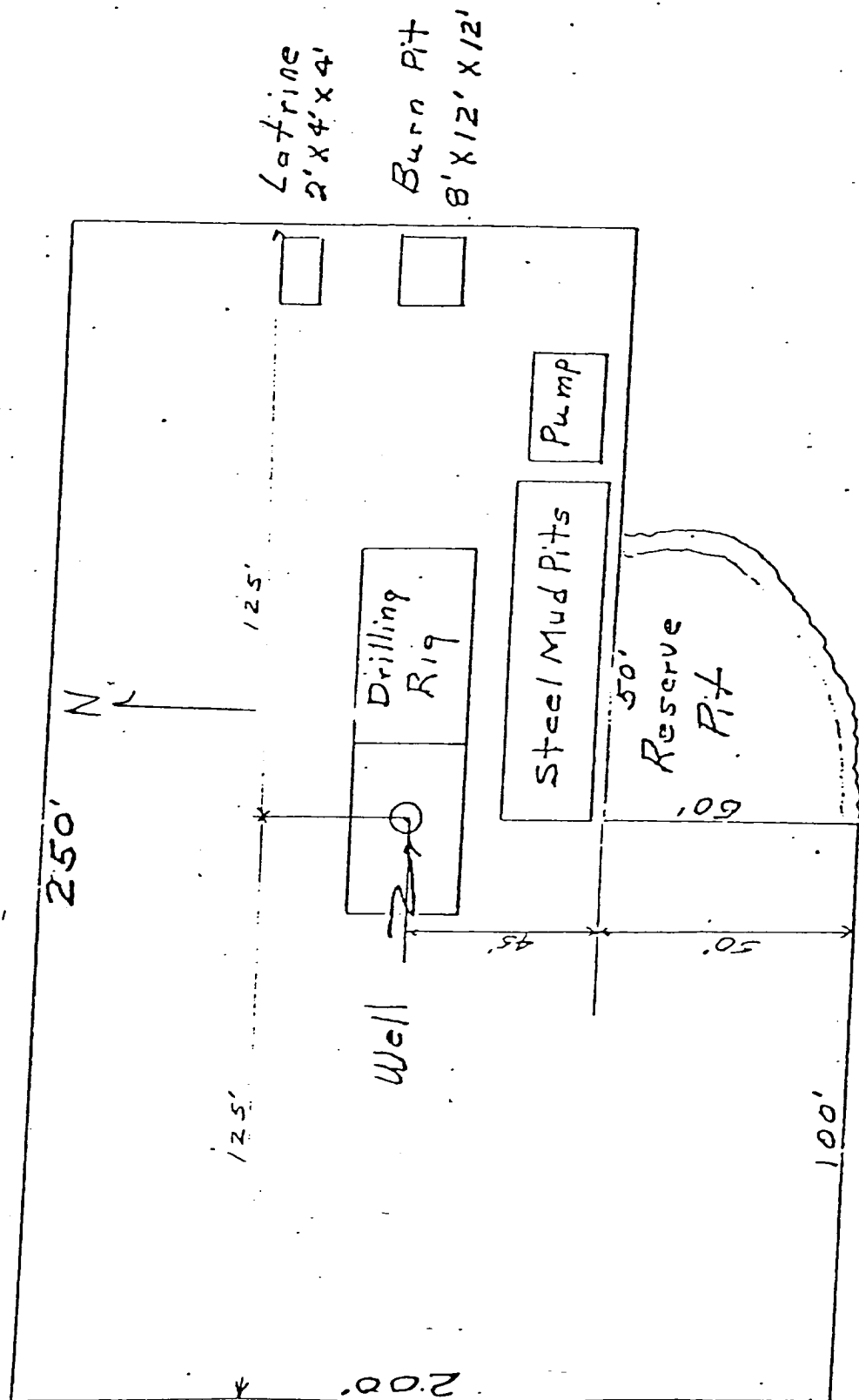

The B.O.P. and all valve and fittings are rated at 3000 psi working pressure, and hydraulically operated

The B.O.P. and all valve and fittings are rated at 3000 psi working pressure, and hydraulically operated

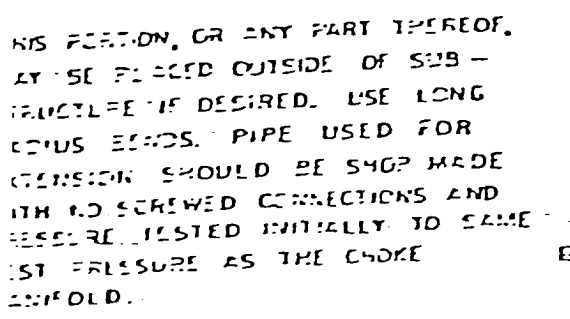

# BLOWOUT PREVENTER HOOKUP

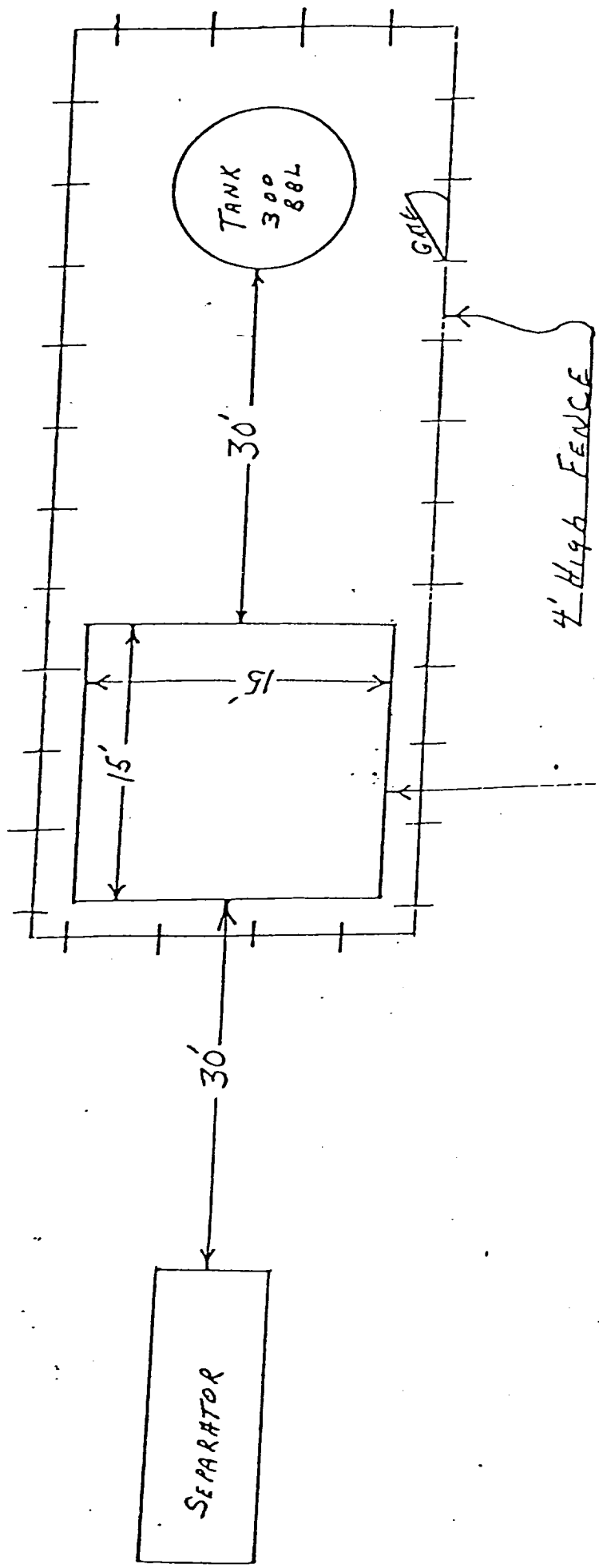



SUPRON ENERGY CORPORATION

Post Office Box 808

FARMINGTON, NEW MEXICO 87401

I hereby certify that I, or persons under my direct supervision, have inspected the proposed drillsite and access route; that I am familiar with the conditions which presently exist; that the statements made in this plan are, to the best of my knowledge, true and correct; and, that the work associated with the operations proposed herein will be performed by SUPRON ENERGY CORPORATION and its contractors subcontractors in conformity with this plan and the terms and conditions under which it is approved.

SUPRON ENERGY CORPORATION



Rudy D. Motto  
Area Superintendent  
Phone: 325-3587