

DISTRICT II  
P.O. Drawer DD, Artesia, NM 88210

# OIL CONSERVATION DIVISION

P.O. Box 2088

Santa Fe, New Mexico 87504-2088

DISTRICT III  
1000 Rio Brazos Rd., Aztec, NM 87410

## REQUEST FOR ALLOWABLE AND AUTHORIZATION TO TRANSPORT OIL AND NATURAL GAS

Operator AMOCO PRODUCTION COMPANY		Well API No. 300452488100
Address P.O. BOX 800, DENVER, COLORADO 80201		
Reason(s) for Filing (Check proper box) <input type="checkbox"/> Other (Please explain)		
New Well <input type="checkbox"/>	Change in Transporter of: <input type="checkbox"/>	
Recompletion <input type="checkbox"/>	Oil <input type="checkbox"/> Dry Gas <input type="checkbox"/>	
Change in Operator <input type="checkbox"/>	Casinghead Gas <input type="checkbox"/> Condensate <input checked="" type="checkbox"/>	
If change of operator give name and address of previous operator		

### II. DESCRIPTION OF WELL AND LEASE

Lease Name STATE GAS COM BP	Well No. 1	Pool Name, Including Formation BASIN DAKOTA (PRORATED GAS)	Kind of Lease State, Federal or Fee	Lease No.
Location				
Unit Letter G	1770	Feet From The FNL	Line and 1740	Feet From The FEL
Section 32	Township 29N	Range 9W	NMPM, SAN JUAN	County

### III. DESIGNATION OF TRANSPORTER OF OIL AND NATURAL GAS

Name of Authorized Transporter of Oil <input type="checkbox"/> or Condensate <input checked="" type="checkbox"/>	Address (Give address to which approved copy of this form is to be sent)
MERIDIAN OIL INC.	3535 EAST 30TH STREET, FARMINGTON, CO 87401
Name of Authorized Transporter of Casinghead Gas <input type="checkbox"/> or Dry Gas <input checked="" type="checkbox"/>	Address (Give address to which approved copy of this form is to be sent)
EL PASO NATURAL GAS COMPANY	P.O. BOX 1492, EL PASO, TX 79978
If well produces oil or liquids, give location of tanks.	Is gas actually connected? When?

If this production is commingled with that from any other lease or pool, give commingling order number.

### IV. COMPLETION DATA

Designate Type of Completion - (X)	Oil Well	Gas Well	New Well	Workover	Deepen	Plug Back	Same Res'v	Diff Res'v
Date Spudded	Date Compl. Ready to Prod.		Total Depth		P.B.T.D.			
Elevations (DF, RKB, RT, GR, etc.)	Name of Producing Formation		Top Oil/Gas Pay		Tubing Depth			
Perforations					Depth Casing Shoe			
TUBING, CASING AND CEMENTING RECORD								
HOLE SIZE	CASING & TUBING SIZE		DEPTH SET		SACKS CEMENT			

### V. TEST DATA AND REQUEST FOR ALLOWABLE

OIL WELL (Test must be after recovery of total volume of load oil and must be equal to or exceed top allowable for this depth, or be for full 24 hours)

Date First New Oil Run To Tank	Date of Test	Producing Method (Flow, pump, gas lift, etc.)	
Length of Test	Tubing Pressure	Casing Pressure	Choke Size
Actual Prod. During Test	Oil - Bbls.	Water - Bbls.	

RECEIVED  
JUL 5 1990

### GAS WELL

Actual Prod. Test - MCF/D	Length of Test	Bbls. Condensate/MMCF	Oil CON. DIV. 1
Testing Method (prod, back pr.)	Tubing Pressure (Shut-in)	Casing Pressure (Shut-in)	DIST. 3

### VI. OPERATOR CERTIFICATE OF COMPLIANCE

I hereby certify that the rules and regulations of the Oil Conservation Division have been complied with and that the information given above is true and complete to the best of my knowledge and belief.

Signature  
Doug W. Whaley, Staff Admin. Supervisor  
Printed Name  
June 25, 1990  
Date  
303-830-4280  
Telephone No.

### OIL CONSERVATION DIVISION

Date Approved JUL 5 1990

By  
SUPERVISOR DISTRICT 13

INSTRUCTIONS: This form is to be filed in compliance with Rule 1104

- 1) Request for allowable for newly drilled or deepened well must be accompanied by tabulation of deviation tests taken in accordance with Rule 111.
- 2) All sections of this form must be filled out for allowable on new and recompleted wells.
- 3) Fill out only Sections I, II, III, and VI for changes of operator, well name or number, transporter, or other such changes.
- 4) Separate Form C-104 must be filed for each pool in multiply completed wells.



State Gas Cons Bp #1  
G-32-29N-9W

Southern

Rockies

Business

Unit

May 29, 1996

Mr. William J. LeMay, Director  
New Mexico Oil Conservation Division  
2040 S. Pacheco Street  
P. O. Box 6429  
Santa Fe, NM 87505

RECEIVED  
JUN - 3 1996

OIL CON. DIV.  
DIST. 3

**Application for Exception to Rule 303-C - Downhole Commingling  
State BP #1 and State AX #2 Well  
Unit G Section 32-T29N-R9W  
Otero Chacra and Basin Dakota Pools  
San Juan County, New Mexico**

Enclosed please find an administrative application form (C-107-A) and attachments for downhole commingling for the captioned well. By copy of this application by certified mail, return receipt requested, Amoco is notifying all offset operators in the formations captioned above as well as all affected interest owners if the ownership of those formations is not common. The Division Director may approve the proposed downhole commingling in the absence of a valid objection from any offset operator or any interest owner in those instances where ownership is not common in the zones to be commingled within 20 days after the receipt of the application if, in his opinion, waste will not result thereby, and correlative rights will not be violated.

Should there be questions concerning this matter, please contact me at (303) 830-5344.

Sincerely,

Pamela W. Staley

Enclosures

cc: Steve Webb  
Gail Jefferson  
Wellfile  
Proration File

Frank Chavez, Supervisor  
NMOCD District III  
1000 Rio Brazos Road  
Aztec, NM 87410

DISTRICT I  
P.O. Box 1980, Hobbs NM 88241-1980

State of New Mexico  
Energy, Minerals and Natural Resources Department

Form C-107-A  
New 3-12-96

OIL CONSERVATION DIVISION

APPROVAL PROCESS:

DISTRICT II  
811 South First St., Artesia, NM 88210-2835

2040 S. Pacheco  
Santa Fe, New Mexico 87505-6429

☒ Administrative ☐ Hearing

DISTRICT III  
1000 Rio Brazos Rd. Aztec, NM 87410-1693

APPLICATION FOR DOWNHOLE COMMINGLING

EXISTING WELLBORE  
☒ YES ☐ NO

Amoco Production Company

P.O. Box 800 Denver, CO 80201

Operator  
State Gas Com BP

#1

Address  
G-32-29N-9W

San Juan

Lease

Well No

Unit Ltr. - Sec Twp - Rge

County

NOTE: AKA STATE AX #2

Spacing Unit Lease Types: (check 1 or more)

OGRID NO 000778 Property Code 001078 API NO 3004524881 Federal State ☒ (and/or) Fee

The following facts are submitted in support of downhole commingling:	Upper Zone	Intermediate Zone	Lower Zone
1. Pool Name and Pool Code	OTERO CHACRA 82329		BASIN DAKOTA 71599
2. Top and Bottom of Pay Section (Perforations)	3463' - 3602'		6957' - 7144'
3. Type of production (Oil or Gas)	GAS		GAS
4. Method of Production (Flowing or Artificial Lift)	FLOWING		FLOWING
5. Bottomhole Pressure Oil Zones - Artificial Lift: Estimated Current Gas & Oil - Flowing: Measured Current All Gas Zones: Estimated or Measured Original	a. (Current) 616 PSI b. (Original) 1200 PSI	a. b.	a. 1103 PSI b. 2415 PSI
6. Oil Gravity (° API) or Gas BTU Content	1240 BTU		1261 BTU / 59.3 DEG API
7. Producing or Shut-In?	PRODUCING		PRODUCING
Production Marginal? (yes or no) • If Shut-In, give data and oil/gas/water rates of last production Note: For new zones with no production history, applicant shall be required to attach production estimates and supporting data • If Producing, give date and oil/gas/water rates of recent test (within 60 days)	YES Date: Rates: 5/96 20 MCFD 0 BCPD 0 BWPD	 Date: Rates: Date: Rates:	NO Date: Rates: 5/96 120 MCFD .019 BCPD <1 BWPD
8. Fixed Percentage Allocation Formula -% for each zone	Oil: 0 % Gas 14 %	Oil: % Gas %	Oil: 100 % Gas 86 %

9. If allocation formula is based upon something other than current or past production, or is based upon some other method, submit attachments with supporting data and/or explaining method and providing rate projections or other required data.

10. Are all working, overriding, and royalty interests identical in all commingled zones? ☐ Yes ☒ No  
If not, have all working, overriding, and royalty interests been notified by certified mail? ☒ Yes ☐ No  
Have all offset operators been given written notice of the proposed downhole commingling? ☒ Yes ☐ No

11. Will cross-flow occur? ☒ Yes ☐ No If yes, are fluids compatible, will the formations not be damaged, will any cross-flowed production be recovered, and will the allocation formula be reliable. ☒ Yes ☐ No (If No, attach explanation)

12. Are all produced fluids from all commingled zones compatible with each other? ☒ Yes ☐ No

13. Will the value of production be decreased by commingling? ☐ Yes ☒ No (If Yes, attach explanation)

14. If this well is on, or communitized with, state or federal lands, either the Commissioner of Public Lands or the United States Bureau of Land Management has been notified in writing of this application. ☒ Yes ☐ No

STATE LEASE #E-2738-1 & E-6513 COM RECORDED 4/27/82 BK 930 PG 294

15. NMOCD Reference Cases for Rule 303(D) Exceptions: ORDER NO(S):

16. ATTACHMENTS:

- \* C-102 for each zone to be commingled showing its spacing unit and acreage dedication.
- \* Production curve for each zone for at least one year. (if not available, attach explanation.)
- \* For zones with no production history, estimated production rates and supporting data.
- \* Data to support allocation method or formula.
- \* Notification list of all offset operators.
- \* Notification list of working, overriding, and royalty interests for uncommon interest cases.
- \* Any additional statements, data, or documents required to support commingling.

I hereby certify that the information above is true and complete to the best of my knowledge and belief.

SIGNATURE Pamela W. Staley TITLE REGULATORY AFFAIRS REP DATE 5/23/96

TYPE OR PRINT NAME PAMELA W. STALEY TELEPHONE NO. ( 303 ) 830-5344

All distances must be from the outer boundaries of the Section.

Operator <b>AMOCO PRODUCTION COMPANY</b>			Lease <b>STATE GAS COM "BP"</b>		Well No. <b>1</b>
Unit Letter <b>Q</b>	Section <b>32</b>	Township <b>29N</b>	Range <b>9W</b>	County <b>San Juan</b>	
Actual Footage Location of Well:					
1770 feet from the North line and		1740 feet from the East line			
Ground Level Elev: <b>6150</b>	Producing Formation <b>Dakota/Chacra</b>	Pool <b>Basin Dakota/Otero Chacra</b>	Dedicated Acreage: <b>320/160</b> Acres		

1. Outline the acreage dedicated to the subject well by colored pencil or hatchure marks on the plat below.
2. If more than one lease is dedicated to the well, outline each and identify the ownership thereof (both as to working interest and royalty).
3. If more than one lease of different ownership is dedicated to the well, have the interests of all owners been consolidated by communitization, unitization, force-pooling, etc?

☒ Yes ☐ No If answer is "yes," type of consolidation Communitization

If answer is "no," list the owners and tract descriptions which have actually been consolidated. (Use reverse side of this form if necessary.)

No allowable will be assigned to the well until all interests have been consolidated (by communitization, unitization, forced-pooling, or otherwise) or until a non-standard unit, eliminating such interests, has been approved by the Commission.

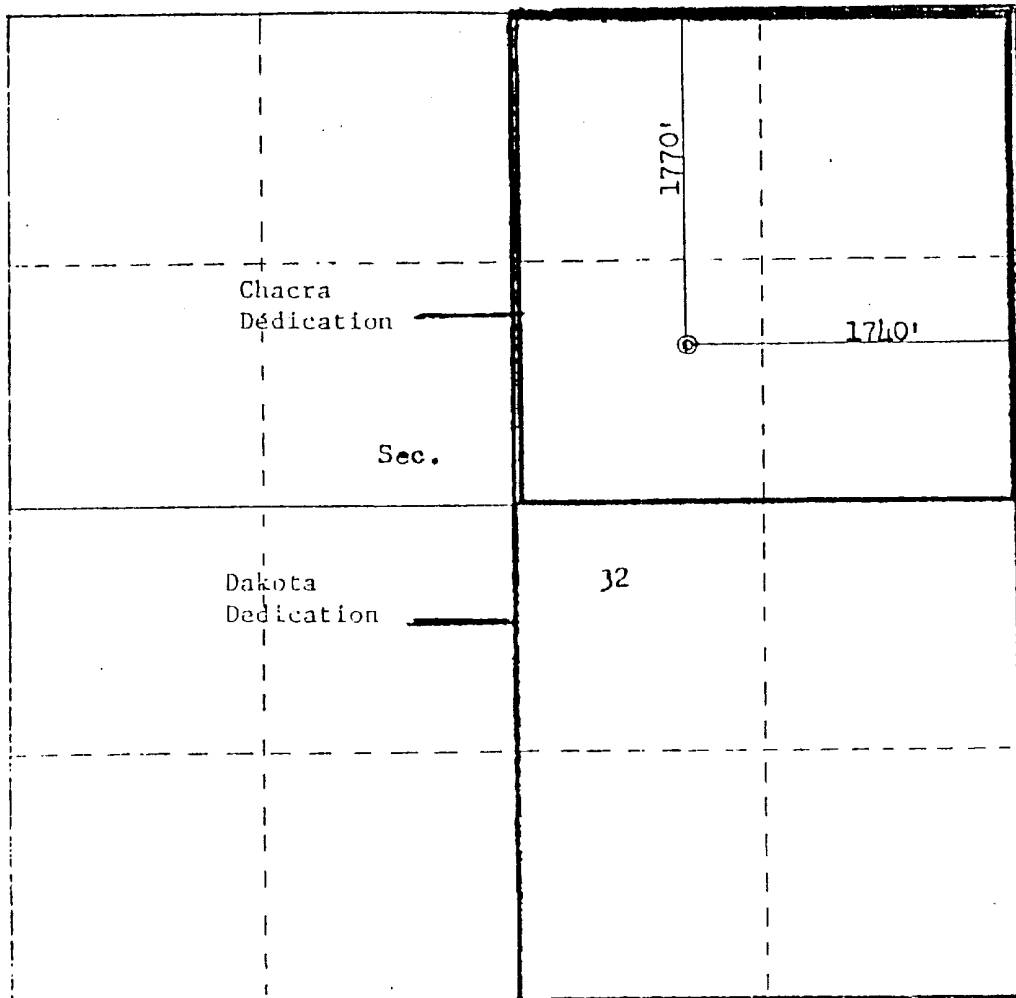

Scale: 1"-1000'

CERTIFICATION

I hereby certify that the information contained herein is true and complete to the best of my knowledge and belief.

*Wayne L. Peterson*

Name

W. L. PETERSON

Position

DISTRICT ENGINEER

Company

AMOCO PRODUCTION COMPANY

Date

2-17-81

I hereby certify that the well location shown on this plat was plotted from field notes of actual surveys made by me or under my supervision, and that the same is true and correct to the best of my knowledge and belief.

Date Surveyed

February 13, 1981

Registered Professional Engineer and A Land Surveyor

*Fred B. Kerr Jr.*

Certificate No.

3950

All distances must be from the outer boundaries of the Section.

Operator <b>AMOCO PRODUCTION COMPANY</b>			Lease State "AX" - <b>STATE GAS COM BP#1</b>		Well No. <b>3</b>
Unit Letter <b>0</b>	Section <b>32</b>	Township <b>29N</b>	Range <b>9W</b>	County <b>San Juan</b>	
1770 feet from the North line and 1780 feet from the East line Ground Level Elev: <b>6150</b> Producing Formation <b>Dakota/Chacra</b> Pool <b>Basin Dakota/Otero Chacra</b> Dedicated Acreage: <b>320/160</b> Acres					

1. Outline the acreage dedicated to the subject well by colored pencil or hatchure marks on the plat below.
2. If more than one lease is dedicated to the well, outline each and identify the ownership thereof (both as to working interest and royalty).
3. If more than one lease of different ownership is dedicated to the well, have the interests of all owners been consolidated by communitization, unitization, force-pooling, etc?

☒ Yes ☐ No If answer is "yes," type of consolidation Communitization

If answer is "no," list the owners and tract descriptions which have actually been consolidated. (Use reverse side of this form if necessary.)

No allowable will be assigned to the well until all interests have been consolidated (by communitization, unitization, forced-pooling, or otherwise) or until a non-standard unit, eliminating such interests, has been approved by the Commission.

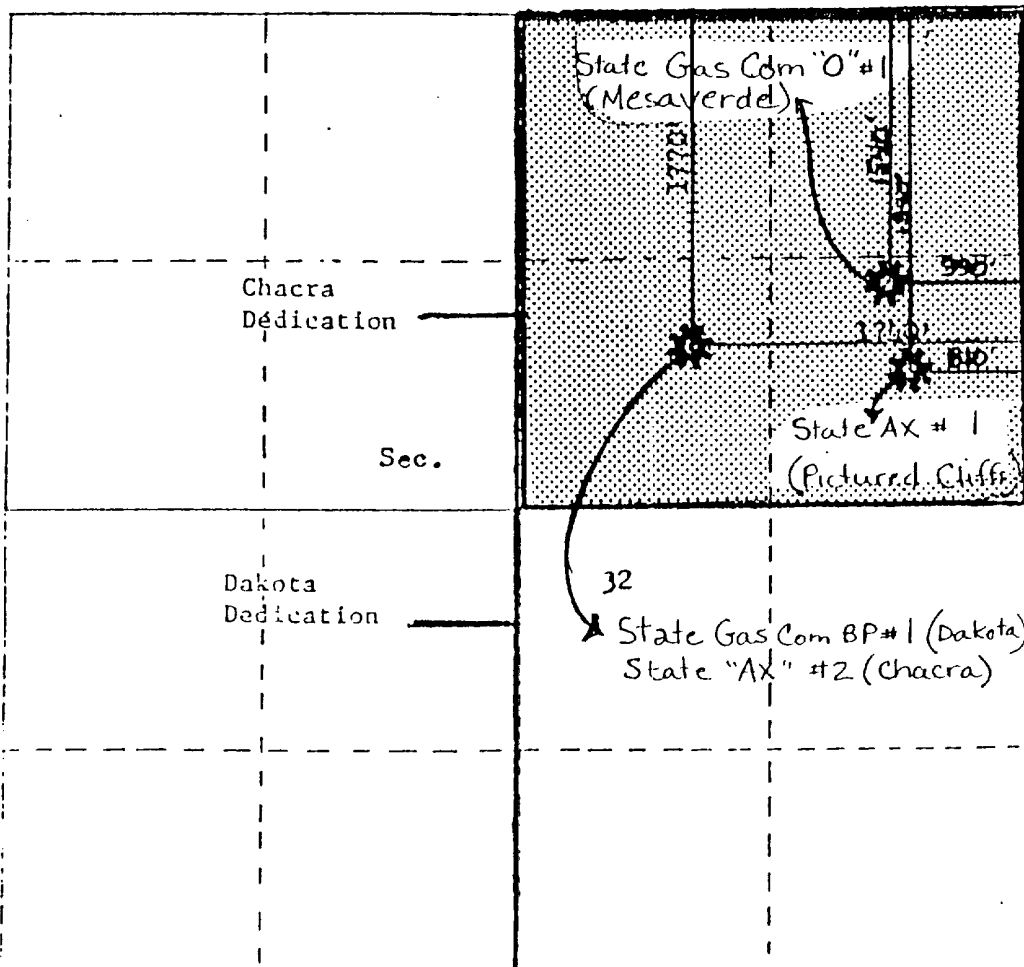

CERTIFICATION

I hereby certify that the information contained herein is true and complete to the best of my knowledge and belief.

*Wayne L. Peterson*

Name  
**W. L. PETERSON**

Position  
**DISTRICT ENGINEER**

Company  
**AMOCO PRODUCTION COMPANY**

Date  
**2-17-81**

I hereby certify that the well location shown on this plat was plotted from field notes of actual surveys made by me or under my supervision, and that the same is true and correct to the best of my knowledge and belief.

Date Surveyed  
**February 13, 1981**

Registered Professional Engineer  
and Land Surveyor

*Fred B. Kern Jr.*  
**Fred B. Kern Jr.**

For: zaic14  
Engr: zr06

State AX 2  
300452488100CK G322909-001 CK Operator- AMOCO PRODUCTION CO  
APC\_WI - 1.0000000

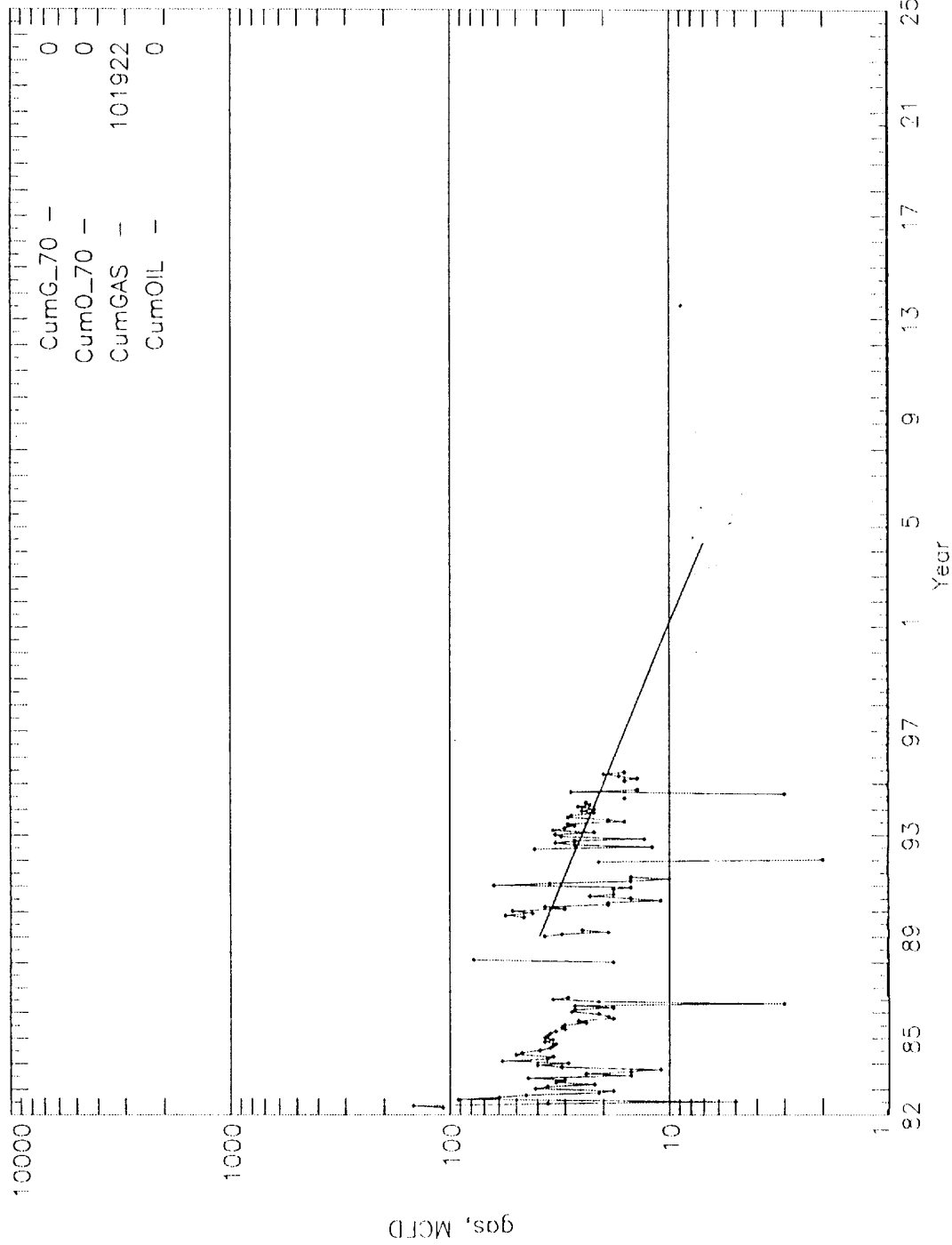

For: zalc14  
Engr: zrar06

STATE GAS COM BP 1 Operator- AMOCO PRODUCTION CO

300452488100DK G322909-001 DK APC\_WI - 0.87500000

10 <sup>5</sup>	CumG_70 -	0
	CumO_70 -	0
10 <sup>4</sup>	CumGAS -	1015165
	CumOIL -	19769

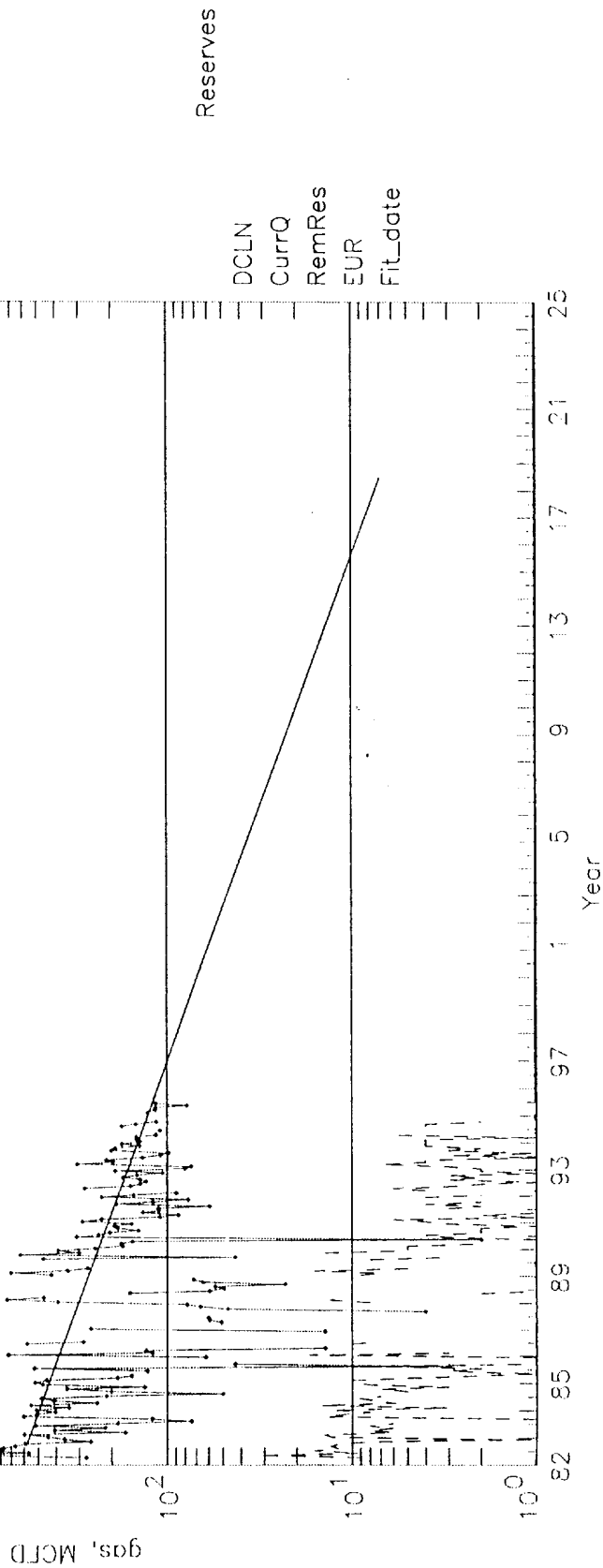

Last Op. Forecast by zrar06 in 07/1995

15566200 00001  
617000 00  
AMOCO PRODUCTION COMPANY  
P O BOX 591  
TULSA

ZJAM63

OK 74102-0591

15566200 00001  
603416 25  
CONOCO INC  
P O BOX 951063  
DALLAS

ZJAM63

TX 75395-1063

15566200 00001  
610592 03  
STATE OF NEW MEXICO  
STATE LAND OFFICE  
SANTA FE

ZJAM63

NM 87501