

UNITED STATES
DEPARTMENT OF THE INTERIOR
GEOLOGICAL SURVEY

APPLICATION FOR PERMIT TO DRILL, DEEPEN, OR PLUG BACK

1a. TYPE OF WORK DRILL ☒ DEEPEN ☐ PLUG BACK ☐

b. TYPE OF WELL
OIL WELL ☒ GAS WELL ☐ OTHER ☐
SINGLE ZONE ☒ MULTIPLE ZONE ☐

2. NAME OF OPERATOR
Union Texas Petroleum Corporation

3. ADDRESS OF OPERATOR
P.O. Box 808, Farmington, New Mexico 87401

4. LOCATION OF WELL (Report location clearly and in accordance with any State requirements)
At surface 1980 ft./South line; 650 ft./East line

At proposed prod. zone Same as above

U. S. GEOLOGICAL SURVEY
FARMINGTON, N. M.

14. DISTANCE IN MILES AND DIRECTION FROM NEAREST TOWN OR POST OFFICE*
4-3/4 miles Southeast of Bloomfield, New Mexico

15. DISTANCE FROM PROPOSED*
LOCATION TO NEAREST
PROPERTY OR LEASE LINE, FT.
(Also to nearest drig. unit line, if any) 650 ft. 650 ft.

18. DISTANCE FROM PROPOSED LOCATION*
TO NEAREST WELL, DRILLING, COMPLETED,
OR APPLIED FOR, ON THIS LEASE, FT. 886 ft.

21. ELEVATIONS (Show whether DF, RT, GR, etc.)
5710 Gr.

16. NO. OF ACRES IN LEASE
2,284.3

19. PROPOSED DEPTH
6044 ft.

17. NO. OF ACRES ASSIGNED
TO THIS WELL
NE SE 40.00

20. ROTARY OR CABLE TOOLS
Rotary

22. APPROX. DATE WORK WILL START*
October 10, 1982

PROPOSED CASING AND CEMENTING PROGRAM

SIZE OF HOLE	SIZE OF CASING	WEIGHT PER FOOT	SETTING DEPTH	QUANTITY OF CEMENT
13-3/4"	10-3/4, K-55	40.55	300 ft.	240 cu. ft. (Circulated)
9-7/8"	7-5/8, K-55	26.40	5244 ft.	1440 cu. ft. (to base of surface)
6-3/4"	5-1/2, J-55	15.50	5044 to 6044 ft.	142 cu. ft. (to top of liner)

We desire to drill 13-3/4" surface hole to approximately 300 ft. using natural mud as a circulating medium. Run new 10-3/4", 40.55#, K-55, ST&C casing to T.D. Circulate cement to the surface. W.O.C. Test casing to 800 PSIG for 10 minutes. Drill out with 9-7/8" bit to approximately 5244 ft. using a starch base, non-dispersed, permaloid mud as the circulating medium. Run new 7-5/8", K-55, 26.40#, ST&C pipe to T.D. with a D.V. tool at approximately 2000 ft. Cement the first stage with approximately 620 cu. ft. of 65/35/6 pozmix followed by approximately 90 cu. ft. of Class "B" cement. 2nd stage with approximately 640 cu. ft. of 65/35/12 followed by approximately 90 cu. ft. of Class "B" cement. W.O.C. Drill out D.V. tool. Pressure test the casing to 1500# for 10 minutes. Drill out with 6-3/4" bit, using natural gas as a circulation medium, to approximately 6044 ft. Log the well. Run new 5-1/2", K-55, 15.50# ST&C casing to T.D. and cement with approximately 142 cu. ft. of 50-50 pozmix to cover the liner hanger. Top of hanger at approximately 5044 ft. W.O.C. Perforate and frac the Gallup zone. Clean the well up. Run new 2-3/8", J-55, EUE, 4.7# tubing and land in the Gallup zone. Nipple down the wellhead. Run rods, pump and set the pumping unit. Set stock tanks. Connect to a gathering system. Test the well. (OVER)

IN ABOVE SPACE DESCRIBE PROPOSED PROGRAM: If proposal is to deepen or plug back, give data on present productive zone and proposed new productive zone. If proposal is to drill or deepen directionally, give pertinent data on subsurface locations and measured and true vertical depths. Give blowout preventer program, if any.

SIGNED

Rudy D. Motto

TITLE Field Operations Manager

DATE September 6, 1982

(This space for Federal or State office use)

PERMIT NO.

APPROVED BY

CONDITIONS OF APPROVAL, IF ANY:

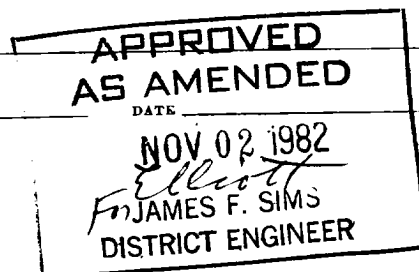
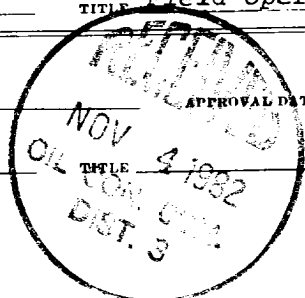

All distances must be from the outer boundaries of the Section.

Operator UNION TEXAS PETROLEUM CORP.			Lease ZACHRY		Well No. 31
Unit Letter I	Section 33	Township 29 NORTH	Range 10 WEST	County SAN JUAN	
Actual Footage Location of Well: 1980 feet from the SOUTH line and 650 feet from the EAST line					
Ground Level Elev. 5710	Producing Formation GALLUP		Pool Armenta Extention		Dedicated Acreage: NE/SE 40.00 Acres

1. Outline the acreage dedicated to the subject well by colored pencil or hachure marks on the plat below.
2. If more than one lease is dedicated to the well, outline each and identify the ownership thereof (both as to working interest and royalty).
3. If more than one lease of different ownership is dedicated to the well, have the interests of all owners been consolidated by communitization, unitization, force-pooling, etc?

☐ Yes ☐ No If answer is "yes," type of consolidation _____

If answer is "no," list the owners and tract descriptions which have actually been consolidated. (Use reverse side of this form if necessary.) _____

No allowable will be assigned to the well until all interests have been consolidated (by communitization, unitization, forced-pooling, or otherwise) or until a non-standard unit, eliminating such interests, has been approved by the Division

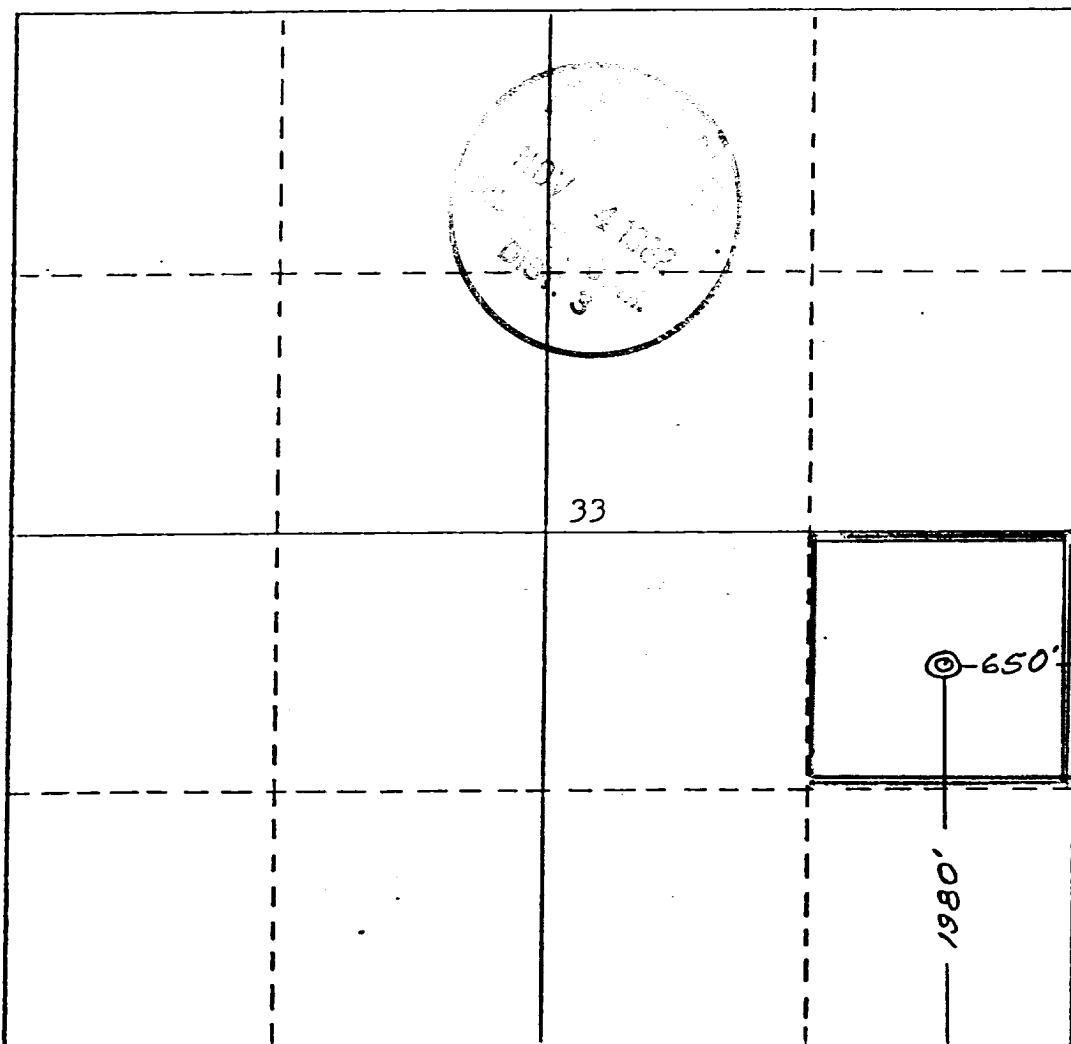

CERTIFICATION

I hereby certify that the information contained herein is true and complete to the best of my knowledge and belief.

Ludy A. Math
Name

Area Operations Manager

Position

Union Texas Petroleum

Company

August 4, 1982

Date

I hereby certify that the well location shown on this plat was plotted from field notes of actual surveys made by me or under my supervision, and that the same is true and correct to the best of my knowledge and belief.

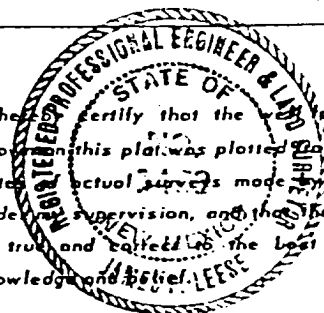

Date Surveyed

July 29, 1982

Registered Professional Engineer and/or Land Surveyor

James P. Leese
James P. Leese

Certificate No.

1463

UNION TEXAS PETROLEUM CORP.
Zachry #31
NE $\frac{1}{4}$ SE $\frac{1}{4}$, Sec. 33, T29N, R10W, NMPM
San Juan County, New Mexico

