

NO. OF COPIES RECEIVED	
DISTRIBUTION	
SANTA FE	
FILE	
U.S.G.S.	
LAND OFFICE	
OPERATOR	

NEW MEXICO OIL CONSERVATION COMMISSION

Form O-191
Revised 1-1-65

5A. Indicate Type of Lease
STATE ☐ FILE ☒
5. State Oil & Gas Lease No.

APPLICATION FOR PERMIT TO DRILL, DEEPEN, OR PLUG BACK

1a. Type of Work b. Type of Well DRILL <input checked="" type="checkbox"/> DEEPEN <input type="checkbox"/> PLUG BACK <input type="checkbox"/> OIL WELL <input type="checkbox"/> GAS WELL <input checked="" type="checkbox"/> OTHER <input type="checkbox"/> SINGLE ZONE <input checked="" type="checkbox"/> MULTIPLE ZONE <input type="checkbox"/>		7. Unit Agreement Name
2. Name of Operator Amoco Production Company		8. Farm or Lease Name Abrams Gas Com "M"
3. Address of Operator 501 Airport Drive, Farmington, New Mexico 87401		9. Well No. 1
4. Location of Well UNIT LETTER I LOCATED 1700 FEET FROM THE South LINE AND 1060 FEET FROM THE East LINE OF SEC. 26 TWP. 29N RGE. 10W NMPM		10. Field and Pool, or Wildcat Otero Chacra <i>ent</i>
19. Proposed Depth 3188'		19A. Formation Chacra
20. Rotary or C.T. Rotary		21. Elevations (Show whether DF, RT, etc.) 5557' GR
21A. Kind & Status Plug. Bond Statewide		21B. Drilling Contractor Unknown
22. Approx. Date Work will start As soon as permitted		

PROPOSED CASING AND CEMENT PROGRAM

SIZE OF HOLE	SIZE OF CASING	WEIGHT PER FOOT	SETTING DEPTH	SACKS OF CEMENT	EST. TOP
12-1/4"	8-5/8"	24# J-55	300'	354 cu. ft.	Class B
7-7/8"	4-1/2"	10.5# K-55	3188'	1200 cu. ft.	Class B

Amoco proposes to drill the above well to further develop the Otero Chacra reservoir. The well will be drilled to the surface casing point using native mud. The well will then be drilled to TD with a low solids nondispersed mud system. Completion design will be based on open hole logs. Copy of all logs will be filed upon completion. Amoco's standard blowout prevention will be employed; see attached drawing for blowout preventer design. Upon completion the well site will be cleaned and the reserve pit filled and leveled. The gas from this well is undedicated at this time.

APPROVAL EXPIRES 6-13-85
UNLESS DRILLING IS COMMENCED.
SPUD NOTICE MUST BE SUBMITTED
WITHIN 10 DAYS.

RECEIVED

DEC 13 1984

OIL CON. DIV.]
DIST. 3

IN ABOVE SPACE DESCRIBE PROPOSED PROGRAM: IF PROPOSAL IS TO DEEPEN OR PLUG BACK, GIVE DATA ON PRESENT PRODUCTIVE ZONE AND PROPOSED NEW PRODUCTIVE ZONE. GIVE BLOWOUT PREVENTER PROGRAM, IF ANY.

I hereby certify that the information above is true and complete to the best of my knowledge and belief.

Signed BDS Shaw Title Administrative Supervisor Date 12-10-84

(This space for State Use)

APPROVED BY John J. Cherry TITLE SUPERVISOR DISTRICT # 3 DATE DEC 13 1984

CONDITIONS OF APPROVAL, IF ANY:

OIL CONSERVATION DIVISION

STATE OF NEW MEXICO
ENERGY AND MINERALS DEPARTMENTP. O. BOX 2088
SANTA FE, NEW MEXICO 87501Form C-107
Revised 10-1-78

All distances must be from the outer boundaries of the Section.

Operator AMOCO PRODUCTION COMPANY			Lease Abrams Gas Com "M"		Well No. 1
Unit Letter I	Section 26	Township 29N	Range 10W	County San Juan	
Actual Footage Location of Well: 1700 feet from the South line and 1060 feet from the East line					
Ground Level Elev. 5557	Producing Formation Chacra		Pool Otero Chacra		Dedicated Acreage: 160 Acres

1. Outline the acreage dedicated to the subject well by colored pencil or hachure marks on the plat below.
2. If more than one lease is dedicated to the well, outline each and identify the ownership thereof (both as to working interest and royalty).
3. If more than one lease of different ownership is dedicated to the well, have the interests of all owners been consolidated by communitization, unitization, force-pooling, etc?

☒ Yes ☐ No If answer is "yes," type of consolidation Communitized

If answer is "no," list the owners and tract descriptions which have actually been consolidated. (Use reverse side of this form if necessary.) _____

No allowable will be assigned to the well until all interests have been consolidated (by communitization, unitization, forced-pooling, or otherwise) or until a non-standard unit, eliminating such interests, has been approved by the Commission.

<div style="text-align: center;"> </div>		<div style="text-align: center;"> RECEIVED DEC 13 1984 OIL CON. DIV. DIST. 3 </div>	
		<div style="text-align: center;"> Sec. </div>	

Scale: 1"=1000'

CERTIFICATION

I hereby certify that the information contained herein is true and complete to the best of my knowledge and belief.

B.D. Shaw

Name
B.D. Shaw

Position
Administrative Supervisor

Company
Amoco Production Company

Date
12/10/84

I hereby certify that the well location shown on this plat was plotted from field notes of actual surveys made by me or under my supervision, and that the same is true and correct to the best of my knowledge and belief.

Date Surveyed
December 5, 1984

Registered Professional Engineer and Land Surveyor
Fred E. Kert Jr.

Certificate No. **3950**

1. Blowout Preventers and Master Valve to be fluid operated, and all fittings must be in good condition.
2. Equipment through which bit must pass shall be as large as the inside diameter of the casing that is being drilled through.
3. Nipple above Blowout Preventer shall be same size or larger than BOP being drilled through.
4. All fittings to be flanged.
5. Omsco or comparable safety valve must be available on rig floor at all times with proper connection or sub. The I.D. of safety valve should be as great as I.D. of tool joints of drill pipe, or at least as great as I.D. of drill collars.

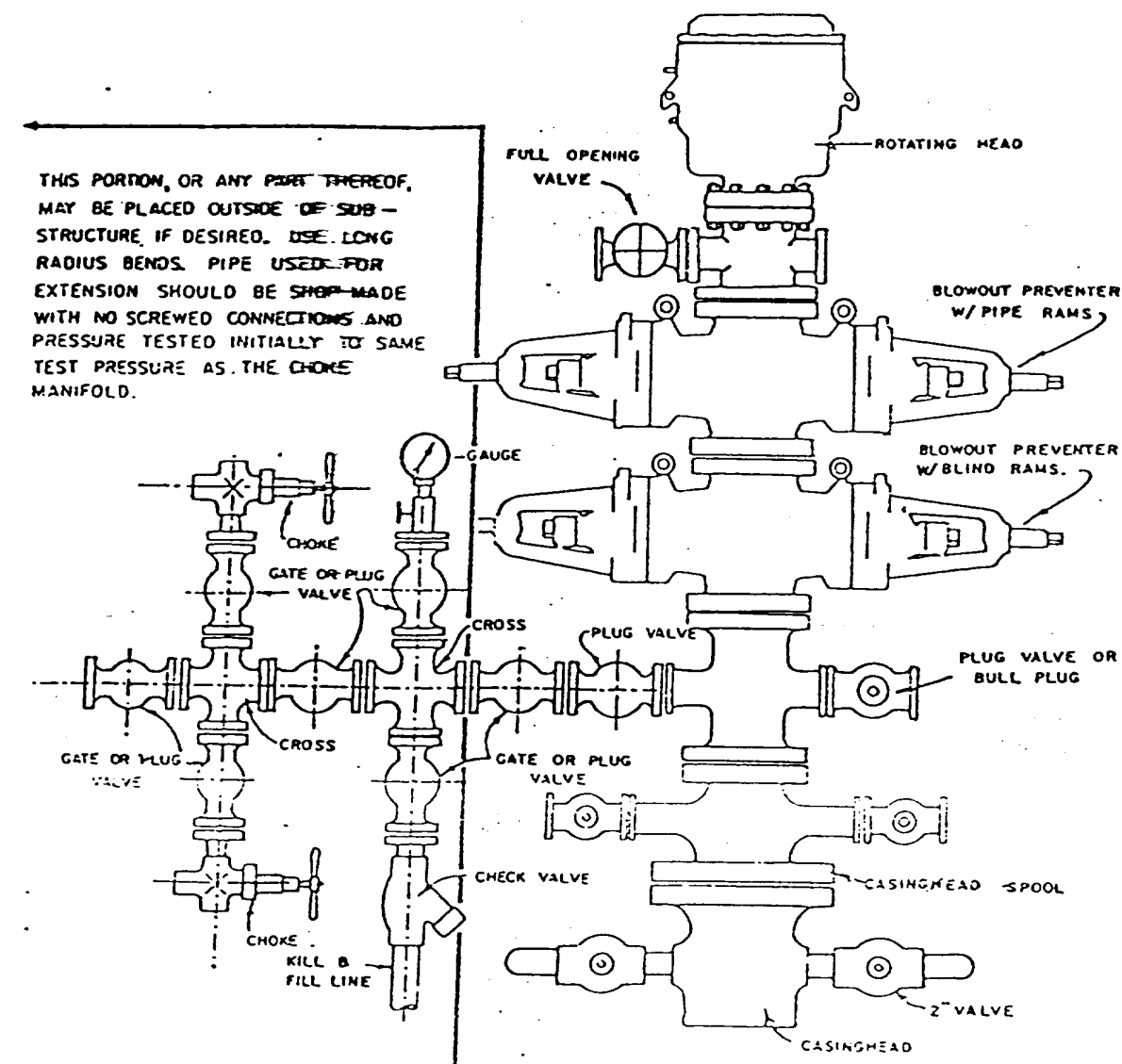

BLOWOUT PREVENTER HOOKUP

API Series # 900

EXHIBIT D-4

OCTOBER 16, 1955

Operation of BOP by closing both pipe and blind rams will be tested each trip or, on long bit runs, pipe rams will be closed once each 24 hours.

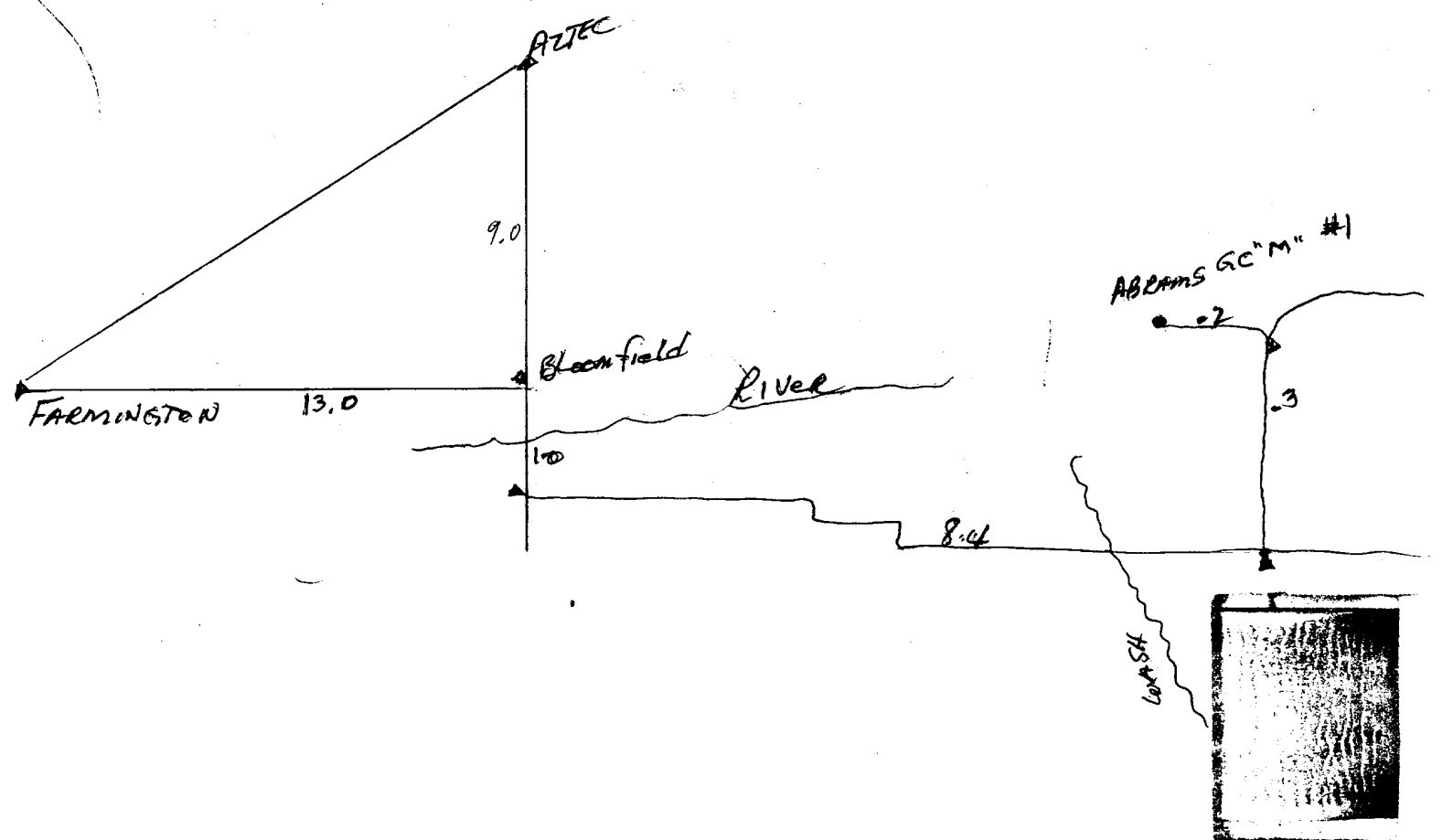
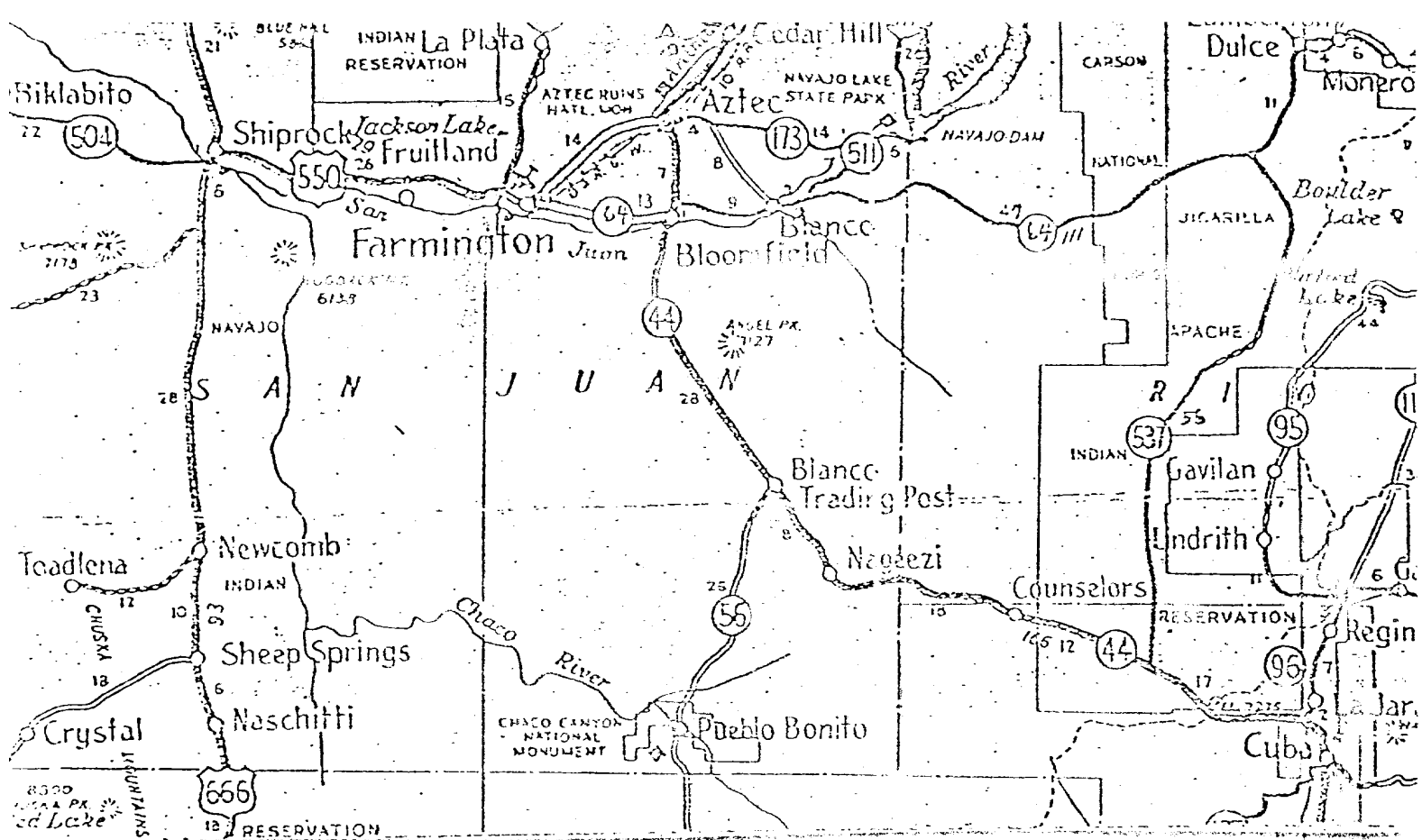

ABRAMS G.C. "M" #1
 NE 1/4 SE 1/4 Sec 26, T29N, R10W
 SAN JUAN CO. N. MEX
 RAIL POINT: 146 mi. Gallup, NM
 MUD POINT: 19 mi. Aztec, NM
 CEMENT POINT: 23 mi. Farmington, NM