



STATE OF NEW MEXICO  
ENERGY AND MINERALS DEPARTMENT

OIL CONSERVATION DIVISION  
AZTEC DISTRICT OFFICE

1010 RIO BRAZOS ROAD  
AZTEC, NEW MEXICO 87410  
15051 334-6178

OIL CONSERVATION DIVISION  
BOX 2088  
SANTA FE, NEW MEXICO 87501

DATE 3-29-89

RE: Proposed MC \_\_\_\_\_  
Proposed DIIC \_\_\_\_\_  
Proposed NSL \_\_\_\_\_  
Proposed SWD \_\_\_\_\_  
Proposed WFX \_\_\_\_\_  
Proposed PMX \_\_\_\_\_

*NSP X*

*Howell G...*

Gentlemen:

I have examined the application dated 3-14-89

for the Meridian Oil Inc. HOWELL GICDA#300 F-6-30N-8W  
Operator Lease and Well No. Unit, S-T-R

and my recommendations are as follows:

Approve For <sup>331.00</sup> 219.70, W/2  
\_\_\_\_\_  
\_\_\_\_\_  
\_\_\_\_\_  
\_\_\_\_\_

Yours truly,

*Eric Busch*

Attn: E. Busch

MERIDIAN OIL

March 6, 1989

Mr. William LeMay  
New Mexico Oil Conservation Division  
Post Office Box 2088  
Santa Fe, New Mexico 87504

Dear Mr. LeMay:

This is a request for administrative approval for a non-standard proration unit for a gas well location in the Basin Fruitland Coal Pool.

Meridian Oil Inc.'s Howell G ~~Com~~ #300 is located at 1430' from the North line and 1090' from the West line of Section 6, T-30-N, R-8-W, San Juan County, New Mexico.

A copy of this application is being submitted to all offset operators by certified mail with a request that they furnish your Santa Fe office with a Waiver of Objection, and return one copy to this office.

A plat showing the proposed well location and configuration of Section 6, along with an ownership plat, are attached.

Sincerely yours,

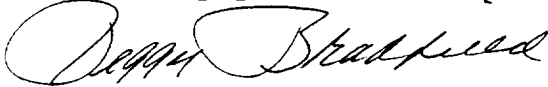

Peggy Bradford

encl.

RECEIVED

MAR 4 1989

OIL CON. DIV.  
DIST. 2

WAIVER

\_\_\_\_\_ hereby waives objection to Meridian Oil Inc.'s application for a non-standard proration unit for their Howell G Com #300 as proposed above.

By: \_\_\_\_\_

Date: \_\_\_\_\_

xc: Tenneco Oil  
Union Texas Petroleum  
Mesa Limited Partnership

MERIDIAN OIL INC.

Well Name Howell G Cam #300, Fruitland Coal

Footage----- 1430' FNL; 1090' FWL

APPLICATION FOR NON-STANDARD PRODUCTION UNIT

County San Juan State New Mexico Section 6 Township 30N Range 8W

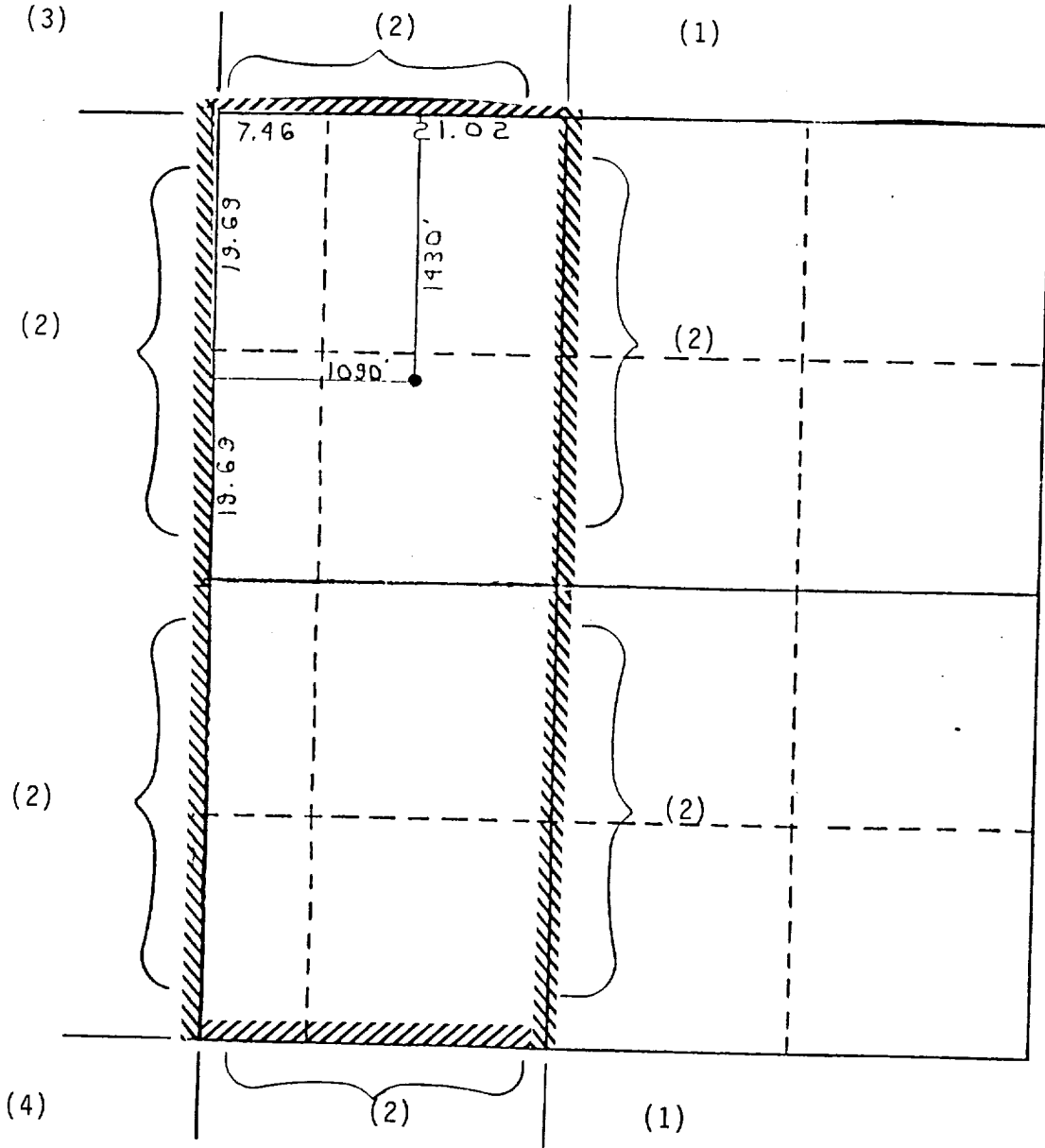

REMARKS: OFFSET OPERATORS:

(1) Meridian Oil Inc.

(2) Tenneco Oil Company

(3) Mesa Limited Partnership

(4) Union Texas Petroleum

OIL CONSERVATION DIVISION

STATE OF NEW MEXICO  
ENERGY AND MINERALS DEPARTMENT

P. O. BOX 2088  
SANTA FE, NEW MEXICO 87501

Form C-102  
Revised 10-1-78

All distances must be from the outer boundaries of the Section.

Operator <b>Meridian Oil Co.</b>		Lease <b>Howell G (NM-012719)</b>			Well No. <b>300</b>
Unit Letter <b>F</b>	Section <b>6</b>	Township <b>T30N</b>	Range <b>R8W</b>	County <b>San Juan</b>	
Actual Footage Location of Well: <b>1430</b> feet from the <b>North</b> line and <b>1090</b> feet from the <b>West</b> line					
Ground Level Elev. <b>6018</b>	Producing Formation <b>Fruitland Coal</b>		Pool <b>Basin</b>	Dedicated Acreage <b>219.7</b> Acres	

1. Outline the acreage dedicated to the subject well by colored pencil or hachure marks on the plat below.
2. If more than one lease is dedicated to the well, outline each and identify the ownership thereof (both as to working interest and royalty).
3. If more than one lease of different ownership is dedicated to the well, have the interests of all owners been consolidated by communitization, unitization, force-pooling, etc?

Yes  No If answer is "yes," type of consolidation \_\_\_\_\_

If answer is "no," list the owners and tract descriptions which have actually been consolidated. (Use reverse side of this form if necessary.) \_\_\_\_\_

No allowable will be assigned to the well until all interests have been consolidated (by communitization, unitization, forced-pooling, or otherwise) or until a non-standard unit, eliminating such interests, has been approved by the Division.

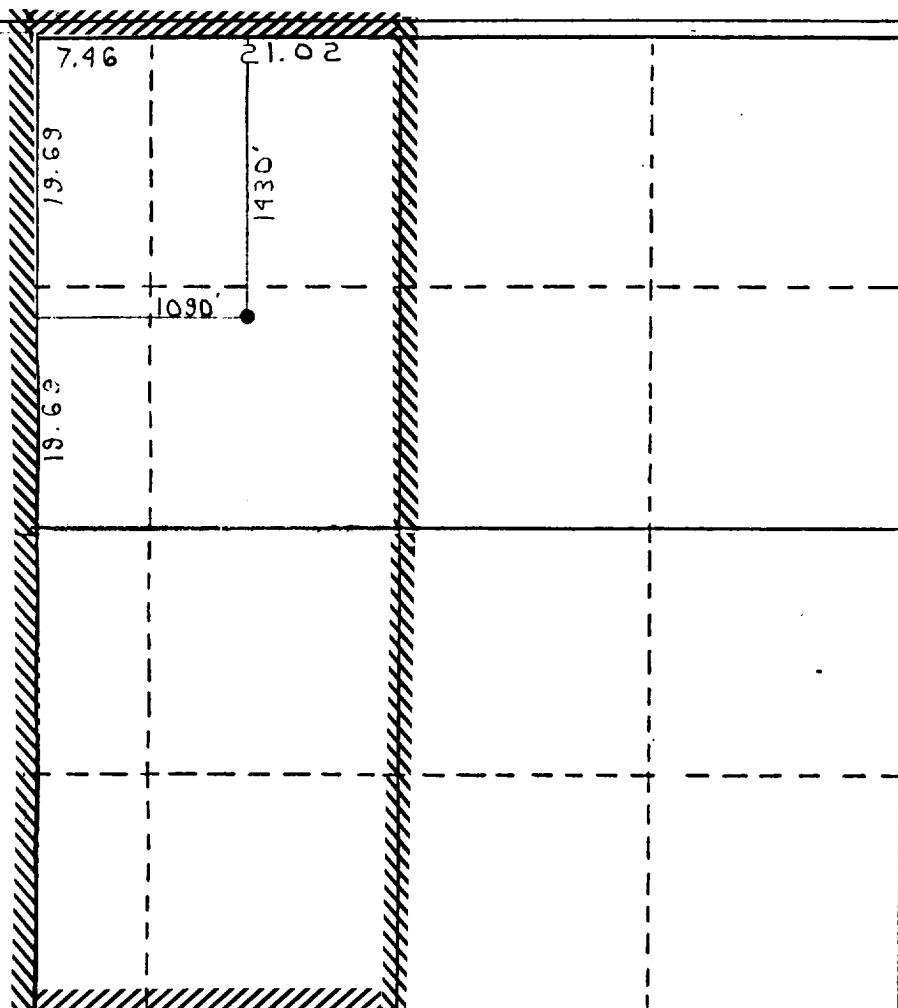

CERTIFICATION

I hereby certify that the information contained herein is true and complete to the best of my knowledge and belief.

Name  
**Regulatory Affairs**  
Position  
**Meridian Oil Inc.**  
Company

Date

I hereby certify that the well location shown on this plat was plotted from field notes of actual surveys made by me or under my supervision, and that the same is true and correct to the best of my knowledge and belief.

Registered Professional

Date Surveyed  
**April 2, 1988**

Registered Land Surveyor  
**R. Howard Daggett**

Certificate No. *R. Howard Daggett*

9679

