

UNITED STATES
DEPARTMENT OF THE INTERIOR
GEOLOGICAL SURVEY

APPLICATION FOR PERMIT TO DRILL, DEEPEN, OR PLUG BACK

1a. TYPE OF WORK DRILL <input checked="" type="checkbox"/> DEEPEN <input type="checkbox"/> PLUG BACK <input type="checkbox"/>				5. LEASE DESIGNATION AND SERIAL NO. 29-012711	
b. TYPE OF WELL OIL WELL <input type="checkbox"/> GAS WELL <input checked="" type="checkbox"/> OTHER <input type="checkbox"/> SINGLE ZONE <input checked="" type="checkbox"/> MULTIPLE ZONE <input type="checkbox"/>				6. IF INDIAN, ALLOTTEE OR TRIBE NAME	
2. NAME OF OPERATOR Tenneco Oil Company				7. UNIT AGREEMENT NAME	
3. ADDRESS OF OPERATOR P.O. Box 3249, Englewood, CO 80155				8. FARM OR LEASE NAME Florance	
4. LOCATION OF WELL (Report location clearly and in accordance with any State requirements.) At surface NE/SE Sec. 3, 1620' FSL, 1050' FEL At proposed prod. zone Same				9. WELL NO. 137	
14. DISTANCE IN MILES AND DIRECTION FROM NEAREST TOWN OR POST OFFICE* 3 miles NW of Archuleta				10. FIELD AND POOL OR WILDCAT Blanco Fruitland <i>com</i>	
15. DISTANCE FROM PROPOSED* LOCATION TO NEAREST PROPERTY OR LEASE LINE, FT. (Also to nearest drlg. unit line, if any) 1050'		16. NO. OF ACRES IN LEASE 688.73		17. NO. OF ACRES ASSIGNED TO THIS WELL 323.20 <i>160</i>	
18. DISTANCE FROM PROPOSED LOCATION* TO NEAREST WELL, DRILLING, COMPLETED, OR APPLIED FOR, ON THIS LEASE, FT. 350'		19. PROPOSED DEPTH 3085'		20. ROTARY OR CABLE TOOLS Rotary	
21. ELEVATIONS (Show whether DF, RT, GR, etc.) 6182' GR DRILLING OPERATIONS AUTHORIZED ARE SUBJECT TO COMPLIANCE WITH ATTACHED "GENERAL REQUIREMENTS" PROPOSED CASING AND CEMENTING PROGRAM				22. APPROX. DATE WORK WILL START* 10/1/88 <i>This action is subject to technical and procedural review pursuant to 43 CFR 3165.3 and appeal pursuant to 43 CFR 3165.4.</i>	
23. SIZE OF HOLE		SIZE OF CASING		QUANTITY OF CEMENT	
12 1/4"		9 5/8"		200 cu.ft. - Circ. to Surface	
8 3/4"		7"		650 cu.ft. - Circ. to Surface	
6 1/2"		5 1/2" - Liner		None	
WEIGHT PER FOOT		SETTING DEPTH			
36#		± 200'			
23#		±2630'			
23#		±2530'-3082'			

See attached Drilling Procedure.

See Item 1.B in the Surface Use Plan and Map 2 for BLM ROW Application.

RECEIVED

OCT 03 1988

OH CON. DIV.
265.3

IN ABOVE SPACE DESCRIBE PROPOSED PROGRAM: If proposal is to deepen or plug back, give data on present productive zone and proposed new productive zone. If proposal is to drill or deepen directionally, give pertinent data on subsurface locations and measured and true vertical depths. Give blowout preventer program, if any.

24. SIGNED Larry Bell TITLE Administrative Supervisor DATE 8/18/88
(This space for Federal or State office use)

PERMIT NO. _____ APPROVAL DATE _____

APPROVED BY _____ TITLE _____ DATE _____
CONDITIONS OF APPROVAL, IF ANY:ok
[Signature]

NMCCG

[Signature]
FSA

NEW MEXICO OIL CONSERVATION COMMISSION
WELL LOCATION AND ACREAGE DEDICATION PLAT

Form C-102
Supersedes C-128
Effective 1-1-65

All distances must be from the outer boundaries of the Section

Operator TENNECO OIL COMPANY			Lease FLORANCE		Well No. 137
Unit Letter I	Section 3	Township 30 N	Range 8 W	County SAN JUAN	
Actual Footage Location of Well: 1620 feet from the South line and 1050 feet from the East line					
Ground Level Elev. 6182	Producing Formation Fruitland Coal		Pool Under Blanco Fruitland	Dedicated Acreage: 323.20 160 Acres	

1. Outline the acreage dedicated to the subject well by colored pencil or hatchure marks on the plat below.
2. If more than one lease is dedicated to the well, outline each and identify the ownership thereof (both as to working interest and royalty).
3. If more than one lease of different ownership is dedicated to the well, have the interests of all owners been consolidated by communitization, unitization, force-pooling, etc?

☐ Yes ☐ No If answer is "yes," type of consolidation _____

If answer is "no," list the owners and tract descriptions which have actually been consolidated. (Use reverse side of this form if necessary.) _____

No allowable will be assigned to the well until all interests have been consolidated (by communitization, unitization, forced-pooling, or otherwise) or until a non-standard unit, eliminating such interests, has been approved by the Commission.

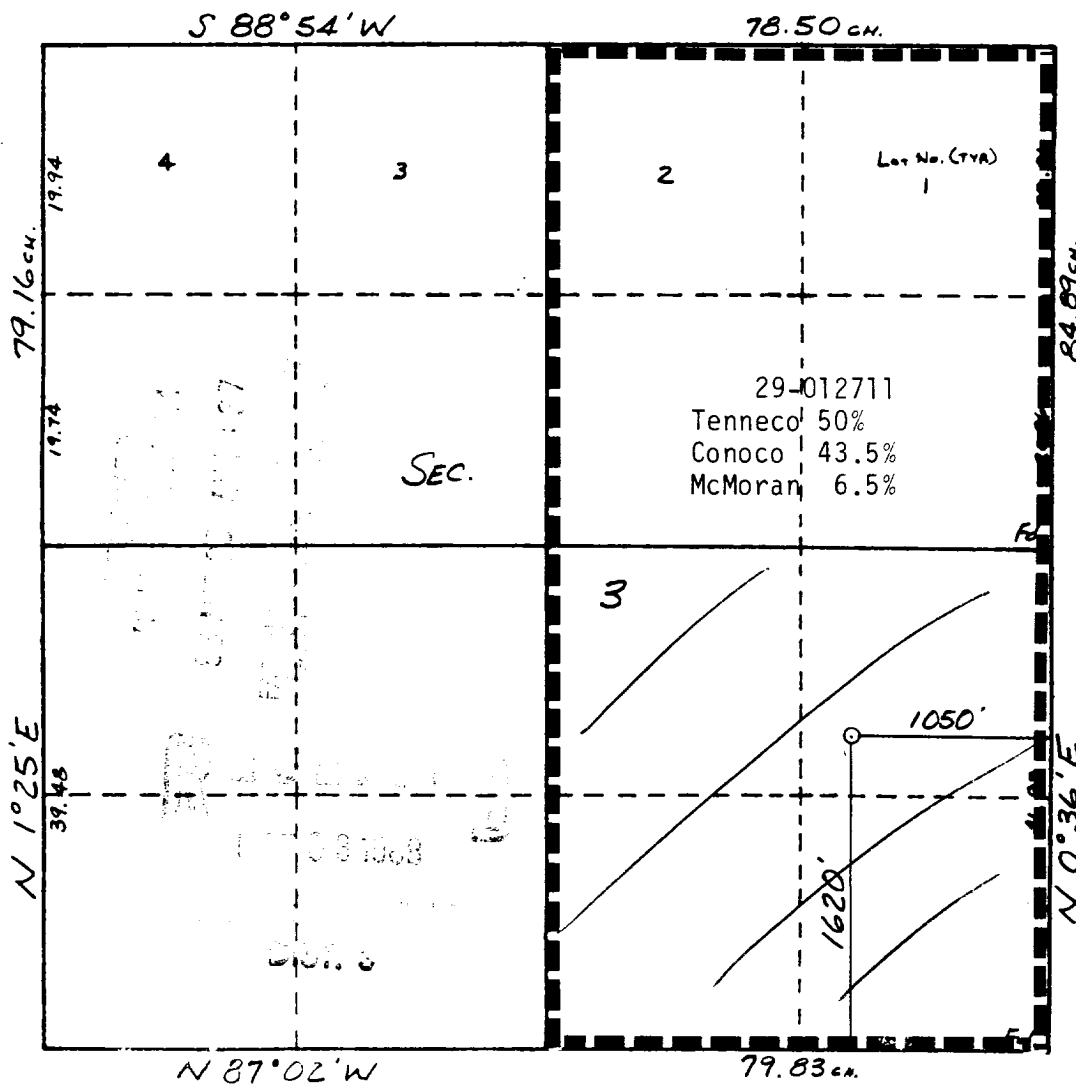

CERTIFICATION

I hereby certify that the information contained herein is true and complete to the best of my knowledge and belief.

Name
Larry Bell
Position
Administrative Supervisor
Company
Tenneco Oil Company
Date
8/18/88

I hereby certify that the well location shown on this plat was plotted from field notes of actual surveys made by me or under my supervision, and that the same is true and correct to the best of my knowledge and belief.

Date Surveyed
7-5-88
WILLIAM E. MAHONEY II
Registered Professional Engineer and Land Surveyor
#8466
Certification
REGISTERED PROFESSIONAL LAND SURVEYOR

