

UNITED STATES  
DEPARTMENT OF THE INTERIOR  
BUREAU OF LAND MANAGEMENT

FORM APPROVED  
Budget Bureau No. 1004-0135  
Expires: March 31, 1993

**SUNDRY NOTICES AND REPORTS ON WELLS**

Do not use this form for proposals to drill or to deepen or reentry to a different reservoir.  
Use "APPLICATION FOR PERMIT—" for such proposals

**SUBMIT IN TRIPLICATE**

1. Type of Well

☐ Oil Well ☒ Gas Well ☐ Other

2. Name of Operator

BHP Petroleum (Americas), Inc.

3. Address and Telephone No.

P.O. Box 977 Farmington, N.M. 87499 (505) 327-1639

4. Location of Well (Footage, Sec., T., R., M., or Survey Description)

SW SW, SE SW, NE SW, NW SE, SW NE  
Sec. 21, T29, R12W, NMPM

5. Lease Designation and Serial No.

NM03526

6. If Indian, Allottee or Tribe Name

7. If Unit or CA, Agreement Designation

Gallegos Canyon Unit

8. Well Name and No.

GCU No. 384 & 519

9. API Well No.

30-045-27575 30-045-29057

10. Field and Pool, or Exploratory Area

Basin Fruitland Coal, W. Kutz Pic-

tured Cliffs

11. County or Parish, State

San Juan, New Mexico

12. CHECK APPROPRIATE BOX(s) TO INDICATE NATURE OF NOTICE, REPORT, OR OTHER DATA

TYPE OF SUBMISSION

- ☒ Notice of Intent  
☐ Subsequent Report  
☐ Final Abandonment Notice

TYPE OF ACTION

- ☐ Abandonment  
☐ Recompletion  
☐ Plugging Back  
☐ Casing Repair  
☐ Altering Casing  
☒ Other Construct 2 buried  
Pipelines.

- ☐ Change of Plans  
☐ New Construction  
☐ Non-Routine Fracturing  
☐ Water Shut-Off  
☐ Conversion to Injection  
☒ Dispose Water

(Note: Report results of multiple completion on Well Completion or Recompletion Report and Log form.)

13. Describe Proposed or Completed Operations (Clearly state all pertinent details, and give pertinent dates, including estimated date of starting any proposed work. If well is directionally drilled, give subsurface locations and measured and true vertical depths for all markers and zones pertinent to this work.)\*

Description Attached.

RECEIVED  
MAY 27 1994

OIL CON. DIV.  
DIST. 3

RECEIVED  
MAY 17 11:04 AM  
BLM

14. I hereby certify that the foregoing is true and correct

Signed Jed Lowery

Title Operations Superintendent

Date May 5, 1994

(This space for Federal or State office use)

Approved by

Title

Date

Conditions of approval, if any:

APPROVED  
MAY 25 1994

DIRECT MANAGER

Title 18 U.S.C. Section 1001, makes it a crime for any person knowingly and willfully to make to any department or agency of the United States any false, fictitious or fraudulent statements or representations as to any matter within its jurisdiction.

\*See instruction on Reverse Side

## DESCRIPTION

BHP proposes to construct a 3200' long buried steel pipeline for the purpose of transporting natural gas from the GCU #384 and GCU #519 locations to our central compressor facility and CDP meter located on lease, SW NE, Sec. 21, T29N, R12W and a 2800' long 3" SDR 7 polyethylene pipeline for the purpose of transporting produced water from our GCU #519 location to our existing Hwy. 64 produced water gathering pipeline located at the same facility.

2", schedule 40, butt welded, external coated steel will be used to construct the natural gas pipeline from the GCU #384, 400' east to the GCU #519 location. 4", .156 wall, butt welded, external coated steel will be used to construct the natural gas pipeline from the GCU #519 location, 2800' northeast to tie-in with the existing GCU Hwy. 64 pipeline in the SW NE, Sec. 21, T29N, R12W.

Both the steel and polyethylene pipelines will be buried 4' deep, side by side, in the same ditch.

The steel natural gas lines will be pressure tested to 1000 psi and the poly line will be tested to 200 psi.

All of the 3200' of 40' wide ROW requested is within the Gallegos Canyon Unit on BLM surface.

A cultural inventory survey was conducted on April 21 and May 2, 1994 by San Juan College. See Consultant Report No. 94-SJC-021. Copy attached.

The proposed pipeline route was chosen in consultation with BLM Realty Spec, Mary Jo Albin, and is scheduled to be onsite by BLM EP Asst., Jackie Neckels, on May 9, 1994.

Orifice allocation meters will be installed on the GCU #384 and GCU #519 locations. The allocation charts will be integrated by measurement auditors of Wheatridge, Colorado. They will conduct the meter calibrations, when required. If the volume exceeds 200 MCF/D average, a continuous temperature recorder will be installed on the respective allocation meter.

22 NORTH)

108°07'30" 15700m.E  
36°45'

BHP Petroleum (Americas), Inc.  
Proposed GCU 384/519 Pipelines  
SW SW, SE SW, NE SW, NW SE, SW NE,  
Sec. 21, T 29 N, R 12 W, NMPM  
San Juan County, New Mexico

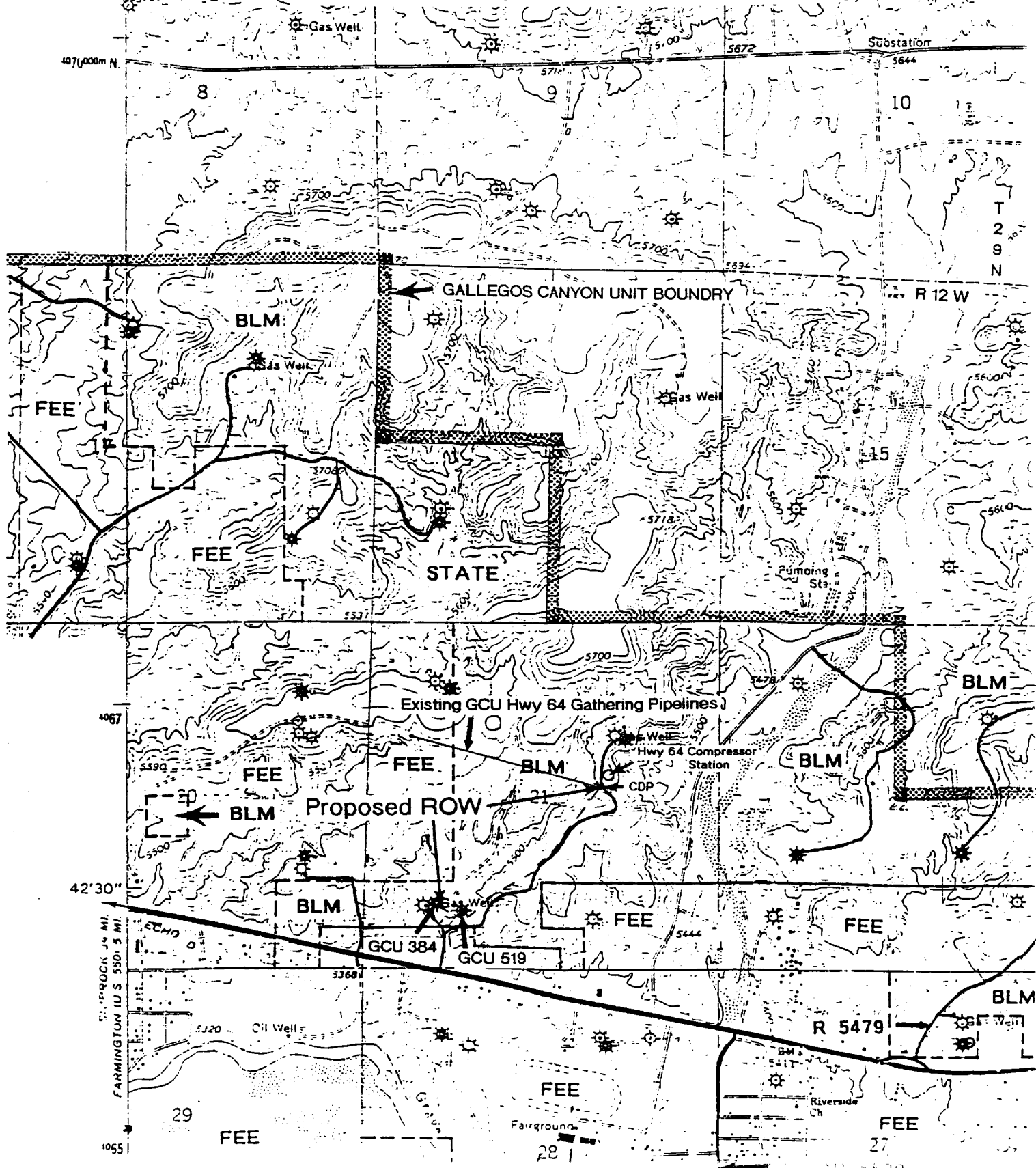

1. BLM Report No.	2. (For BLM Use Only)	3. Recipients Accession No.
4. Title of Report: A Cultural Resources Inventory of Proposed Gallegos Canyon Unit #384/519 Gas Pipeline near Farmington, San Juan County, New Mexico, Conducted for BHP (Americas), Inc. by Patricia M. Hancock		5. Fieldwork Dates: April 21 and May 2, 1994
		6. Report Date: May 4, 1994
7. Consultant Name and Address: General Charge: Linda Wheelbarger Org. Name: San Juan College CRMP Org. Address: 4601 College Boulevard Farmington, NM 87402 Phone: (505) 599-0344		8. Permit No.  1-2920-93-KK
		9. Consultant Report No.  94-SJC-021
10. Sponsor Name and Address: Ind. Responsible: Charles Neeley Org. Name: Property Management and Consulting, Inc. representing BHP (Americas), Inc. Org. Address: P O Box 2596; Farmington, NM 87499 Phone: 505-325-5220		11. Sponsor Project No.
		12. Area of Effect: <u>3.67 acres</u> 3200 x 50 ft ROW BLM surface/BLM minerals Area Surveyed: <u>11.02 acres</u> 3200 x 150 ft BLM surface/BLM minerals
13. Location (Maps Attached) a. State: New Mexico b. County: San Juan c. District: Farmington d. Land Status: BLM Surface with BLM Minerals	e. Area: T <u>29</u> N R <u>12</u> W Sec. <u>21</u> S <u>1/2</u> and NE <u>1/4</u> f. Footages: N/A g. 7.5' Map Name(s): Horn Canyon, NM, 1965, photorevised 1979	
14. a. Description of Undertaking: The proposed project will consist of construction of a buried pipeline within a 3,200 x 50 ft ROW. Heavy equipment will be used during construction of the project.		
b. Existing Data Review: On April 21, 1994, a records search was conducted of the NMCRIIS files and of nearby sites information located at the SJC-CRMP and BLM, Farmington District, offices. No previously recorded sites are located within 500 ft of the project area. See the attached Nearby Sites Map.		
c. Area Environmental and Cultural Setting: The proposed project area is located just below and on the first terrace north of the San Juan River between Farmington and Bloomfield, New Mexico. The general area is quite rugged with steep cobble talus slopes and narrow terrace tops to the west, north, and east. Beginning at the existing Gallegos Canyon Unit #384 well location located in a rincon at the base of the terrace, the proposed pipeline ROW heads east for approximately 200 ft to the existing Gallegos Canyon Unit #519 well pad (T29N, R12W, Section 21, 885 ft FSL and 1450 ft FWL). From there, the proposed pipeline ROW proceeds northeastward up the steep gravel slope of an erosional drainage to the top of a terrace ridge which is defined by deep arroyos to the east and west. From the top of the ridge, the proposed pipeline ROW continues to head northeast, paralleling the west side of a dirt road for a portion of the way, and terminates, approximately 3,000 ft from the GCU #519 well, at a pig receiver on an existing BHP pipeline. Soils in the area consist of tan aeolian sand mixed among the dense cover of river cobbles and Nacimiento gravels. Vegetative cover varies from 10-25 percent. Rabbitbrush, Russian thistle, and sage dominate the area. Other observed species include sparse juniper, four-wing saltbush, sagebrush, bunch grasses, cheat grass, yucca, prickly pear, pencil cholla, Indian ricegrass, and evening primrose.		

**d. Field Methods:** The proposed centerline was staked with orange flagged wooden lath. The westernmost 200 ft length of the proposed pipeline ROW was surveyed on April 21, 1994. Subsequently, Charles Neeley advised SJC-CRMP that an additional 3,000 ft length would be added to the project area. The latter portion of the project area was surveyed on May 2, 1994. The project area and cultural buffer were surveyed by walking four parallel transects spaced 10-12 m apart. A 50 ft cultural buffer was surveyed on each side of the 3200 x 50 ft proposed pipeline ROW.

**15. Cultural Resource Findings:** One isolated manifestation (IM) was discovered during the survey.

**a. Location/Identification of Each Resource:** IM #1 is located in the cultural buffer zone on the south side of the proposed pipeline ROW, approximately 100 ft east of the GCU #519 well pad. IM #1 consists of a single artifact, an igneous cobble core/chopper. The artifact measures 14.4 x 12.4 x 5.8 cm with 4-5 flakes having been taken unifacially off one end. The percentage of remaining cortex on the artifact is approximately 60%. See the attached BLM Isolated Manifestation Table for additional information.

**b. Evaluation of Significance of Each Resource (above):** IM #1 was recorded in detail in the field, and it is suggested that the information potential of the artifact has been exhausted. IM #1 is not recommended eligible for the National Register of Historic Places (NRHP).

**16. Management Summary (Recommendations):** No NRHP eligible historic properties were discovered during the cultural resource survey. Cultural resource approval for this undertaking to proceed is recommended.

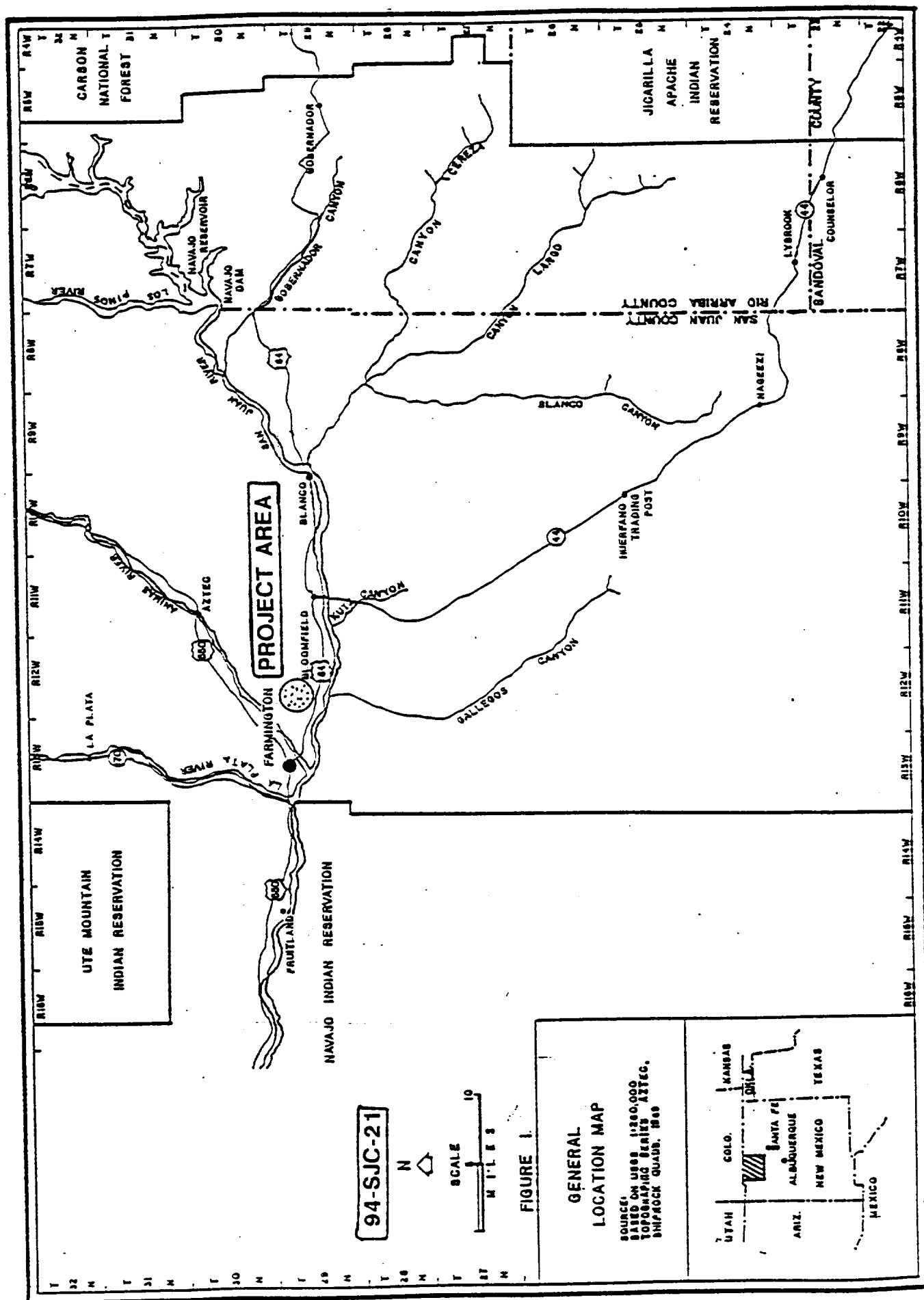

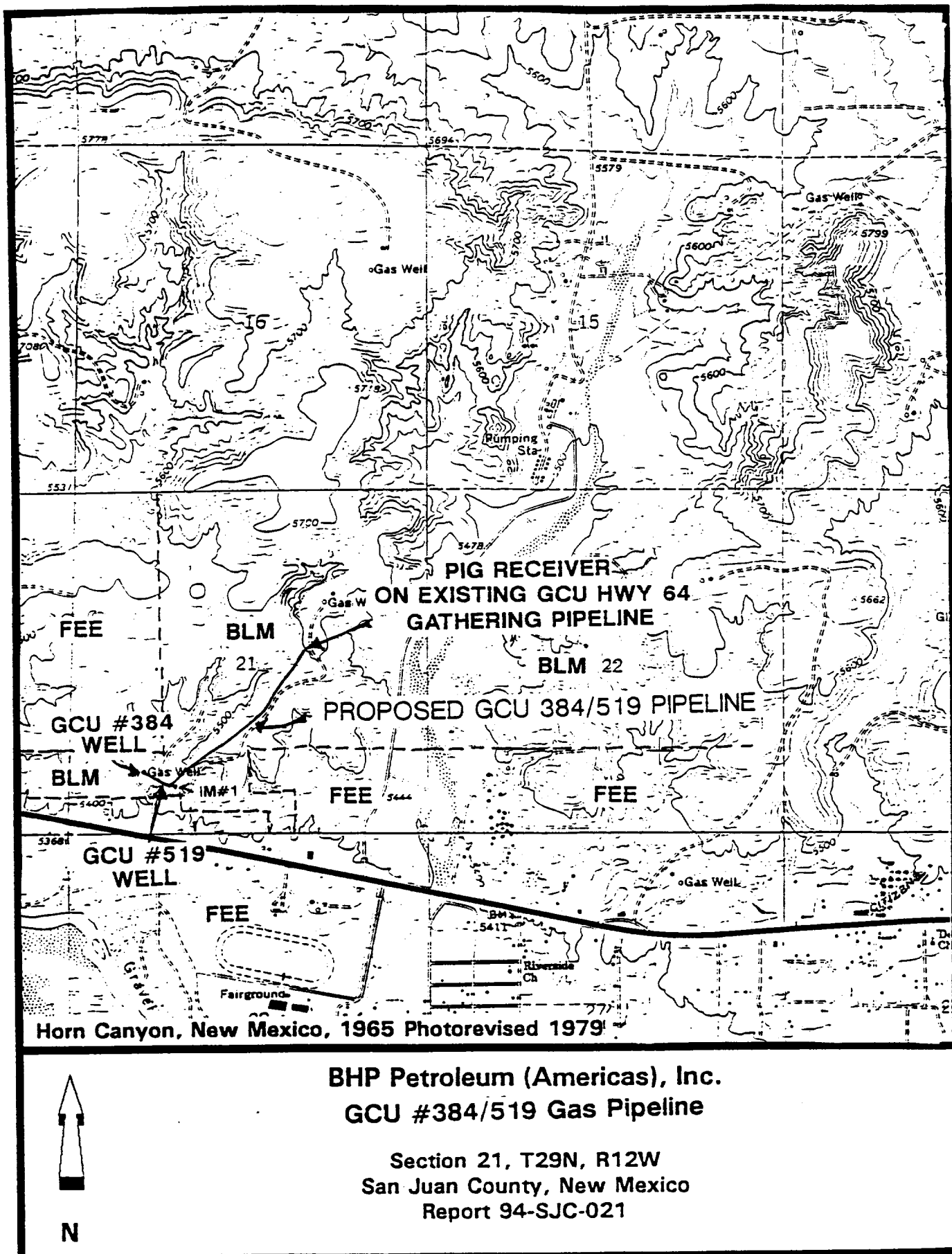

Figure 2. Vicinity Map