

UNITED STATES
DEPARTMENT OF THE INTERIOR
BUREAU OF LAND MANAGEMENT

APPLICATION FOR PERMIT TO DRILL, DEEPEN, OR PLUG BACK

1a. TYPE of WORK DRILL <input checked="" type="checkbox"/> DEEPEN <input type="checkbox"/> PLUG BACK <input type="checkbox"/>				5. LEASE DESIGNATION SF080647	
b. TYPE of WELL OIL WELL <input type="checkbox"/> GAS WELL <input checked="" type="checkbox"/> OTHER <input type="checkbox"/> SINGLE ZONE <input checked="" type="checkbox"/> MULTIPLE ZONE <input type="checkbox"/>				6. INDIAN, ALLOTTEE, TRIBE NAME	
2. NAME of OPERATOR BHP Petroluem (Americas), Inc.				7. UNIT AGREEMENT NAME GALLEGOS CANYON UNIT	
3. ADDRESS of OPERATOR P.O. Box 977 Farmington, NM 87499				8. FARM OR LEASE NAME GALLEGOS CANYON UNIT	
4. LOCATION of WELL 880' FNL & 1820' FWL				9. WELL NO. 522	
14. DISTANCE IN MILES and DIRECTION from NEAREST TOWN 3.8 miles southeast of Farmington, NM				10. FIELD and POOL or WILDCAT Pictured Cliffs	
15. DISTANCE from PROPOSED LOCATION to NEAREST PROPERTY or LEASE LINE, Ft. 792'				11. SEC., T., R., M., or BLK Sec. 22, T29N, R12W, NMPM	
16. NO. of ACRES in LEASE 320 (e)		17. NO. of ACRES ASSIGNED to WELL 159.22		12. COUNTY or PARISH San Juan	
18. DISTANCE from PROPOSED LOCATION to NEAREST WELL, DRILLING, COMPLETED, or APPLIED FOR, ON THIS LEASE, Ft. 700'		19. PROPOSED DEPTH 1672'		13. STATE NM	
21. ELEVATIONS (Show DF, RT, GR, etc.) 5477' GR				22. APPROX. DATE WORK WILL START As soon as approved	
23. PROPOSED CASING and CEMENTING PROGRAM				SUBJECT TO COMPLIANCE WITH ATTACHED "GENERAL REQUIREMENTS"	
SIZE of HOLE	SIZE of CASING	WEIGHT per FOOT	SETTING DEPTH	QUANTITY of CEMENT	
8 3/4"	7"	20#K-55	130'	35 sx (41 cu ft) circ to surface	
6 1/4"	4 1/2"	10.5#K-55	1672'	210 sx (261 cu ft) circ to surface	

BHP Petroleum (Americas), Inc. proposes to spud in the Nacimiento Formation. Will drill an 8-3/4" hole to a TD of 130'. Run and cement surface casing with cement returns to surface. WOC 12 hours. Test casing to 2000 psi for 30 minutes. Drill a 6-1/4" hole to TD of 1672' using fresh water mud. No abnormal pressures or poisonous gases are anticipated. Adequate weight material will be on location to control flows from the Farmington sands. Run logs at TD. Run and cement production casing with cement returns to surface. WOC 12 hrs. Move out drilling rig and move in completion unit. Pressure test to 2500 psi for 30 minutes prior to perforating. Run cased hole correlation logs. Perforate Pictured Cliffs and stimulate using a fresh water based gel or foam system.

50' of new, on lease, access road BLM Row is applied for via this APD.

Surface ownership is BLM

RECEIVED
DEC 17 1993

OIL CON. DIV.

24. SIGNED: JRED Luning TITLE: Operations Superintendent DATE: 11/29/93

(This space for Federal or State office use)

PERMIT NO. APPROVAL DATE

APPROVED BY TITLE

CONDITIONS OF APPROVAL, IF ANY:

APPROVED
AS AMENDED

DATE DEC 14 1993
DISTRICT MANAGER

Submit to Appropriate
District Office
State Lease - 4 copies
Fee Lease - 3 copies

State of New Mexico
Energy, Minerals and Natural Resources Department

Form C-102
Revised 1-1-89

OIL CONSERVATION DIVISION

DISTRICT I
P.O. Box 1980, Hobbs, NM 88240

P.O. Box 2088

Santa Fe, New Mexico 87504-2088

DISTRICT II
P.O. Drawer DD, Artesia, NM 88210

DISTRICT III
1000 Rio Brazos Rd., Aztec, NM 87410

WELL LOCATION AND ACREAGE DEDICATION PLAT

All Distances must be from the outer boundaries of the section

Operator BHP PETROLEUM (AMERICAS) INC.			Lease GALLEGOS CANYON UNIT		Well No. 522
Unit Letter C	Section 22	Township 29 N	Range 12 W	County San Juan	
Actual Footage Location of Well 880 feet from the North line and 1820 feet from the West line					
Ground level Elev. 5477	Producing Formation PICTURED CLIFF		Pool WEST KUTZ PICTURED CLIFF		Dedicated Acreage: 159.22 Acres

- Outline the acreage dedicated to the subject well by colored pencil or hatchure marks on the plat below.
- If more than one lease is dedicated to the well, outline each and identify the ownership thereof (both as to working interest and royalty).
- If more than one lease of different ownership is dedicated to the well, have the interest of all owners been consolidated by communitization, unitization, force-pooling, etc.?
☒ Yes ☐ No If answer is "yes" type of consolidation _____
If answer is "no" list the owners and tract descriptions which have actually been consolidated. (Use reverse side of this form if necessary) _____
No allowable will be assigned to the well until all interests have been consolidated (by communitization, unitization, forced-pooling, or otherwise) or until a non-standard unit, eliminating such interest, has been approved by the Division.

0 330 660 990 1320 1650 1980 2310 2640 2000 1500 1000 500 0

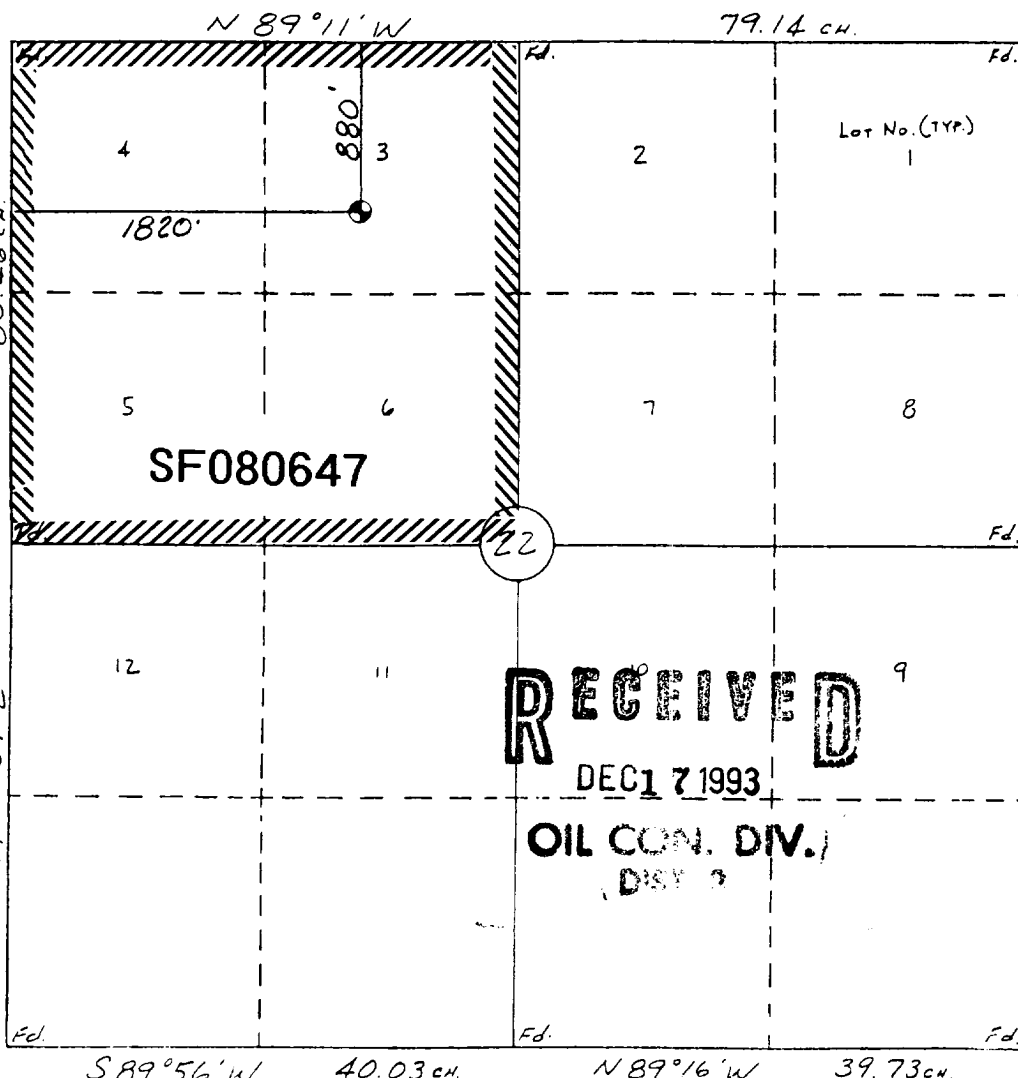

OPERATOR CERTIFICATION

I hereby certify that the information contained herein is true and complete to the best of my knowledge and belief.

Signature
Fred Lowery
Printed Name
FRED LOWERY
Position
OPERATION SUPT.
Company
BHP PETROLEUM
Date
11-4-93

SURVEYOR CERTIFICATION

I hereby certify that the well location shown on this plat was plotted from field notes of actual surveys made by me or under my supervision, and that the same is true and correct to the best of my knowledge and belief.
14 Oct., 1993

Date Surveyed
William E. Mahnke II
Signature & Seal of Professional Surveyor
WILLIAM E. MAHNKE II
#8466
Certificate No. **8466**
PROFESSIONAL LAND SURVEYOR

VICINITY MAP

BHP PETROLEUM (AMERICA'S) INC.
G.C.U. #522
880' FNL & 1820' FWL
Sec. 22, T29N, R12W
San Juan County, New Mexico

